

UNITED STATES  
DEPARTMENT OF THE INTERIOR  
BUREAU OF LAND MANAGEMENT

OIL CONSERVATION DIVISION  
811 S. 1st ST.  
ARTESIA, NM 88210-2834

APPLICATION FOR PERMIT TO DRILL OR DEEPEN

5. LEASE DESIGNATION AND SERIAL NO.  
LC-029419-B  
6. IF INDIAN, ALLOTTEE OR TRIBE NAME  
N/A

7. UNIT AGREEMENT NAME  
Skelly Unit 17540

8. FARM OR LEASE NAME, WELL NO.  
#263

9. API WELL NO.  
30-015-29184

10. FIELD AND POOL OR WILDCAT  
Grayburg Jackson 7-Rivers-QN-GB-SA  
28509

11. SEC., T., R., M., OR BLK.  
AND SURVEY OR AREA  
27, 17S-31E, N.M.P.M.

12. COUNTY FOR PARISH  
Eddy  
13. STATE  
NM

1a. TYPE OF WORK

DRILL ☒ DEEPEN ☐

b. TYPE OF WELL

OIL WELL ☒ GAS WELL ☐ OTHER ☐ SINGLE ZONE ☐ MULTIPLE ZONE ☐

2. NAME OF OPERATOR

The Wiser Oil Company 22922

3. ADDRESS AND TELEPHONE NO.

c/o J. O. Easley, Inc., P. O. Box 1796, Roswell, NM 88201-1796 (505) 623-3758

4. LOCATION OF WELL (Report location clearly and in accordance with any State requirements. \*)

At Surface 15' FNL & 1262' FWL, Unit D  
At proposed prod. Zone 15' FNL & 1262' FWL, Unit D

14. DISTANCE IN MILES AND DIRECTION FROM NEAREST TOWN OR POST OFFICE \*

± 5.7 miles southwest of Maljamar, NM

15. DISTANCE FROM PROPOSED \*  
LOCATION TO NEAREST

PROPERTY OR LEASE LINE, FT. 15'  
(Also to nearest drlg. unit line, if any)

16. NO. OF ACRES IN LEASE

640.00

17. NO. OF ACRES ASSIGNED  
TO THIS WELL

40

18. DISTANCE FROM PROPOSED LOCATION \*

TO NEAREST WELL, DRILLING, COMPLETED 904'  
OR APPLIED FOR, ON THIS LEASE, FT.

19. PROPOSED DEPTH

4800'

20. ROTARY OR CABLE TOOLS

Rotary

21. ELEVATIONS (Show whether DF, RT, GR, etc.)

3819'

22. APPROX. DATE WORK WILL START \*

1-1-97

23. PROPOSED CASING AND CEMENTING PROGRAM

SIZE OF HOLE	GRADE, SIZE OF CASING	WEIGHT PER FOOT	SETTING DEPTH	QUANTITY OF CEMENT
12 1/4"	8 5/8" 8RD ST&C J-55	23#	400'	Circulate
7 7/8"	5 1/2" J-55	17#	4800'	Sufficient to bring cmt 100' above 8 5/8" casing shoe.

Duration of Program: Drilling - Nine (9) days  
Completion - Thirty (30) days  
See attached for complete Drilling Program

EXHIBITS

Exhibit "A": Drilling Program

Exhibit "D": Land Survey Plat

Exhibit "G": Rig Layout

Exhibit "B": H<sub>2</sub>S Plan

Exhibit "E": Vicinity Plat

Exhibit "H": BOP Layout

Exhibit "C": Surface Use Plan

Exhibit "F": Existing Well Plat

IN ABOVE SPACE DESCRIBE PROPOSED PROGRAM: If proposal is to deepen, give data on present productive zone and proposed new productive zone. If proposal is to drill or deepen directionally, give pertinent data on subsurface locations and measured and true vertical depths. Give blowout preventer program, if any.

24.

SIGNED

Michael R. Burch

TITLE Agent for The Wiser Oil Company

DATE 8-19-96

Michael R. Burch, CPL

(This space for Federal or State office use)

PERMIT NO.

APPROVAL DATE

New loc 4 API

Application approval does not warrant or certify that the applicant holds legal or equitable title to those rights in the subject lease which would entitle the applicant to conduct operations thereon.

CONDITIONS OF APPROVAL, IF ANY:

/s/ JOAN R. FLOREZ

APPROVED BY

TITLE

Area Manager

DATE

SEP 24 1996

\*See Instructions On Reverse Side

Title 18 U.S.C. Section 1001, makes it a crime for any person knowingly and willfully to make to any department or agency of the United States any false, fictitious or fraudulent statements or representations as to any matter within its jurisdiction.

DISTRICT I  
P. O. Box 1980  
Hobbs, NM 88241-1980

State of New Mexico  
Energy, Minerals, and Natural Resources Department

Form C-102  
Revised 02-10-94  
Instructions on back

DISTRICT II  
P. O. Drawer DD  
Artesia, NM 88211-0719

EXHIBIT "D"  
OIL CONSERVATION DIVISION  
P. O. Box 2088  
Santa Fe, New Mexico 87504-2088

Submit to the Appropriate  
District Office  
State Lease - 4 copies  
Fee Lease - 3 copies

DISTRICT III  
1000 Rio Brazos Rd.  
Aztec, NM 87410

DISTRICT IV  
P. O. Box 2088  
Santa Fe, NM 87507-2088

☐ AMENDED REPORT

WELL LOCATION AND ACREAGE DEDICATION PLAT

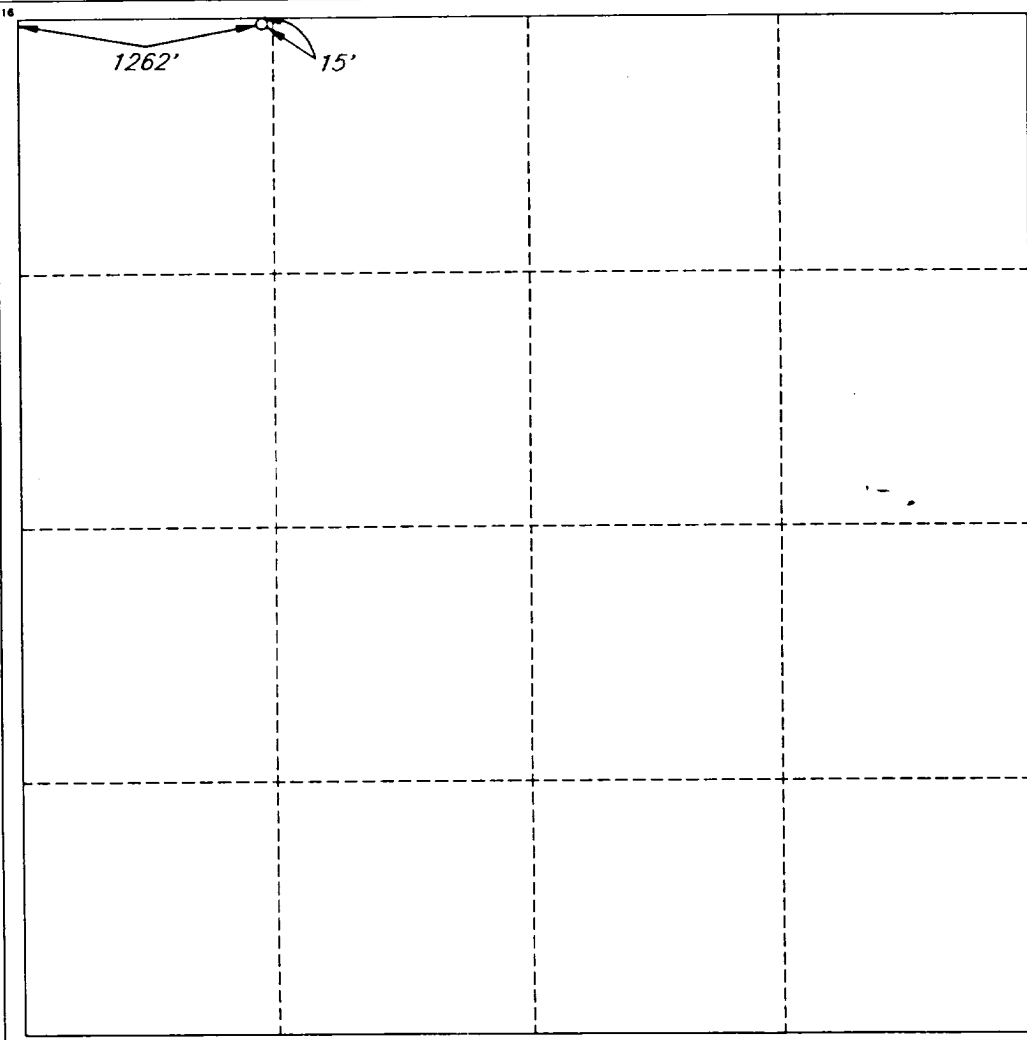
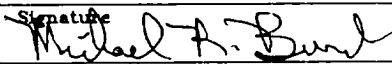
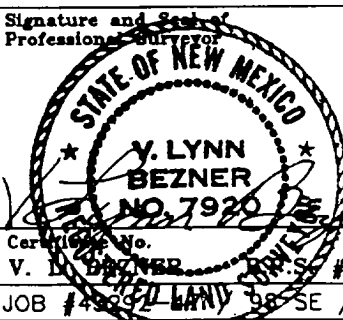
1 API Number 30-015-29184		2 Pool Code 28509		3 Pool Name Grayburg Jackson 7-Rivers QN GB SA					
4 Property Code 017540		5 Property Name SKELLY UNIT 'D'						6 Well Number 263	
7 OGRID No. 022922		8 Operator Name THE WISER OIL COMPANY						9 Elevation 3819'	
10 SURFACE LOCATION									
UL or lot no. D	Section 27	Township 17 SOUTH	Range 31 EAST, N.M.P.M.	Lot Ida	Feet from the 15'	North/South line NORTH	Feet from the 1262'	East/West line WEST	County EDDY
11 BOTTOM HOLE LOCATION IF DIFFERENT FROM SURFACE									
UL or lot no.	Section	Township	Range	Lot Ida	Feet from the	North/South line	Feet from the	East/West line	County
12 Dedicated Acres 40		13 Joint or Infill		14 Consolidation Code		15 Order No.			
NO ALLOWABLE WELL BE ASSIGNED TO THIS COMPLETION UNTIL ALL INTERESTS HAVE BEEN CONSOLIDATED OR A NON-STANDARD UNIT HAS BEEN APPROVED BY THE DIVISION									
						<b>OPERATOR CERTIFICATION</b> I hereby certify that the information contained herein is true and complete to the best of my knowledge and belief.			
						Signature 			
						Printed Name Michael R. Burch, CPL			
						Title Agent for The Wiser Oil Company			
						Date 8-19-96			
						<b>SURVEYOR CERTIFICATION</b> I hereby certify that the well location shown on this plat was plotted from field notes of actual surveys made by me or under my supervision, and that the same is true and correct to the best of my belief.			
						Date of Survey JANUARY 17, 1998			
						Signature and Seal of Professional Surveyor 			
						Certificate No. V. L. BEZNER, P.S. #7920			
						JOB #49662 LANY SE / VHB			

12"1900 Cameron SS Space Saver  
3000# Working Pressure  
3000# Working Pressure Choke Manifold

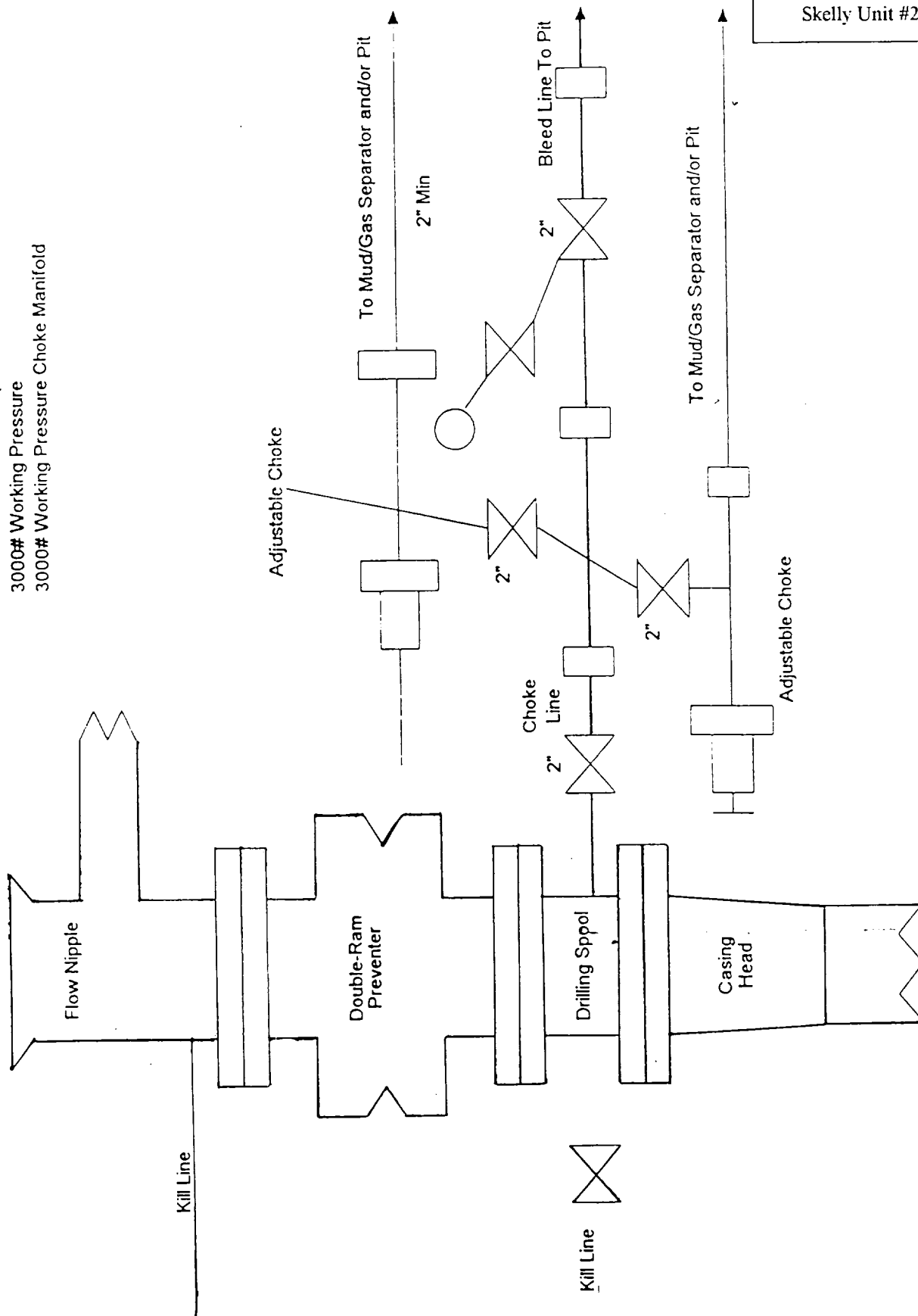

The Wiser Oil Company  
Skelly Unit #263