

UNITED STATES
DEPARTMENT OF THE INTERIOR
BUREAU OF LAND MANAGEMENT

APPLICATION FOR PERMIT TO DRILL OR DEEPEN

1a. TYPE OF WORK

DRILL ☒

DEEPEN ☐

b. TYPE OF WELL

OIL
WELL ☐

GAS
WELL ☐

OTHER

Water Injection

SINGLE
ZONE ☐

MULTIPLE
ZONE ☐

2. NAME OF OPERATOR

The Wiser Oil Company (22922)

3. ADDRESS AND TELEPHONE NO.

c/o J. O. Easley, Inc., P. O. Box 245, Artesia, NM 88211-0245 (505) 746-1070

4. LOCATION OF WELL (Report location clearly and in accordance with any State requirements. *)

At Surface 1980' FNL & 560' FWL, Unit E

At proposed prod. Zone 1980' FNL & 560' FWL, Unit E

14. DISTANCE IN MILES AND DIRECTION FROM NEAREST TOWN OR POST OFFICE*

± 5.5 miles east of Loco Hills, New Mexico

15. DISTANCE FROM PROPOSED *
LOCATION TO NEAREST

PROPERTY OR LEASE LINE, FT. 560'
(Also to nearest drlg. unit line, if any)

18. DISTANCE FROM PROPOSED LOCATION *

TO NEAREST WELL, DRILLING, COMPLETED 184'
OR APPLIED FOR, ON THIS LEASE, FT.

21. ELEVATIONS (Show whether DF, RT, GR, etc.)

3761'

16. NO. OF ACRES IN LEASE

1920.00

17. NO. OF ACRES ASSIGNED
TO THIS WELL

40

20. ROTARY OR CABLE TOOLS

Rotary

22. APPROX. DATE WORK WILL START *

5-1-97

23. PROPOSED CASING AND CEMENTING PROGRAM OR OTHER SPECIAL REQUIREMENTS

ROSWELL CONTROLLED WATER BASIN

SIZE OF HOLE	GRADE, SIZE OF CASING	WEIGHT PER FOOT	SETTING DEPTH	QUANTITY OF CEMENT
12 1/4"	8 5/8" 8RD X-42	20#	350'	Circulate to surface
7 7/8"	5 1/2" J-55	17#	4800'	Circulate

Duration of Program: Drilling - Nine (9) days
Completion - Thirty (30) days
See attached for complete Drilling Program

APPROVAL SUBJECT TO
GENERAL REQUIREMENTS AND
SPECIAL STIPULATIONS
ATTACHED

EXHIBITS

Exhibit "A": Drilling Program

Exhibit "D": Land Survey Plat

Exhibit "G": Rig Layout

Exhibit "B": H₂S Plan

Exhibit "E": Vicinity Plat

Exhibit "H": BOP Layout

Exhibit "C": Surface Use Plan

Exhibit "F": Existing Well Plat

IN ABOVE SPACE DESCRIBE PROPOSED PROGRAM: If proposal is to deepen, give data on present productive zone and proposed new productive zone. If proposal is to drill or deepen directionally, give pertinent data on subsurface locations and measured and true vertical depths. Give blowout preventer program, if any.

24.

SIGNED

Michael R. Burch, CPL

TITLE

Agent for The Wiser Oil Company

DATE

3-5-97

(This space for Federal or State office use)

PERMIT NO.

APPROVAL DATE

Application approval does not warrant or certify that the applicant holds legal or equitable title to those rights in the subject lease which would entitle the applicant to conduct operations thereon.

CONDITIONS OF APPROVAL, IF ANY:

(ORIG. SGD. ONLY - RETURN TO BUREAU)

APPROVED BY

TITLE

ADM. GENERAL

DATE

4/4/97

*See Instructions On Reverse Side

Title 18 U.S.C. Section 1001, makes it a crime for any person knowingly and willfully to make to any department or agency of the United States any false, fictitious or fraudulent statements or representations as to any matter within its jurisdiction.

DISTRICT I
P.O. Box 1990, Hobbs, NM 88241-1990

DISTRICT II
P.O. Drawer DD, Artesia, NM 88211-0719

DISTRICT III
1000 Rio Brazos Rd., Aztec, NM 87410

DISTRICT IV
P.O. BOX 2088, SANTA FE, N.M. 87504-2088

State of New Mexico
Energy, Minerals and Natural Resources Department

EXHIBIT "D"

Form C-102
Revised February 10, 1994
Submit to Appropriate District Office
State Lease - 4 Copies
Fee Lease - 3 Copies

OIL CONSERVATION DIVISION
P.O. Box 2088
Santa Fe, New Mexico 87504-2088

☐ AMENDED REPORT

WELL LOCATION AND ACREAGE DEDICATION PLAT

API Number 30-015-	Pool Code 28509	Pool Name Grayburg Jackson 7-Rivers ON GB SA
Property Code 017540	Property Name SKELLY UNIT	Well Number 301
OGRD No. 022922	Operator Name THE WISER OIL COMPANY	Elevation 3761'

Surface Location

UL or lot No. E	Section 28	Township 17 S	Range 31 E	Lot Idn	Feet from the 1980	North/South line NORTH	Feet from the 560	East/West line WEST	County EDDY
---------------------------	----------------------	-------------------------	----------------------	---------	------------------------------	----------------------------------	-----------------------------	-------------------------------	-----------------------

Bottom Hole Location If Different From Surface

UL or lot No.	Section	Township	Range	Lot Idn	Feet from the	North/South line	Feet from the	East/West line	County
Dedicated Acres 40	Joint or Infill	Consolidation Code	Order No.						

NO ALLOWABLE WILL BE ASSIGNED TO THIS COMPLETION UNTIL ALL INTERESTS HAVE BEEN CONSOLIDATED
OR A NON-STANDARD UNIT HAS BEEN APPROVED BY THE DIVISION

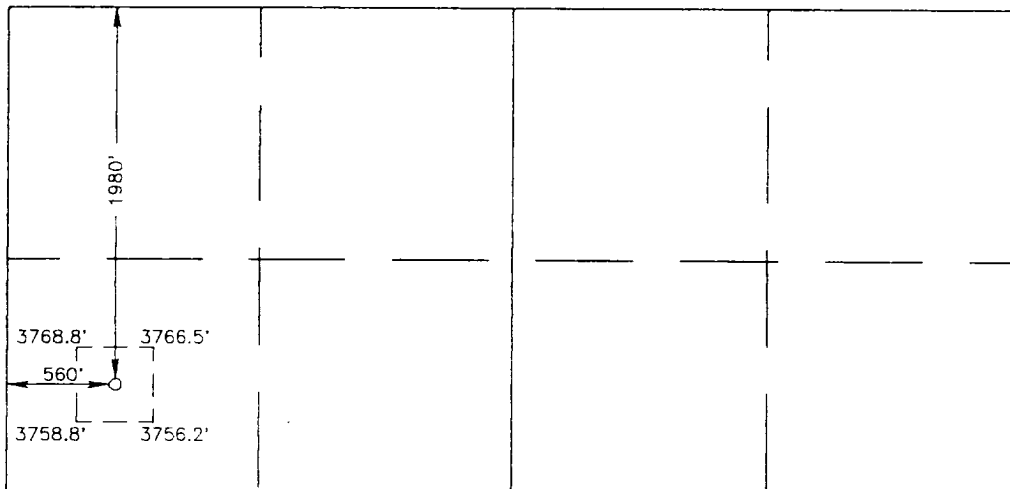
	<p>OPERATOR CERTIFICATION</p> <p>I hereby certify that the information contained herein is true and complete to the best of my knowledge and belief.</p> <p><i>Michael R. Burch</i> Signature</p> <p>Michael R. Burch, CPL Printed Name</p> <p>Agent for The Wisser Oil Company Title</p> <p>2-7-97 Date</p>
	<p>SURVEYOR CERTIFICATION</p> <p>I hereby certify that the well location shown on this plat was plotted from field notes of actual surveys made by me or under my supervision and that the same is true and correct to the best of my belief.</p> <p>FEBRUARY 1, 1997 Date Surveyed</p> <p>J. EIDSON Signature & Seal of Professional Surveyor</p> <p>CDG</p> <p>3289 Certificate No.</p> <p>JOHN W. EIDSON Professional Surveyor</p> <p>676 3239 12641</p>

BOP & CHOKE MANIFOLD

12"/900 Cameron SS Space Saver
3000# Working Pressure
3000# Working Pressure Choke Manifold

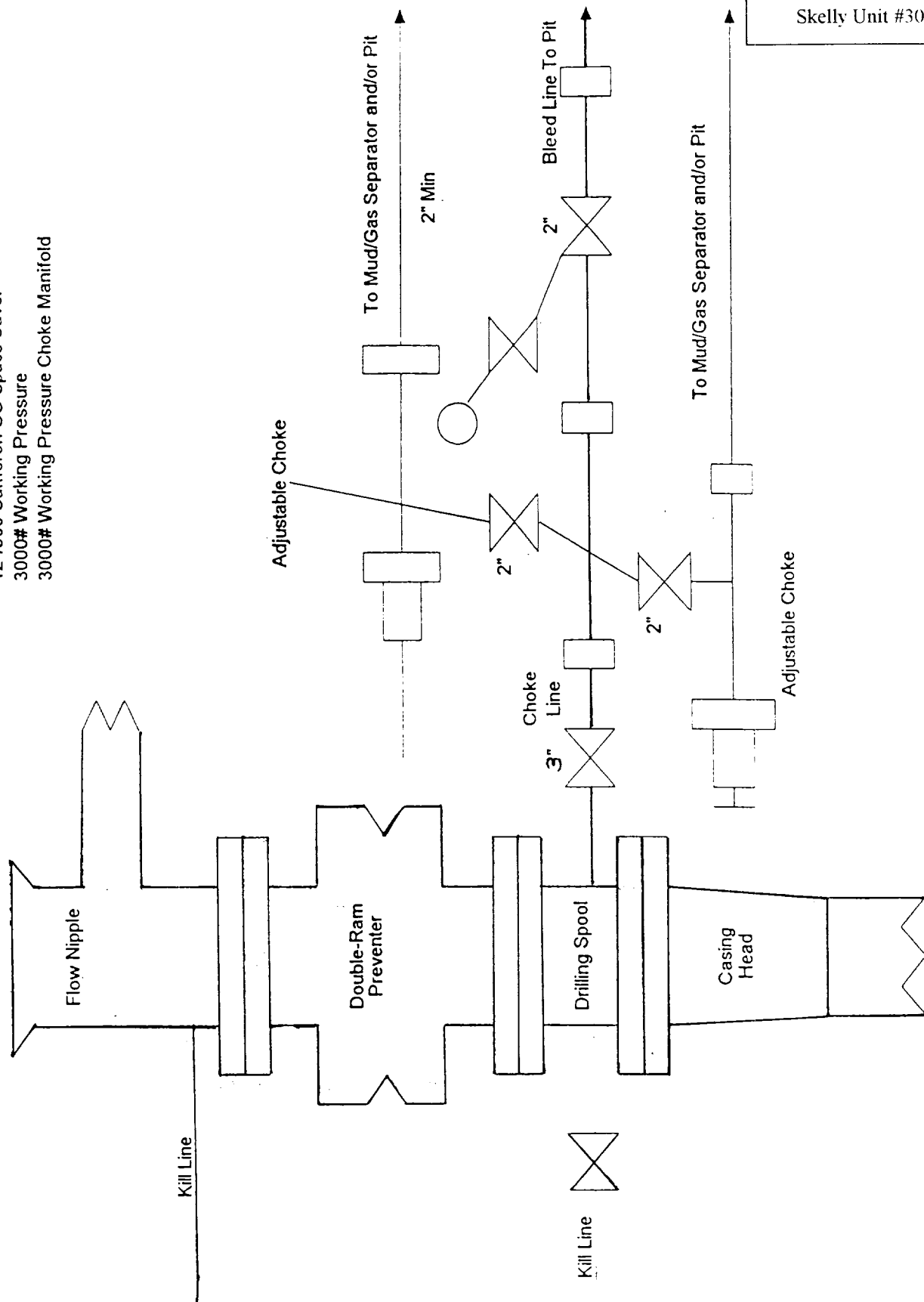

EXHIBIT "H"

BOP LAYOUT

The Wiser Oil Company
Skelly Unit #301