

DISTRICT I  
P. O. Box 1980  
Hobbs, NM 88241-1980

State of New Mexico  
Energy Minerals, and Natural Resources Department

Form C-102  
Revised 02-10-94  
Instructions on back

DISTRICT II  
P. O. Drawer DD  
Artesia, NM 88211-0719

**OIL CONSERVATION DIVISION**  
P. O. Box 2088  
Santa Fe, New Mexico 87504-2088

Submit to the Appropriate  
District Office  
State Lease - 4 copies  
Fee Lease - 3 copies

☐ AMENDED REPORT

DISTRICT III  
1000 Rio Brazos Rd.  
Aztec, NM 87410

DISTRICT IV  
P. O. Box 2088  
Santa Fe, NM 87507-2088

**WELL LOCATION AND ACREAGE DEDICATION PLAT**

|  |               |   |                            |                                 |                       |                           |                        |                        |                |
|--|---------------|---|----------------------------|---------------------------------|-----------------------|---------------------------|------------------------|------------------------|----------------|
| 1 API Number                                     |               | 2 Pool Code   |                            | 3 Pool Name<br>Grayburg Jackson |                       |                           |                        |                        |                |
| 4 Property Code<br>15966                         |               | 5 Property Name<br>TURNER 'B'                         |                            |                                 |                       |                           | 6 Well Number<br>111   |                        |                |
| 7 OGRID No.<br>136025                            |               | 8 Operator Name<br>DEVON ENERGY OPERATING CORPORATION |                            |                                 |                       |                           | 9 Elevation<br>3639'   |                        |                |
| 10 SURFACE LOCATION                              |               |   |                            |                                 |                       |                           |                        |                        |                |
| UL or lot no.<br>0                               | Section<br>30 | Township<br>17 SOUTH                                  | Range<br>31 EAST, N.M.P.M. | Lot Ida                         | Feet from the<br>330' | North/South line<br>SOUTH | Feet from the<br>1950' | East/West line<br>EAST | County<br>EDDY |
| "BOTTOM HOLE LOCATION IF DIFFERENT FROM SURFACE" |               |   |                            |                                 |                       |                           |                        |                        |                |
| UL or lot no.                                    | Section       | Township  | Range                      | Lot Ida                         | Feet from the         | North/South line          | Feet from the          | East/West line         | County         |
| 12 Dedicated Acres<br>40                         |               | 13 Joint or Infill                                    |                            | 14 Consolidation Code           |                       | 15 Order No.              |                        |                        |                |

NO ALLOWABLE WELL BE ASSIGNED TO THIS COMPLETION UNTIL ALL INTERESTS HAVE BEEN CONSOLIDATED OR A NON-STANDARD UNIT HAS BEEN APPROVED BY THE DIVISION

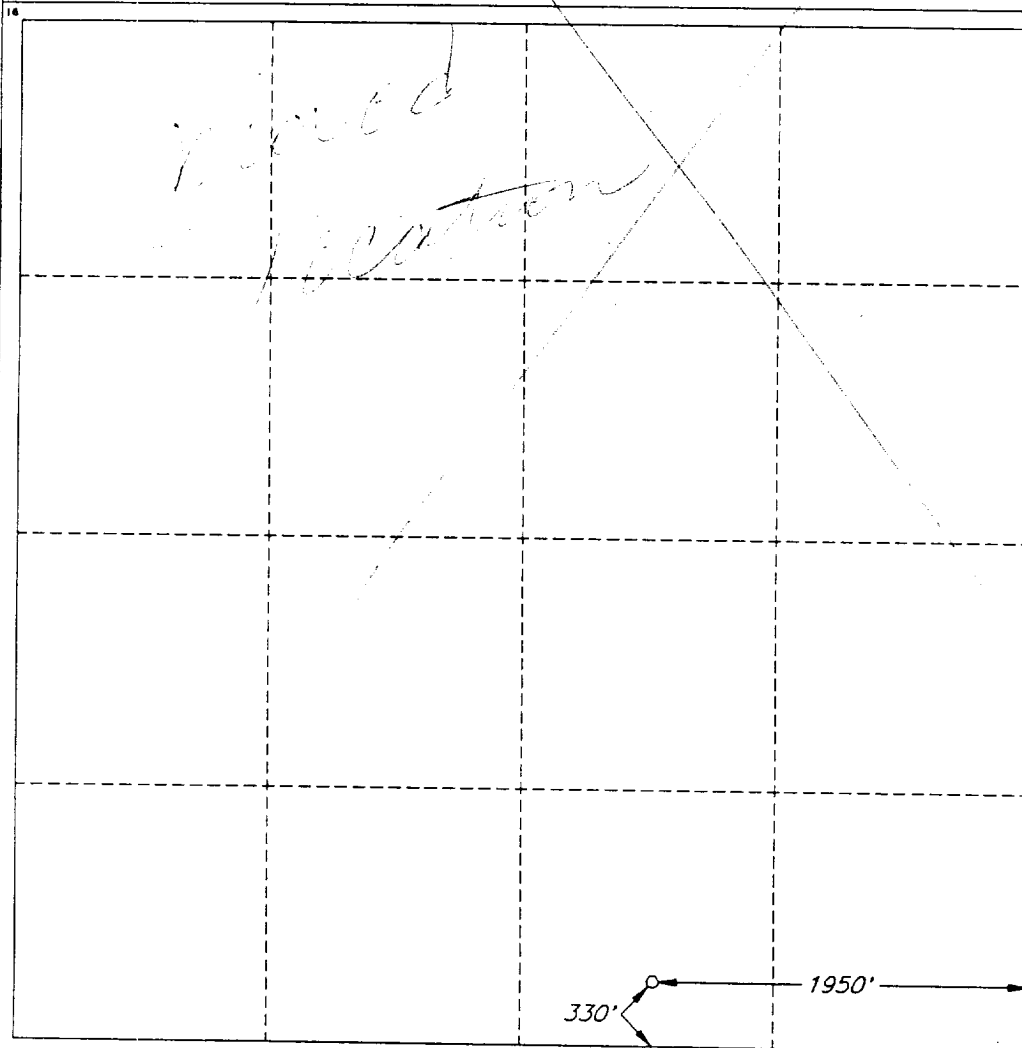

**OPERATOR CERTIFICATION**

I hereby certify that the information contained herein is true and complete to the best of my knowledge and belief.

Signature

Printed Name

Randy Jackson

Title

District Engineer

Date

**SURVEYOR CERTIFICATION**

I hereby certify that the well location shown on this plat was plotted from field notes of actual surveys made by me or under my supervision, and that the same is true and correct to the best of my belief.

Date of Survey

JUNE 22, 1995

Signature and Seal of Professional Surveyor

V. LYNN  
BEZNER  
NO. 7920

Certified by  
V. L. BEZNER R.P.S. #7920

JOB #40156-5 / 98 SW / V.H.B.