

District I
PO Box 1980, Hobbs, NM 88241-1980

District II
PO Drawer DD, Artesia, NM 88211-0719

District III
1000 Rio Brazos Rd., Aztec, NM 87410

District IV
PO Box 2088, Santa Fe, NM 87504-2088

State of New Mexico
Energy, Minerals & Natural Resources Department.

OIL CONSERVATION DIVISION
PO Box 2088
Santa Fe, NM 87504-2088

Form C-101
Revised February 10, 1994
Instructions on back
Submit to Appropriate District Office
State Lease - 6 Copies
Fee Lease - 5 Copies

AMENDED REPORT

APPLICATION FOR PERMIT TO DRILL, RE-ENTER, DEEPEN, PLUG BACK, OR ADD A ZONE

¹ Operator Name and Address. Devon Energy Corporation (Nevada) 1500 Mid America Tower 20 N. Broadway Oklahoma City, OK 73102-8260		¹ OGRID Number 6137
⁴ Property Code 22549		³ API Number 30-015-30681
⁵ Property Name KAISER		⁶ Well No. 1

⁷ Surface Location

UL or lot no. A	Section 18	Township 18S	Range 27E	Lot Ids	Feet from the 330	North/South line North	Feet from the 1110	East/West line East	County Eddy
--------------------	---------------	-----------------	--------------	---------	----------------------	---------------------------	-----------------------	------------------------	----------------

⁸ Proposed Bottom Hole Location If Different From Surface

UL or lot no.	Section	Township	Range	Lot Ids	Feet from the	North/South line	Feet from the	East/West line	County
⁹ Proposed Pool 1 Red Lake; Glorieta-Yeso, NB (9-693-6) S1120						¹⁰ Proposed Pool 2 Red Lake; Q-GB-SA (51300)			

¹¹ Work Type Code N	¹² Well Type Code O	¹³ Cable/Rotary Rotary	¹⁴ Lease Type Code S	¹⁵ Ground Level Elevation 3286'
¹⁶ Multiple No	¹⁷ Proposed Depth 4500'	¹⁸ Formation Glorieta-Yeso	¹⁹ Contractor Unknown	²⁰ Spud Date 7-15-99

²¹ Proposed Casing and Cement Program

Hole Size	Casing Size	Casing weight/foot	Setting Depth	Sacks of Cement	Estimated TOC
17 1/2"	13 3/8"	Conductor	200'	275 sxs "C"	surface
12 1/4"	8 5/8"	24 ppf	950'	350 lite, 200 "C"	surface
7 7/8"	5 1/2"	15.5 ppf	4500'	200 lite, 400 "C"	surface

²² Describe the proposed program. If this application is to DEEPEN or PLUG BACK give the data on the present productive zone and proposed new productive zone. Describe the blowout prevention program, if any. Use additional sheets if necessary.
We plan to drill this well to a total depth of +/- 4500' and complete it as an oil well. If the well is deemed non-commercial, then it will be plugged and abandoned in accordance with the rules established by the OCD of New Mexico. BOP's will be installed while drilling the production hole.

Post ID-1
7-2-99
HPI + LOC

²³ I hereby certify that the information given above is true and complete to the best of my knowledge and belief.		OIL CONSERVATION DIVISION	
Signature: <i>E. L. Buttross, Jr.</i>		Approved by: ORIGINAL SIGNED BY TIM W. GUM	
Printed name: E. L. Buttross Jr.		Title: DISTRICT II SUPERVISOR	
Title: District Engineer		Approval Date: 6-24-99	
Date: 6/23/99		Expiration Date: 2-4-00	
Phone: (405) 235-3611 x 4509		Conditions of Approval:	
		Attached <input type="checkbox"/>	

DISTRICT I
P.O. Box 1980, Hobbs, NM 88240

DISTRICT II
P.O. Drawer DD, Artesia, NM 88210

DISTRICT III
1000 Rio Brazos Rd., Aztec, NM 87410

State of New Mexico
Energy, Minerals and Natural Resources Department

Form C-102
Revised February 10, 1994
Instruction on back
Submit to Appropriate District Office
State Lease - 4 Copies
Fee Lease - 3 Copies

OIL CONSERVATION DIVISION

P.O. Box 2088
Santa Fe, New Mexico 87504-2088

☐ AMENDED REPORT

WELL LOCATION AND ACREAGE DEDICATION PLAT

API Number	Pool Code	96836	Pool Name	51300
		Red Lake;Glorieta-Yeso, NE & Red Lake;Q-GB-SA		
Property Code	Property Name			Well Number
	KAISER			1
OGRID No.	Operator Name			Elevation
	DEVON ENERGY CORPORATION			3286'

Surface Location

UL or lot No.	Section	Township	Range	Lot Idn	Feet from the	North/South line	Feet from the	East/West line	County
A	18	18 S	27 E		330	NORTH	1110	EAST	EDDY

Bottom Hole Location If Different From Surface

UL or lot No.	Section	Township	Range	Lot Idn	Feet from the	North/South line	Feet from the	East/West line	County

Dedicated Acres	Joint or Infill	Consolidation Code	Order No.

NO ALLOWABLE WILL BE ASSIGNED TO THIS COMPLETION UNTIL ALL INTERESTS HAVE BEEN CONSOLIDATED
OR A NON-STANDARD UNIT HAS BEEN APPROVED BY THE DIVISION

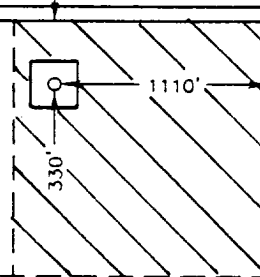
				OPERATOR CERTIFICATION I hereby certify the the information contained herein is true and complete to the best of my knowledge and belief. <u>E. L. Buttross, Jr.</u> Signature <u>E. L. Buttross, Jr.</u> Printed Name District Engineer _____ Title 1/23/98 Date	
				SURVEYOR CERTIFICATION I hereby certify that the well location shown on this plat was plotted from field notes of actual surveys made by me or under my supervision, and that the same is true and correct to the best of my belief. January 21, 1998 Date Surveyed <u>GARY L JONES</u> Signature & Seal of Professional Surveyor <u>7977</u> W.O. No. 8028A Certificate No. Gary L. Jones 7977 BASIN SURVEYS	

SECTION 18, TOWNSHIP 18 SOUTH, RANGE 27 EAST, N.M.P.M.,
EDDY COUNTY, NEW MEXICO.

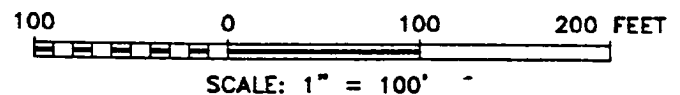
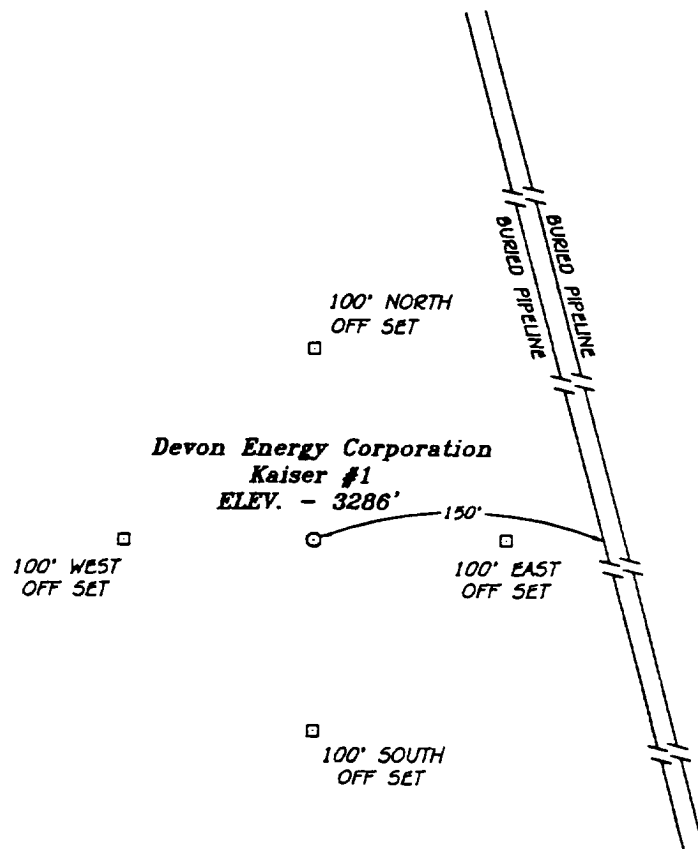

DEVON ENERGY CORP.

REF: Kaiser #1/ Well Pad Topo

THE KAISER No. 1 LOCATED 330' FROM THE
NORTH LINE AND 1110' FROM THE EAST LINE OF
SECTION 18, TOWNSHIP 18 SOUTH, RANGE 27 EAST,
N.M.P.M., EDDY COUNTY, NEW MEXICO.

BASIN SURVEYS P.O. BOX 1786-HOBBS, NEW MEXICO

W.O. Number: 8028 Drawn By: K. GOAD

DATE: 01-21-98 Disk: KJG #83 - 8023A.DWG

Survey Date: 01-21-98

Sheet 1 of 1 Sheets

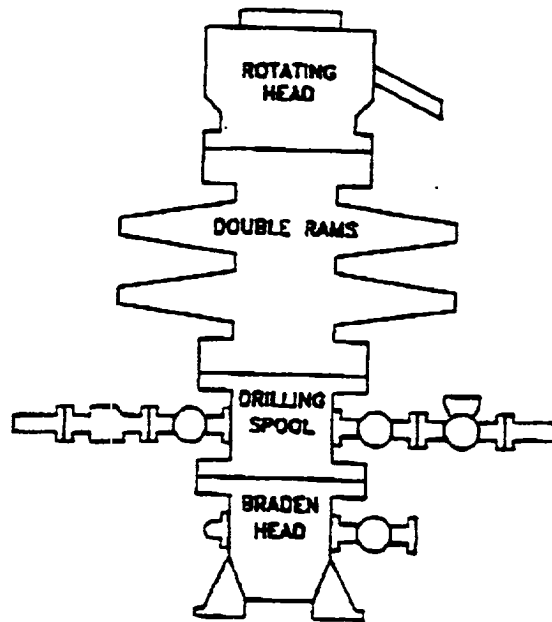

CHOKE MANIFOLD REQUIREMENT (2000 psi WP)

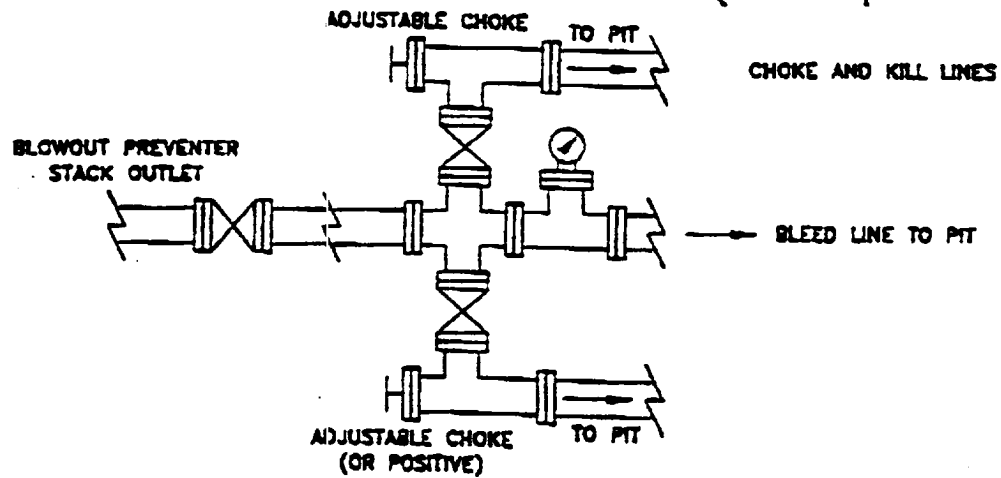

devon

WEST RED LAKE

NEW CONCEPT, NEW DESIGN

BLOWOUT PREVENTOR

(2000 PSI WORKING WP)

WB-100P	