

UNITED STATES
DEPARTMENT OF THE INTERIOR
BUREAU OF LAND MANAGEMENT

APPLICATION FOR PERMIT TO DRILL OR DEEPEN

1a. TYPE OF WORK DRILL <input checked="" type="checkbox"/> DEEPEN <input type="checkbox"/>		5. LEASE DESIGNATION AND SERIAL NO. NM-14846
b. TYPE OF WELL OIL WELL <input checked="" type="checkbox"/> GAS WELL <input type="checkbox"/> OTHER <input type="checkbox"/>		6. IF INDIAN, ALLOTTEE OR TRIBE NAME
2. NAME OF OPERATOR Louis Dreyfus Natural Gas Corporation 25773		7. UNIT AGREEMENT NAME 17613
3. ADDRESS AND TELEPHONE NO. (405) 749-1300 14000 Quail Springs Parkway, Suite 600, Oklahoma City, OK 73134		8. FARM OR LEASE NAME, WELL NO. Loco Hills 4 Federal #4
4. LOCATION OF WELL (Report location clearly and in accordance with any State requirements.)* At surface 990' FNL & 990' FEL (NE/4 NE/4) At proposed prod. zone Unit A		9. API WELL NO. 30-015-31024
14. DISTANCE IN MILES AND DIRECTION FROM NEAREST TOWN OR POST OFFICE* 18 Miles Southeast of Artesia, NM		10. FIELD AND POOL, OR WILDCAT Jones Gray Butte; Loco Hills UPPER PENN
15. DISTANCE FROM PROPOSED* LOCATION TO NEAREST PROPERTY OR LEASE LINE, FT. (Also to nearest drlg. unit line, if any) 990' FEL	16. NO. OF ACRES IN LEASE 160	11. SEC., T., R., M., OR BLK. AND SURVEY OR AREA Sec. 4-T18S-R29E
18. DISTANCE FROM PROPOSED LOCATION* TO NEAREST WELL, DRILLING, COMPLETED, OR APPLIED FOR, ON THIS LEASE, FT. N/A	19. PROPOSED DEPTH 9,800'	12. COUNTY OR PARISH Eddy
21. ELEVATIONS (Show whether DF, RT, GR, etc.) 3525'		13. STATE NM
22. APPROX. DATE WORK WILL START* 4/1/2000		

PROPOSED CASING AND CEMENTING PROGRAM

SIZE OF HOLE	GRADE, SIZE OF CASING	WEIGHT PER FOOT	SETTING DEPTH	QUANTITY OF CEMENT
17 1/2"	13 3/8" J5S	54.5#	400'	360 sxs - Surface
11"	8 5/8" K55	32#	3100'	995 sxs - Surface
7 7/8"	5 1/2" N80	11.6#	9800'	375 sxs - Est TOC 7000'

- A. Drill 17 1/2" hole to 400'. Set 13 3/8" surface casing at 400' with 360 sxs cement.
- B. Drill 11" hole to 3100', set 8 5/8" intermediate casing at 3100'. Cement with 795 sxs 35:65 POZ/C tail in with 200 sxs Class C.
- C. Drill 7 7/8" hole to 9800'. Set 5 1/2" production casing at 9800'. Cement with 375 sxs modified H .3% D 156.

APPROVAL SUBJECT TO
GENERAL REQUIREMENTS AND
SPECIAL STIPULATIONS
ATTACHED

IN ABOVE SPACE DESCRIBE PROPOSED PROGRAM: If proposal is to deepen, give data on present productive zone and proposed new productive zone. If proposal is to drill or deepen directionally, give pertinent data on subsurface locations and measured and true vertical depths. Give blowout preventer program, if any.

24. SIGNED Carla Christian TITLE Regulatory Technician DATE 2-17-00

(This space for Federal or State office use)

PERMIT NO. _____ APPROVAL DATE _____

Application approval does not warrant or certify that the applicant holds legal or equitable title to those rights in the subject lease which would entitle the applicant to conduct operations thereon.
CONDITIONS OF APPROVAL, IF ANY:

APPROVED BY /S/LARRY D. GRAY TITLE Assistant Field Manager, Lands And Minerals DATE MAR 10 2000

*See Instructions On Reverse Side

DISTRICT III
1000 Rio Brazos Rd., Artec. NM 87410

State of New Mexico
Energy, Minerals and Natural Resources Department

OIL CONSERVATION DIVISION

P.O. Box 2088
Santa Fe, New Mexico 87504-2088

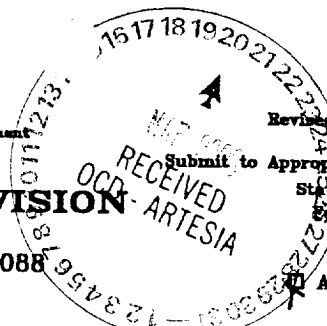

Form C-102
Revised February 10, 1994
Instruction on back
Appropriate District Office
State Lease - 4 Copies
See Lease - 3 Copies

AMENDED REPORT

WELL LOCATION AND ACREAGE DEDICATION PLAT

API Number		Pool Code	Pool Name	
			Upper Penn	
Property Code	Property Name			Well Number
24932	LOCO HILLS "4" FEDERAL			4
OGRID No.	Operator Name			Elevation
025773	LOUIS DREYFUS NATURAL GAS CORPORATION			3525'

Surface Location

UL or lot No.	Section	Township	Range	Lot Idn	Feet from the	North/South line	Feet from the	East/West line	County
A	4	18 S	29 E		990	NORTH	990	EAST	EDDY

Bottom Hole Location If Different From Surface

UL or lot No.	Section	Township	Range	Lot Idn	Feet from the	North/South line	Feet from the	East/West line	County
Dedicated Acres	Joint or Infill	Consolidation Code		Order No.					
40	N								

NO ALLOWABLE WILL BE ASSIGNED TO THIS COMPLETION UNTIL ALL INTERESTS HAVE BEEN CONSOLIDATED
OR A NON-STANDARD UNIT HAS BEEN APPROVED BY THE DIVISION

	<p> 990' 3527.0' 3524.9' 990' 3526.6' 3525.6' </p> <p> Lat.: N32°46'51.8" Long.: W104°04'27.9" </p>	<p>OPERATOR CERTIFICATION</p> <p><i>I hereby certify the the information contained herein is true and complete to the best of my knowledge and belief.</i></p> <p><u>Carla Christian</u> Signature</p> <p><u>Carla Christian</u> Printed Name</p> <p><u>Regulatory Technician</u> Title</p> <p><u>3-14-00</u> Date</p>
		<p>SURVEYOR CERTIFICATION</p> <p><i>I hereby certify that the well location shown on this plat was plotted from field notes of actual surveys made by me or under my supervision, and that the same is true and correct to the best of my belief.</i></p> <p><u>January 10, 2000</u> Date Surveyed</p> <p><u>GARY L. JONES</u> Signature & Seal of Professional Surveyor</p> <p><u>W.O. No. 0012A</u> Certificate No. Gary L. Jones 7977</p> <p>BASIN SURVEYS</p>

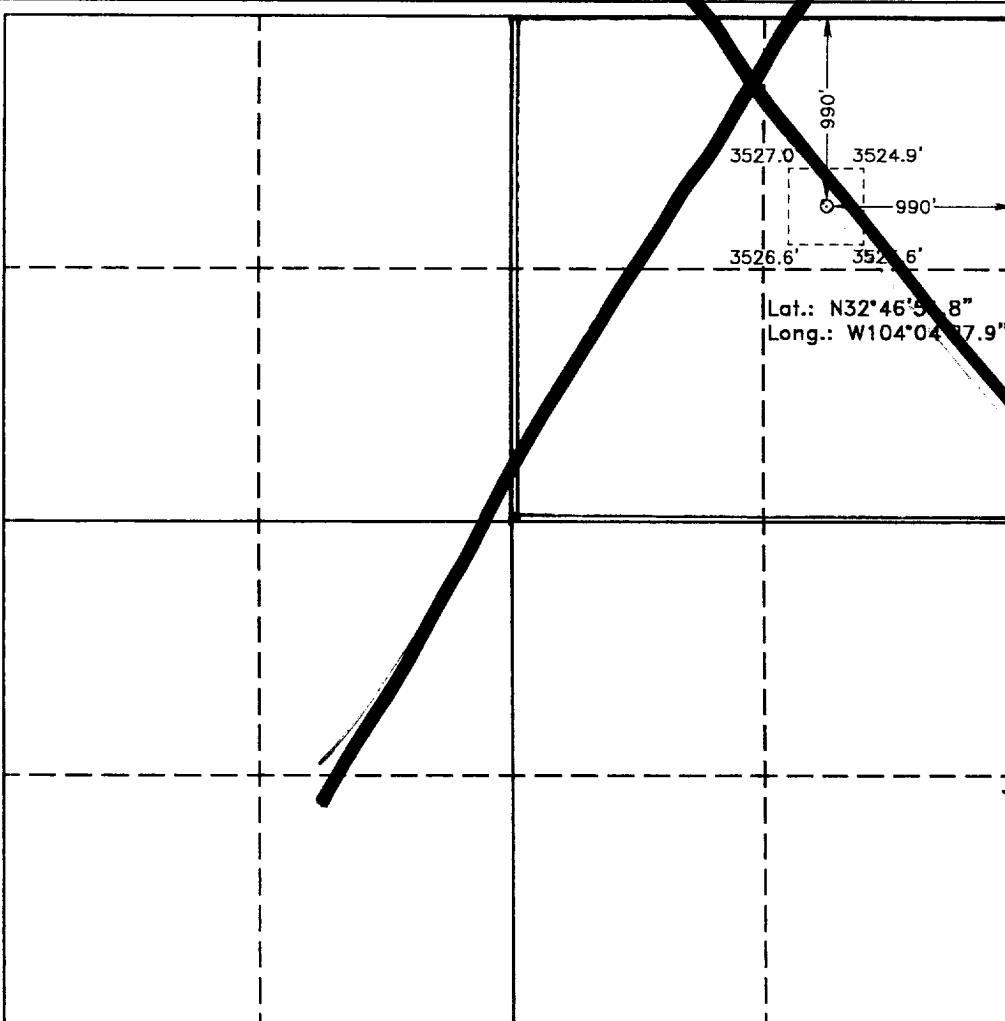
	OPERATOR CERTIFICATION <i>I hereby certify the the information contained herein is true and complete to the best of my knowledge and belief.</i> <u>Carla Christian</u> Signature <u>Carla Christian</u> Printed Name <u>Regulatory Technician</u> Title <u>2-17-00</u> Date
	SURVEYOR CERTIFICATION <i>I hereby certify that the well location shown on this plat was plotted from field notes of actual surveys made by me or under my supervision and that the same is true and correct to the best of my belief.</i> <u>January 10, 2000</u> Date Surveyed <u>[Signature]</u> Signature & Seal of Professional Surveyor <u>W.O. No. 0012A</u> Certificate No. <u>Gary L. Jones</u> 7977 BASIC SURVEYS

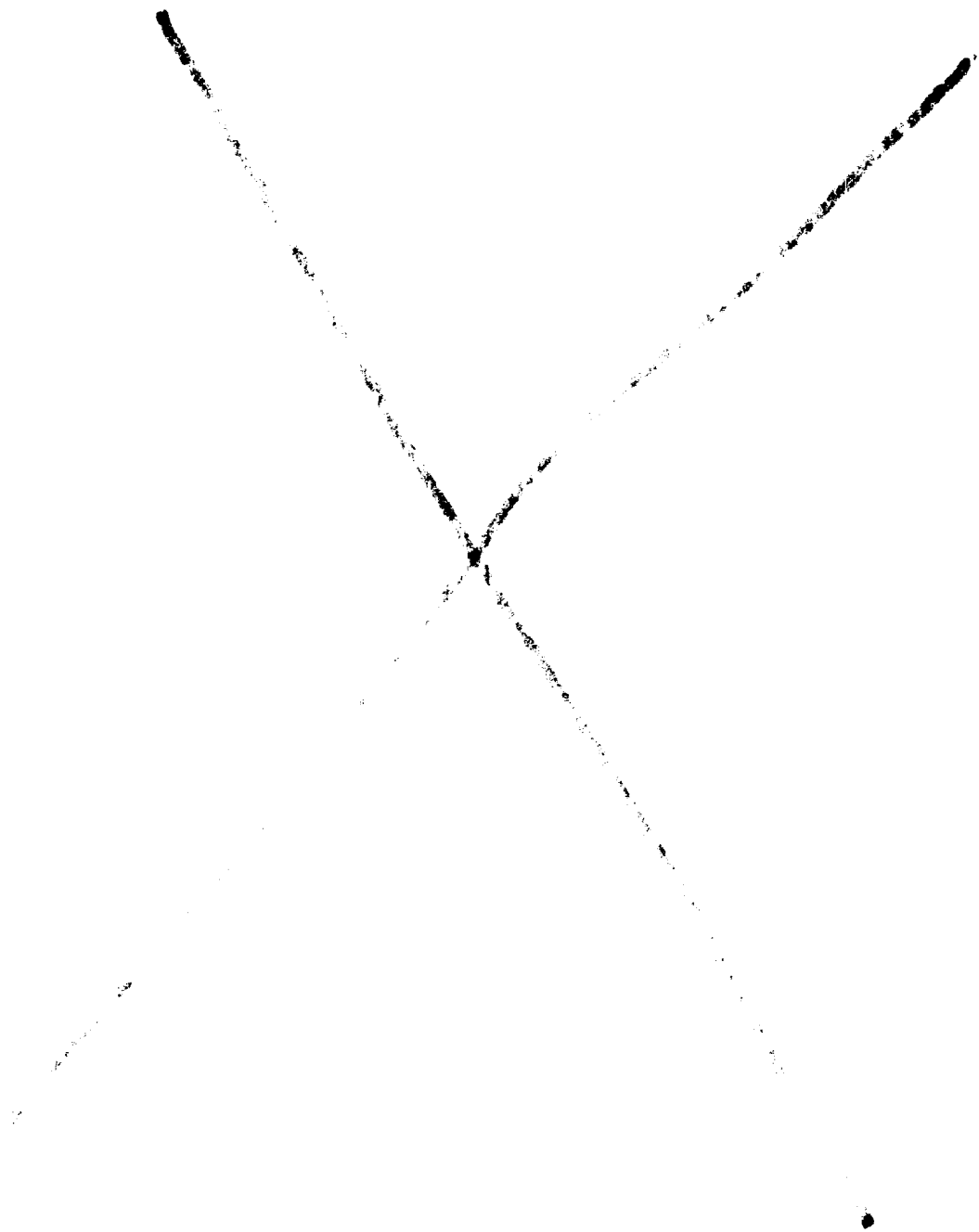
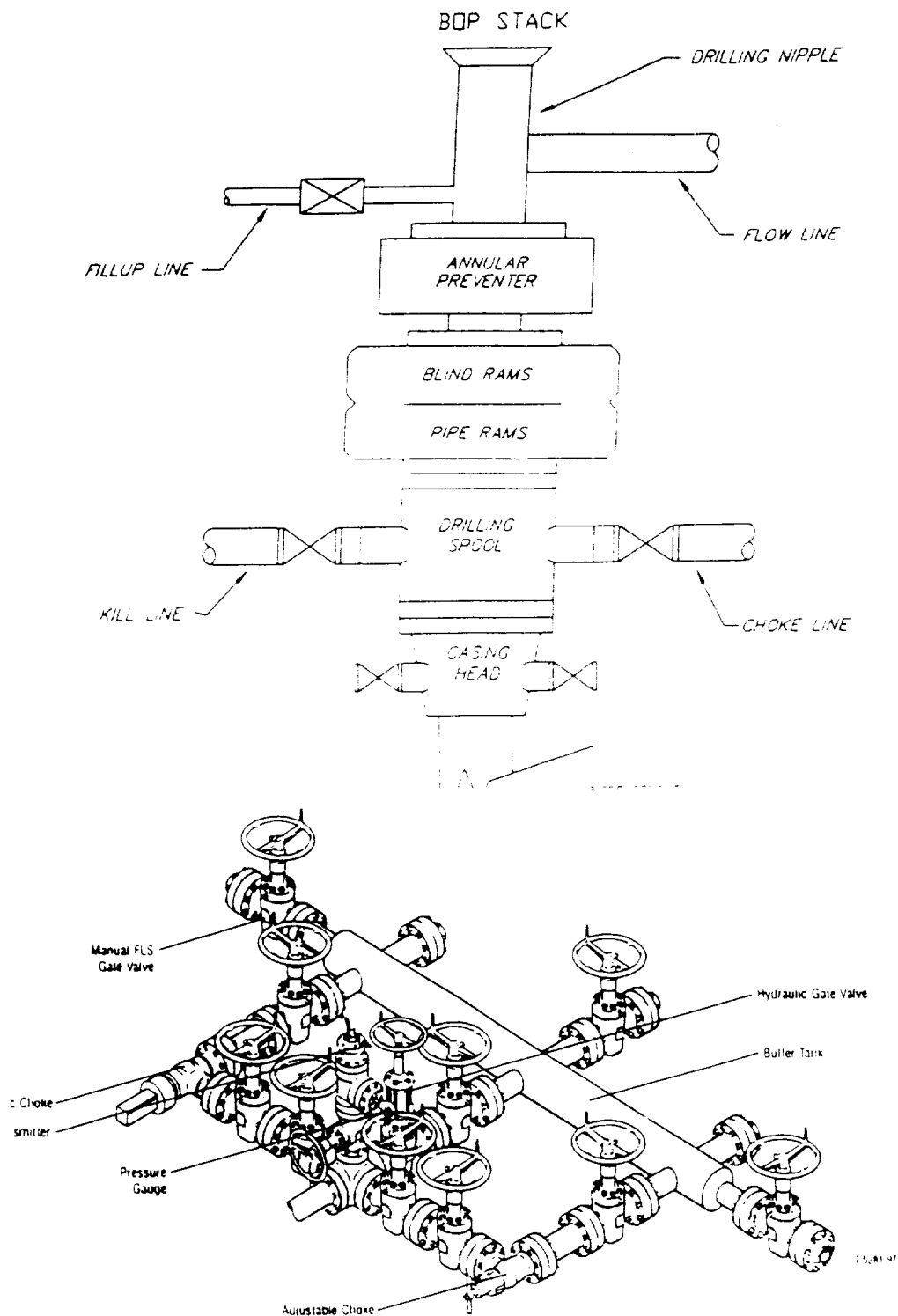

Exhibit 6

TYPICAL 5,000 p.s.i. BLOWOUT PREVENTER & CHOKE MANIFOLD SCHEMATIC



Typical Choke Manifold Designed for Land Drilling Applications

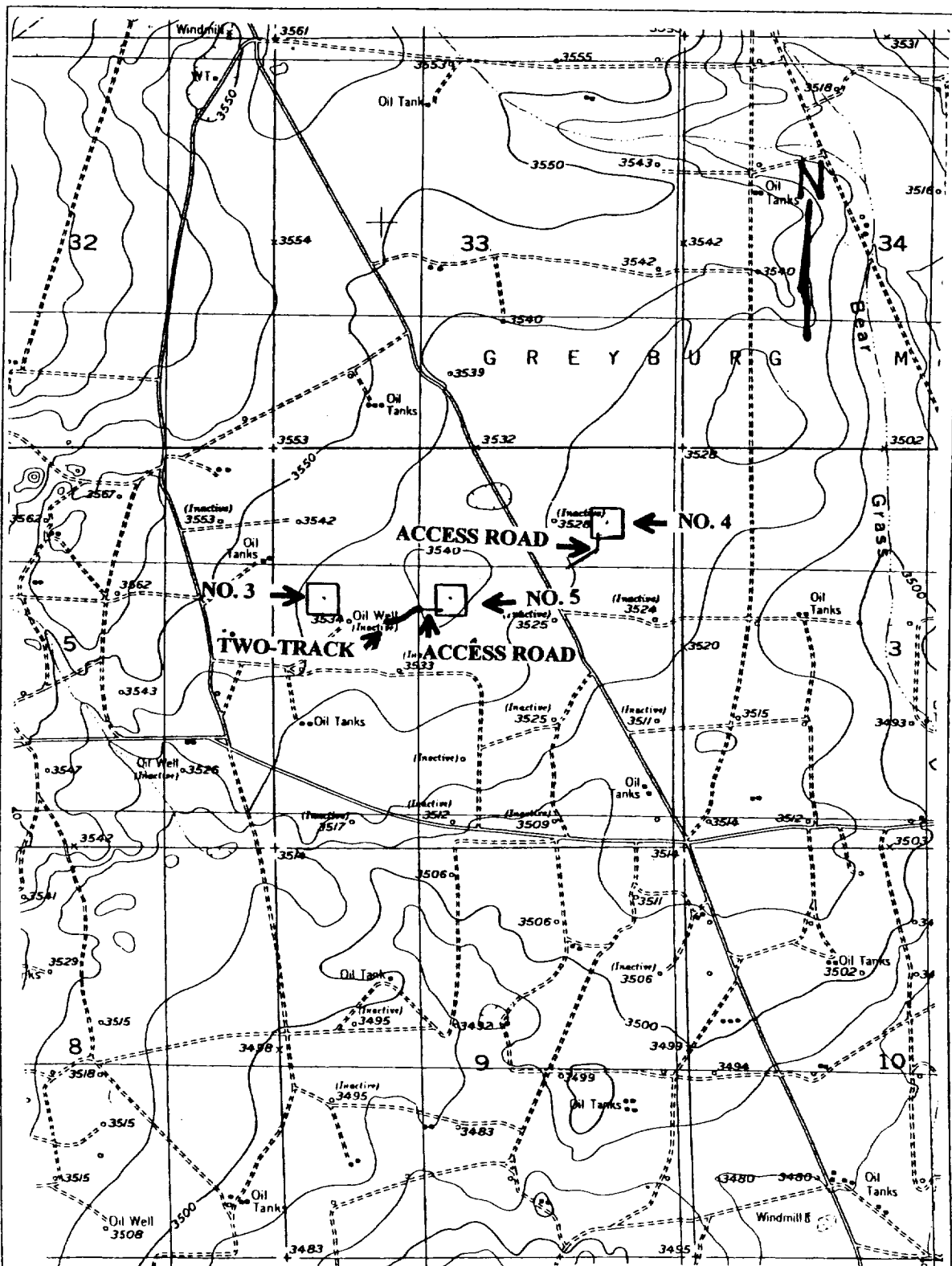

Figure 1. Showing the location of LOUIS DREYFUS NATURAL GAS CORPORATION's proposed Loco Hills "4" Federal Wells Nos. 3 (1980 FNL, 660 FWL), 4 (990 FNL, 990 FEL), and 5 (1980 FNL, 2310 FWL) and associated access roads in Section 4, T18S, R29E NMPM, Eddy County, NM. Map Reference: 7.5' series Red Lake SE, NM (1955), 32104-G1.