

District I  
1625 N. French Dr., Hobbs, NM 88240  
District II  
811 South First, Artesia, NM 88210  
District III  
1000 Rio Brazos Road, Aztec, NM 87410  
District IV  
2040 South Pacheco, Santa Fe, NM 87505

State of New Mexico  
Energy Minerals and Natural Resources

Form C-101  
Revised March 17, 1999

Oil Conservation Division  
2040 South Pacheco  
Santa Fe, NM 87505

Submit to appropriate District Office  
State Lease - 6 Copies  
Fee Lease - 5 Copies

☐ AMENDED REPORT

APPLICATION FOR PERMIT TO DRILL, RE-ENTER, DEEPEN, PLUGBACK, OR ADD A ZONE

<sup>1</sup> Operator Name and Address The Eastland Oil Company P.O. Drawer 3488, Midland, Texas 79702		<sup>2</sup> OGRID Number 022767
		<sup>3</sup> API Number 30 -
<sup>3</sup> Property Code 003908	<sup>5</sup> Property Name Laurel State	<sup>6</sup> Well No. 3

<sup>7</sup> Surface Location

UL or lot no.	Section	Township	Range	Lot Idn	Feet from the	North/South line	Feet from the	East/West line	County
E	7	18-S	28-E		2310	North	330	West	Eddy

<sup>8</sup> Proposed Bottom Hole Location If Different From Surface

UL or lot no.	Section	Township	Range	Lot Idn	Feet from the	North/South line	Feet from the	East/West line	County

<sup>9</sup> Proposed Pool 1

Artesia Queen, GB, SA

<sup>10</sup> Proposed Pool 2

<sup>11</sup> Work Type Code N	<sup>12</sup> Well Type Code 0	<sup>13</sup> Cable/Rotary Cable	<sup>14</sup> Lease Type Code S	<sup>15</sup> Ground Level Elevation 3603
<sup>16</sup> Multiple	<sup>17</sup> Proposed Depth 1700	<sup>18</sup> Formation Queen	<sup>19</sup> Contractor Southeast Drlg.	<sup>20</sup> Spud Date

**Minimum WOC time / 8 hrs.** <sup>21</sup> Proposed Casing and Cement Program

Hole Size	Casing Size	Casing weight/foot	Setting Depth	Sacks of Cement	Estimated TOC
12 1/4"	8 5/8"	24"	480	400 sx Class C	Circulate Surface
8"	5 1/2"	14	1700'	375 sx PP	Circulate "

<sup>22</sup> Describe the proposed program. If this application is to DEEPEN or PLUG BACK, give the data on the present productive zone and proposed new productive zone.  
Describe the blowout prevention program, if any. Use additional sheets if necessary.

Will have Control Head for BOP protection

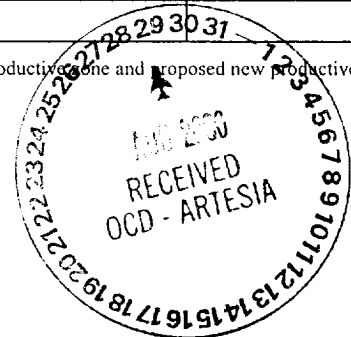

<sup>23</sup> I hereby certify that the information given above is true and complete to the best of my knowledge and belief.		OIL CONSERVATION DIVISION	
Signature: <i>Travis Reed</i>		Approved by: <b>ORIGINAL SIGNED BY TIM W. GUM</b>	
Printed name: Travis Reed		Title: <b>DISTRICT II SUPERVISOR</b>	
Title: Agent		Approval Date: <b>AUG 29 2000</b> Expiration Date: <b>AUG 29 2001</b>	
Date: 8-25-2000	Phone: 915-683-6293	Conditions of Approval: Attached <input type="checkbox"/>	

DISTRICT I  
P.O. Box 1980, Hobbs, NM 88241-1980

State of New Mexico

Energy, Minerals and Natural Resources Department

Form C-102  
Revised February 10, 1994  
Submit to Appropriate District Office  
State Lease - 4 Copies  
Fee Lease - 3 Copies

DISTRICT II  
P.O. Drawer DD, Artesia, NM 88211-0719

DISTRICT III  
1000 Rio Brazos Rd., Artec, NM 87410

DISTRICT IV  
P.O. Box 2068, Santa Fe, NM 87504-2068

OIL CONSERVATION DIVISION

P.O. Box 2088  
Santa Fe, New Mexico 87504-2088

☐ AMENDED REPORT

WELL LOCATION AND ACREAGE DEDICATION PLAT

API Number		Pool Code	Pool Name	
		03230	Artesia Queen, GB, SA	
Property Code	Property Name		Well Number	
003908	LAUREL STATE		3	
OGRID No.	Operator Name		Elevation	
022767	THE EASTLAND OIL CO.		3603	

Surface Location

UL or lot No.	Section	Township	Range	Lot Idn	Feet from the	North/South line	Feet from the	East/West line	County
LOT 2	7	18 S	28 E		2310	NORTH	330	WEST	EDDY

Bottom Hole Location If Different From Surface

UL or lot No.	Section	Township	Range	Lot Idn	Feet from the	North/South line	Feet from the	East/West line	County
Dedicated Acres		Joint or Infill	Consolidation Code	Order No.					
43.70									

NO ALLOWABLE WILL BE ASSIGNED TO THIS COMPLETION UNTIL ALL INTERESTS HAVE BEEN CONSOLIDATED  
OR A NON-STANDARD UNIT HAS BEEN APPROVED BY THE DIVISION

	<b>OPERATOR CERTIFICATION</b>	
	I hereby certify the the information contained herein is true and complete to the best of my knowledge and belief.	
	Signature <i>Travis Reed</i>	
	Printed Name Travis Reed	
	Agent Title	
	Date 8-25-2000	
	<b>SURVEYOR CERTIFICATION</b>	
	I hereby certify that the well location shown on this plat was plotted from field notes of actual surveys made by me or under my supervision, and that the same is true and correct to the best of my belief.	
	Date Surveyed AUGUST 16, 2000	
	Signature & Seal of Professional Surveyor <i>Ronald J. Eidson</i> 8/22/00	
	W.O. Num. 00-11-1006	
	Certificate No. RONALD J. EIDSON, 3239 GARY G. EIDSON, 12841 MACON McDONALD, 12185	

# VICINITY MAP

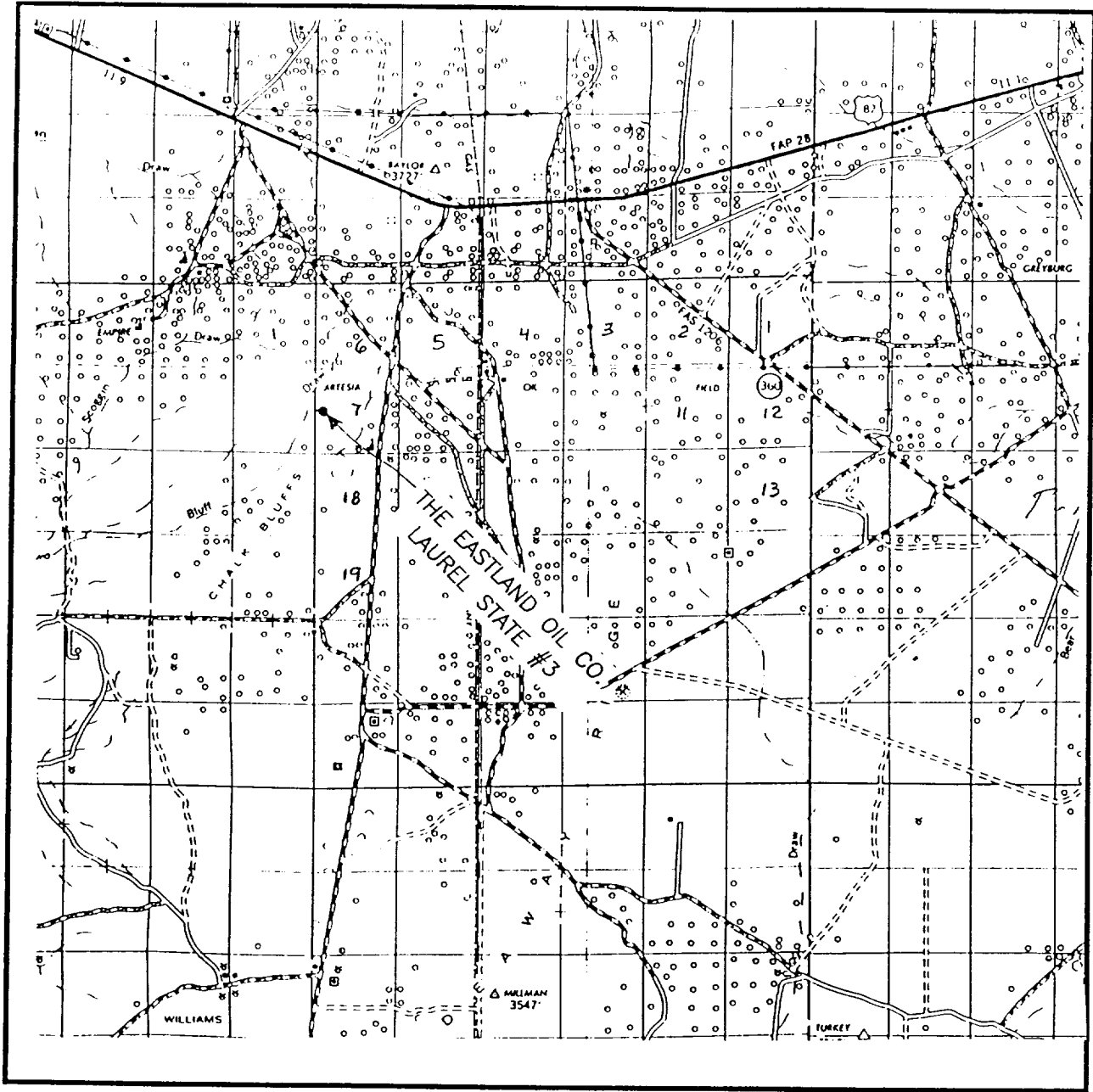

SCALE: 1" = 2 MILES

SEC. 7 TWP. 18-S RGE. 28-E  
 SURVEY N.M.P.M.  
 COUNTY EDDY  
 DESCRIPTION 2310' FNL & 330' FWL  
 ELEVATION 3603  
 OPERATOR THE EASTLAND OIL CO.  
 LEASE LAUREL STATE

**JOHN WEST SURVEYING**  
**HOBBS, NEW MEXICO**  
 (505) 393-3117

# LOCATION VERIFICATION MAP

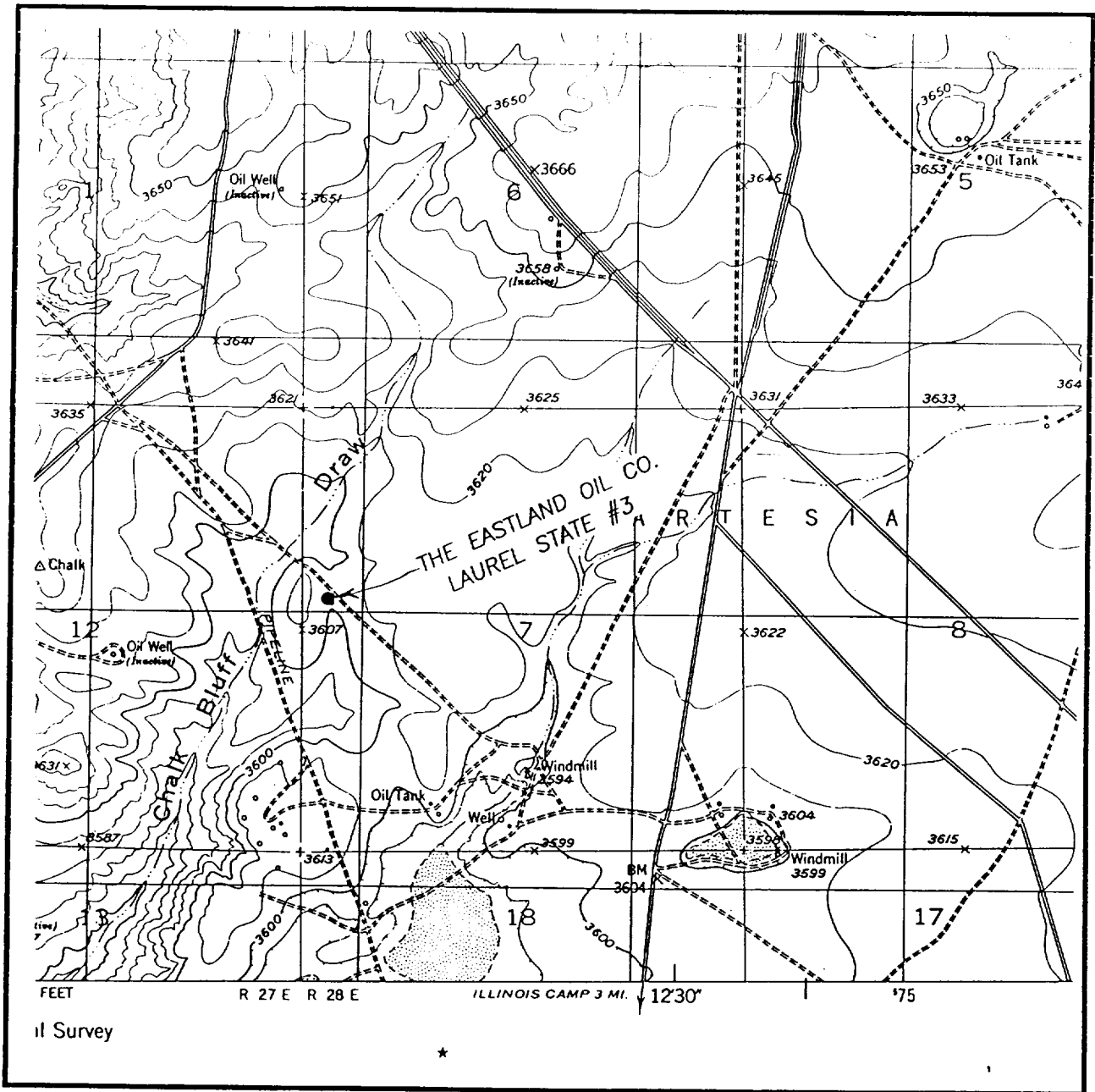

SCALE: 1" = 2000'

CONTOUR INTERVAL - 10'

SEC. 7 TWP. 18-S RGE. 28-E

SURVEY N.M.P.M.

COUNTY EDDY

DESCRIPTION 2310' FNL & 330' FWL

ELEVATION 3603

OPERATOR THE EASTLAND OIL CO.

LEASE LAUREL STATE

U.S.G.S. TOPOGRAPHIC MAP

RED LAKE, N.M.

**JOHN WEST SURVEYING**  
**HOBBS, NEW MEXICO**  
**(505) 393-3117**