

SECTION 8, TOWNSHIP 18 SOUTH, RANGE 31 EAST, NMPM, EDDY COUNTY, NEW MEXICO.

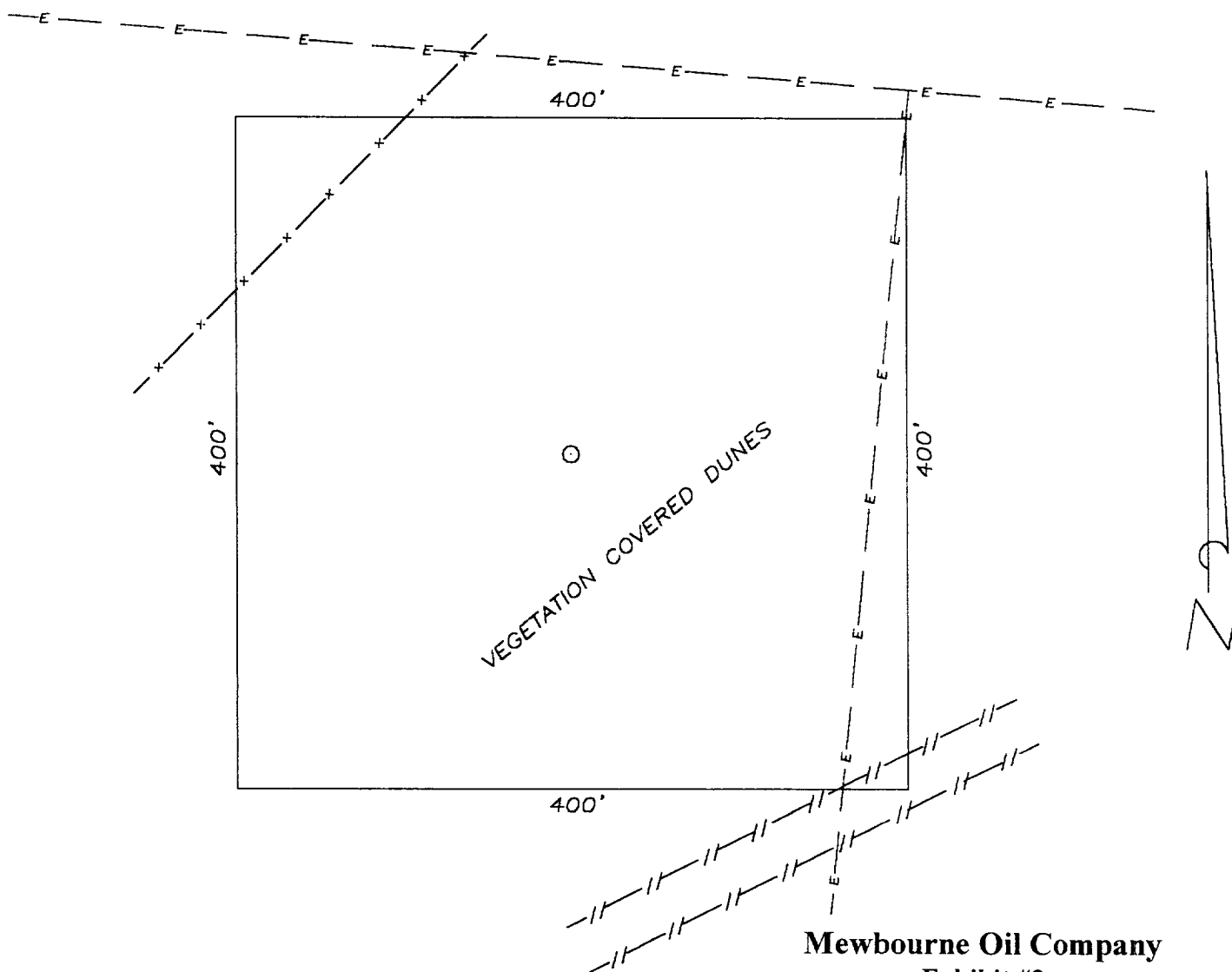

Mewbourne Oil Company
Exhibit #3
Proposed Location Construction

100' 0 100' 200'
 Scale 1" = 1000'

THE PREPARATION OF THIS PLAT AND THE PERFORMANCE OF THE SURVEY UPON WHICH IT IS BASED WERE DONE UNDER MY DIRECTION AND THE PLAT ACCURATELY DEPICTS THE RESULTS OF SAID SURVEY AND MEET THE REQUIREMENTS OF THE STANDARDS FOR LAND SURVEYS IN NEW MEXICO AS ADOPTED BY THE NEW MEXICO STATE BOARD OF REGISTRATION FOR PROFESSIONAL ENGINEERS AND LAND SURVEYORS.

[Signature]
 HERSCHEL L. JONES R.L.S. No. 3640

GENERAL SURVEYING COMPANY P.O. BOX 1928
 LOVINGTON, NEW MEXICO 88260

MEWBOURNE OIL COMPANY

MEWBOURNE OIL COMPANY FREN "8" FEDERAL
 COM. #5, SECTION 8, TOWNSHIP 18 SOUTH,
 RANGE 31 EAST, NMPM, EDDY COUNTY, NEW
 MEXICO.

Survey Date: 3/30/2001	Sheet 1 of 1 Sheets
Drawn By: Ed Blevins	W.O. Number
Date: 3/31/01	Scale 1" = 100' FREN 5P