

NEW MEXICO OIL CONSERVATION COMMISSION  
Santa Fe, New Mexico

NOTICE OF INTENTION TO DRILL OR RECOMPLETE

Notice must be given to the District Office of the Oil Conservation Commission and approval obtained before drilling or recompletion begins. If changes in the proposed plan are considered advisable, a copy of this notice showing such changes will be returned to the sender. Submit this notice in QUINTUPPLICATE. One copy will be returned following approval. See additional instructions in Rules and Regulations of the Commission.

Midland, Texas

(Place)

May 25, 1953

(Date)

OIL CONSERVATION COMMISSION  
SANTA FE, NEW MEXICO

Gentlemen:

You are hereby notified that it is our intention to commence the (Drilling) ~~(Recompletion)~~ of a well to be known as

Standard Oil Company of Texas

(Company or Operator)

Federal-Cass Ranch Unit

(Lease)

Well No. 1, in Cass Ranch (Unit) The well is

located 1980 feet from the North line and 1980 feet from the

West

line of Section 3, T. 20-S, R. 24-E, NMPM.

(GIVE LOCATION FROM SECTION LINE)

Wildcat

Pool, Eddy County

If State Land the Oil and Gas Lease is No. -

If patented land the owner is. -

Address. -

We propose to drill well with drilling equipment as follows: Rotary 0' to 10,500'

The status of plugging bond is Blanket Bond

Drilling Contractor Will Report Later M. J. Delaney Co.

Dallas, Tex.

We intend to complete this well in the Siluro-Devonian

formation at an approximate depth of 10,200 - 10,500 feet.

CASING PROGRAM

We propose to use the following strings of Casing and to cement them as indicated:

Size of Hole	Size of Casing	Weight per Foot	New or Second Hand	Depth	Sacks Cement
17 1/2"	13-3/8"	48#	New	700	500
12 1/2"	9-5/8"	36#	New	3,500	1,000
8-3/4"	7"	23, 26 & 29#	New	10,500	1,000

If changes in the above plans become advisable we will notify you immediately.

ADDITIONAL INFORMATION (If recompletion give full details of proposed plan of work.)

Approved....., 19.....  
Except as follows:

OIL CONSERVATION COMMISSION

By *P. A. Hansen*

Title .....

Sincerely yours,

Standard Oil Company of Texas

(Company or Operator)

By *T. J. Leighner, Jr.*

Position Petroleum Engineer

Send Communications regarding well to

Name Standard Oil Company of Texas

Address P. O. Box 1660

Midland, Texas

R 24 E  
CORNER MARKED

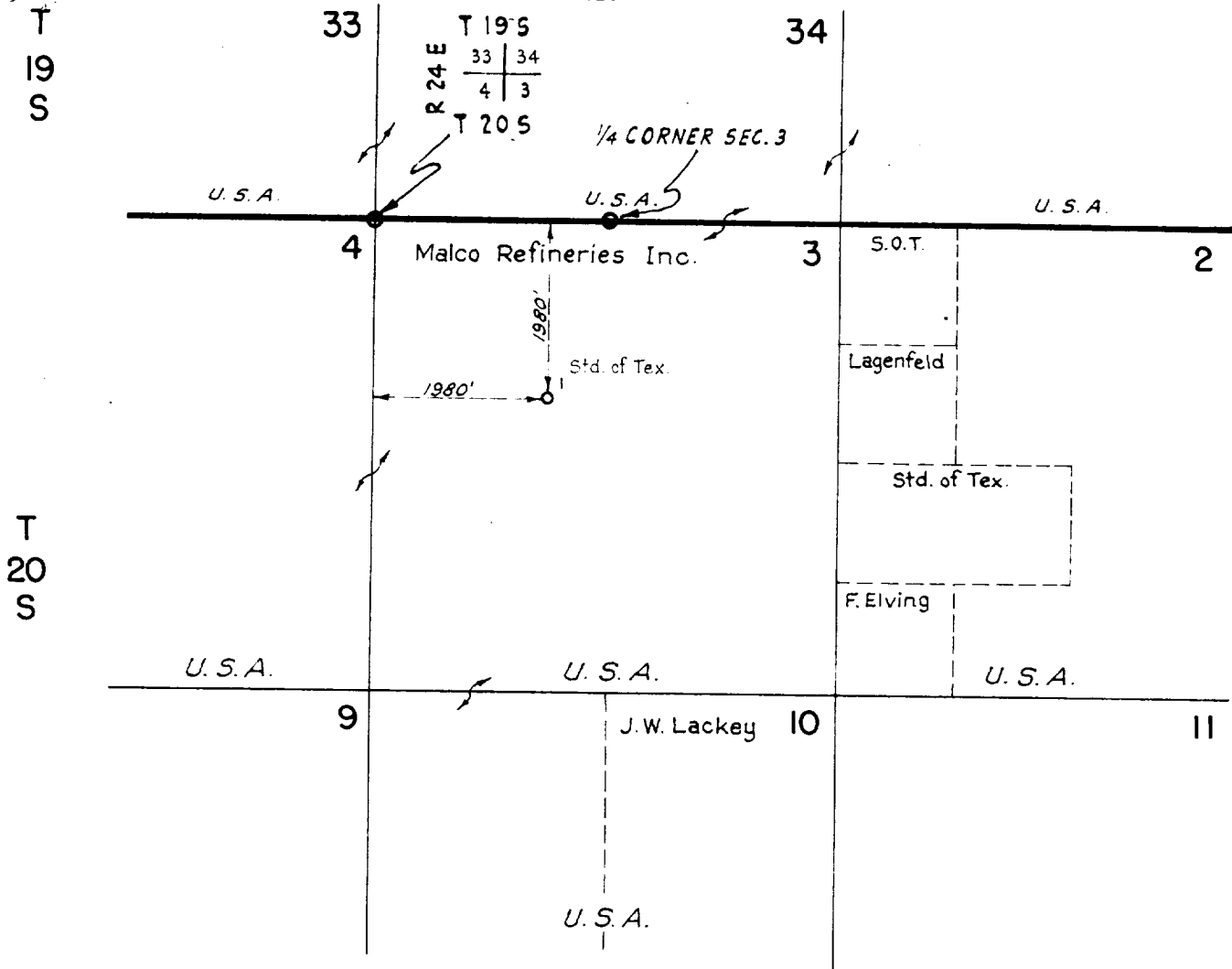

I, Guy E. Saunders, certify that this survey was made by me on the ground and that this plat is true and correct.  
May 26, 1953

*Guy E. Saunders*  
Registered State Land Surveyor  
of New Mexico

Plat Showing Location of  
Standard Oil Co. of Texas - Well #1  
Federal - Cass Ranch Unit  
Malco Area  
Eddy County, New Mex.

Scale: 1" = 2000' Date: 5-22-53

NEW MEXICO OIL CONSERVATION COMMISSION  
Santa Fe, New Mexico

NOTICE OF INTENTION TO DRILL OR RECOMPLETE.

Notice must be given to the District Office of the Oil Conservation Commission and approval obtained before drilling or recompletion begins. If changes in the proposed plan are considered advisable, a copy of this notice showing such changes will be returned to the sender. Submit this notice in QUINTUPPLICATE. One copy will be returned following approval. See additional instructions in Rules and Regulations of the Commission.

Midland, Texas  
(Place)

May 25, 1953  
(Date)

OIL CONSERVATION COMMISSION  
SANTA FE, NEW MEXICO

Gentlemen:

You are hereby notified that it is our intention to commence the (Drilling) ~~Recompletion~~ of a well to be known as

Standard Oil Company of Texas  
(Company or Operator)

Federal-Casa Ranch Unit  
(Lease)

Well No. 1, in Casa Ranch (Unit) The well is

located 1980 feet from the North line and 1980 feet from the West line of Section 3, T. 20-S, R. 24-E, NMPM.

(GIVE LOCATION FROM SECTION LINE) Wilcox Pool, Brady County

D	1980'	B	A
1980'		G	H
L	K	J	I
M	N	O	P

If State Land the Oil and Gas Lease is No.

If patented land the owner is.

Address.

We propose to drill well with drilling equipment as follows: Rotary 0' to 10,500'

The status of plugging bond is Blanket Bond

Drilling Contractor Will Report Later M. J. Delaney Co.  
Dallas, Texas.

We intend to complete this well in the Siluro-Devonian formation at an approximate depth of 10,200 - 10,500 feet.

CASING PROGRAM

We propose to use the following strings of Casing and to cement them as indicated:

Size of Hole	Size of Casing	Weight per Foot	New or Second Hand	Depth	Sacks Cement
17 1/2"	13-3/8"	48 1/2	New	700	500
12 1/2"	9-5/8"	36 1/2	New	3,500	1,000
8-3/4"	7"	23, 26 & 29 1/2	New	10,500	1,000

If changes in the above plans become advisable we will notify you immediately.

ADDITIONAL INFORMATION (If recompletion give full details of proposed plan of work.)

Approved....., 19.....  
Except as follows:

OIL CONSERVATION COMMISSION

By P. A. Johnson  
Title

Sincerely yours,

Standard Oil Company of Texas  
(Company or Operator)

By T. J. Leigman, Jr.  
Position Petroleum Engineer

Send Communications regarding well to

Name Standard Oil Company of Texas

Address P. O. Box 1660

Midland, Texas

R 24 E

CORNER MARKED

T 19 S

33	34
4	3

T 20 S

R 24 E

1/4 CORNER SEC. 3

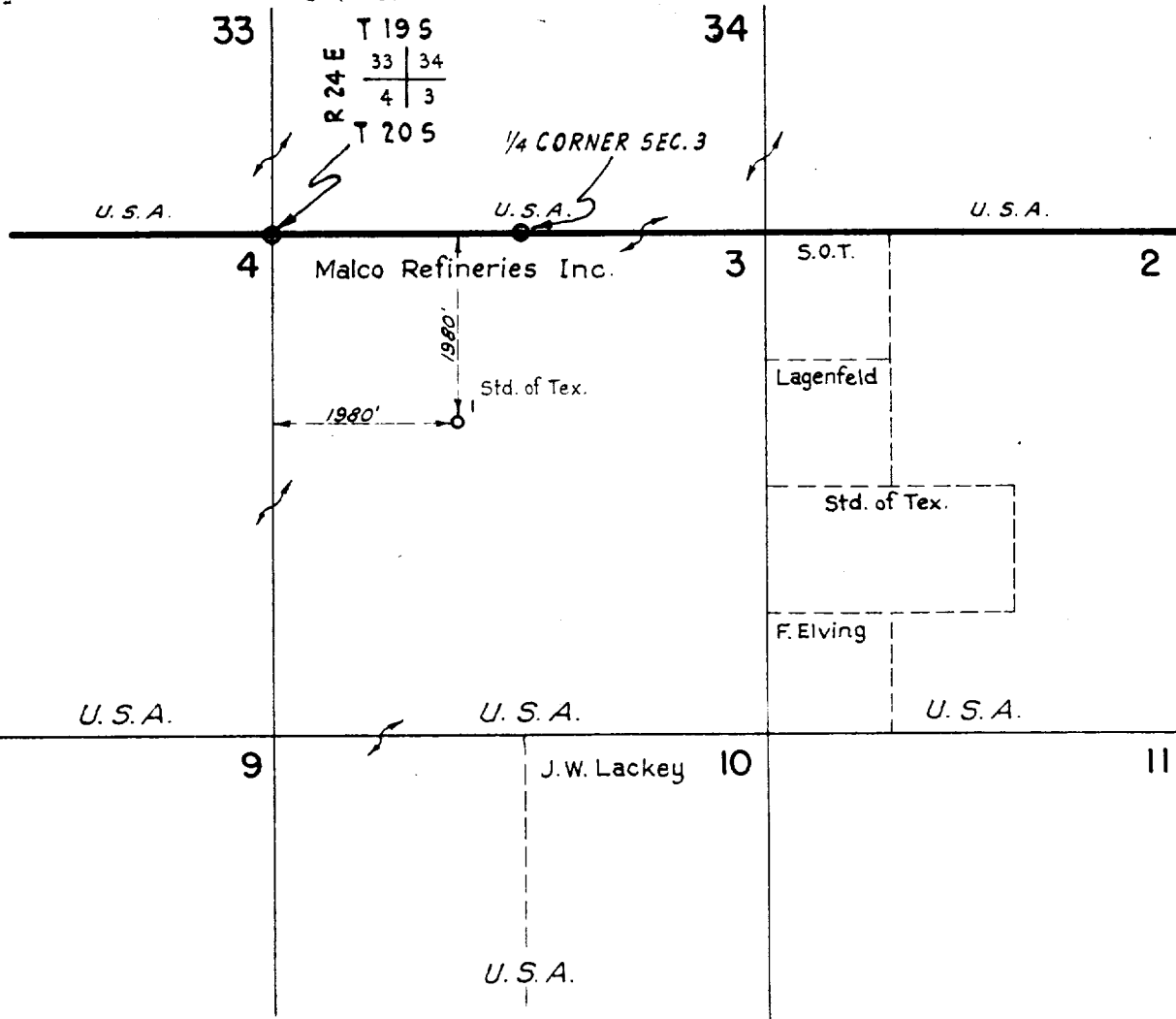

I, Guy E. Saunders, certify that this survey was made by me on the ground and that this plat is true and correct.  
May 26, 1953

*Guy E. Saunders*  
Registered State Land Surveyor  
of New Mexico

Plat Showing Location of  
Standard Oil Co. of Texas - Well #1  
Federal - Cass Ranch Unit  
Malco Area  
Eddy County, New Mex.

Scale: 1" = 2000' Date: 5-22-53