

UNITED STATES DEPARTMENT OF THE INTERIOR
BUREAU OF LAND MANAGEMENT
APPLICATION FOR PERMIT TO DRILL, DEEPEN, OR PLUG BACK

Form approved.
Budget Bureau No. 1004-0136
Expires August 31, 1985

1a. TYPE OF WORK

DRILL ☐

DEEPEN ☐

PLUG BACK ☒

b. TYPE OF WELL

OIL WELL ☐

GAS WELL ☒

OTHER RECOMPLETE

SINGLE ZONE ☐

MULTIPLE ZONE ☐

2. NAME OF OPERATOR

Yates Petroleum Corporation

RECEIVED

3. ADDRESS OF OPERATOR

105 South 4th St., Artesia, NM 88210

4. LOCATION OF WELL (Report location clearly and in accordance with any State requirements)

At surface

1980' FNL & 1980' FWL, Sec. 3-T20S-R24E

At proposed prod. zone

Same

U. C. D.
WATERMAN, OFFICE

14. DISTANCE IN MILES AND DIRECTION FROM NEAREST TOWN OR POST OFFICE*

Approximately 26 miles south west of Artesia, New Mexico

15. DISTANCE FROM PROPOSED*

LOCATION TO NEAREST
PROPERTY OR LEASE LINE, FT.
(Also to nearest drlg. unit line, if any)

1980'

16. NO. OF ACRES IN LEASE

160

17. NO. OF ACRES ASSIGNED
TO THIS WELL

160

18. DISTANCE FROM PROPOSED LOCATION*

TO NEAREST WELL, DRILLING, COMPLETED,
OR APPLIED FOR, ON THIS LEASE, FT.

19. PROPOSED DEPTH

9950'

20. ROTARY OR CABLE TOOLS

Pulling Unit

21. ELEVATIONS (Show whether DF, RT, GR, etc.)

3749' GR

22. APPROX. DATE WORK WILL START*

When approved

23.

PROPOSED CASING AND CEMENTING PROGRAM

EXISTING

SIZE OF HOLE	SIZE OF CASING	WEIGHT PER FOOT	SETTING DEPTH	QUANTITY OF CEMENT
17 1/2"	13-3/8"	48#	543'	375 sx (in place)
12 1/2"	9-5/8"	36#	3700 - 1377'	400 sx (in place)
8-3/4"	4 1/2"	11.6 & 9.5#	8997'	Stage I 630 sx (in place)
			Stage Clr. @1508'	Stage II 750 sx (in place)

Propose to abandon Atoka perforations 8712-8721' and set CIBP at 8500' and cap w/35' cmt.

Propose to perforate Canyon at 7550-52' and 7740-42'. Will treat as needed for production, and recompletion.

IN ABOVE SPACE DESCRIBE PROPOSED PROGRAM: If proposal is to deepen or plug back, give data on present productive zone and proposed new productive zone. If proposal is to drill or deepen directionally, give pertinent data on subsurface locations and measured and true vertical depths. Give blowout preventer program, if any.

24. SIGNED Ken B. Bandy TITLE LAND MAN DATE 5-5-89

(This space for Federal or State office use)

PERMIT NO. _____ APPROVAL DATE _____

APPROVED BY Shirley J. Green FOR: U. C. D. DATE 6-7-89

CONDITIONS OF APPROVAL, IF ANY:

*See Instructions On Reverse Side

CORRECTED COPY

MEXICO OIL CONSERVATION COMMISSION
WELL LOCATION AND ACREAGE DEDICATION PLAT

Form C-102
Supersedes C-128
Effective 1-1-65

All distances must be from the outer boundaries of the Section.

Copy to J.F.

Operator Standard Oil Company of Texas A Division of Chevron Oil Company		Lease Cass Ranch Federal		Well No. 1
Unit Letter F	Section 3	Township 20 South	Range 24 East	County Eddy
Actual Footage Location of Well: 1980 feet from the West line and 1980 feet from the North line				
Ground Level Elev: 3750	Producing Formation Atoka Penn	Pool Aggie Draw Atoka Gas Undesignated 24c	Dedicated Acreage: 320 Acres	

1. Outline the acreage dedicated to the subject well by colored pencil or hachure marks on the plat below.
2. If more than one lease is dedicated to the well, outline each and identify the ownership thereof (both as to working interest and royalty).
3. If more than one lease of different ownership is dedicated to the well, have the interests of all owners been consolidated by communitization, unitization, force-pooling, etc?

☐ Yes ☐ No If answer is "yes," type of consolidation NOV 2 1966

If answer is "no," list the owners and tract descriptions which have actually been consolidated (Use reverse side of this form if necessary.) D.C.E. Artesia Office

No allowable will be assigned to the well until all interests have been consolidated (by communitization, unitization, forced-pooling, or otherwise) or until a non-standard unit, eliminating such interests, has been approved by the Commission.

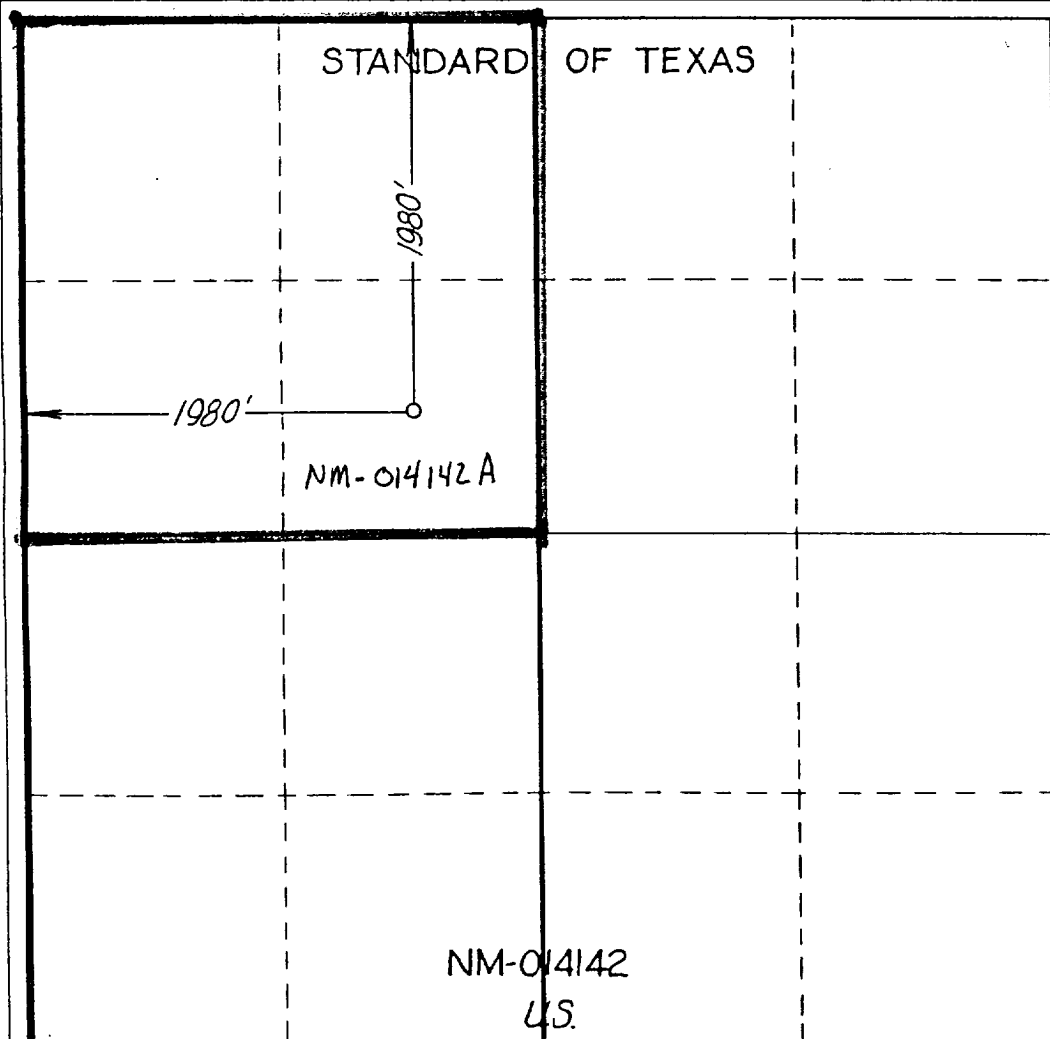

CERTIFICATION

I hereby certify that the information contained herein is true and complete to the best of my knowledge and belief.

B. Davidson
Name
B. Davidson
Position
Lead Drilling Engineer

Company
Standard Oil Company of Texas

Date
October 28, 1966

I hereby certify that the well location shown on this plat was plotted from field notes of actual surveys made by me or under my supervision, and that the same is true and correct to the best of my knowledge and belief.

Date Surveyed
Refer to original survey of 5-22-63

Registered Professional Engineer and/or Land Surveyor

Certificate No.