

NO. OF COPIES RECEIVED	6
DISTRIBUTION	
SANTA FE	1
FILE	1-
U.S.G.S.	2
LAND OFFICE	
OPERATOR	2

NEW MEXICO OIL CONSERVATION COMMISSION

Form C-101
Revised 1-1-65

APPLICATION FOR PERMIT TO DRILL, DEEPEN, OR PLUG BACK

1. Type of Work a. Type of Well DRILL <input type="checkbox"/> DEEPEN <input type="checkbox"/> PLUG BACK <input type="checkbox"/> OIL WELL <input checked="" type="checkbox"/> GAS WELL <input type="checkbox"/> OTHER RE-ENTRY <input type="checkbox"/> SINGLE ZONE <input type="checkbox"/> MULTIPLE ZONE <input type="checkbox"/>		5A. Indicate Type of Lease STATE <input type="checkbox"/> FEE <input checked="" type="checkbox"/>
2. Name of Operator Yates Petroleum Corporation		7. Unit Agreement Name
3. Address of Operator 309 Carper Building-Artesia, New Mexico 88210		8. Farm or Lease Name A. Land & Cattle Co.
4. Location of Well UNIT LETTER E LOCATED 2323 FEET FROM THE North LINE AND 430 FEET FROM THE West LINE OF SEC. 2 T10N R3E 25 NMPM		9. Well No. 1
		10. Field and Pool, or Wildcat Wildcat SA yeso
		12. County Eddy
19. Proposed Depth 3700		19A. Formation S.A. Yeso
20. Rotary or C.T. Cable		
21. Elevations (Show whether DF, RT, etc.) 3480 DF	21A. Kind & Status Plug. Bond Blanket	21B. Drilling Contractor Floyd Osbourne
		22. Approx. Date Work will start Immediately

PROPOSED CASING AND CEMENT PROGRAM

SIZE OF HOLE	SIZE OF CASING	WEIGHT PER FOOT	SETTING DEPTH	SACKS OF CEMENT	EST. TOP
11"	8-5/8"	24#	1206'	650 8x Circulated	

This well was drilled to a total depth of 5328' with all of the 8-5/8" casing left in the hole by Pan American Petroleum Corporation. *PA 6-25-60*

We propose to re-enter this well and clean out to approximately 3700' to test the San Andres & Yeso formations by using Lynes straddle packer on 3" tubing.

If production is encountered, ^{53'} production casing will be run according to NMCCC regulations.

APPROVAL VALID
FOR 90 DAYS UNLESS
DRILLING COMMENCED,

EXPIRES 9-11-67

RECEIVED

JUN 19 1967

AMERICAN PETROLEUM

IN ABOVE SPACE DESCRIBE PROPOSED PROGRAM: IF PROPOSAL IS TO DEEPEN OR PLUG BACK, GIVE DATA ON PRESENT PRODUCTIVE ZONE AND PROPOSED NEW PRODUCTIVE ZONE. GIVE BLOWOUT PREVENTER PROGRAM, IF ANY.

I hereby certify that the information above is true and complete to the best of my knowledge and belief.

Signed MS Armstrong Title Agent Date 6-19-67
(This space for State Use)

APPROVED BY W. A. Gussert TITLE OIL AND GAS INSPECTOR DATE JUN 20 1967

CONDITIONS OF APPROVAL, IF ANY:

Casing must be set and cemented in compliance with Order R-3169

NEW MEXICO OIL CONSERVATION COMMISSION
WELL LOCATION AND ACREAGE DEDICATION PLAT

Form C-102
Supersedes C-128
Effective 1-1-65

All distances must be from the outer boundaries of the Section.

Operator Vates Petroleum Corporation		Lease C. A. Land & Cattle Co.		Well No. 1
Unit Letter E	Section 2	Township 19S	Range 25E	County Eddy
Actual Footage Location of Well: 2323 feet from the North line and 430 feet from the West line				
Ground Level Elev. 3480 DF	Producing Formation S.A. Yesso	Pool And Pecos Draw Wildcat S.A. Yesso	Dedicated Acreage: 40 Acres	

1. Outline the acreage dedicated to the subject well by colored pencil or hatchure marks on the plat below.
2. If more than one lease is dedicated to the well, outline each and identify the ownership thereof (both as to working interest and royalty).
3. If more than one lease of different ownership is dedicated to the well, have the interests of all owners been consolidated by communitization, unitization, force-pooling, etc?

☐ Yes ☐ No If answer is "yes," type of consolidation _____

If answer is "no," list the owners and tract descriptions which have actually been consolidated. (Use reverse side of this form if necessary.) _____

No allowable will be assigned to the well until all interests have been consolidated (by communitization, unitization, forced-pooling, or otherwise) or until a non-standard unit, eliminating such interests, has been approved by the Commission.

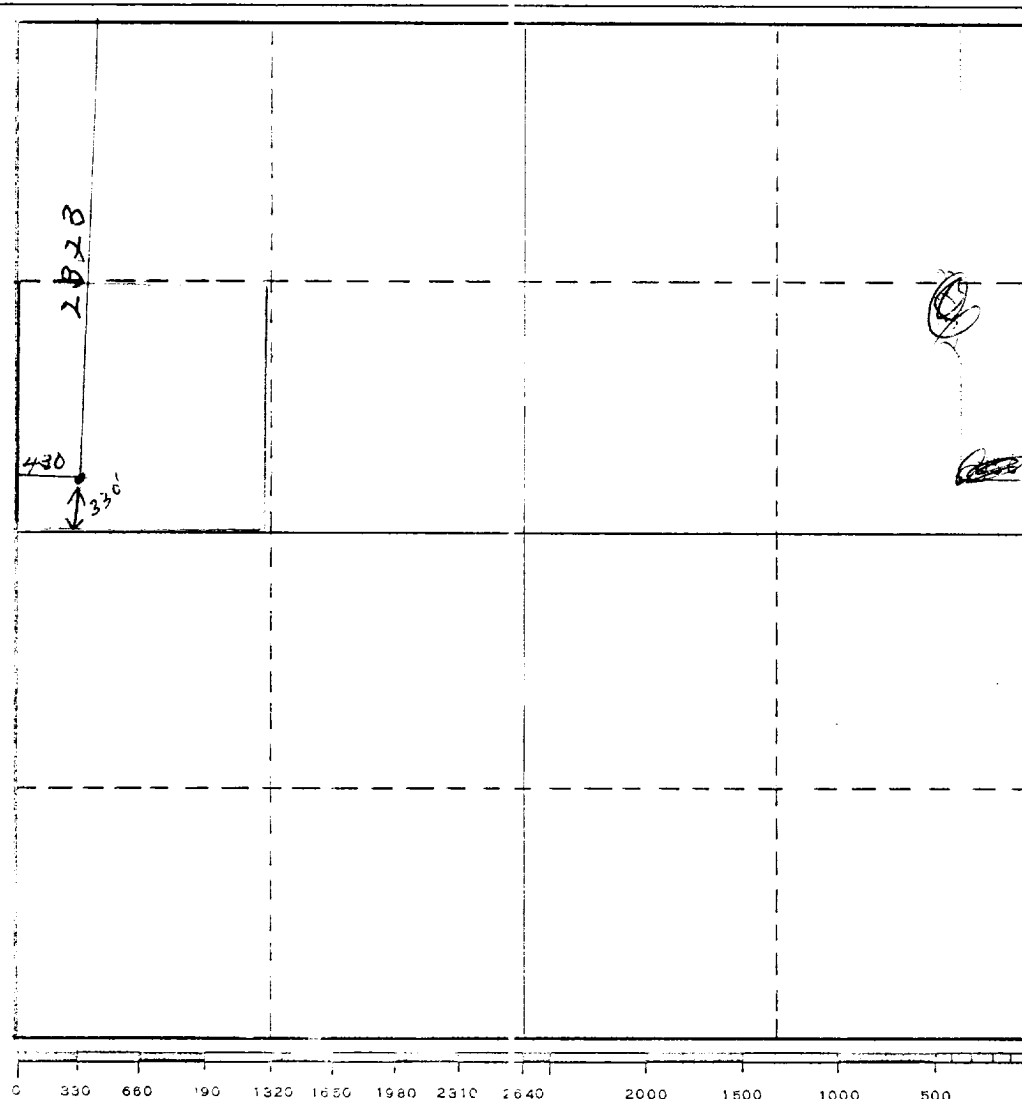

CERTIFICATION

I hereby certify that the information contained herein is true and complete to the best of my knowledge and belief.

M. L. Armstrong

Name
M. L. Armstrong
Position
Agent
Company
Vates Petroleum Corp.

Date
6-19-67

I hereby certify that the well location shown on this plat was plotted from field notes of actual surveys made by me or under my supervision, and that the same is true and correct to the best of my knowledge and belief.

See Original dated
Date Surveyed
5-25-60 By John West
Registered Professional Engineer
and/or Land Surveyor

Certificate No.