

NEW MEXICO  
OIL CONSERVATION COMMISSION

Form C-128

Well Location and/or Gas Proration Plat

Date April 15, 1957

Operator Magnolia Petroleum Company Lease Ralph Nix

Well No. One (1) Section 11 Township 19 S Range 26 E NMPM

Located 1980 Feet From South Line, 660 Feet From West Line,

Eddy County, New Mexico. G. L. Elevation \_\_\_\_\_

Name of Producing Formation San Andres Pool Undesignated Dedicated Acreage \_\_\_\_\_

(Note: All distances must be from outer boundaries of Section)

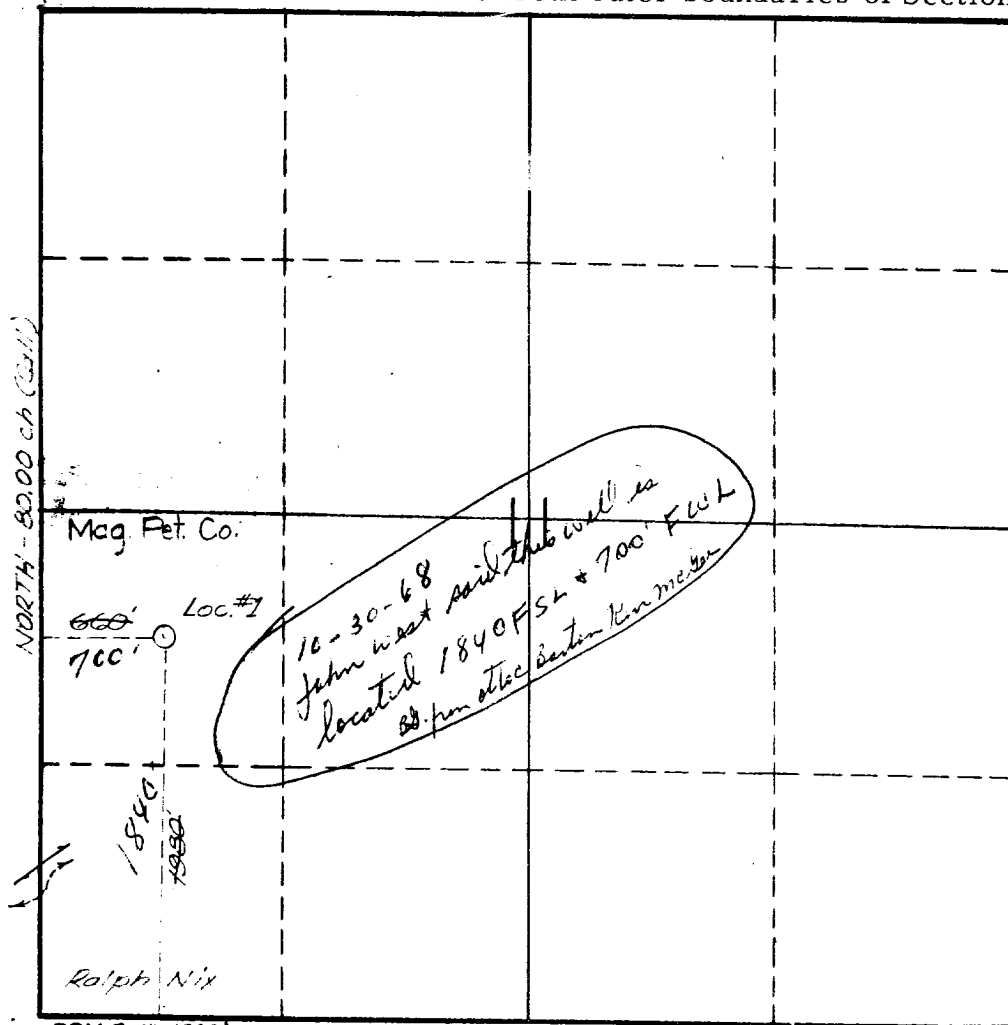

SCALE: 1"=1000'

Is this Well a Dual Comp. ? Yes \_\_\_ No X

If the answer to Question 1 is yes, are there any other dually completed wells within the dedicated acreage? Yes \_\_\_ No \_\_\_

This is to certify that the above plat was prepared from field notes of actual surveys made by me or under my supervision and that the same are true and correct to the best of my knowledge and belief.

me W. B. [Signature]  
sition. District Superintendent  
presenting Magnolia Petroleum Company  
ldress Box 2406, Hobbs, New Mexico

Date Surveyed April 11, 1957  
Registered Professional Engineer and/or  
Land Surveyor #1415

# **OIL CONSERVATION COMMISSION**

## **ARTESIA DISTRICT OFFICE**

**No. Copies Received** 5

### **DISTRIBUTION**

	<b>CO. FURNISHED</b>	
Division	<u>1</u>	
Production		
State Lized Oil		
U. S. C. S.	<u>2</u>	
Transporter		
File	<u>1</u>	<input checked="" type="checkbox"/>