

NEW MEXICO OIL CONSERVATION COMMISSION  
Santa Fe, New Mexico

Form C-101  
Revised (12/1/55)

NOTICE OF INTENTION TO DRILL

Notice must be given to the District Office of the Oil Conservation Commission and approval obtained before drilling or recompletion begins. If changes in the proposed plan are considered advisable, a copy of this notice showing such changes will be returned to the sender. Submit this notice in QUINTUPPLICATE. One copy will be returned following approval. See additional instructions in Rules and Regulations of the Commission. If State Land submit 6 Copies Attach Form C- 128 in triplicate to first 3 copies of form C-101

Artesia, New Mexico

(Place)

April 21, 1960

(Date)

OIL CONSERVATION COMMISSION  
SANTA FE, NEW MEXICO

Gentlemen:

You are hereby notified that it is our intention to commence the Drilling of a well to be known as  
Jones & Haile

(Company or Operator)

Featherstone-State

(Lease)

Well No. 1, in J The well is

(Unit)

located 1650 feet from the South line and 2262 feet from the East

Line of Section 32, T 19 S, R 27 E, NMPM.

(GIVE LOCATION FROM SECTION LINE)

McMillian Pool, Eddy County

E-916

If State Land the Oil and Gas Lease is No.

If patented land the owner is

Address

We propose to drill well with drilling equipment as follows: Cable Tools

The status of plugging bond is Blanket Bond

Drilling Contractor Willard Beaty

We intend to complete this well in the Seven Rivers formation at an approximate depth of 550 feet.

CASING PROGRAM

We propose to use the following strings of Casing and to cement them as indicated:

Size of Hole	Size of Casing	Weight per Foot	New or Second Hand	Depth	Sacks Cement
8"	5 1/2"	15	New	350'	102

If changes in the above plans become advisable we will notify you immediately.

ADDITIONAL INFORMATION (If recompletion give full details of proposed plan of work.)

APR 28 1960

Approved....., 19.....  
Except as follows:

OIL CONSERVATION COMMISSION

By M L Armstrong

OIL AND GAS INSPECTOR

Sincerely yours,

Jones & Haile

(Company or Operator)

By

Agent

Position

Send Communications regarding well to

Name Jones & Haile

Address Box 1225, Artesia, New Mexico

**NEW MEXICO OIL CONSERVATION COMMISSION**  
**WELL LOCATION AND ACREAGE DEDICATION PLAT**

FORM C-128  
Revised 5/1/57

SEE INSTRUCTIONS FOR COMPLETING THIS FORM ON THE REVERSE SIDE

**SECTION A**

Operator <b>Bert Jones &amp; J.F. Haile</b>		Lease <b>Feshherstone-State</b>		Well No. <b>1</b>
Unit Letter <b>J</b>	Section <b>32</b>	Township <b>19 South</b>	Range <b>27 East</b>	County <b>Eddy</b>
Actual Footage Location of Well: <b>1650</b> feet from the <b>South</b> line and <b>2262</b> feet from the <b>East</b> line				
Ground Level Elev. <b>3370</b>	Producing Formation <b>Sever Rivers</b>	Pool	Dedicated Acreage: Acres	

1. Is the Operator the only owner in the dedicated acreage outlined on the plat below? YES \_\_\_\_\_ NO \_\_\_\_\_. ("Owner" means the person who has the right to drill into and to produce from any pool and to appropriate the production either for himself or for himself and another. (65-3-29 (e) NMSA 1935 Comp.)
2. If the answer to question one is "no," have the interests of all the owners been consolidated by communitization agreement or otherwise? YES \_\_\_\_\_ NO \_\_\_\_\_. If answer is "yes," Type of Consolidation \_\_\_\_\_
3. If the answer to question two is "no," list all the owners and their respective interests below:

Owner	Land Description

**SECTION B**

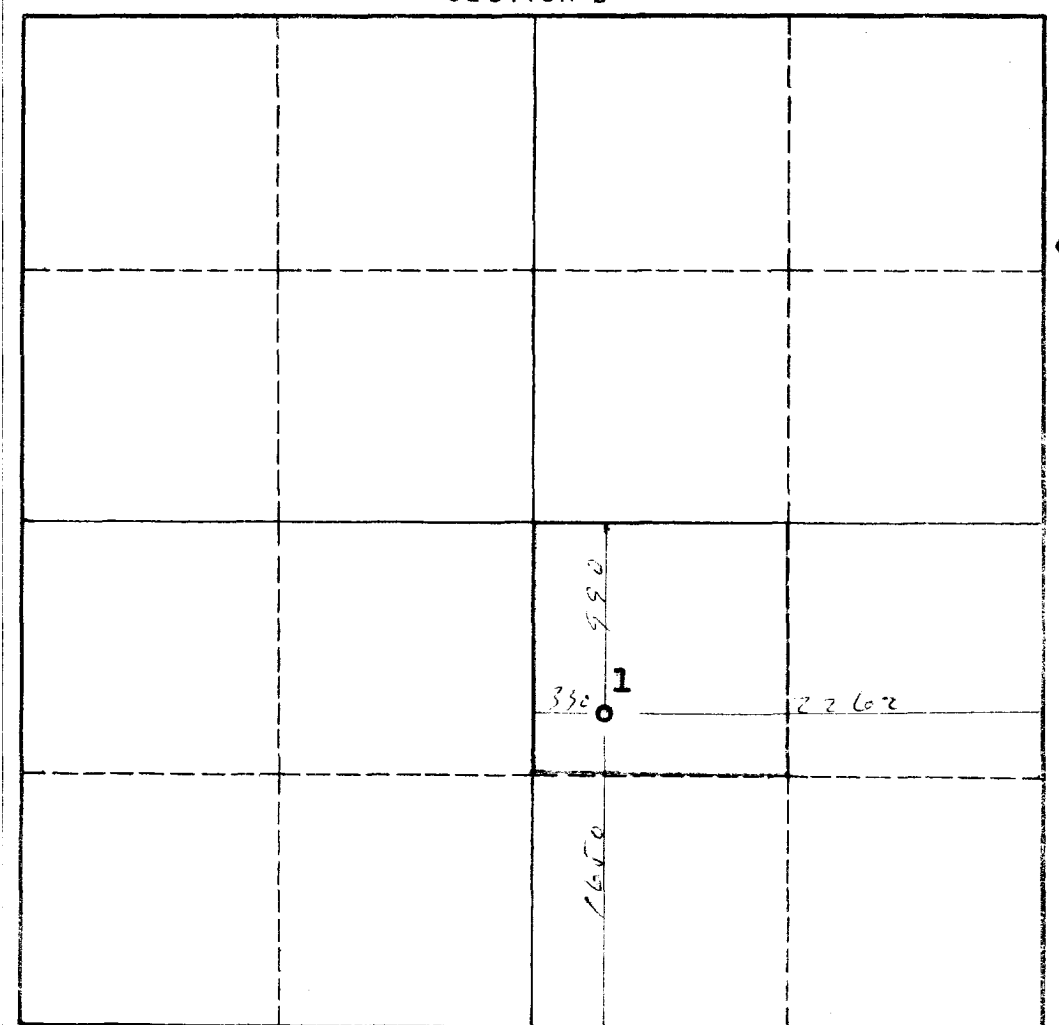

**CERTIFICATION**

I hereby certify that the information in SECTION A above is true and complete to the best of my knowledge and belief.

*J. Ineth Gil*  
Name

*Agent*  
Position

Company

Date

I hereby certify that the well location shown on the plat in SECTION B was plotted from field notes of actual surveys made by me or under my supervision, and that the same is true and correct to the best of my knowledge and belief.

Date Surveyed

**April 23, 1960**

Registered Professional Engineer  
and/or Land Surveyor

*John A. Matlock*  
Certificate No.

**1502**

0 330 660 990 1320 1650 1980 2310 2640 2000 1500 1000 500 0

# INSTRUCTIONS FOR COMPLETION OF FORM C-128

1. Operator shall furnish and certify to the information called for in Section A.
2. Operator shall outline the dedicated acreage for both oil and gas wells on the plat in Section B.
3. A registered professional engineer or land surveyor registered in the State of New Mexico or approved by the Commission shall show on the plat the location of the well and certify this information in the space provided.
4. All distances shown on the plat must be from the outer boundaries of the Section.
5. If additional space is needed for listing owners and their respective interests as required in question 3 of Section A, please use space below.

OIL CONSERVATION COMMISSION	
ARTESIA DISTRICT OFFICE	
No. Copies Received	10
DISTRIBUTION	
By	DATE
OPERATOR	
DANIELA RE	
PROBATION OFFICE	
STATE LAND OFFICE	
U. S. G. S.	
TRANSPORTER	
FILE	
BUREAU OF MINES	