

NEW MEXICO OIL CONSERVATION COMMISSION
Santa Fe, New Mexico

Form C-101
Revised (12/1/55)

NOTICE OF INTENTION TO DRILL OFFICE OCC

Notice must be given to the District Office of the Oil Conservation Commission and approval obtained before drilling or recompletion begins. If changes in the proposed plan are considered advisable, a copy of this notice showing such changes will be returned to the sender. Submit this notice in QUINTUPPLICATE. One copy will be returned following approval. See additional instructions in Rules and Regulations of the Commission. If State Land submit 6 Copies Attach Form C-128 in triplicate to first 3 copies of form C-101

Artesia, New Mexico

(Place)

October 19, 1959

(Date)

OIL CONSERVATION COMMISSION
SANTA FE, NEW MEXICO

Gentlemen:

You are hereby notified that it is our intention to commence the Drilling of a well to be known as

Western - Yates

(Company or Operator)

State 648, Tract 15

(Lease)

Well No. 155, in N The well is

(Unit)

located 660 feet from the South line and 1980 feet from the

West line of Section 11, T. 19 S, R. 28 E, NMPM.

(GIVE LOCATION FROM SECTION LINE) Unders. (E. Millman Pool, Eddy County

Queen Grayburg)

648

If State Land the Oil and Gas Lease is No.

If patented land the owner is

Address

We propose to drill well with drilling equipment as follows: Cable tools to 2300'

The status of plugging bond is Blanket Bond on file

Drilling Contractor Harvey Yates

Artesia, New Mexico

We intend to complete this well in the Queen Grayburg

formation at an approximate depth of 2300 feet.

CASING PROGRAM

We propose to use the following strings of Casing and to cement them as indicated:

Size of Hole	Size of Casing	Weight per Foot	New or Second Hand	Depth	Sacks Cement
12 1/2	10 3/4	32.75	New	450	75
10	8 5/8	24	Second Hand	1900	mudded
7 3/4	4 1/2	11.6	New	2300	300

If changes in the above plans become advisable we will notify you immediately.

ADDITIONAL INFORMATION (If recompletion give full details of proposed plan of work.)

Approved OCT 20 1959, 19

Except as follows:

OIL CONSERVATION COMMISSION

By W. A. Gressett

SEAL AND SIGN INSPECTOR

Sincerely yours,

Western - Yates

(Company or Operator)

By R. E. Yates

Position Asst. Dist. Supt.

Send Communications regarding well to

Name Western - Yates

Address P. O. Box 427, Artesia, N. M.

NEW MEXICO OIL CONSERVATION COMMISSION

Form C-128
Revised 5/1/57

Well Location and Acreage Dedication Plat

Section A.

Date October 19, 1959

Operator Western - Yates Lease State 648, Tr. 15
Well No. 155 Unit Letter N Section 11 Township 19 S Range 28 E NMPM
Located 660 Feet From South Line, 1980 Feet From West Line
County Eddy G. L. Elevation _____ Dedicated Acreage 40 Acres
Name of Producing Formation Queen Grayburg Pool Undesignated (E. Millman Queen

1. Is the Operator the only owner* in the dedicated acreage outlined on the plat below? Grayburg
Yes XX No _____.
2. If the answer to question one is "no," have the interests of all the owners been consolidated by communitization agreement or otherwise? Yes _____ No _____. If answer is "yes," Type of Consolidation _____
3. If the answer to question two is "no," list all the owners and their respective interests below:

Owner

Land Description

Section B

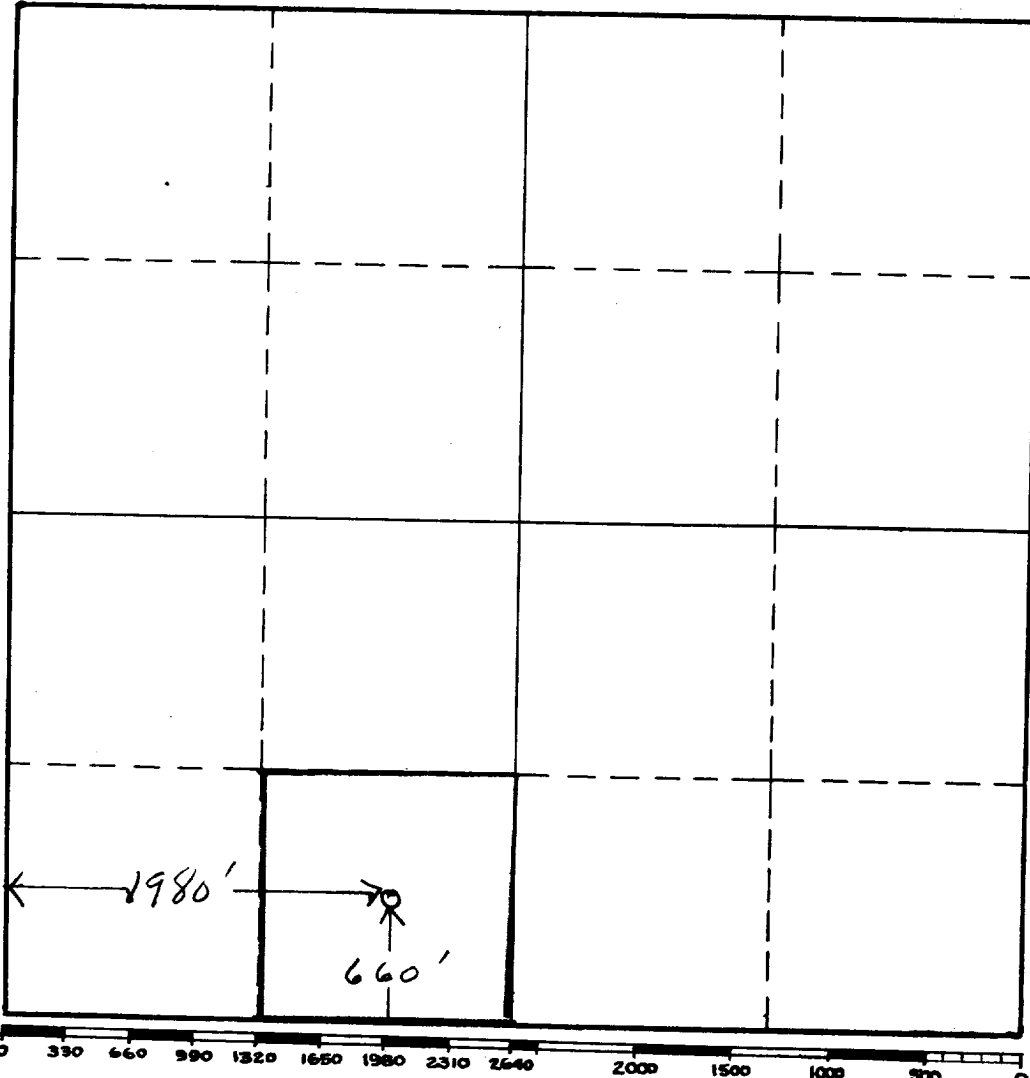

This is to certify that the information in Section A above is true and complete to the best of my knowledge and belief.

Western - Yates

(Operator)

Asst. Dist. Supt.

P.O. Box 427, Artesia, N.M.

Address

This is to certify that the well location shown on the plat in Section B was plotted from field notes of actual surveys made by me or under my supervision and that the same is true and correct to the best of my knowledge and belief.

Date Surveyed 10-15-59

W B Macey
Registered Professional
Engineer and/or Land Surveyor.

Certificate No. 926

(See instructions for completing this form on the reverse side)

INSTRUCTIONS FOR COMPLETION

1. Operator shall furnish and certify to the information called for in Section A.
2. Operator shall outline the dedicated acreage for both oil and gas wells on the plat in Section B.
3. A registered professional engineer or land surveyor registered in the State of New Mexico or approved by the Commission shall show on the plat the location of the well and certify this information in the space provided.
4. All distances shown on the plat must be from the outer boundaries of Section.
5. If additional space is needed for listing owners and their respective interests as required in question 3, Section A, please use space below

OR COPY TO THE COMMISSION	
No. 1	8
DATE	
NAME	
ADDRESS	
CITY	
STATE	
U. S. C. S.	
LANDMAN	
FILE	
BUREAU OF MINES	

* "Owner" means the person who has the right to drill into and to produce from any pool and to appropriate the production either for himself or for himself and another. (65-3-29 (e) NMSA 1953 Comp.)