

NEW MEXICO OIL CONSERVATION COMMISSION
Santa Fe, New Mexico

AUG 30 1961
30-015-02217
O. C. C.
ARTESIA, OFFICE
(Form C-101)
(Revised 7/1/52)

NOTICE OF INTENTION TO DRILL ~~UNRECOMPLETION~~

Notice must be given to the District Office of the Oil Conservation Commission and approval obtained before drilling or recompletion begins. If changes in the proposed plan are considered advisable, a copy of this notice showing such changes will be returned to the sender. Submit this notice in QUINTUPLICATE. One copy will be returned following approval. See additional instructions in Rules and Regulations of the Commission.

~~Manzano, Santa~~

(Place)

August 30, 1961

(Date)

OIL CONSERVATION COMMISSION
SANTA FE, NEW MEXICO

Gentlemen:

You are hereby notified that it is our intention to commence the (Drilling) (~~UNRECOMPLETION~~) of a well to be known as

~~Harry E. Buss~~

(Company or Operator)

~~Self-Drilling State~~

(Lease)

Well No. ~~1~~, in ~~1~~ The well is

(Unit)

located ~~1320~~ feet from the ~~North~~ line and ~~320~~ feet from the

~~West~~

line of Section ~~32~~, T. ~~13-N~~, R. ~~10-E~~, NMPM.

(GIVE LOCATION FROM SECTION LINE)

~~East 1/4 Sec 32~~ Pool, ~~1320~~ County

If State Land the Oil and Gas Lease is No. ~~2-1377~~

If patented land the owner is

Address

We propose to drill well with drilling equipment as follows: ~~Rotary Tools~~

The status of plugging bond is ~~\$10,000.00 - Northwest Drilling Co.~~

Drilling Contractor

We intend to complete this well in the ~~Green & Grayburg~~ formation at an approximate depth of ~~2100~~ feet.

CASING PROGRAM

We propose to use the following strings of Casing and to cement them as indicated:

Size of Hole	Size of Casing	Weight per Foot	New or Second Hand	Depth	Sacks Cement
12-1/4"	8-1/2"	25	New	400	100
8-1/2"	6-1/2"	25	New	2100	200

If changes in the above plans become advisable we will notify you immediately.

ADDITIONAL INFORMATION (If recompletion give full details of proposed plan of work.)

Approved AUG 30 1961, 19.....
Except as follows:

OIL CONSERVATION COMMISSION

By M. L. Armstrong

Title OIL AND GAS INSPECTOR

Sincerely yours,

Harry E. Buss

(Company or Operator)

By C. H. Sanders

Position Petroleum Engineer

Send Communications regarding well to

Name G. E. Buss

Address Box 1174

Manzano, Santa

NEW MEXICO OIL CONSERVATION COMMISSION
WELL LOCATION AND ACREAGE DEDICATION PLAT

RECEIVED

AUG 30 1961 C-128
Revised 5/1/57

SEE INSTRUCTIONS FOR COMPLETING THIS FORM ON THE REVERSE SIDE

D. E. C.
ARTESIAN OFFICE

SECTION A

Operator Perry R. Bass		Lease Seltzer-State		Well No. 1
Unit Letter B	Section 12	Township 19 South	Range 28 East	County Eddy
Actual Footage Location of Well: 2310 feet from the North line and 330 feet from the West line				
Ground Level Elev. 3402.80	Producing Formation Queen-Grayburg	Pool East Millman Grayburg-Queen	Dedicated Acreage: 40 Acres	

1. Is the Operator the only owner in the dedicated acreage outlined on the plat below? YES ☒ NO ____ . ("Owner" means the person who has the right to drill into and to produce from any pool and to appropriate the production either for himself or for himself and another. (65-3-29 (e) NMSA 1935 Comp.)
2. If the answer to question one is "no," have the interests of all the owners been consolidated by communitization agreement or otherwise? YES ____ NO ____ . If answer is "yes," Type of Consolidation ____
3. If the answer to question two is "no," list all the owners and their respective interests below:

Owner	Lead Description

SECTION B

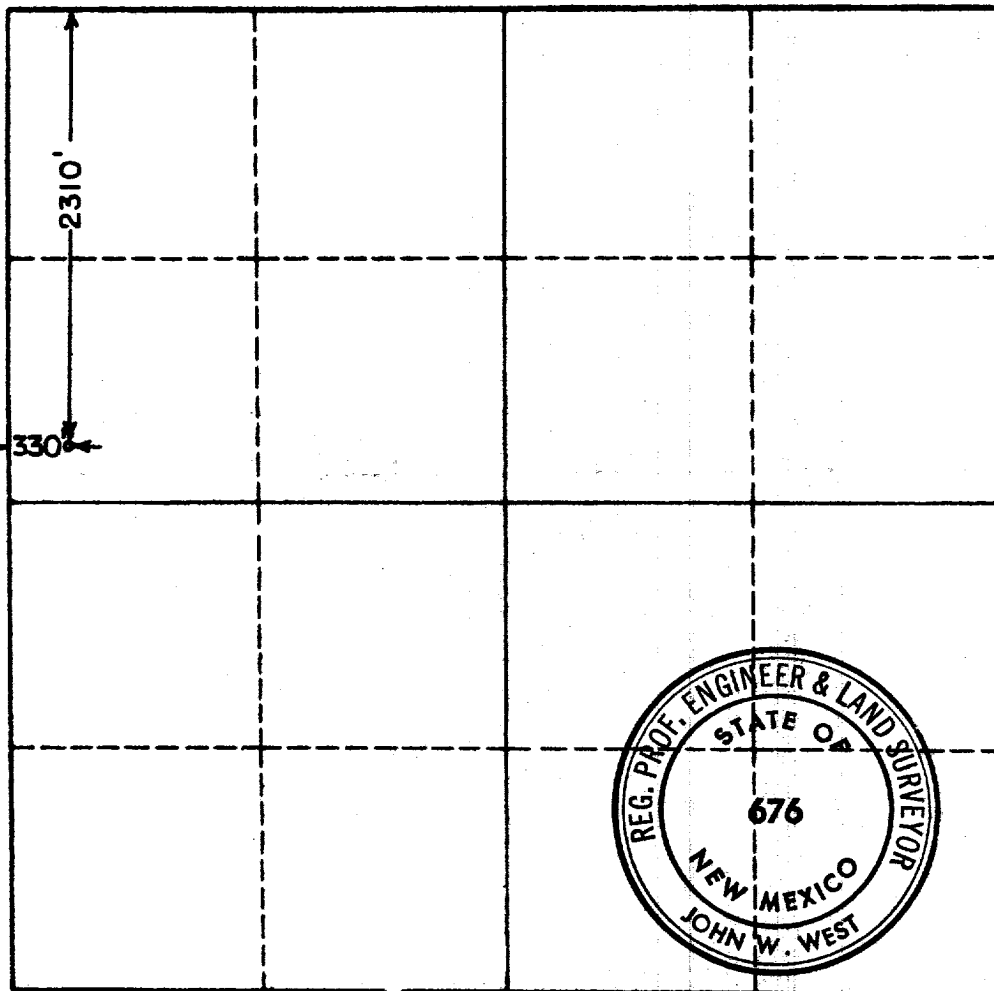

CERTIFICATION

I hereby certify that the information in SECTION A above is true and complete to the best of my knowledge and belief.

Name <i>John W. West</i>
Position Engineer
Company Perry R. Bass
Date Aug. 30. 1961

I hereby certify that the well location shown on the plat in SECTION B was plotted from field notes of actual surveys made by me or under my supervision, and that the same is true and correct to the best of my knowledge and belief.

Date Surveyed Aug. 29, 1961
Registered Professional Engineer and/or Land Surveyor, JOHN W. WEST <i>John W. West</i>
Certificate No. N. M. - P. E. & L. S. NO. 676

0 330 660 990 1320 1650 1980 2310 2640 2000 1500 1000 500 0