

(SUBMIT IN TRIPLICATE)

UNITED STATES
DEPARTMENT OF THE INTERIOR
GEOLOGICAL SURVEY

Budget Bureau No. 42-R358.4
Approval expires 12-31-60.

Land Office 30-015-02229
Lease No. LC 069107
Unit Elliott & Farrell

SUNDRY NOTICES AND REPORTS ON WELLS

NOTICE OF INTENTION TO DRILL	<input checked="" type="checkbox"/>	SUBSEQUENT REPORT OF WATER SHUT-OFF	
NOTICE OF INTENTION TO CHANGE PLANS		SUBSEQUENT REPORT OF SHOOTING OR ACIDIZING	
NOTICE OF INTENTION TO TEST WATER SHUT-OFF		SUBSEQUENT REPORT OF ALTERING CASING	
NOTICE OF INTENTION TO RE-DRILL OR REPAIR WELL		SUBSEQUENT REPORT OF RE-DRILLING OR REPAIR	
NOTICE OF INTENTION TO SHOOT OR ACIDIZE		SUBSEQUENT REPORT OF ABANDONMENT	
NOTICE OF INTENTION TO PULL OR ALTER CASING		SUPPLEMENTARY WELL HISTORY	
NOTICE OF INTENTION TO ABANDON WELL			

(INDICATE ABOVE BY CHECK MARK NATURE OF REPORT, NOTICE, OR OTHER DATA)

October 13, 1958

Elliott-Parcell
Well No. 3 is located 1980 ft. from N line and 660 ft. from E line of sec 13

Sec. 13 C SE NE T. 19 N. R. 28 E. N.M.P.M.
(1/4 Sec. and Sec. No.) (Twp.) (Range) (Meridian)
Undesignated Edley New Mexico
(Field) (County or Subdivision) (State or Territory)

The elevation of the derrick floor above sea level is 1371 ft. ground level

DETAILS OF WORK

(State names of and expected depths to objective sands; show sizes, weights, and lengths of proposed casings; indicate mudding jobs, cementing points, and all other important proposed work)

Propose to drill to approximately 2300 feet with cable tools to test the Grayburg formation.

The following casing program is as follows:

10-inch casg. will be set & cemented at approximately 380 ft. with approx. 50 sacks.
7-inch casg. will be set and cemented at total depth with 300 sacks cement if pay is encountered.

3-5/8" casg. will be set at approx. 1300 ft. if necessary to protect any water encountered.

I understand that this plan of work must receive approval in writing by the Geological Survey before operations may be commenced.
Roach & Shepard Drilling Contractors with cable tools.

Company John W. Gates

Address Box 596

Artesia, New Mexico

RECEIVED
OCT 13 1958

By

Title

Owner

NEW MEXICO OIL CONSERVATION COMMISSION
Well Location and Acreage Dedication Plat

Section A.

Date October 8, 1958

Operator John W. Gates Lease Parcel
Well No. 5 Unit Letter H Section 13 Township 19 S Range 28 E NMPM
Located 1980 Feet From N Line 660 Feet From E Line
County Eddy G. L. Elevation 3371 Dedicated Acreage 40 Acres
Name of Producing Formation Grayburg Pool Undesignated

1. Is the Operator the only owner* in the dedicated acreage outlined on the plat below?
Yes X No .
2. If the answer to question one is "no," have the interests of all the owners been consolidated by communitization agreement or otherwise? Yes No . If answer is "yes," Type of Consolidation
3. If the answer to question two is "no," list all the owners and their respective interests below:

Owner

Land Description

Section B

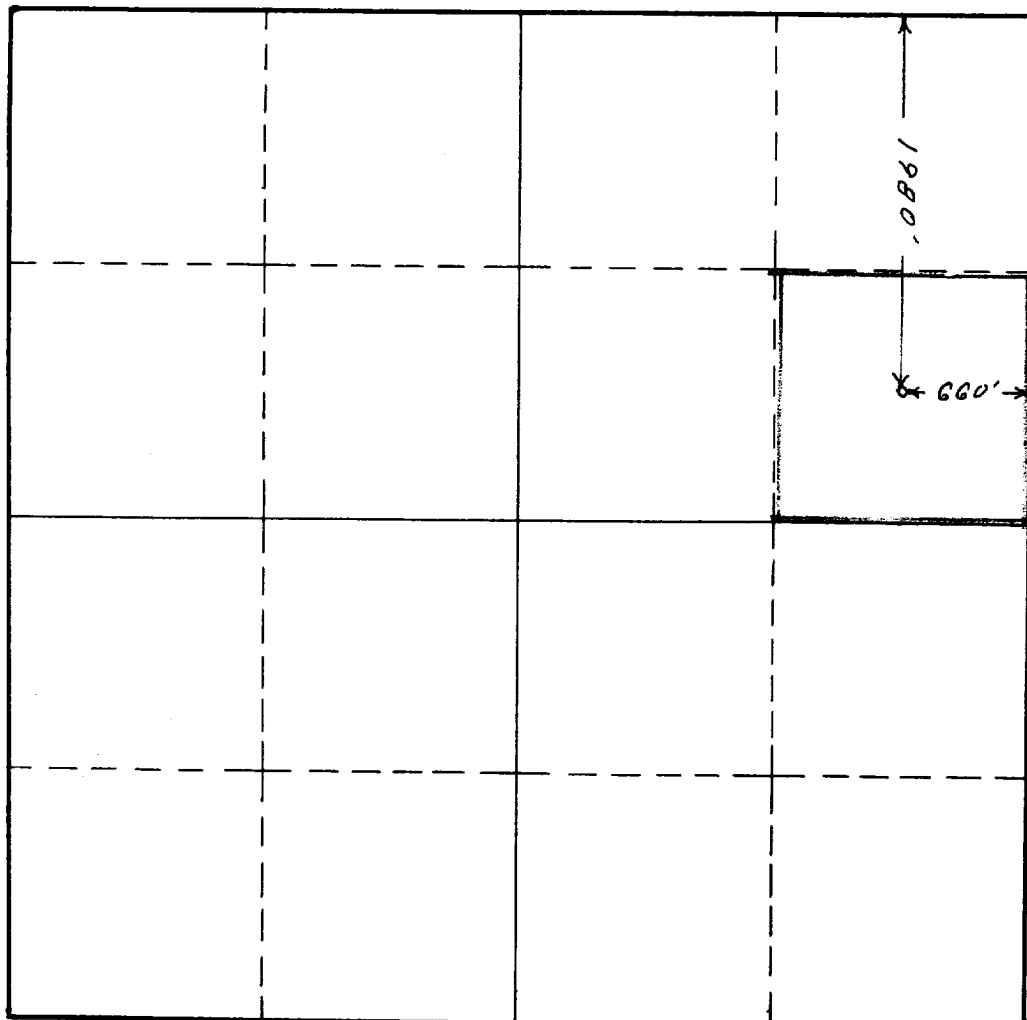

RECEIVED
OCT 10 1958
L. S. SHELTON
ARIZONA, NEW MEXICO
This is to certify that the information in Section A above is true and complete to the best of my knowledge and belief.

John W. Gates

(Operator)

John W. Gates
(Representative)

Artesia, New Mexico

Address

This is to certify that the well location shown on the plat in Section B was plotted from field notes of actual surveys made by me or under my supervision and that the same is true and correct to the best of my knowledge and belief.

Date Surveyed Oct. 7, 1958

W. P. Sheldon
Registered Professional
Engineer and/or Land Surveyor.

Certificate No. 963

(See instructions for completing this form on the reverse side)