

JUN 12 1959

WELL RECORD

Mail to District Office, Oil Conservation Commission, to which Form C-101 was sent not later than twenty days after completion of well. Follow instructions in Rules and Regulations of the Commission. Submit in **QUINTUPLICATE**. If State Land submit 6 Copies

**AREA 640 ACRES
LOCATE WELL CORRECTLY**

Western - Yates
(Company or Operator)

State 648, Tract 15
(Lease)

Well No. 149, in NW $\frac{1}{4}$ of NE $\frac{1}{4}$, of Sec. 14, T. 19 S, R. 28 E, NMPM.

E. Millman Queen Grayburg ✓ Pool, Eddy County.

Well is 660 feet from North line and 1980 feet from East line
of Section 14. If State Land the Oil and Gas Lease No. is 648

Drilling Commenced May 4, 1959 Drilling was Completed June 2, 1959

Name of Drilling Contractor..... **Roach & Shepard**

Address..... **Artesia, New Mexico**

Elevation above sea level at Top of Tubing Head.....**3417 DF**..... The information given is to be kept confidential until
.....*******....., 19.....

OIL SANDS OR ZONES

No. 1, from 1818 to 1834 No. 4, from.....to.....

No. 2, from.....**1853**.....to.....**1859**..... No. 5, from.....to.....

No. 3, from **2100** to **2112** No. 6, from _____ to _____

IMPORTANT WATER SANDS

Include data on rate of water inflow and elevation to which water rose in hole.

No. 1, from 195 to _____ feet. _____

No. 2, from 395 to feet.

No. 3, from.....to.....feet.

No. 4, from.....to.....feet.

CASING RECORD

SIZE	WEIGHT PER FOOT	NEW OR USED	AMOUNT	KIND OF SHOE	CUT AND PULLED FROM	PERFORATIONS	PURPOSE
10 3/4	32.75	New	423	Guide	--	--	Surface
8 5/8	24	Used	1893	Guide	Pulled all	--	
4 1/2	11.6	New	2287	Guide	---	1818-34, 1853-59 2100-12	Production

MUDDING AND CEMENTING RECORD

SIZE OF HOLE	SIZE OF CASING	WHERE SET	NO. SACKS OF CEMENT	METHOD USED	MUD GRAVITY	AMOUNT OF MUD USED
12"	10 3/4	423	75	Pump and plug	---	---
10"	8 5/8	1893	---	Pump	---	20 sac
8"	4 1/2	2287	300	Pump and plug	---	---

RECORD OF PRODUCTION AND STIMULATION

(Record the Process used, No. of Qts. or Gals. used, interval treated or shot.)

SOF 2100-2112' with 23,000 gals. and 47,000 lbs. sand.

SOF 1853-1859' with 15,000 gals. and 34,750 lbs. sand.

SOF 1818-1834' with 11,500 gals. and 28,500 lbs. sand.

Result of Production Stimulation..... **Well flowed 160 BOPD**

Depth Cleaned Out.....2247

RECORD OF DRILL-STEM AND SPECIAL TESTS

If drill-stem or other special tests or deviation surveys were made, submit report on separate sheet and attach hereto

TOOLS USED

Rotary tools were used from.....feet to.....feet, and from.....feet to.....feet.
Cable tools were used from.....feet to.....feet, and from.....feet to.....feet.

PRODUCTION

Put to Producing.....**June 11, 1959**....., 19.....
OIL WELL: The production during the first 24 hours was.....**160**.....barrels of liquid of which.....**100**.....% was
was oil;% was emulsion;% water; and.....% was sediment. A.P.I.
Gravity.....**39.5 A.P.I.**.....
GAS WELL: The production during the first 24 hours was.....M.C.F. plus.....barrels of
liquid Hydrocarbon. Shut in Pressure.....lbs.
Length of Time Shut in.....

PLEASE INDICATE BELOW FORMATION TOPS (IN CONFORMANCE WITH GEOGRAPHICAL SECTION OF STATE):

Southeastern New Mexico

Northwestern New Mexico

T. Anhy.....	T. Devonian.....	T. Ojo Alamo.....
T. Salt..... 390	T. Silurian.....	T. Kirtland-Fruitland.....
B. Salt..... 620	T. Montoya.....	T. Farmington.....
T. Yates.....	T. Simpson.....	T. Pictured Cliffs.....
T. 7 Rivers.....	T. McKee.....	T. Menefee.....
T. Queen..... 1621	T. Ellenburger.....	T. Point Lookout.....
T. Grayburg..... 2030	T. Gr. Wash.....	T. Mancos.....
T. San Andres.....	T. Granite.....	T. Dakota.....
T. Glorieta.....	T.	T. Morrison.....
T. Drinkard.....	T.	T. Penn.....
T. Tubbs.....	T.	T.
T. Abo.....	T.	T.
T. Penn.....	T.	T.
T. Miss.....	T.	T.

FORMATION RECORD

From	To	Thickness in Feet	Formation	From	To	Thickness in Feet	Formation
0	20	20	Caliche				
20	270	250	Shale and sand				
270	390	120	Anhy. and red shale				
390	423	33	Salt				
423	450	27	Anhy.				
450	620	170	Salt				
620	1080	460	Anhy.				
1080	1105	25	Sand				
1105	1130	25	Anhy.				
1130	1190	60	Dolo. and shale				
1190	1210	20	Red sand				
1210	1270	60	Dolo 30% pink				
1270	1300	30	Dolo.				
1300	1670	370	Dolo. 75% pink				
1670	1720	50	Red Sand				
1720	1810	90	Dolo.				
1810	2000	190	Sand and Dolo.				
2000	2120	120	Dolo.				
2120	2240	120	Dolo. and sand				
2240	2288	48	Dolo.				
			Total Depth 2288				

OIL CONSERVATION COMMISSION	
ARTESIA DISTRICT OFFICE	
No. Copies Received	
DISTRIBUTION	
OPERATOR	
SANTA FE	
PRODUCTION OFFICE	
STATE LAND OFFICE	
U. S. G. S.	
TRANSPORTER	
FILE	
BUREAU OF MINES	

ATTACH SEPARATE SHEET IF ADDITIONAL SPACE IS NEEDED

I hereby swear or affirm that the information given herewith is a complete and correct record of the well and all work done on it so far as can be determined from available records.

June 12, 1959

Company or Operator.....**Western - Yates**.....

Address.....**P.O. Box 427, Artesia, N.M.**.....(Date)

Name.....**W.B. Macey**.....

Position or Title.....**Chairman of Operating Committee**.....

NEW MEXICO OIL CONSERVATION COMMISSION
Santa Fe, New Mexico

RECEIVED
Form C-104
Revised 7/1/57

REQUEST FOR (OIL) - (GAS) ALLOWABLE JUN 12 1959 New Well
Recompletion

This form shall be submitted by the operator before an initial allowable will be assigned to any completed Oil or Gas well. Form C-104 is to be submitted in QUADRUPLICATE to the same District Office to which Form C-101 was sent. The allowable will be assigned effective 7:00 A.M. on date of completion or recompletion, provided this form is filed during calendar month of completion or recompletion. The completion date shall be that date in the case of an oil well when new oil is delivered into the stock tanks. Gas must be reported on 15.025 psia at 60° Fahrenheit.

Artesia, New Mexico June 12, 1959
(Place) (Date)

WE ARE HEREBY REQUESTING AN ALLOWABLE FOR A WELL KNOWN AS:

Western - Yates State 648, Tr. 15, Well No. 149, in NW 1/4 NE 1/4,
(Company or Operator) (Lease)
B. V., Sec. 14, T. 19 S., R. 28 E., NMPM, E. Millman Queen Grayburg Pool
Unit Letter

Eddy

Please indicate location:

D	C	B	A
E	F	G	H
L	K	J	I
M	N	O	P

640° N and 1920° E

Tubing, Casing and Cementing Record

Size	Feet	Sax
10 3/4	423	75
4 1/2	2287	300
2"	1798	

County. Date Spudded 5-4-59 Date Drilling Completed 6-2-59
Elevation 3417 DF Total Depth 2288' PBD 2247'

Top Oil/Gas Pay 1818-34' Name of Prod. Form. Queen Grayburg

PRODUCING INTERVAL -

Perforations 1818-1834', 1853-1859', 2100-2112'

Open Hole None Depth 2287' Depth Casing Shoe 1798'

OIL WELL TEST -

Natural Prod. Test: 24 bbls. oil, -- bbls water in 24 hrs, -- min. Choke Size

Test After Acid or Fracture Treatment (after recovery of volume of oil equal to volume of load oil used): 160 bbls. oil, --- bbls water in 24 hrs, -- min. Choke 3/4"

GAS WELL TEST -

Natural Prod. Test: MCF/Day; Hours flowed Choke Size

Method of Testing (pitot, back pressure, etc.):

Test After Acid or Fracture Treatment: MCF/Day; Hours flowed

Choke Size Method of Testing:

Acid or Fracture Treatment (Give amounts of materials used, such as acid, water, oil, and sand): 49,500 gals. and 110,250 lbs. sand.

Casing Tubing Date first new Press. 580 Press. 450 oil run to tanks June 11, 1959

Oil Transporter Continental Pipe Line Company

Gas Transporter None

Remarks:

I hereby certify that the information given above is true and complete to the best of my knowledge.

Approved JUN 12 1959, 19

OIL CONSERVATION COMMISSION

By: M. K. Armstrong

Title OIL AND GAS INSPECTOR

Western - Yates

(Company or Operator)

By: W. B. Macey

(Signature)

Title Chairman of Operating Committee

Send Communications regarding well to:

Name Western - Yates

Address P.O. Box 427, Artesia, N.M.

OIL CONSERVATION COMMISSION	
ARTESIA DISTRICT OFFICE	
No. Copies Received	
DISTRICT	
OPERATOR	
SANTA FE	
PROBATION OFFICE	
STATE LAND OFFICE	
U. S. G. S.	
TRANSPORTER	
FEE	
BUREAU OF MINES	

NEW MEXICO OIL CONSERVATION COMMISSION
SANTA FE, NEW MEXICO

Form C-110

Revised 7/1/55

(File the original and 4 copies with the appropriate district office)

CERTIFICATE OF COMPLIANCE AND AUTHORIZATION
TO TRANSPORT OIL AND NATURAL GAS

JUN 12 1959

Company or Operator Western - Yates Lease State 648, Tr. 15
Well No. 149 Unit Letter B S 14 T 19S R 28E Pool E. Millman Queen Grayburg
County Eddy Kind of Lease (State, Fed. or Patented) State
If well produces oil or condensate, give location of tanks: Unit B S 14 T 19S R 28E
Authorized Transporter of Oil or ~~Condensate~~ Continental Pipe Line Company
Address P. O. Box 367, Artesia, New Mexico
(Give address to which approved copy of this form is to be sent)
Authorized Transporter of Gas None
Address _____
(Give address to which approved copy of this form is to be sent)
If Gas is not being sold, give reasons and also explain its present disposition:
No market for casinghead.

Reasons for Filing: (Please check proper box) New Well XX
Change in Transporter of (Check One): Oil () Dry Gas () C'head () Condensate ()
Change in Ownership _____ () Other _____ ()
Remarks: _____ (Give explanation below)

The undersigned certifies that the Rules and Regulations of the Oil Conservation Commission have been complied with.

Executed this the 12th day of June 19 59.

Approved JUN 12 1959 19 _____

OIL CONSERVATION COMMISSION
By McArmstrong
Title OIL AND GAS INSPECTOR

By W. J. Donacy
Title Chairman of Operating Committee
Company Western - Yates
Address P. O. Box 427
Artesia, New Mexico

OIL CONSERVATION COMMISSION	
ARTESIA DISTRICT OFFICE	
No. Copies Received	77
L. S. 1000 1000	
DATE	4
BY	
FOR	
ST. 11 1A	
U. S. G.	
TRANSFER	

NEW MEXICO OIL CONSERVATION COMMISSION

RECEIVED
FORM C-103
(Rev. 3-55)

MISCELLANEOUS REPORTS ON WELLS

(Submit to appropriate District Office as per Commission Rule 1106)

JUN 12 1959

Name of Company Western - Yates		Address P. O. Box 427, Artesia, N.M.			
Lease State 648, Tract 15	Well No. 149	Unit Letter B	Section 14	Township 19 S	Range 28 E
Date Work Performed	Pool E. Millman Queen Grayburg		County Eddy		

THIS IS A REPORT OF: (Check appropriate block)

- ☐ Beginning Drilling Operations ☒ Casing Test and Cement Job ☐ Other (Explain):
☐ Plugging ☐ Remedial Work

Detailed account of work done, nature and quantity of materials used, and results obtained.

June 3, 1959 At T.D. 2288' in lime, we pulled 1893' of 8 5/8" casing which had been set and mudded to shut off oil from the Queen formation.

We then ran 2287' of new 4 1/2" seamless casing and cemented it with 300 sacks neat cement. After waiting on cement, we will run logs, perforate and Sand-oil fracture for production.

Witnessed by	Position	Company
--------------	----------	---------

FILL IN BELOW FOR REMEDIAL WORK REPORTS ONLY

ORIGINAL WELL DATA

D F Elev.	T D	P B T D	Producing Interval	Completion Date
Tubing Diameter	Tubing Depth	Oil String Diameter	Oil String Depth	
Perforated Interval(s)				
Open Hole Interval		Producing Formation(s)		

RESULTS OF WORKOVER

Test	Date of Test	Oil Production BPD	Gas Production MCFPD	Water Production BPD	GOR Cubic feet/Bbl	Gas Well Potential MCFPD
Before Workover						
After Workover						

OIL CONSERVATION COMMISSION		I hereby certify that the information given above is true and complete to the best of my knowledge.	
Approved by <i>M. L. Armstrong</i>		Name <i>[Signature]</i>	
Title OIL AND GAS INSPECTOR		Position Asst. Dist. Supt.	
Date JUN 12 1959		Company Western - Yates	

OIL CONSERVATION COMMISSION	
ARTESIA DISTRICT OFFICE	
No. Copies Received	
DATE	
OPERATOR	
SANITARY	
PRODUCTION	
STATE LAND OPER.	
U. S. S.	
TELEPHONE	
WELL	
DEVELOPMENT	

NEW MEXICO OIL CONSERVATION COMMISSION

MISCELLANEOUS REPORTS ON WELLS

(Submit to appropriate District Office as per Commission Rule 1106)

RECEIVED

FORM 0-103
(Rev 3-55)

JUN 12 1959

Name of Company Western - Yates				Address P. O. Box 427, Artesia, New Mexico		
Lease State 648, Tr. 15	Well No. 149	Unit Letter B /	Section 14	Township 19 S	Range 28 E	
Date Work Performed	Pool E. Millman Queen Grayburg			County Eddy		

THIS IS A REPORT OF: (Check appropriate block)

- ☐ Beginning Drilling Operations ☐ Casing Test and Cement Job ☒ Other (Explain):
☐ Plugging ☐ Remedial Work **Perforating and Sand-oil fracture**

Detailed account of work done, nature and quantity of materials used, and results obtained.

June 9, 1959 Perf. 48 h 2100-2112', SOF with 23,000 gals. and 47,000 lbs. sand. Set Bridge-plug at 1875'. Perf. 24 h 1853-1859', SOF with 15,000 gals. and 34,750 lbs. sand. Set Bridge plug at 1842'. Perf. 64 h 1818-1834', SOF with 11,500 gals. and 28,500 lbs. sand. Well sanded up. Flushed back 5,000 gals., but formation wouldn't feed. Drilled out Bridge plugs and ran 2" tubing to 1798'.

Witnessed by	Position	Company
--------------	----------	---------

FILL IN BELOW FOR REMEDIAL WORK REPORTS ONLY

ORIGINAL WELL DATA

D F Elev.	T D	P B T D	Producing Interval	Completion Date
Tubing Diameter	Tubing Depth	Oil String Diameter	Oil String Depth	
Perforated Interval(s)				
Open Hole Interval		Producing Formation(s)		

RESULTS OF WORKOVER

Test	Date of Test	Oil Production BPD	Gas Production MCFPD	Water Production BPD	GOR Cubic feet/Bbl	Gas Well Potential MCFPD
Before Workover						
After Workover						

OIL CONSERVATION COMMISSION		I hereby certify that the information given above is true and complete to the best of my knowledge.	
Approved by <i>M. H. Armstrong</i>		Name <i>[Signature]</i>	
Title OIL AND GAS INSPECTOR		Position Asst. Dist. Supt.	
Date JUN 12 1959		Company Western - Yates	

OIL CONSERVATION COMMISSION
ARTESIA DISTRICT OFFICE

No. Copies Recd.

OPERATOR

SUNOCO INC.

1000 N. 10th St.

Artesia, N.M.

1000 N. 10th St.

Artesia, N.M.

1000 N. 10th St.

Artesia, N.M.

NEW MEXICO OIL CONSERVATION COMMISSION

FORM C-103
(Rev 3-55)

MISCELLANEOUS REPORTS ON WELLS

(Submit to appropriate District Office as per Commission Rule 1106)

Name of Company Western - Yates				Address P. O. Box 427, Artesia, N.M.			
Lease State 648 2r15	Well No. 149	Unit Letter B	Section 14	Township 19 S	Range 28 E		
Date Work Performed		Pool E. Millman Queen Grayburg			County Eddy		

THIS IS A REPORT OF: (Check appropriate block)

<input checked="" type="checkbox"/> Beginning Drilling Operations	<input checked="" type="checkbox"/> Casing Test and Cement Job	<input type="checkbox"/> Other (Explain):
<input type="checkbox"/> Plugging	<input type="checkbox"/> Remedial Work	

Detailed account of work done, nature and quantity of materials used, and results obtained.

May 4, 1959 Begin drilling operations.

May 8, 1959 At T. D. 423' in salt we ran 423' of new 10 3/4" seamless 32.75 lb. casing and cemented with 75 sacks neat cement with 4% C.C. After waiting on cement 36 hrs. drilled plug and tested water shut off 1 hr. O.K. Top of salt at 390' and we had good show of water at 190' and a show of water at 390' on top of salt.

Witnessed by Loree Evans	Position Field Supt.	Company Western - Yates
------------------------------------	--------------------------------	-----------------------------------

FILL IN BELOW FOR REMEDIAL WORK REPORTS ONLY

ORIGINAL WELL DATA

D F Elev.	T D	P B T D	Producing Interval	Completion Date
Tubing Diameter	Tubing Depth	Oil String Diameter	Oil String Depth	
Perforated Interval(s)				
Open Hole Interval			Producing Formation(s)	

RESULTS OF WORKOVER

Test	Date of Test	Oil Production BPD	Gas Production MCFPD	Water Production BPD	GOR Cubic feet/Bbl	Gas Well Potential MCFPD
Before Workover						
After Workover						

OIL CONSERVATION COMMISSION

I hereby certify that the information given above is true and complete to the best of my knowledge.

Approved by <i>W. A. Gressett</i>	Name <i>P. C. Harwood</i>
Title OIL AND GAS INSPECTOR	Position Dist. Supt.
Date JUN 10 1959	Company Western - Yates

OIL CONSERVATION COMMISSION	
ADMINISTRATIVE OFFICE	
No.	5
<div style="text-align: right;">3</div>	
Transmitted	
File	1 ✓

NEW MEXICO OIL CONSERVATION COMMISSION

FORM C-103
(Rev 3-55)

MISCELLANEOUS REPORTS ON WELLS

(Submit to appropriate District Office as per Commission Rule 1106)

Name of Company Western - Yates				Address P. O. Box 427, Artesia, New Mexico			
Lease State 648, Tract 15	Well No. 149	Unit Letter B	Section 14	Township 19 S	Range 28 E		
Date Work Performed April 22, 1959		Pool E. Millman Queen Grayburg			County Eddy		

THIS IS A REPORT OF: (Check appropriate block)

- ☐ Beginning Drilling Operations ☐ Casing Test and Cement Job ☒ Other (Explain):
☐ Plugging ☐ Remedial Work **Change well location**

Detailed account of work done, nature and quantity of materials used, and results obtained.

The above captioned well was formerly located in unit letter "I".

1980' from South line and 660' from ^{East} West line of Section 14-19S-28E.

Well No. 149 now located in unit letter "B".

660' from North line and 1980' from East line of Section 14-19S-28E.

Witnessed by	Position	Company
--------------	----------	---------

FILL IN BELOW FOR REMEDIAL WORK REPORTS ONLY

ORIGINAL WELL DATA

D F Elev.	T D	P B T D	Producing Interval	Completion Date
Tubing Diameter	Tubing Depth	Oil String Diameter	Oil String Depth	
Perforated Interval(s)				
Open Hole Interval			Producing Formation(s)	

RESULTS OF WORKOVER

Test	Date of Test	Oil Production BPD	Gas Production MCFPD	Water Production BPD	GOR Cubic feet/Bbl	Gas Well Potential MCFPD
Before Workover						
After Workover						

OIL CONSERVATION COMMISSION

I hereby certify that the information given above is true and complete to the best of my knowledge.

Approved by <i>M. L. Armstrong</i>	Name <i>H. C. Hanson</i>
Title <i>Dist. Supt.</i>	Position Dist. Supt.
Date	Company Western - Yates

NEW MEXICO OIL CONSERVATION COMMISSION
Well Location and Acreage Dedication Plat

Section A.

Date April 23, 1959

Operator Western - Yates Lease State 648, Tr. 15
Well No. 149 Unit Letter B Section 14 Township 19 S Range 28 E NMPM
Located 660 Feet From North Line, 1980 Feet From East Line
County Eddy G. L. Elevation _____ Dedicated Acreage 40 Acres
Name of Producing Formation Queen Grayburg Pool E. Millman Queen Grayburg

1. Is the Operator the only owner* in the dedicated acreage outlined on the plat below?
Yes XX No _____.
2. If the answer to question one is "no," have the interests of all the owners been consolidated by communitization agreement or otherwise? Yes _____ No _____. If answer is "yes," Type of Consolidation _____
3. If the answer to question two is "no," list all the owners and their respective interests below:

Owner

Land Description

Section B

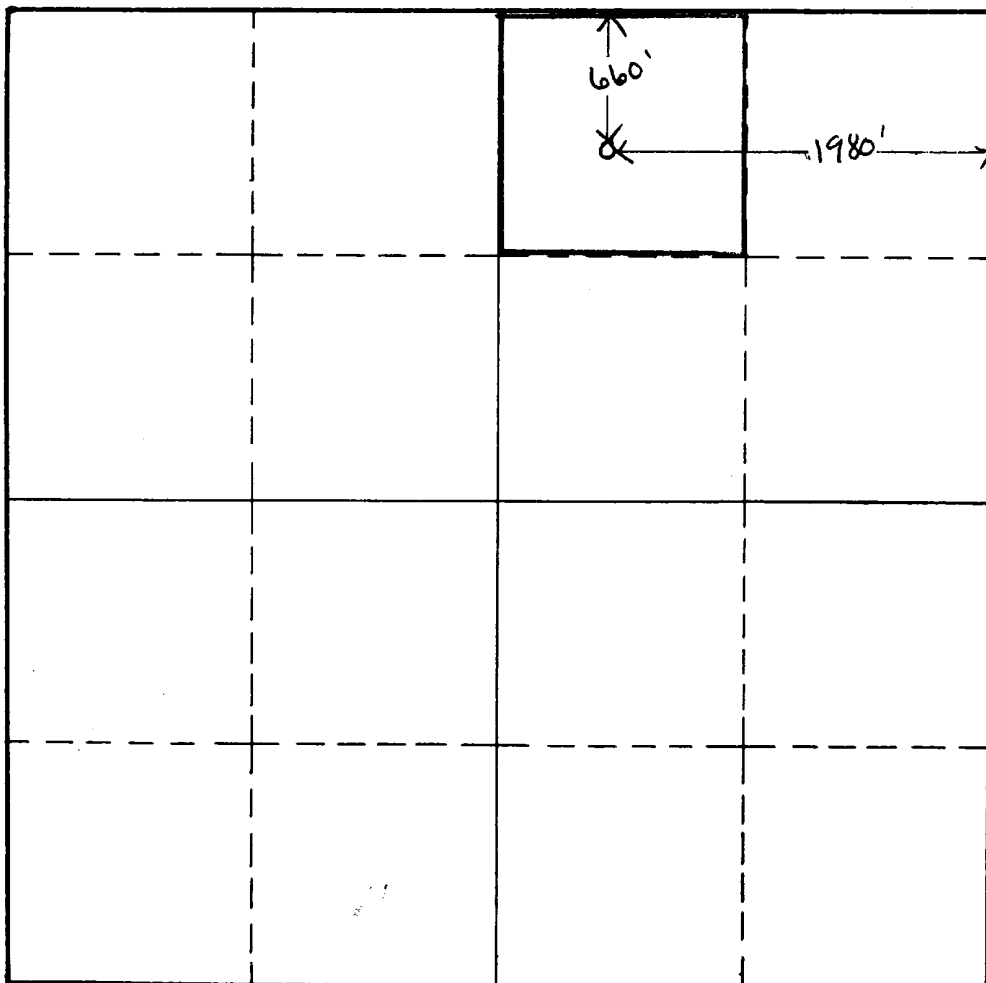

This is to certify that the information in Section A above is true and complete to the best of my knowledge and belief.

Western - Yates
(Operator)

W. B. Bracey
(Representative)
Chairman of Operating Comm.
P.O. Box 427, Artesia, N. M.
Address

This is to certify that the well location shown on the plat in Section B was plotted from field notes of actual surveys made by me or under my supervision and that the same is true and correct to the best of my knowledge and belief.

Date Surveyed 4-6-59

W. B. Bracey
Registered Professional
Engineer and/or Land Surveyor.

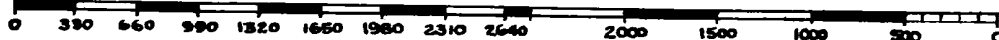

(See instructions for completing this form on the reverse side)

Certificate No. 926

INSTRUCTIONS FOR COMPLETION

1. Operator shall furnish and certify to the information called for in Section A.
2. Operator shall outline the dedicated acreage for both oil and gas wells on the plat in Section B.
3. A registered professional engineer or land surveyor registered in the State of New Mexico or approved by the Commission shall show on the plat the location of the well and certify this information in the space provided.
4. All distances shown on the plat must be from the outer boundaries of Section.
5. If additional space is needed for listing owners and their respective interests as required in question 3, Section A, please use space below

* "Owner" means the person who has the right to drill into and to produce from any pool and to appropriate the production either for himself or for himself and another. (65-3-29 (e) NMSA 1953 Comp.)