

NEW MEXICO OIL CONSERVATION COMMISSION
Santa Fe, New Mexico

Form G-101
Revised (12/1/55)

NOTICE OF INTENTION TO DRILL

Notice must be given to the District Office of the Oil Conservation Commission and approval obtained before drilling or recompletion begins. If changes in the proposed plan are considered advisable, a copy of this notice showing such changes will be returned to the sender. Submit this notice in QUINTUPPLICATE. One copy will be returned following approval. See additional instructions in Rules and Regulations of the Commission. If State Land submit 6 Copies Attach Form G-128 in triplicate to first 3 copies of form G-101

Artesia, New Mexico
(Place)

April 23, 1959
(Date)

OIL CONSERVATION COMMISSION
SANTA FE, NEW MEXICO

Gentlemen:

You are hereby notified that it is our intention to commence the Drilling of a well to be known as

Western - Yates
(Company or Operator)

State 648, Tract 15
(Lease)

Well No. 150, in P. The well is
(Unit)

located 660 feet from the South line and 660 feet from the
East line of Section 15, T. 19S, R. 28E, NMPM.

(GIVE LOCATION FROM SECTION LINE) Undesignated Pool, Eddy County

If State Land the Oil and Gas Lease is No. 648

If patented land the owner is

Address

We propose to drill well with drilling equipment as follows: Cable tools

The status of plugging bond is Blanket Bond on file with O. C. C.

Drilling Contractor Roach & Shepard
Artesia, New Mexico

We intend to complete this well in the Queen Grayburg
formation at an approximate depth of 2500 feet.

CASING PROGRAM

We propose to use the following strings of Casing and to cement them as indicated:

Size of Hole	Size of Casing	Weight per Foot	New or Second Hand	Depth	Sacks Cement
12 1/2"	10 3/4"	32.75 lb.	New	300'	75
8"	4 1/2"	11.6 lb.	New	2400'	200

If changes in the above plans become advisable we will notify you immediately.

ADDITIONAL INFORMATION (If recompletion give full details of proposed plan of work.)

Approved _____, 19____
Except as follows:

Sincerely yours, Western - Yates

(Company or Operator)

By

Position Dist. Supt.
Send Communications regarding well to

Name Western - Yates

Address P.O. Box 427, Artesia, N. M.

OIL CONSERVATION COMMISSION

By

M. L. Armstrong

NEW MEXICO OIL CONSERVATION COMMISSION
Well Location and Acreage Dedication Plat

Section A.

Date April 23, 1959

Operator Western - Yates Lease State 648, Tract 15
Well No. 150 Unit Letter P Section 15 Township 19 S Range 28 E NMPM
Located 660 Feet From South Line, 660 Feet From East Line
County Eddy G. L. Elevation _____ Dedicated Acreage 40 Acres
Name of Producing Formation Queen Grayburg Pool Undesignated

1. Is the Operator the only owner* in the dedicated acreage outlined on the plat below?
Yes XX No _____.
2. If the answer to question one is "no," have the interests of all the owners been consolidated by communitization agreement or otherwise? Yes _____ No _____. If answer is "yes," Type of Consolidation _____
3. If the answer to question two is "no," list all the owners and their respective interests below:

Owner

Land Description

Section B

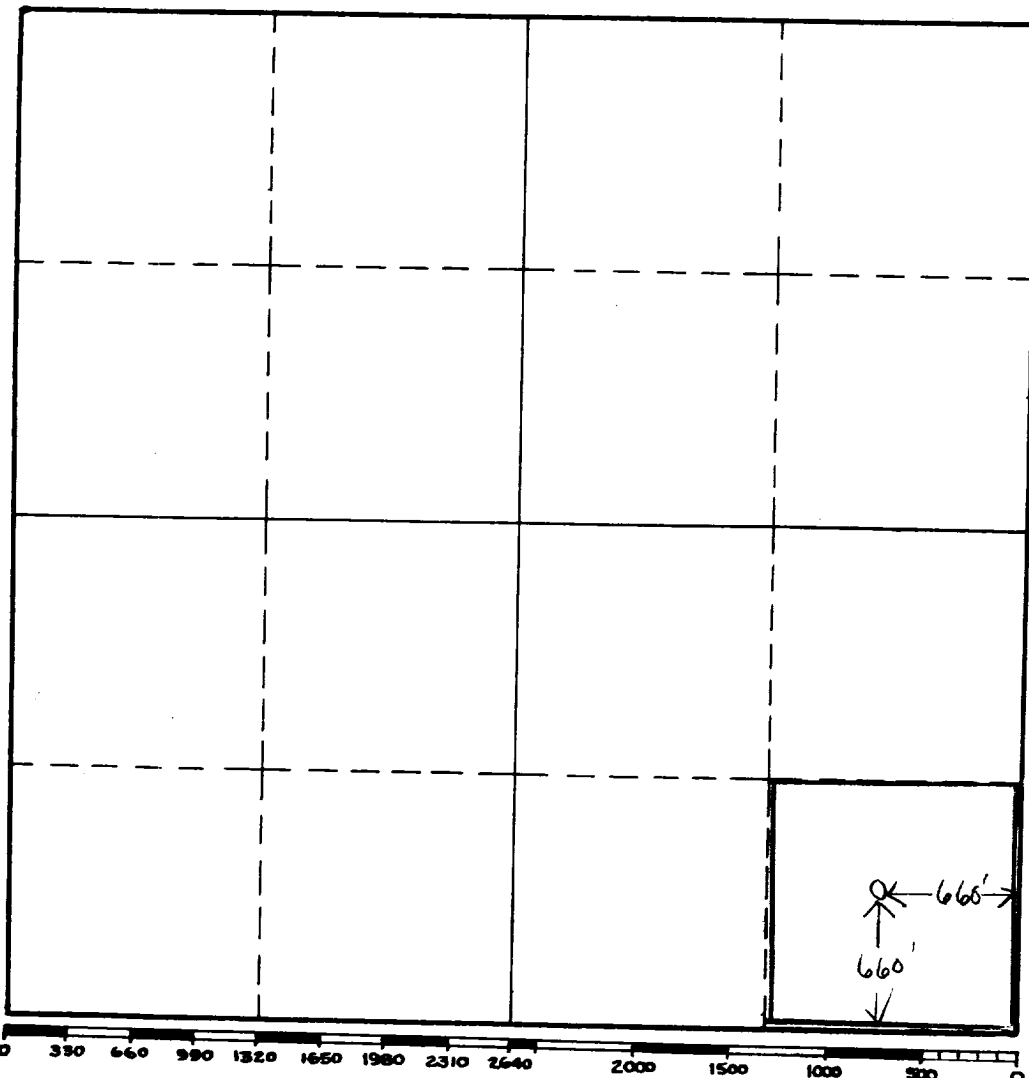

This is to certify that the information in Section A above is true and complete to the best of my knowledge and belief.

Western - Yates
(Operator)

W. L. Harrison
(Representative)

Dist. Supt.
P.O. Box 427, Artesia, N.M.
Address

This is to certify that the well location shown on the plat in Section B was plotted from field notes of actual surveys made by me or under my supervision and that the same is true and correct to the best of my knowledge and belief.

Date Surveyed 4-14-59

W. B. Macey
Registered Professional
Engineer and/or Land Surveyor.

Certificate No. 926

(See instructions for completing this form on the reverse side)

INSTRUCTIONS FOR COMPLETION

1. Operator shall furnish and certify to the information called for in Section A.
2. Operator shall outline the dedicated acreage for both oil and gas wells on the plat in Section B.
3. A registered professional engineer or land surveyor registered in the State of New Mexico or approved by the Commission shall show on the plat the location of the well and certify this information in the space provided.
4. All distances shown on the plat must be from the outer boundaries of Section.
5. If additional space is needed for listing owners and their respective interests as required in question 3, Section A, please use space below

* "Owner" means the person who has the right to drill into and to produce from any pool and to appropriate the production either for himself or for himself and another. (65-3-29 (e) NMSA 1953 Comp.)