

NEW MEXICO OIL CONSERVATION COMMISSION
Santa Fe, New Mexico

Form G-101
Revised (12/1/55)

NOTICE OF INTENTION TO DRILL RECEIVED

Notice must be given to the District Office of the Oil Conservation Commission and approval obtained before drilling or recompletion begins. If changes in the proposed plan are considered advisable, a copy of this notice showing such changes shall be returned to the sender. Submit this notice in QUINTUPPLICATE. One copy will be returned following approval. See additional instructions in Rules and Regulations of the Commission. If State Land submit 6 Copies Attach Form G-128 in triplicate to first 3 copies of form G-101

Artesia, New Mexico

September 26, 1960

(Place)

(Date)

OIL CONSERVATION COMMISSION
SANTA FE, NEW MEXICO

Gentlemen:

You are hereby notified that it is our intention to commence the Drilling of a well to be known as

Western-Yates

(Company or Operator)

State 648, Tract 15

(Lease)

Well No. 163

N

(Unit)

located 330 feet from the South line and 1980 feet from the

West

line of Section 15

T. 19-S

R. 28-E, NMPM.

(GIVE LOCATION FROM SECTION LINE) E. Millman (Queen-Grayburg), Eddy County

If State Land the Oil and Gas Lease is No. 648

If patented land the owner is

Address

We propose to drill well with drilling equipment as follows: Cable tools to

2300'

The status of plugging bond is Blanket bond on file

Drilling Contractor Unknown

We intend to complete this well in the Queen-Grayburg

formation at an approximate depth of 2300 feet.

CASING PROGRAM

We propose to use the following strings of Casing and to cement them as indicated:

Size of Hole	Size of Casing	Weight per Foot	New or Second Hand	Depth	Sacks Cement
12-1/2	10-3/4	32.75	New	450	75
10	8-5/8	24	Used	1250	Mudded
7-3/4	4-1/2	11.6	New	2300	250

If changes in the above plans become advisable we will notify you immediately.

ADDITIONAL INFORMATION (If recompletion give full details of proposed plan of work.)

Approved SEP 26 1960
Except as follows:

Sincerely yours,

Western-Yates
(Company or Operator)

By

Position Engineer

Send Communications regarding well to

Name Western-Yates

Address P. O. Box 427, Artesia, New Mexico

OIL CONSERVATION COMMISSION

By

M. L. Armstrong
Oil and Gas Inspector

NEW MEXICO OIL CONSERVATION COMMISSION
WELL LOCATION AND ACREAGE DEDICATION **RECEIVED**

FORM C-128
Revised 5/1/57

SEE INSTRUCTIONS FOR COMPLETING THIS FORM ON THE REVERSE SIDE

SEP 26 1960

SECTION A

Operator Western-Yates		Lease State 648, Tract 15		Well No. O. O. C. 163
Unit Letter N	Section 15	Township 19 South	Range 25 East	County ARTESIA, OFFICE
Actual Footage Location of Well: 1980 feet from the West line and 330 feet from the South line				
Ground Level Elev. 3436	Producing Formation Queen-Grayburg		Pool East Millman (Queen-Grayburg)	Dedicated Acreage: 40 Acres

1. Is the Operator the only owner in the dedicated acreage outlined on the plat below? YES ☒ NO ____ . ("Owner" means the person who has the right to drill into and to produce from any pool and to appropriate the production either for himself or for himself and another. (65-3-29 (e) NMSA 1935 Comp.)
2. If the answer to question one is "no," have the interests of all the owners been consolidated by communitization agreement or otherwise? YES ____ NO ____ . If answer is "yes," Type of Consolidation ____
3. If the answer to question two is "no," list all the owners and their respective interests below:

Owner	Land Description

SECTION B

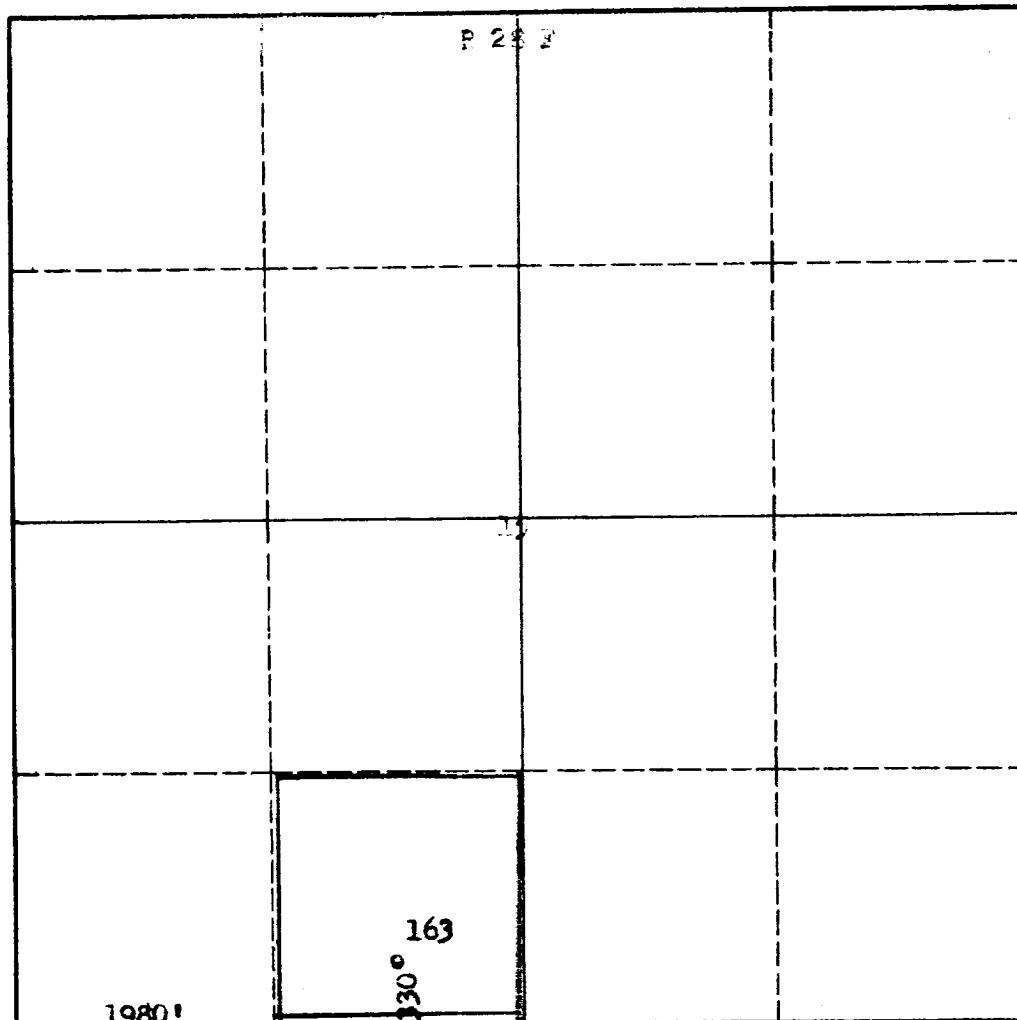

CERTIFICATION

I hereby certify that the information in SECTION A above is true and complete to the best of my knowledge and belief.

Name REB
Position Production Supt.
Company Western-Yates
Date July, 8, 1960

I hereby certify that the well location shown on the plat in SECTION B was plotted from field notes of actual surveys made by me or under my supervision, and that the same is true and correct to the best of my knowledge and belief.

Date Surveyed Aug. 22, 1960
Registered Professional Engineer and/or Land Surveyor James H. Brown
Certificate No. N.M.L.S. No. 542

0 330 660 990 1320 1650 1980 2310 2640 2000 1500 1000 500 0

INSTRUCTIONS FOR COMPLETION OF FORM C-128

1. Operator shall furnish and certify to the information called for in Section A.
2. Operator shall outline the dedicated acreage for *both* oil and gas wells on the plat in Section B.
3. A registered professional engineer or land surveyor registered in the State of New Mexico or approved by the Commission shall show on the plat the location of the well and certify this information in the space provided.
4. All distances shown on the plat must be from the outer boundaries of the Section.
5. If additional space is needed for listing owners and their respective interests as required in question 3 of Section A, please use space below.

OIL CONSERVATION COMMISSION	
ARTESIA DISTRICT OFFICE	
No. Copies Purchased	9
E. L. LLOYD, JR.	
DATE FOR	4
APPROVED BY	1
LOCATION OF WELL	
STATE INTEREST	
U. S. G. S.	
TRANSPORTER	
TIME	
BUREAU OF MINES	