

NEW MEXICO OIL CONSERVATION COMMISSION
Santa Fe, New Mexico

Form C-101
Revised (12/1/55)

RECEIVED

NOTICE OF INTENTION TO DRILL

Notice must be given to the District Office of the Oil Conservation Commission and approval obtained before drilling or recompletion begins. If changes in the proposed plan are considered advisable, a copy of this notice showing such changes will be returned to the sender. Submit this notice in QUINTUPLICATE. One copy will be returned following approval. See additional instructions in Rates and Regulations of the Commission. If State Land submit 6 Copies Attach Form C-128 in triplicate to file 2 copies of form C-101

NOV 25 1959

Artesia, New Mexico

11/25/59

(Place)

(Date)

OIL CONSERVATION COMMISSION
SANTA FE, NEW MEXICO

Gentlemen:

You are hereby notified that it is our intention to commence the Drilling of a well to be known as
Western - Yates

St. 648, Tr. 15

(Company or Operator)

158

G

The well is

(Lease)

(Unit)

located 1980 feet from the North line and 1980 feet from the East

(GIVE LOCATION FROM SECTION LINE) E. Millman Green Gey. Pool, Eddy County

If State Land the Oil and Gas Lease is No.

648

If patented land the owner is

Address

We propose to drill well with drilling equipment as follows: Cable Tools to 2500

The status of plugging bond is Blanket Bond on File

Drilling Contractor Roach Drilling Company
Artesia, New Mexico

We intend to complete this well in the San Andres
formation at an approximate depth of 2500 feet.

CASING PROGRAM

We propose to use the following strings of Casing and to cement them as indicated:

Size of Hole	Size of Casing	Weight per Foot	New or Second Hand	Depth	Sacks Cement
12	10 3/4	32.75	New	425	75
10	8 5/8	24	Used	1900	Mudded
7 3/4	4 1/2	11.6	New	2500	300

If changes in the above plans become advisable we will notify you immediately.

ADDITIONAL INFORMATION (If recompletion give full details of proposed plan of work.)

NOV 25 1959

Approved....., 19.....
Except as follows:

OIL CONSERVATION COMMISSION

By

M. L. Armstrong

ALL LAB GAS INSPECTOR

Sincerely yours,

Western - Yates

(Company or Operator)

By

Ralph Box

Position Assistant District Supt.
Send Communications regarding well to

Name Western - Yates

Address P.O. Box 427, Artesia, N.M.

RECEIVED

NEW MEXICO OIL CONSERVATION COMMISSION
WELL LOCATION AND ACREAGE DEDICATION PLAT

NOV 25 1959 C-128
 Revised 5/1/57

SEE INSTRUCTIONS FOR COMPLETING THIS FORM ON THE REVERSE SIDE

B. C. C.
 ARTESIA, OFFICE

SECTION A

Operator Western - Yates			Lease State 648, Tr. 15		Well No. 158
Unit Letter G	Section 22	Township 19S	Range 28E	County Eddy	
Actual Footage Location of Well: 1980 feet from the North line and 1980 feet from the East line					
Ground Level Elev.	Producing Formation Queen Grayburg		Pool E. Millman Queen Grayburg		Dedicated Acreage: 40 Acres

1. Is the Operator the only owner in the dedicated acreage outlined on the plat below? YES XXX NO _____. ("Owner" means the person who has the right to drill into and to produce from any pool and to appropriate the production either for himself or for himself and another. (65-3-29 (e) NMSA 1935 Comp.)
2. If the answer to question one is "no," have the interests of all the owners been consolidated by communitization agreement or otherwise? YES ____ NO _____. If answer is "yes," Type of Consolidation _____
3. If the answer to question two is "no," list all the owners and their respective interests below:

Owner	Land Description

SECTION B

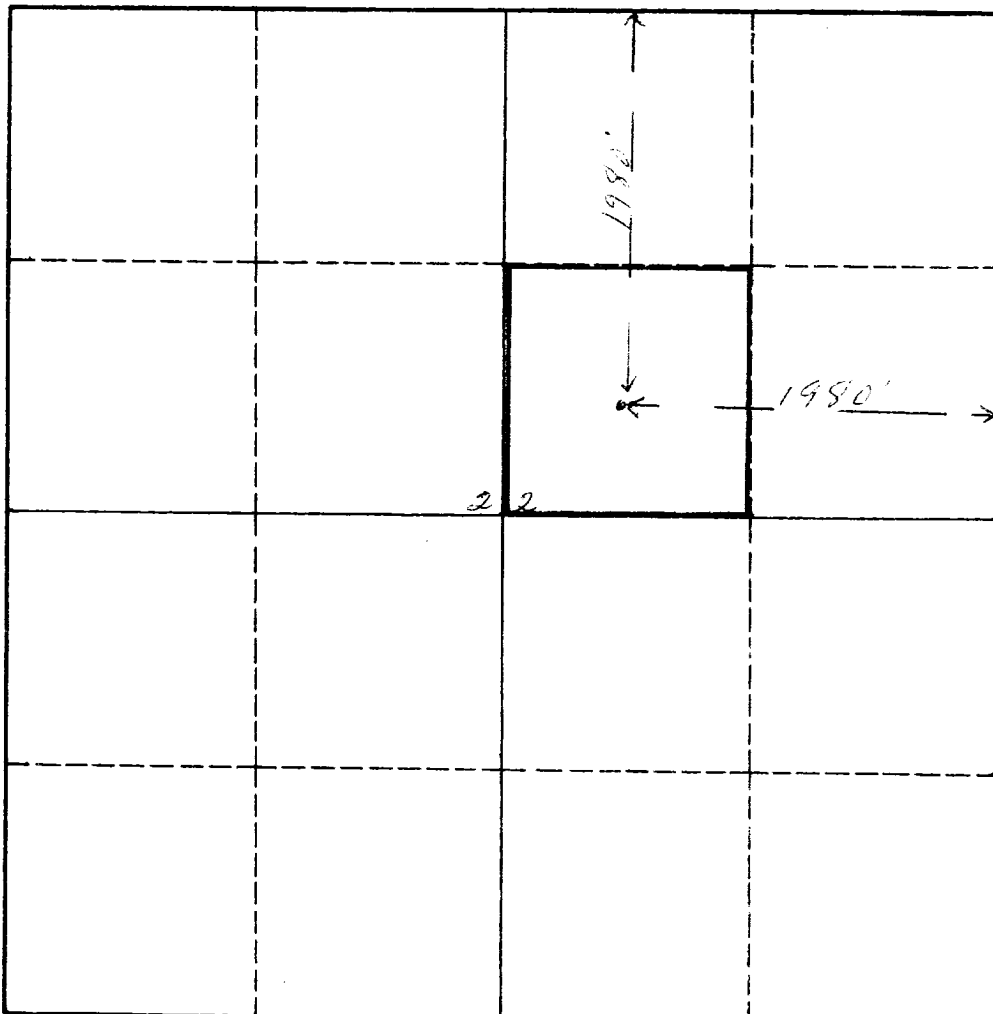

CERTIFICATION

I hereby certify that the information in SECTION A above is true and complete to the best of my knowledge and belief.

Name *Ralph J. Day*
 Position **Assistant Dist. Supt.**
 Company **Western - Yates**
 Date **11/25/59**

I hereby certify that the well location shown on the plat in SECTION B was plotted from field notes of actual surveys made by me or under my supervision, and that the same is true and correct to the best of my knowledge and belief.

Date Surveyed **11/24/59**
 Registered Professional Engineer
 and/or Land Surveyor

Certificate No. **926**

0 330 660 990 1320 1650 1980 2310 2640 2000 1500 1000 500 0

INSTRUCTIONS FOR COMPLETION OF FORM C-128

1. Operator shall furnish and certify to the information called for in Section A.
2. Operator shall outline the dedicated acreage for *both* oil and gas wells on the plat in Section B.
3. A registered professional engineer or land surveyor registered in the State of New Mexico or approved by the Commission shall show on the plat the location of the well and certify this information in the space provided.
4. All distances shown on the plat must be from the outer boundaries of the Section.
5. If additional space is needed for listing owners and their respective interests as required in question 3 of Section A, please use space below.

OIL CONSERVATION COMMISSION		
AFFIDAVIT OF COPIES		
No. Copies	6	
OPERATOR	1	
SANTA FE	1	
PRORATION OFFICE		
STATE LAND OFFICE	1	
U. S. G. S.	2	
TRANSPORTER		
FILE	1	✓
BUREAU OF MINES		