

(SUBMIT IN TRIPLICATE)

UNITED STATES
DEPARTMENT OF THE INTERIOR
GEOLOGICAL SURVEY

Land Office Santa Fe
Lease No. SM 0932
Unit _____

SUNDRY NOTICES AND REPORTS ON WELLS

NOTICE OF INTENTION TO DRILL	<input checked="" type="checkbox"/>	SUBSEQUENT REPORT OF WATER SHUT-OFF	
NOTICE OF INTENTION TO CHANGE PLANS		SUBSEQUENT REPORT OF SHOOTING OR ACIDIZING	
NOTICE OF INTENTION TO TEST WATER SHUT-OFF		SUBSEQUENT REPORT OF ALTERING CASING	
NOTICE OF INTENTION TO RE-DRILL OR REPAIR WELL		SUBSEQUENT REPORT OF RE-DRILLING OR REPAIR	
NOTICE OF INTENTION TO SHOOT OR ACIDIZE		SUBSEQUENT REPORT OF ABANDONMENT	
NOTICE OF INTENTION TO PULL OR ALTER CASING		SUPPLEMENTARY WELL HISTORY	
NOTICE OF INTENTION TO ABANDON WELL			

(INDICATE ABOVE BY CHECK MARK NATURE OF REPORT, NOTICE, OR OTHER DATA)

Well No. 2 is located 2310 ft. from N line and 1690 ft. from E line of sec. 31
SE/4 NW/4 Section 31 193 28E NM
(1/4 Sec. and Sec. No.) (Twp.) (Range) (Meridian)
Wildcat Eddy New Mexico
(Field) (County or Subdivision) (State or Territory)

The elevation of the derrick floor above sea level is _____ ft.

DETAILS OF WORK

(State names of and expected depths to objective sands; show sizes, weights, and lengths of proposed casings; indicate mudlogging jobs, cementing points, and all other important proposed work)

Plan to drill to queen or Grayburg zone around 2000'. Will also test Yates sand at 1000'. Plan to set 10" & 8 5/8" for surface casing, and will set 7" casing for water string if water is encountered in queen. Will cement 8 5/8" casing with 50 sacks, and production string of 5 1/2" with 100 sacks if production obtained.

RECEIVED

I understand that this plan of work must receive approval in writing by the Geological Survey before operations may be commenced.

Company Schuster & Schuster

Address Box 303

Artesia, New Mexico

By Harold Kessy
Title Agent

('copy to Santa Fe

NEW MEXICO OIL CONSERVATION COMMISSION

Well Location and Acreage Dedication Plat

Section A.

Date October 13, 1959

Operator Schuster & Schuster Lease Federal Anderson
Well No. 2 Unit Letter 7 Section 21 Township 19 Range 28 NMPM
Located 2310 Feet From North Line, 1650 Feet From West Line
County Levy G. L. Elevation _____ Dedicated Acreage _____ Acres
Name of Producing Formation Water, Green Grayburg Pool Wildcat

1. Is the Operator the only owner* in the dedicated acreage outlined on the plat below?
Yes 1 No _____.
2. If the answer to question one is "no," have the interests of all the owners been consolidated by communitization agreement or otherwise? Yes _____ No _____. If answer is "yes," Type of Consolidation _____
3. If the answer to question two is "no," list all the owners and their respective interests below:

Owner

Land Description

_____	_____
_____	_____
_____	_____

Section B

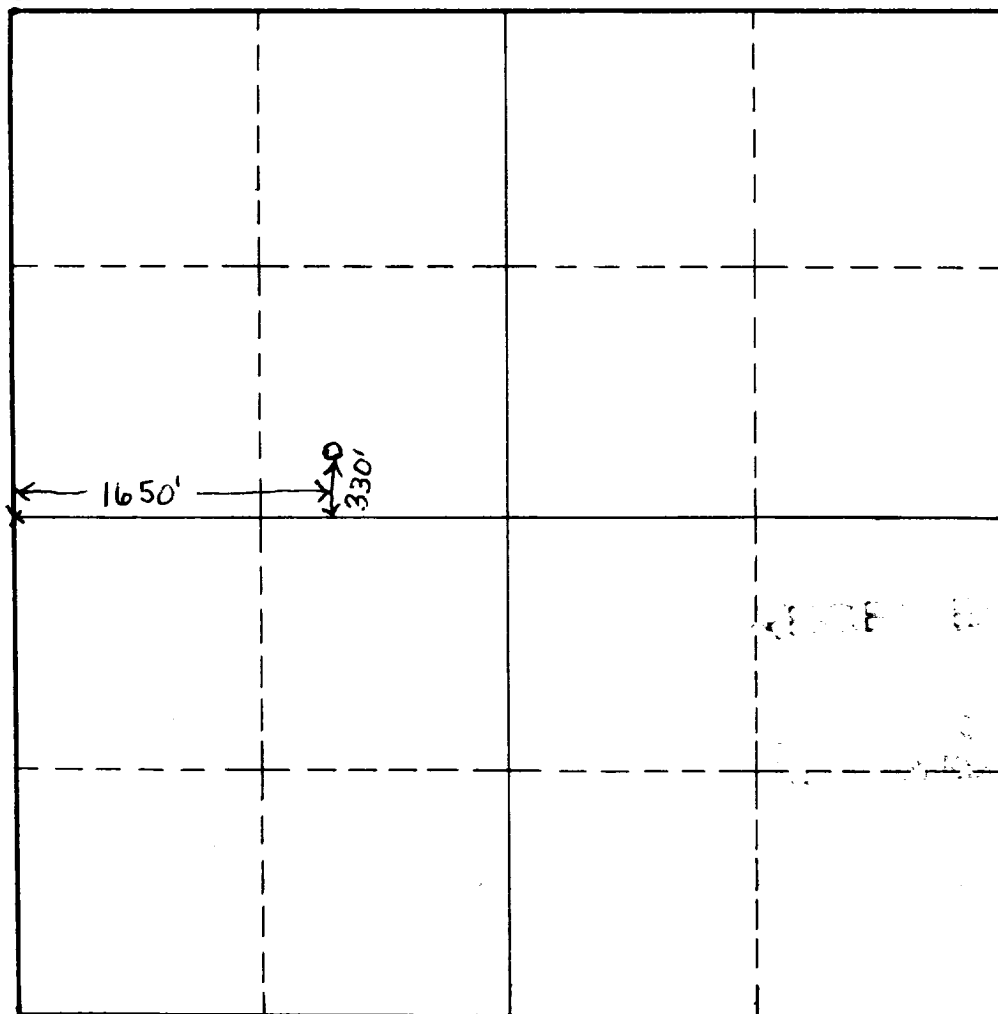

This is to certify that the information in Section A above is true and complete to the best of my knowledge and belief.

Schuster & Schuster
(Operator)

Harold Kelsey
(Representative)

Box 305, Artesia, New Mexico
Address

This is to certify that the well location shown on the plat in Section B was plotted from field notes of actual surveys made by me or under my supervision and that the same is true and correct to the best of my knowledge and belief.

Date Surveyed October 2, 1959

Harold Kelsey
Registered Professional
Engineer and/or Land Surveyor.

Certificate No. 802

INSTRUCTIONS FOR COMPLETION

1. Operator shall furnish and certify to the information called for in Section A.
2. Operator shall outline the dedicated acreage for both oil and gas wells on the plat in Section B.
3. A registered professional engineer or land surveyor registered in the State of New Mexico or approved by the Commission shall show on the plat the location of the well and certify this information in the space provided.
4. All distances shown on the plat must be from the outer boundaries of Section.
5. If additional space is needed for listing owners and their respective interests as required in question 3, Section A, please use space below

* "Owner" means the person who has the right to drill into and to produce from any pool and to appropriate the production either for himself or for himself and another. (65-3-29 (e) NMSA 1953 Comp.)