

Company JONES & WATKINS

Lease CONTINENTAL- STATE Well No. 3

Sec. 10 T. 10 S., R. 29 E., N.M.P.M.

Location C. EL NW $\frac{1}{4}$ NE $\frac{1}{4}$
1650' fr. EL & 660' fr. NL

County Ed dy

New Mexico

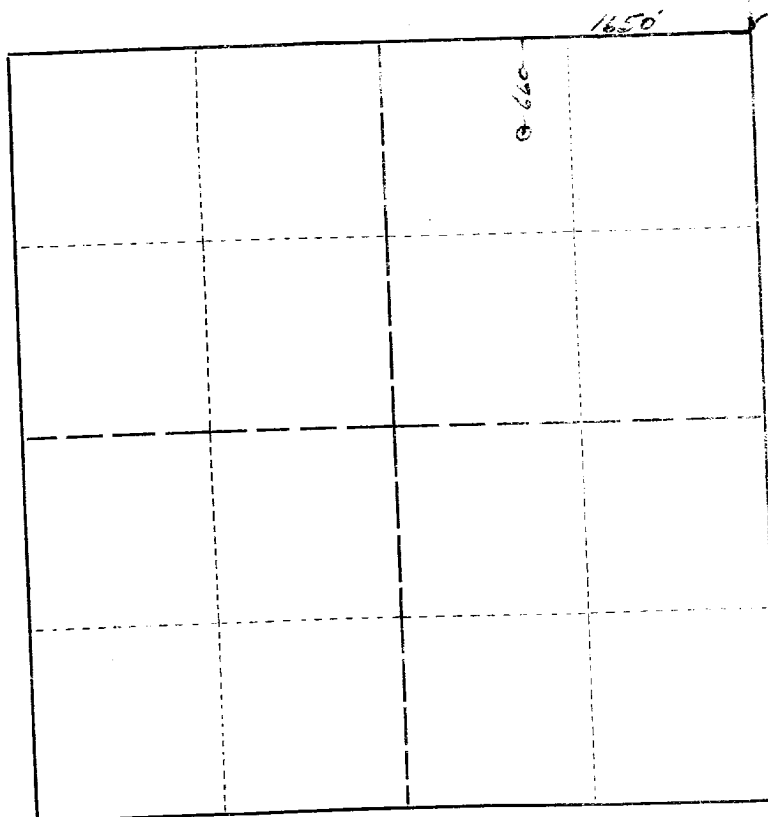

Scale 4" = 1 mile.

Chained distances.

This is to certify that the above plat was prepared from field notes of actual surveys made by me or under my supervision and that the same are true and correct to the best of my knowledge and belief.

Seal:

Artesia, New Mexico

[Signature]
Registered Professional
Engineer and Land Surveyor.

Surveyed January 14, 1950

17532 Advocate Print

Company UNITED STATES
 Lease CONTINENTAL - ST. 112
 Sec. 10 T. 13 S. R. 2
O. M. 444
 Location 11200' N. 100' E. 4 550' W.
 County Clark

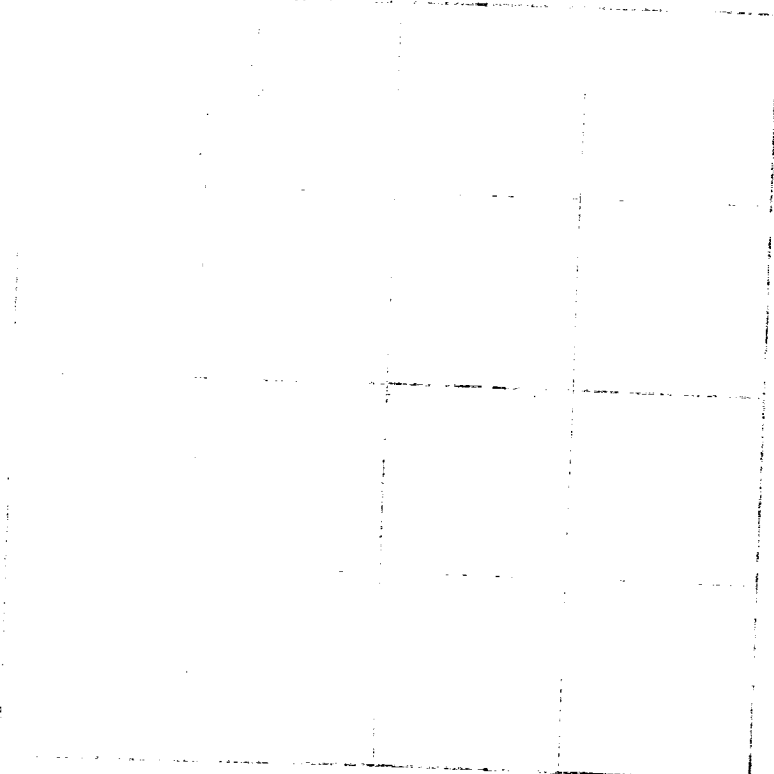

Scale 4" = 1 mile.
Chain of distances.
 This is to certify that the above plan was prepared from notes of actual surveys made by me or under my supervision, and that the same are true and correct to the best of my knowledge and belief.

[Signature]
 Registered Professional
 Surveyor and Land Engineer

Clark
 Athens, New Mexico

Surveyed January 14, 1900
 11222 Advocate Print