

NOTICE OF INTENTION TO DRILL

Notice must be given to the District Office of the Oil Conservation Commission and approval obtained before drilling or recompletion begins. If changes in the proposed plan are considered advisable, a copy of this notice showing such changes will be returned to the sender. Submit this notice in QUINTUPLICATE. One copy will be returned following approval. See additional instructions in Rules and Regulations of the Commission. If State Land submit 6 Copies Attach Form C- 128 in triplicate to first 3 copies of form C-101 on all wells

Hobbs, New Mexico
(Place)

August 27, 1959
(Date)

OIL CONSERVATION COMMISSION
SANTA FE, NEW MEXICO

Gentlemen:

You are hereby notified that it is our intention to commence the Drilling of a well to be known as

Western Oil Fields, Inc.

(Company or Operator)

State "A"
(Lease)

Well No. 1

I
(Unit)

The well is

located 990 feet from the East line and 2310 feet from the

South line of Section 15 T. 19 S. R. 29 E. NMPM

(GIVE LOCATION FROM SECTION LINE) (Turkey Track (Queens)) Pool, Eddy County

If State Land the Oil and Gas Lease is No. E2944

If patented land the owner is

Address

We propose to drill well with drilling equipment as follows: Cable tool from surface to T. D.

The status of plugging bond is Approved

Drilling Contractor Donnell Drilling Co.
Denver, Colorado

We intend to complete this well in the Queens formation at an approximate depth of 2200 feet.

CASING PROGRAM

We propose to use the following strings of Casing and to cement them as indicated:

| Size of Hole | Size of Casing | Weight per Foot | New or Second Hand | Depth | Sacks Cement |
|--------------|----------------|-----------------|--------------------|-----------|--------------|
| 15 1/2 | 13 3/8 | 48 | Used | 300 | 50 |
| 10 | 8 5/8 | 24 | Used | As Needed | * None |
| 8 | 5 1/2 | 15 1/2 | Used | 2200 | 100 |

If changes in the above plans become advisable we will notify you immediately.

ADDITIONAL INFORMATION

- * The 8 5/8 " casing will be run as needed to drill well and will be pulled after 5 1/2 " casing is run.

Approved AUG 27 1959, 19

Except as follows:

Sincerely yours,

Western Oil Fields, Inc.

(Company or Operator)

By

Position Petroleum Engineer

Send Communications regarding well to

Name Western Oil Fields, Inc.

Address P. O. Box 1147, Hobbs, New Mexico

OIL CONSERVATION COMMISSION

By

W. A. Gressett

NEW MEXICO OIL CONSERVATION COMMISSION
WELL LOCATION AND ACREAGE DEDICATION PLAT

FORM C-128
 Revised 5/1/57.

SEE INSTRUCTIONS FOR COMPLETING THIS FORM ON THE REVERSE SIDE

SECTION A

| | | | | |
|---|--------------------------------------|-----------------------------------|---------------------------------------|------------------------|
| Operator Western Oil Fields, Inc. | | Lease State "N" | | Well No. 1 |
| Unit Letter I | Section 15 | Township 19 S | Range 29 E | County Elddy |
| Actual Footage Location of Well: 2310 feet from the South line and 990 feet from the East line | | | | |
| Ground Level Elev. | Producing Formation Queens | Pool <i>Sub. sand in place</i> | Dedicated Acreage: 40 Acres | |

1. Is the Operator the only owner in the dedicated acreage outlined on the plat below? YES ☒ NO ____ . ("Owner" means the person who has the right to drill into and to produce from any pool and to appropriate the production either for himself or for himself and another. (65-3-29 (e) NMSA 1935 Comp.)
2. If the answer to question one is "no," have the interests of all the owners been consolidated by communitization agreement or otherwise? YES ____ NO ____ . If answer is "yes," Type of Consolidation _____
3. If the answer to question two is "no," list all the owners and their respective interests below:

| Owner | Land Description |
|-------|------------------|
| | |
| | |

SECTION B

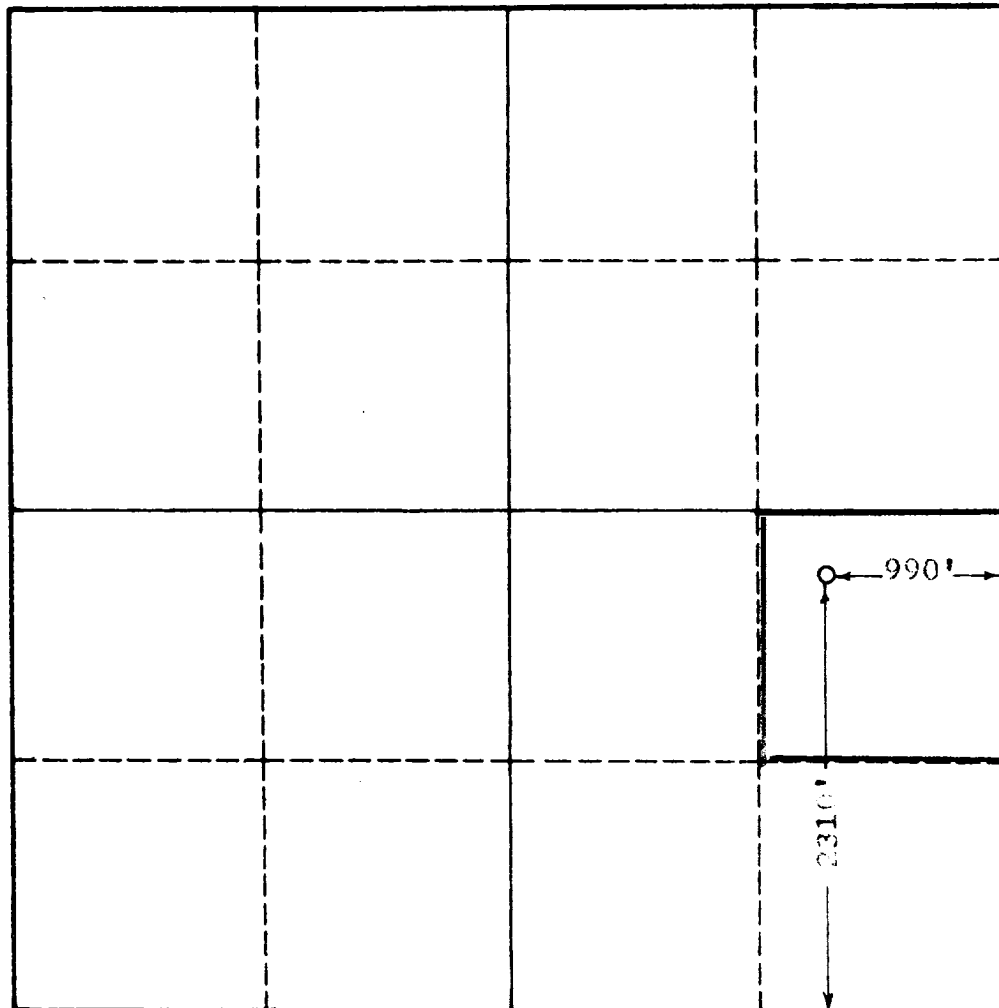

CERTIFICATION

I hereby certify that the information in SECTION A above is true and complete to the best of my knowledge and belief.

R. H. Smith
 Name

Position

Petroleum Engineer
 Company

Western Oil Fields, Inc.
 Date

August 27, 1959

I hereby certify that the well location shown on the plat in SECTION B was plotted from field notes of actual surveys made by me or under my supervision, and that the same is true and correct to the best of my knowledge and belief.

Date Surveyed

8-27-59

Registered Professional Engineer and/or Land Surveyor, **JOHN W. WEST**

John W. West

Certificate No.

(N.M. - P.E. & L.S. NO. 676)

0 330 660 990 1320 1650 1980 2310 2640 2000 1500 1000 500 0

| OIL CONSERVATION COMMISSION | |
|-----------------------------|----|
| APPROPRIATE AGENCY | |
| No. Copies | 7 |
| GRANT | 2 |
| SALES | 1 |
| OTHER | 2 |
| TOTAL | 12 |
| DATE | ✓ |