

NUMBER OF COPIES RECEIVED		7
DISTRIBUTION		
SANTA FE		
FILE		
U.S.G.S.		
LAND OFFICE		
TRANSPORTER	OIL	
	GAS	
PRODUCTION OFFICE		
OPERATOR		7

NEW MEXICO OIL CONSERVATION COMMISSION
Santa Fe, New Mexico

Form C-101
Revised (12/1/55)

RECEIVED

NOTICE OF INTENTION TO DRILL

Notice must be given to the District Office of the Oil Conservation Commission and approval obtained before drilling completion begins. If changes in the proposed plan are considered advisable, a copy of this notice showing such changes will be returned to the sender. Submit this notice in **QUINTUPLICATE**. One copy will be returned following approval. See additional instructions in Rules and Regulations of the Commission. If State Land submit 6 Copies Attach Form C- 128 in triplicate to first 3 copies of form C-101

SEP 5 1961
ARTESIA, OFFICE

HOBBS, NEW MEXICO
(Place)

9-1-61
(Date)

OIL CONSERVATION COMMISSION
SANTA FE, NEW MEXICO

Gentlemen:

You are hereby notified that it is our intention to commence the Drilling of a well to be known as

Sunray Mid-Continent Oil Company

(Company or Operator)

N.M. State "AD"

(Lease)

, Well No. **1**, in **M** (Unit) The well is

located **660** feet from the **South** line and **660** feet from the

West line of Section **29**, T **19S**, R **29E**, NMPM.

(GIVE LOCATION FROM SECTION LINE) **Wildcat** Pool, **Eddy** County

If State Land the Oil and Gas Lease is No. **8-7750**

If patented land the owner is.....

Address.....

We propose to drill well with drilling equipment as follows: **Rotary to TD**

The status of plugging bond is **Approved**

Drilling Contractor **Not selected yet.**

We intend to complete this well in the **Bone Springs** formation at an approximate depth of **7600** feet.

CASING PROGRAM

We propose to use the following strings of Casing and to cement them as indicated:

Size of Hole	Size of Casing	Weight per Foot	New or Second Hand	Depth	Sacks Cement
12 1/4	9 5/8	32.3	New	2100	To Circ.
7 7/8	4 1/2	9.5 & 11.6	New	7700	150

If changes in the above plans become advisable we will notify you immediately.

ADDITIONAL INFORMATION (If recompletion give full details of proposed plan of work.)

Approved.....**SEP 5 1961**....., 19.....
Except as follows:

OIL CONSERVATION COMMISSION
By **M L Armstrong**

Sincerely yours,

SUNRAY MID-CONTINENT OIL COMPANY

(Company or Operator)

By **R. E. Station**

Position **District Engineer**

Send Communications regarding well to

Name **C. J. McGlathahan**

Address **P. O. Box 128, Hobbs, New Mexico**

RECEIVED

NEW MEXICO OIL CONSERVATION COMMISSION
WELL LOCATION AND ACREAGE DEDICATION PLAT

FORM C-128
 Revised 5/1/57

SEE INSTRUCTIONS FOR COMPLETING THIS FORM ON THE REVERSE SIDE

D. C. B.
ARTESIA, OFFICE

SECTION A

Operator Sunray Mid-Continent Oil Co.			Lease New Mexico State "AD"		Well No. 1
Unit Letter M	Section 29	Township 19 South	Range 29 East	County Eddy	
Actual Footage Location of Well: 660 feet from the South line and 660 feet from the West line					
Ground Level Elev. 3325 Est.	Producing Formation Bone Springs		Pool Wildcat	Dedicated Acreage: 40 Acres	

1. Is the Operator the only owner in the dedicated acreage outlined on the plat below? YES ☒ NO ____ ("Owner" means the person who has the right to drill into and to produce from any pool and to appropriate the production either for himself or for himself and another. 165-3-29 (e) NMSA 1935 Comp.)
2. If the answer to question one is "no," have the interests of all the owners been consolidated by communitization agreement or otherwise? YES ____ NO ____ If answer is "yes," Type of Consolidation ____
3. If the answer to question two is "no," list all the owners and their respective interests below:

Owner	Land Description

SECTION B

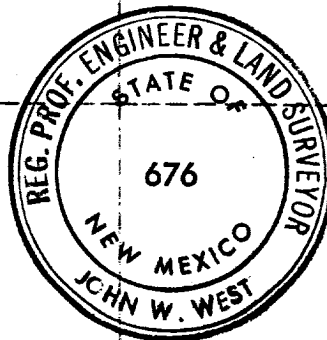
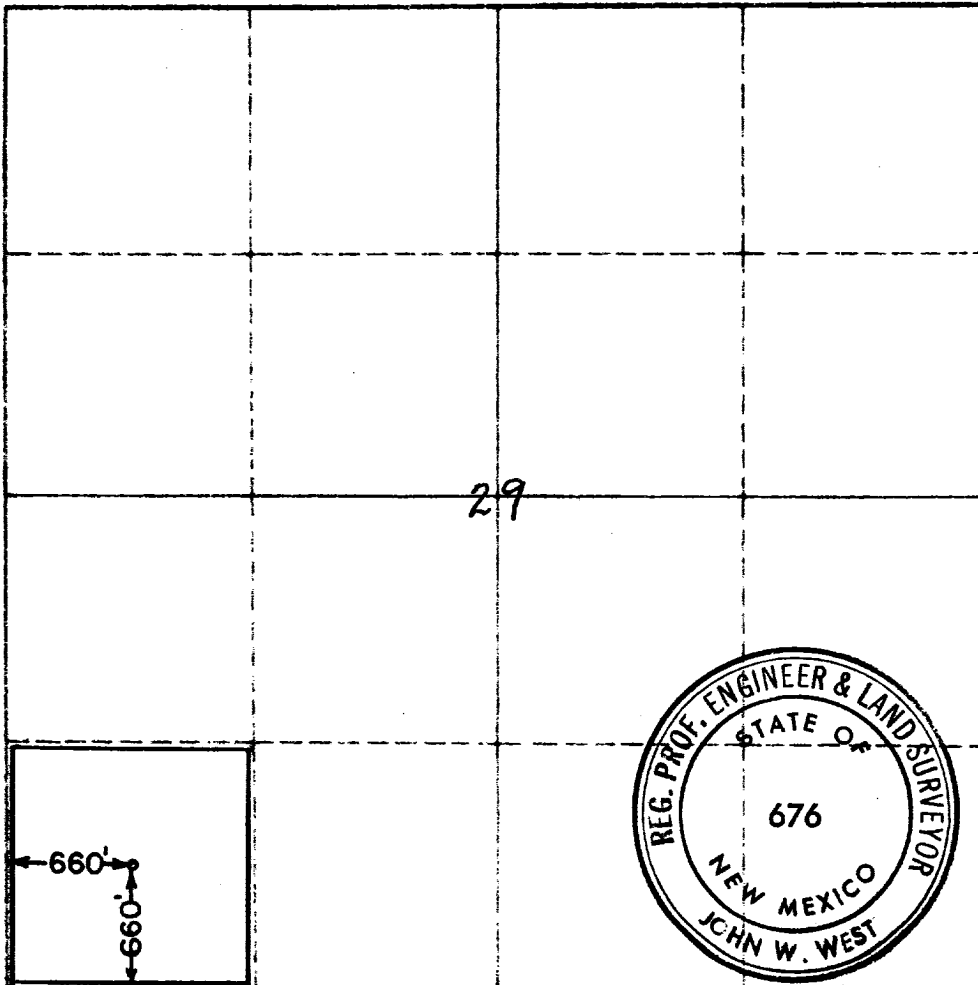

CERTIFICATION

I hereby certify that the information in SECTION A above is true and complete to the best of my knowledge and belief.

Name **R.E. Statton**
 Position **District Engineer**
 Company **Sunray Mid-Continent Oil Co.**
 Date **9-1-61**

I hereby certify that the well location shown on the plat in SECTION B was plotted from field notes of actual surveys made by me or under my supervision, and that the same is true and correct to the best of my knowledge and belief.

Date Surveyed **9-1-61**
 Registered Professional Engineer and/or Land Surveyor, **JOHN W. WEST**
 Certificate No. **John W. West**
 N.M. - P.E. & L.S. NO. **676**

- (1) Melaf - Acoustic Velocity Log
- (1) Melaf - Gamma Log
- (1) Melaf - Induction Log