

(SUBMIT IN ~~DUPLICATE~~ <sup>QUINTuplicate</sup>)  
UNITED STATES  
DEPARTMENT OF THE INTERIOR  
GEOLOGICAL SURVEY

Land Office New Mexico  
Lease No. NM-01523  
Unit A

RECEIVED

## SUNDRY NOTICES AND REPORTS ON WELLS

NOTICE OF INTENTION TO DRILL.....	<input checked="" type="checkbox"/>	SUBSEQUENT REPORT OF WATER SHUT-OFF.....	
NOTICE OF INTENTION TO CHANGE PLANS.....		SUBSEQUENT REPORT OF SHOOTING OR ACIDIZING.....	
NOTICE OF INTENTION TO TEST WATER SHUT-OFF.....		SUBSEQUENT REPORT OF ALTERING CASING.....	
NOTICE OF INTENTION TO RE-DRILL OR REPAIR WELL.....		SUBSEQUENT REPORT OF RE-DRILLING OR REPAIR.....	
NOTICE OF INTENTION TO SHOOT OR ACIDIZE.....		SUBSEQUENT REPORT OF ABANDONMENT.....	
NOTICE OF INTENTION TO PULL OR ALTER CASING.....		SUPPLEMENTARY WELL HISTORY.....	
NOTICE OF INTENTION TO ABANDON WELL.....			

(INDICATE ABOVE BY CHECK MARK NATURE OF REPORT, NOTICE, OR OTHER DATA)

November 19, 1959

*Langrange*  
Well No. 1 is located 660 ft. from [N] line and 660 ft. from [E] line of sec. 35

C-NE 1/4 Sec. 35; 19 Sec. 29 East N.M.P.M.  
(1/4 Sec. and Sec. No.) (Twp.) (Range) (Meridian)  
(Undesignated Survey) Sandoz New Mexico  
(Field) (County or Subdivision) (State or Territory)

The elevation of the ~~bottom floor~~ <sup>ground</sup> above sea level is 3325 ft.

### DETAILS OF WORK

(State names of and expected depths to objective sands; show sizes, weights, and lengths of proposed casings; indicate mudding jobs, cementing points, and all other important proposed work)

Seven Rivers test - Proposed depth 1800' more or less. Contractor is Roach Drilling Company, 102 South Second St., Artesia, New Mexico. Cable Tools will be used. Top of Seven Rivers is estimated at 1750'

8-5/8" casg., 28# or better at 250' to be mudded. If a dry hole, this string will be pulled. If a producer, it will be cemented w/50 sax.

5-1/2" casg., 14#, now at 1740' more or less to be cemented w/50 sax if well is completed as a producer.

Bond of Oil & Gas Lease Operator in amount of \$5000 tendered to Bureau of Land Management at Santa Fe, New Mexico November 19, 1959.

I understand that this plan of work must receive approval in writing by the Geological Survey before operations may be commenced.

Company .....

Address Emmett D. White  
P. O. Box 146  
Roswell, New Mexico.

RECEIVED

NOV 23 1959

GEOLOGICAL SURVEY  
NEW MEXICO

**NEW MEXICO OIL CONSERVATION COMMISSION**  
**WELL LOCATION AND ACREAGE DEDICATION PLAT**

**RECEIVED**

FORM C-128  
Revised 5/1/57  
**DEC 3 1959**

SEE INSTRUCTIONS FOR COMPLETING THIS FORM ON THE REVERSE SIDE

**SECTION A**

**B. C. C.**  
**ARTESIA, OFFICE**

Operator <i>Emmett D. White</i>		Lease <i>Federal (Hogrove)</i>		Well No. <i>1</i>	
Unit Letter <i>A</i>	Section <i>35</i>	Township <i>19S</i>	Range <i>29S</i>	County <i>Eddy</i>	
Actual Footage Location of Well: <i>660</i> feet from the <i>North</i> line and <i>660</i> feet from the <i>East</i> line					
Ground Level Elev. <i>3325</i>	Producing Formation		Pool <i>Dunkley Jack Lindsey</i>	Dedicated Acreage: <i>40</i> Acres	

1. Is the Operator the only owner in the dedicated acreage outlined on the plat below? YES \_\_\_\_\_ NO ✓. ("Owner" means the person who has the right to drill into and to produce from any pool and to appropriate the production either for himself or for himself and another. (65-3-29 (e) NMSA 1935 Comp.)
2. If the answer to question one is "no," have the interests of all the owners been consolidated by communitization agreement or otherwise? YES \_\_\_\_\_ NO \_\_\_\_\_. If answer is "yes," Type of Consolidation \_\_\_\_\_
3. If the answer to question two is "no," list all the owners and their respective interests below:

Owner	Land Description

**SECTION B**

**CERTIFICATION**

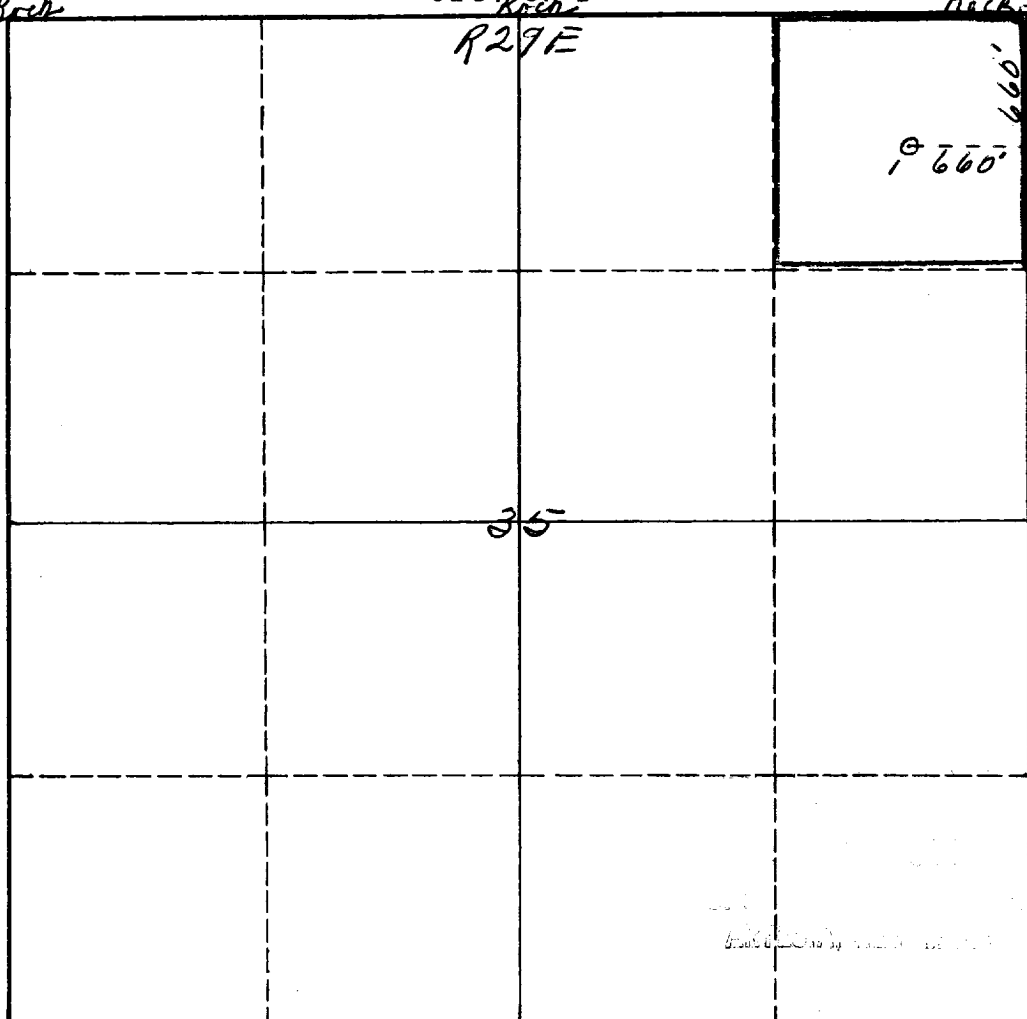

I hereby certify that the information in SECTION A above is true and complete to the best of my knowledge and belief.

Name

Position

Company

Date

I hereby certify that the well location shown on the plat in SECTION B was plotted from field notes of actual surveys made by me or under my supervision, and that the same is true and correct to the best of my knowledge and belief.

Date Surveyed

*November 18th, 1959*

Registered Professional Engineer

and/or Land Surveyor

*James H. Brown*  
Certificate No. *542*

0 330 660 990 1320 1650 1980 2310 2640 2000 1500 1000 500

## INSTRUCTIONS FOR COMPLETION OF FORM C-128

1. Operator shall furnish and certify to the information called for in Section A.
2. Operator shall outline the dedicated acreage for *both* oil and gas wells on the plat in Section B.
3. A registered professional engineer or land surveyor registered in the State of New Mexico or approved by the Commission shall show on the plat the location of the well and certify this information in the space provided.
4. All distances shown on the plat must be from the outer boundaries of the Section.
5. If additional space is needed for listing owners and their respective interests as required in question 3 of Section A, please use space below.