

## TOPS

Salado	605'
B. Salt	1985'
Yemas	2195'
Wasson	3074'

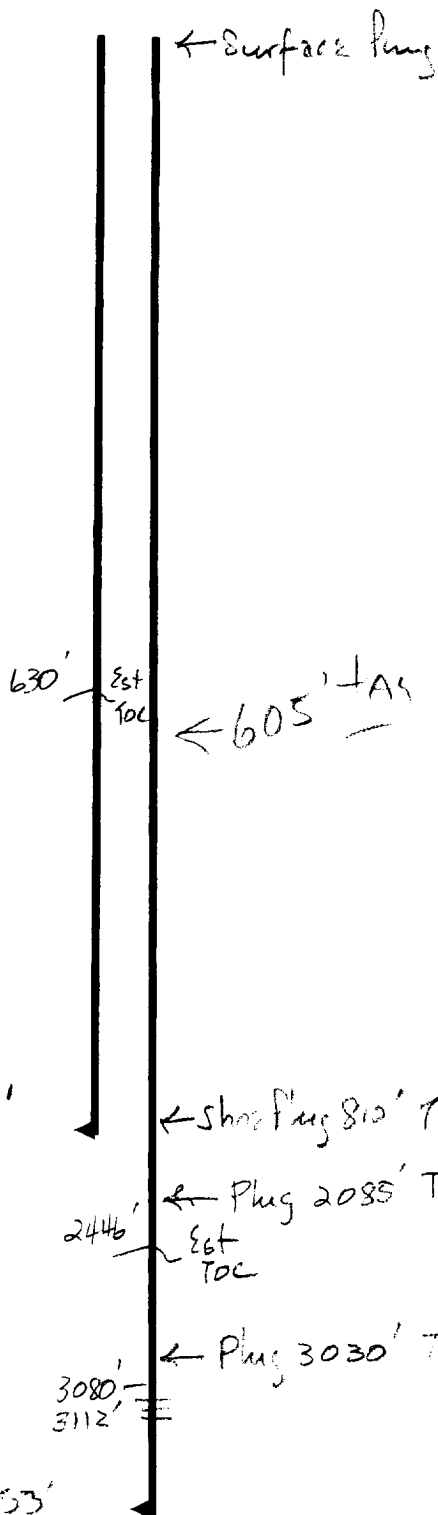

- \* Contact OCD 24 hrs. prior to any work done.
- \* Salt gel mud consisting of 10# brine with 25# of gel per barrel must be placed between each plug.
- \* Install dry hole marker as per Rule 202.B.2
- \* Plugs are to be set from point indicated up.
- \* Plugs must not be less than 100' or 25 Sacks of cement, whichever is greater, unless specifically indicated.
- \* Shoe and stub plugs will be 50' above and below shoe or stub and tagged.
- \* Surface plug will be from 0' - 60'
- \* Where plugs are required, cement must be placed inside and outside of all casing string(s) in the correct footage or sacks required, **if no cement exists.**
- \* Plugs to be tagged will be indicated.

8 5/8" x 7 1/2"  
SC x S

5 1/2" @ 3253'  
125' max.

2