

(SUBMIT IN TRIPLICATE)

UNITED STATES
DEPARTMENT OF THE INTERIOR
GEOLOGICAL SURVEY

Land Office

RECEIVED
OCT 5 1960
D. C. F. F.
ARTESIA OFFICE

SUNDRY NOTICES AND REPORTS ON WELLS

NOTICE OF INTENTION TO DRILL.....	<input checked="" type="checkbox"/>	SUBSEQUENT REPORT OF WATER SHUT-OFF.....	
NOTICE OF INTENTION TO CHANGE PLANS.....		SUBSEQUENT REPORT OF SHOOTING OR ACIDIZING.....	
NOTICE OF INTENTION TO TEST WATER SHUT-OFF.....		SUBSEQUENT REPORT OF ALTERING CASING.....	
NOTICE OF INTENTION TO RE-DRILL OR REPAIR WELL.....		SUBSEQUENT REPORT OF RE-DRILLING OR REPAIR.....	
NOTICE OF INTENTION TO SHOOT OR ACIDIZE.....		SUBSEQUENT REPORT OF ABANDONMENT.....	
NOTICE OF INTENTION TO PULL OR ALTER CASING.....		SUPPLEMENTARY WELL HISTORY.....	
NOTICE OF INTENTION TO ABANDON WELL.....			

(INDICATE ABOVE BY CHECK MARK NATURE OF REPORT, NOTICE, OR OTHER DATA)

Well No. 1 is located 660 ft. from S line and 1980 ft. from W line of sec. 20
SE/4 SW/4 SEC. 20 19-S 30-E NMPM
(1/4 Sec. and Sec. No.) (Twp.) (Range) (Meridian)
Wagon Mound Eddy N. M.
(Field) (County or Subdivision) (State or Territory)

The elevation of the derrick floor above sea level is _____ ft.

DETAILS OF WORK

(State names of and expected depths to objective sands; show sizes, weights, and lengths of proposed casings; indicate mudding jobs, cementing points, and all other important proposed work)

RUN USED 8-5/8" CSG. TO TOP OF SALT & CIRCULATE CEMENT TO SURFACE.
 RUN USED 7" TO TOP OF YATES & MUD IN - DRILL YATES PAY ZONES & IF
 PRODUCER RUN 4-1/2" CSG. TO T. D. & PULL 7", CIRCUMFANG PROD. STRING
 TO SURFACE.

RECEIVED

AUG 16 1960

U. S. GEOLOGICAL SURVEY
ARTESIA, NEW MEXICO

I understand that this plan of work must receive approval in writing by the Geological Survey before operations may be commenced.

Company WAYNE J. SPEARSAddress 201 THREE CROSS DRIVEROSWELL, NEW MEXICO

By Samuel B. Spear
 Title AGENT

NEW MEXICO OIL CONSERVATION COMMISSION
Well Location and Acreage Dedication Plat

RECEIVED

OCT 5 1960

Section A.

Date September 23, 1960

Operator Wayne J. Spears Lease Nelly-Federal
Well No. 1 Unit Letter " Section 30 Township 19 South Range 30 East NMPM
Located 600 Feet From South Line, 1900 Feet From West Line
County San Juan G. L. Elevation 3335 Dedicated Acreage 40 Acres
Name of Producing Formation San Juan River Pool San Juan River

1. Is the Operator the only owner* in the dedicated acreage outlined on the plat below?
Yes ☒ No ☐.
2. If the answer to question one is "no," have the interests of all the owners been consolidated by communitization agreement or otherwise? Yes ☐ No ☐. If answer is "yes," Type of Consolidation _____
3. If the answer to question two is "no," list all the owners and their respective interests below:

Owner

Land Description

Section B

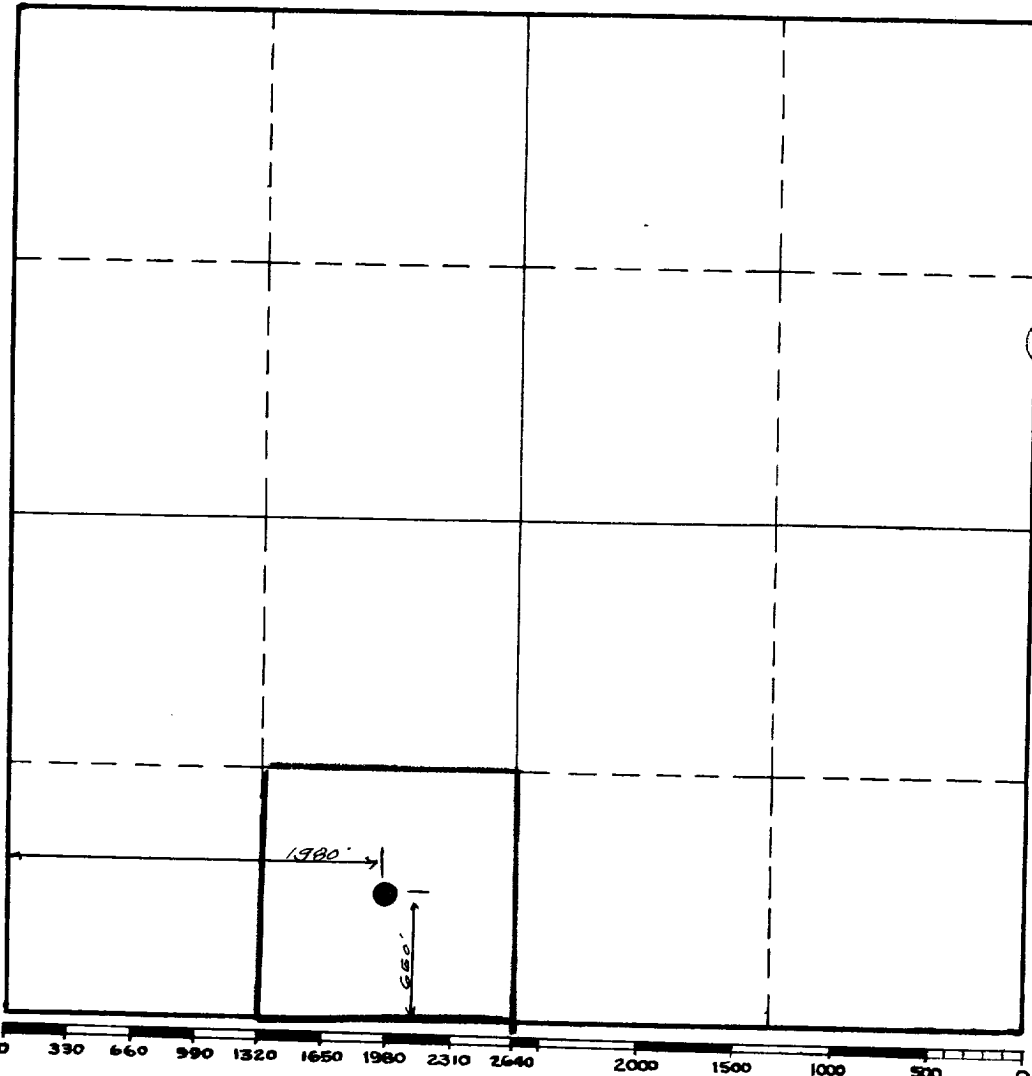

This is to certify that the information in Section A above is true and complete to the best of my knowledge and belief.

Wayne J. Spears

(Operator)

John L. McChalla
(Representative)
201 Third Street
Alamogordo, New Mexico

Address

This is to certify that the well location shown on the plat in Section B was plotted from field notes of actual surveys made by me or under my supervision and that the same is true and correct to the best of my knowledge and belief.

Date Surveyed 9-27-60

Ray A. Swartz
Registered Professional
Engineer and/or Land Surveyor.

Certificate No. 278

(See instructions for completing this form on the reverse side)

INSTRUCTIONS FOR COMPLETION:

1. Operator shall furnish and certify to the information called for in Section A.
2. Operator shall outline the dedicated acreage for both oil and gas wells on the plat in Section B.
3. A registered professional engineer or land surveyor registered in the State of New Mexico or approved by the Commission shall show on the plat the location of the well and certify this information in the space provided.
4. All distances shown on the plat must be from the outer boundaries of Section.
5. If additional space is needed for listing owners and their respective interests as required in question 3, Section A, please use space below

* "Owner" means the person who has the right to drill into and to produce from any pool and to appropriate the production either for himself or for himself and another. (65-3-29 (e) NMSA 1953 Comp.)

OCT 3 1960

Well Location and Acreage Dedication Plat

Section A.

ARTESIA, OFFICE

Date September 28, 1960

Operator Wynne J. Spence Lease Not by Federal
 Well No. 1 Unit Letter A Section 20 Township 15 North Range 30 East NMPM
 Located 200 Feet From South Line, 1000 Feet From West Line
 County San Juan G. L. Elevation 1000 Dedicated Acreage 40 Acres
 Name of Producing Formation Santon Shale Pool Not Known

1. Is the Operator the only owner* in the dedicated acreage outlined on the plat below?
 Yes No .
2. If the answer to question one is "no," have the interests of all the owners been consolidated by communitization agreement or otherwise? Yes No . If answer is "yes," Type of Consolidation
3. If the answer to question two is "no," list all the owners and their respective interests below:

OwnerLand Description

RECEIVED

OCT 3 1960

U. S. GEOLOGICAL SURVEY
ARTESIA, NEW MEXICO

Section B

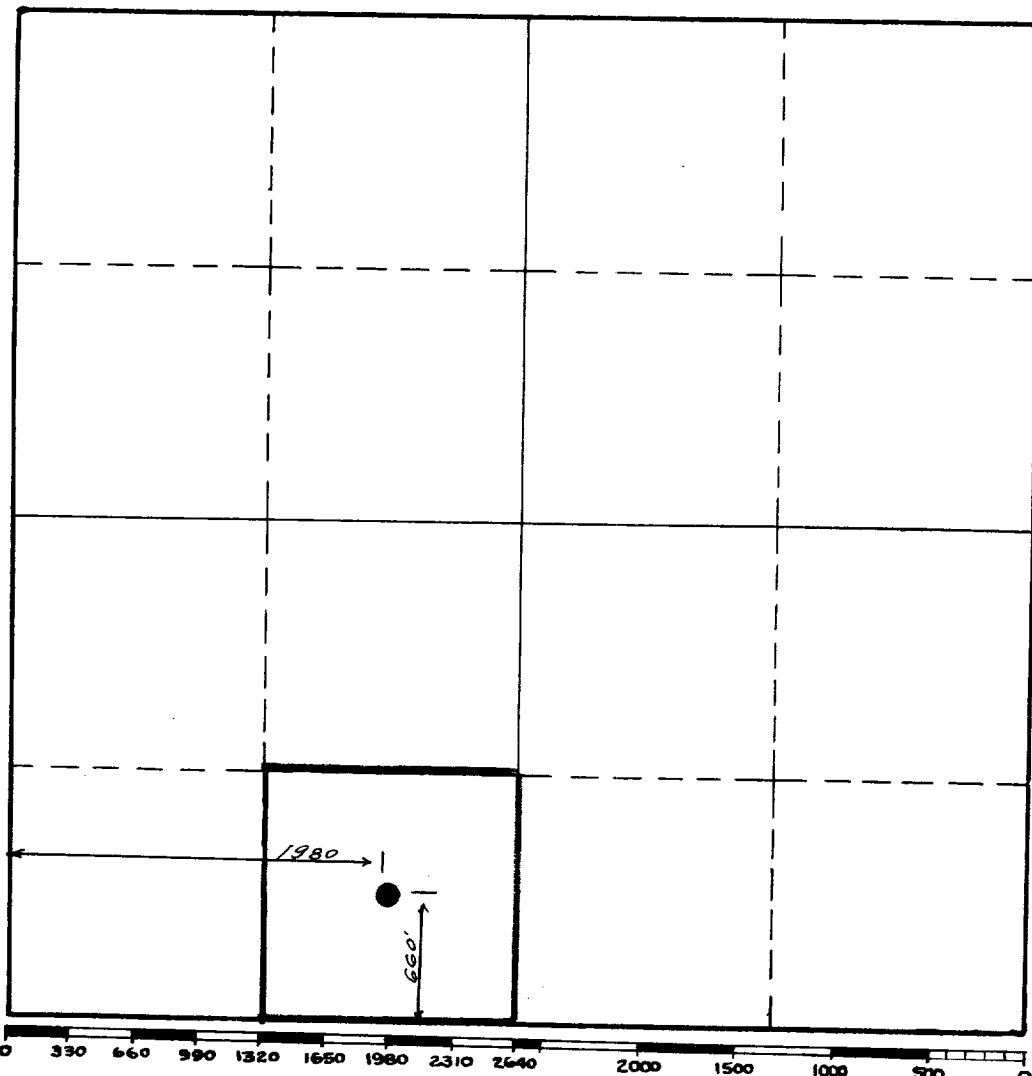

This is to certify that the information in Section A above is true and complete to the best of my knowledge and belief.

Wynne J. Spence

(Operator)

John J. McCalla

(Representative)

San Juan County
Artesia, New Mexico

Address

This is to certify that the well location shown on the plat in Section B was plotted from field notes of actual surveys made by me or under my supervision and that the same is true and correct to the best of my knowledge and belief.

Date Surveyed 9-28-60

Wynne J. Spence
 Registered Professional
 Engineer and/or Land Surveyor.

Certificate No. 378

(See instructions for completing this form on the reverse side)

INSTRUCTIONS FOR COMPLETION:

1. Operator shall furnish and certify to the information called for in Section A.
2. Operator shall outline the dedicated acreage for both oil and gas wells on the plat in Section B.
3. A registered professional engineer or land surveyor registered in the State of New Mexico or approved by the Commission shall show on the plat the location of the well and certify this information in the space provided.
4. All distances shown on the plat must be from the outer boundaries of Section.
5. If additional space is needed for listing owners and their respective interests as required in question 3, Section A, please use space below

* "Owner" means the person who has the right to drill into and to produce from any pool and to appropriate the production either for himself or for himself and another. (65-3-29 (e) NMSA 1953 Comp.)