



104-518
UNITED STATES
DEPARTMENT OF THE INTERIOR
GEOLOGICAL SURVEY
P. O. Box 6721
Roswell, New Mexico

IN REPLY REFER TO:

RECEIVED
FEB 1 1961
D.C.C.
ARTESIA, OFFICE

January 31, 1961

Mr. G. W. Strake
3300 Gulf Building
Houston 2, Texas

Dear Mr. Strake:

Reference is made to your Notice of Intention to Drill well No. 3 Union-Federal (copy attached) in the SE $\frac{1}{4}$ NE $\frac{1}{4}$ sec. 23, T. 19 S., R. 30 E., N.M.P.M., Eddy County, New Mexico, on lease New Mexico 06765. Inasmuch as said lease lies within the "Potash Area" designated by the Secretary of the Interior on October 16, 1951, it is subject to the "Potash Stipulation."

Pursuant to the authority delegated by the Director, U. S. Geological Survey on January 25, 1961, I hereby approve the Notice of Intention to Drill the above described well to a depth of approximately 2300 feet to test the Yates and Seven Rivers formations. Please notify the District Engineer, U. S. Geological Survey, Drawer U, Artesia, New Mexico, in sufficient time for a representative to witness all cementing operations.

Very truly yours,

(Orig. Sgd.) JOHN A. ANDERSON

JOHN A. ANDERSON
Regional Oil and Gas Supervisor

Copy to: Washington (w/cy notice & ltr.)
MWDGC, Artesia (w/2 cy of ltr. & Notice)
7



UNITED STATES
DEPARTMENT OF THE INTERIOR
GEOLOGICAL SURVEY

W. C. Calkins
Geologist

RECEIVED
JUN 10 1908
IN THE
OFFICE OF THE
DIRECTOR

Very respectfully,
W. C. Calkins
Geologist

Enclosed for the
Director of the
Geological Survey
are two copies of
a report on the
geology of the
vicinity of
the town of
Calkins, in
the State of
Texas.

Very respectfully,
W. C. Calkins
Geologist

N. M. O. C. C. COPY
(SUBMIT IN TRIPLICATE)

UNITED STATES
DEPARTMENT OF THE INTERIOR
GEOLOGICAL SURVEY

Budget Bureau No. 42-1338.2
Approval expires 12-31-60.

Land Office

Lease No.

Unit

RECEIVED
FEB 1 1961
O. C. C.
ARTESIA, OFFICE

SUNDRY NOTICES AND REPORTS ON WELLS

NOTICE OF INTENTION TO DRILL <i>Amended</i>	<input checked="" type="checkbox"/>	SUBSEQUENT REPORT OF WATER SHUT-OFF	
NOTICE OF INTENTION TO CHANGE PLANS		SUBSEQUENT REPORT OF SHOOTING OR ACIDIZING	
NOTICE OF INTENTION TO TEST WATER SHUT-OFF		SUBSEQUENT REPORT OF ALTERING CASING	
NOTICE OF INTENTION TO RE-DRILL OR REPAIR WELL		SUBSEQUENT REPORT OF RE-DRILLING OR REPAIR	
NOTICE OF INTENTION TO SHOOT OR ACIDIZE		SUBSEQUENT REPORT OF ABANDONMENT	
NOTICE OF INTENTION TO PULL OR ALTER CASING		SUPPLEMENTARY WELL HISTORY	
NOTICE OF INTENTION TO ABANDON WELL			

(INDICATE ABOVE BY CHECK MARK NATURE OF REPORT, NOTICE, OR OTHER DATA)

January 20, 1961

Well No. 3 is located 2310 ft. from [N] line and 990 ft. from [E] line of sec. 23
SE/4 NE/4 of Sec. 23 19S 30E NMPM
 (1/4 Sec. and Sec. No.) (Twp.) (Range) (Meridian)
Undesignated Edgy New Mexico
 (Field) (County or Subdivision) (State or Territory)

The elevation of the derrick floor above sea level is 3265 ft.

DETAILS OF WORK

(State names of and expected depths to objective sands; show sizes, weights, and lengths of proposed casings; indicate mudding jobs, cementing points, and all other important proposed work)

(See Attached Sheet)

RECEIVED

JAN 23 1961

U. S. GEOLOGICAL SURVEY
ARTESIA, NEW MEXICO

I understand that this plan of work must receive approval in writing by the Geological Survey before operations may be commenced.

Company G. W. Strake
 Address 3300 Gulf Building
Houston 2, Texas

By [Signature]
C. R. Note
 Title Prof. Supt.

RECEIVED
FEB 1 1961
Page Two O.C.C.
ARTESIA, OFFICE

DETAILS OF WORK

It is proposed to drill a well to test the Yates and Seven Rivers formations at a maximum depth of 2300 feet. The drilling will be done with rotary tool equipment.

Surface casing will be set to the top of the Massive Salt (approximately 550 feet). This casing will be 8-5/8" OD, 24#, J-55 grade or equivalent. The surface casing will be cemented with a volume sufficient to circulate the annular space to the surface of the ground.

Provided commercial oil and/or gas production is obtained, production casing will be set to total depth or plug-back total depth. The production casing will be 5-1/2" OD, 15.5#, J-55 Grade or equivalent. It will be cemented with a volume equivalent to 150% of the annular space from the bottom of the casing to the base of the Massive Salt, or a minimum of 150 sacks, and preceded with mud laden fluid circulated to the surface of the ground.

100-443887-100

NEW MEXICO OIL CONSERVATION COMMISSION
WELL LOCATION AND ACREAGE DEDICATION PLAT

SEE INSTRUCTIONS FOR COMPLETING THIS FORM ON THE REVERSE SIDE

SECTION A

Operator G. W. Strake		Lease Union-Federal		Well No. D. C. C.
Unit Letter H	Section 23	Township 19 South	Range 30 East	County Lady
Actual Footage Location of Well: 2310 feet from the North line and 990 feet from the East line				
Ground Level Elev. 3265	Producing Formation Yates or Seven Rivers		Pool Undesignated	Dedicated Acreage: 40 Acres

1. Is the Operator the only owner in the dedicated acreage outlined on the plat below? YES ☒ NO ____ . ("Owner" means the person who has the right to drill into and to produce from any pool and to appropriate the production either for himself or for himself and another. (65-3-29 (e) NMSA 1935 Comp.)
2. If the answer to question one is "no," have the interests of all the owners been consolidated by communitization agreement or otherwise? YES ____ NO ____ . If answer is "yes," Type of Consolidation ____
3. If the answer to question two is "no," list all the owners and their respective interests below:

Owner G. W. Strake	Land Description SE 1/4 NE 1/4 of Sec. 23, T19N, R30E NPM
3300 Gulf Building, Houston 2, Texas	

SECTION B

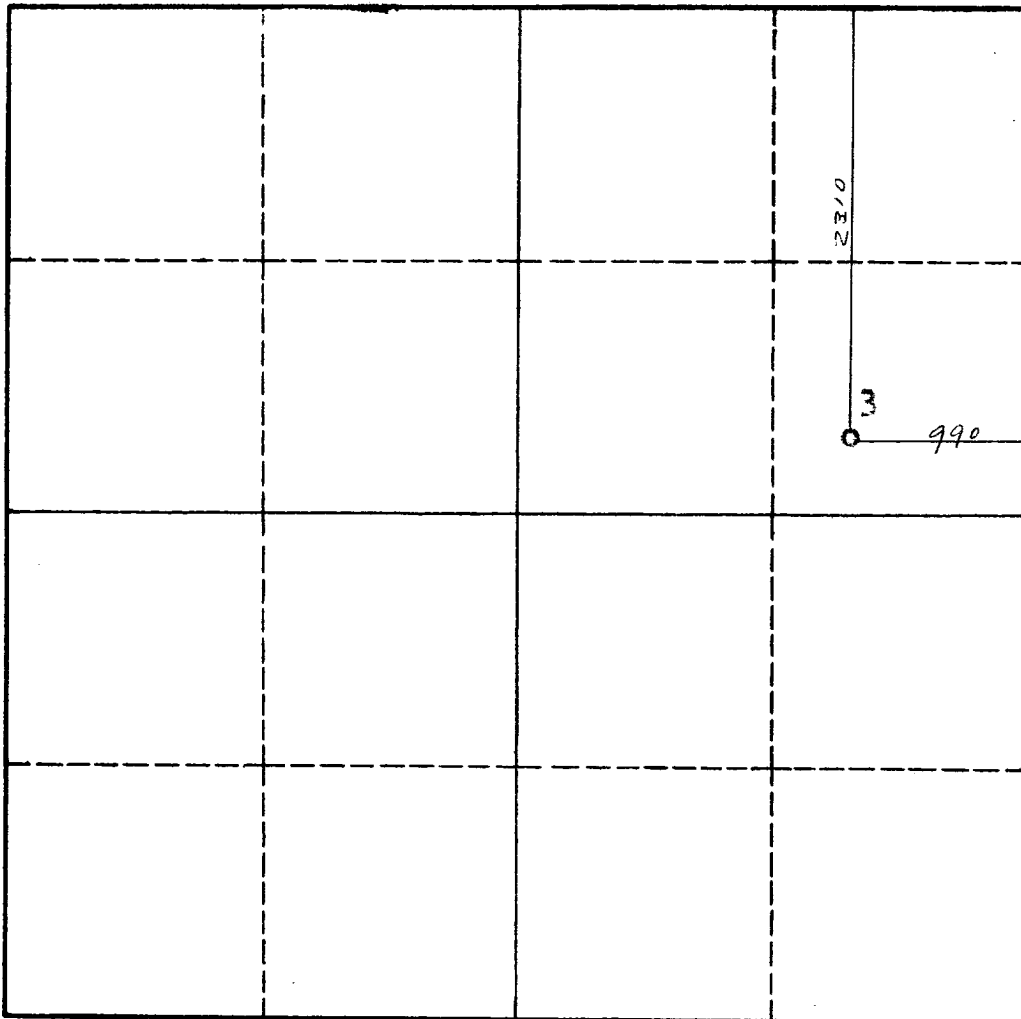

CERTIFICATION

I hereby certify that the information in SECTION A above is true and complete to the best of my knowledge and belief.

Name	C. R. Mote
Position	Prod. Supt.
Company	G. W. Strake
Date	January 20, 1961

I hereby certify that the well location shown on the plat in SECTION B was plotted from field notes of actual surveys made by me or under my supervision, and that the same is true and correct to the best of my knowledge and belief.

Date Surveyed	Jan. 18, 1961
Registered Professional Engineer and/or Land Surveyor	
John A. Mathew Jr.	
Certificate No.	1502

0 330 660 990 1320 1650 1980 2310 2640 2000 1500 1000 500 0

INSTRUCTIONS FOR COMPLETION OF FORM C-128

1. Operator shall furnish and certify to the information called for in Section A.
2. Operator shall outline the dedicated acreage for *both* oil and gas wells on the plat in Section B.
3. A registered professional engineer or land surveyor registered in the State of New Mexico or approved by the Commission shall show on the plat the location of the well and certify this information in the space provided.
4. All distances shown on the plat must be from the outer boundaries of the Section.
5. If additional space is needed for listing owners and their respective interests as required in question 3 of Section A, please use space below.