



UNITED STATES  
DEPARTMENT OF THE INTERIOR  
GEOLOGICAL SURVEY

Drews 1857  
Roswell, New Mexico

December 1, 1961

RECEIVED

Gulf Oil Corporation  
Box 2167  
Hobbs, New Mexico

DEC 3 1961

D. C. C.  
ARTESIA, OFFICE

Gentlemen:

Your Notice of Intention to Drill Helder "CR" well No. 5 (copy attached) in the NW 1/4 sec. 24, T. 19 S., R. 30 E., N.M.P.M., Eddy County, New Mexico, less New Mexico 06766, has been forwarded to this office for approval.

Pursuant to authority delegated by the Director, Geological Survey on June 7, 1961, I hereby approve the Notice of Intention to Drill the Helder "CR" well No. 5 to a depth of approximately 2,000 feet to test the Yates formation.

Please notify the District Engineer, Geological Survey, Drawer 8, Artesia, New Mexico, in sufficient time for a representative to witness all cementing operations.

Very truly yours,

*John A. Anderson*

JOHN A. ANDERSON 84 W. H. Feldmiller  
Regional Oil and Gas Supervisor

Attachment

Copy to: Washington (w/cy Notice)  
Mining Branch (2) (w/2 days Notice)  
NMOC-Artesia (2) (w/2 days Notice) ✓  
Artesia Office copy  
Roswell Office copy  
JAKnauf:gs 11-24-61

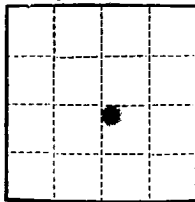
Form 9-331a  
(Feb. 1951)

(SUBMIT IN TRIPLICATE)

UNITED STATES  
DEPARTMENT OF THE INTERIOR  
GEOLOGICAL SURVEY

Land Office .....

Lease No. **W-06766**Unit **RECEIVED**

DEC 31

**SUNDRY NOTICES AND REPORTS ON WELLS**

D. C. C.  
ARTESIA, OFFICE

NOTICE OF INTENTION TO DRILL.....	<input checked="" type="checkbox"/>	SUBSEQUENT REPORT OF WATER SHUT-OFF.....	
NOTICE OF INTENTION TO CHANGE PLANS.....		SUBSEQUENT REPORT OF SHOOTING OR ACIDIZING.....	
NOTICE OF INTENTION TO TEST WATER SHUT-OFF.....		SUBSEQUENT REPORT OF ALTERING CASING.....	
NOTICE OF INTENTION TO RE-DRILL OR REPAIR WELL.....		SUBSEQUENT REPORT OF RE-DRILLING OR REPAIR.....	
NOTICE OF INTENTION TO SHOOT OR ACIDIZE.....		SUBSEQUENT REPORT OF ABANDONMENT.....	
NOTICE OF INTENTION TO PULL OR ALTER CASING.....		SUPPLEMENTARY WELL HISTORY.....	
NOTICE OF INTENTION TO ABANDON WELL.....			

(INDICATE ABOVE BY CHECK MARK NATURE OF REPORT, NOTICE, OR OTHER DATA)

**1650** November 16, 19 **61**

Federal Holder "CR" (Corporation) is located **2310** ft. from **S** line and **2310** ft. from **E** line of sec. **24**

**SE 1/4, Sec 24** **19-S** **30-S** **W11W**

(1/4 Sec. and Sec. No.) (Twp.) (Range) (Meridian)

**South Benson-Yates** **Edgy** **New Mexico**

(Field) (County or Subdivision) (State or Territory)

**RECEIVED****NOV 22 1961**

The elevation of the derrick floor above sea level is ..... ft.

U. S. GEOLOGICAL SURVEY  
ARTESIA, NEW MEXICO**DETAILS OF WORK**

(State names of and expected depths to objective sands; show sizes, weights, and lengths of proposed casings; indicate mudding jobs, cementing points, and all other important proposed work)

THIS FORM IS FILED TO SHOW CORRECTED LOCATION. PREVIOUS FORM 9-331a, FILED 8-24-61, SHOWED INCORRECT LOCATION.

It is proposed to drill to approximately 2000' with rotary tools and complete in the Yates formation. Proposed casing program is as follows:

Bore Size	Casing Size	Wt./ft	New or SH	Depth	Cement
11"	8-5/8"	21 1/2	New	550'	Circulate
7-7/8"	4-1/2"	9.5 1/2	New	2000'	Circulate

I understand that this plan of work must receive approval in writing by the Geological Survey before operations may be commenced.

Company **Gulf Oil Corporation**Address **Box 2167, Hobbs****New Mexico**By **[Signature]**Title **Area Production Manager**

**NEW MEXICO OIL CONSERVATION COMMISSION**  
**WELL LOCATION AND ACREAGE DEDICATION PLAT**

FORM C-128  
 Revised 5/1/57

**SEE INSTRUCTIONS FOR COMPLETING THIS FORM ON THE REVERSE SIDE**

**SECTION A**

Operator <b>Gulf Oil Corp.</b>			Lease <b>Federal Holder "CR"</b>		Well No. <b>5</b>
Unit Letter <b>I</b>	Section <b>24</b>	Township <b>19 South</b>	Range <b>30 East</b>	County <b>Eddy</b>	
Actual Footage Location of Well: <b>1650</b> feet from the <b>South</b> line and <b>2310</b> feet from the <b>East</b> line					
Ground Level Elev.	Producing Formation <b>South Canyon Yates</b>		Pool <b>South Canyon Yates</b>		Dedicated Acreage: <b>40</b> Acres

1. Is the Operator the only owner in the dedicated acreage outlined on the plat below? YES ☒ NO ☐ ("Owner" means the person who has the right to drill into and to produce from any pool and to appropriate the production either for himself or for himself and another. (65-3-29 (e) NMSA 1935 Comp.)
2. If the answer to question one is "no," have the interests of all the owners been consolidated by community or otherwise? YES ☐ NO ☐ If answer is "yes," Type of Consolidation \_\_\_\_\_
3. If the answer to question two is "no," list all the owners and their respective interests below:

Owner	Land Description

**RECEIVED**

**NOV 22 1961**

**U. S. GEOLOGICAL SURVEY  
 ARTESIA, NEW MEXICO**

**SECTION B**

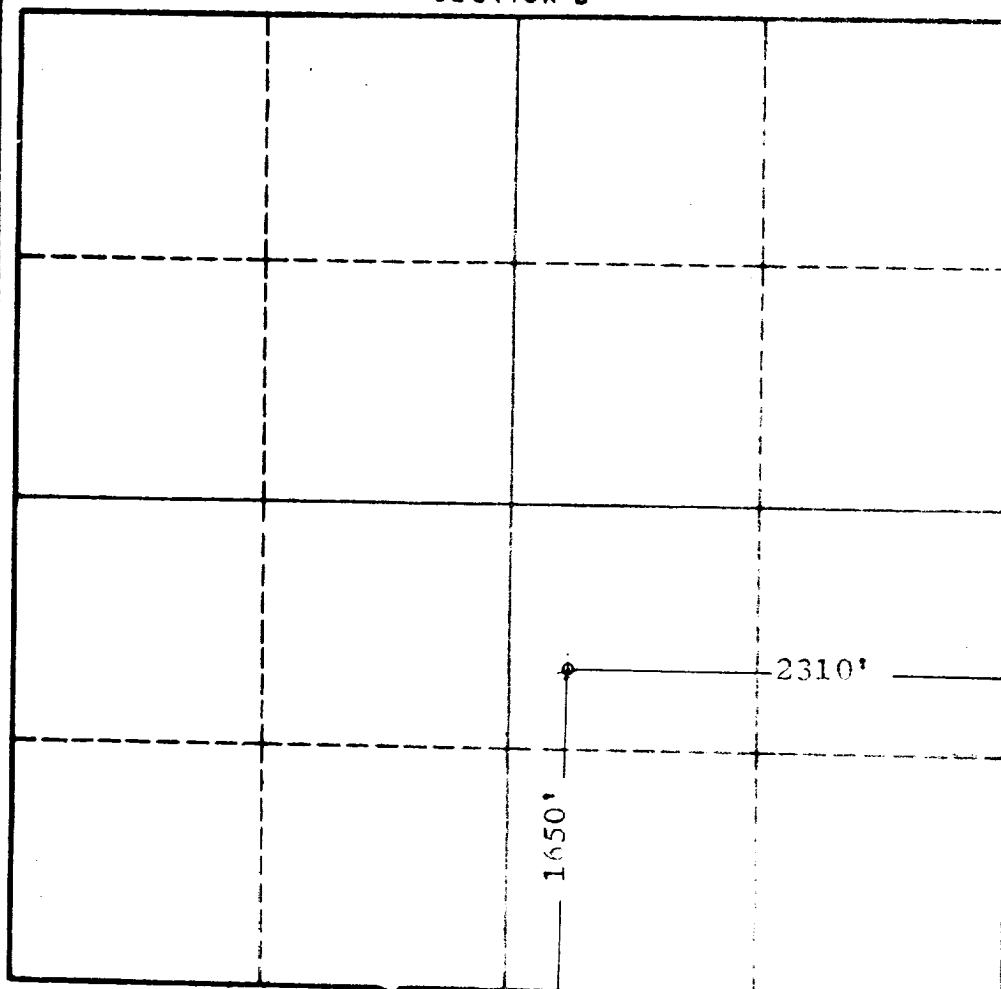

**CERTIFICATION**

I hereby certify that the information in SECTION A above is true and complete to the best of my knowledge and belief.

Name <b>J. M. RUSSELL</b>
Position <b>Area Production Manager</b>
Company <b>Gulf Oil Corporation</b>
Date <b>November 20, 1961</b>

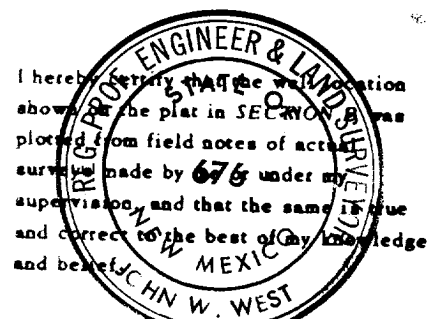

I hereby certify that the well location shown on the plat in SECTION B was plotted from field notes of actual survey made by **676** under my supervision, and that the same is true and correct to the best of my knowledge and belief.

Date Surveyed <b>11-13-61</b>
Registered Professional Engineer and/or Land Surveyor, <b>JOHN W. WEST</b>
Certificate No. <b>N. M. - P. E. &amp; L. S. NO. 676</b>

0 330 660 990 1320 1650 1980 2310 2640 2000 1500 1000 500