



UNITED STATES
DEPARTMENT OF THE INTERIOR
GEOLOGICAL SURVEY

Drawer 1857
Roswell, New Mexico

RECEIVED

APR 20 1961

APR 19 1961
ARTESIA, N.M.

Mr. G. W. Strake
330 Gulf Building
Houston 2, Texas

Dear Mr. Strake:

Your Notice of Intention to Drill Labow-Federal well No. 3 (copy attached) in the NW $\frac{1}{4}$ SE $\frac{1}{4}$ sec. 25, T. 19 S., R. 30 E., N.M.P.M., Eddy County, New Mexico, lease New Mexico 06767; has been forwarded to this office for approval. The lease lies within the "Potash Area" designated by the Secretary of the Interior and is subject to the stipulation that all wells drilled to formations above the base of the Delaware sand or to a depth above 5,000 feet, whichever is the lesser, must be approved by the Director of the Geological Survey.

Pursuant to authority delegated to me by the Director, U. S. Geological Survey on December 20, 1960, I hereby approve the Notice of Intention to Drill the Labow-Federal well No. 3 to a depth of approximately 2300 feet to test the Yates-Seven Rivers formations.

Please notify the District Engineer, U. S. Geological Survey, Drawer U, Artesia, New Mexico, insufficient time for a representative to witness all cementing operations.

Very truly yours,

[Signature]

JOHN A. ANDERSON
Regional Oil and Gas Supervisor

Attachment

Copy to: Washington (w/cy Notice)
NMOCC-Artesia (2) (w/2cys Notice)

UNITED STATES
DEPARTMENT OF THE INTERIOR
GEOLOGICAL SURVEY

RECEIVED
JAN 10 1964

[illegible]

(10) (11) (12)

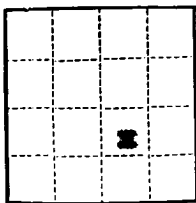

(SUBMIT IN TRIPLICATE)

UNITED STATES
DEPARTMENT OF THE INTERIOR
GEOLOGICAL SURVEY

Land Office

Lease No. **101-04757**

Unit **RECEIVED**

APR 20 1961

SUNDRY NOTICES AND REPORTS ON WELLS ☐ O. C. C.
ARTESIA, OFFICE

NOTICE OF INTENTION TO DRILL.....	<input checked="" type="checkbox"/>	SUBSEQUENT REPORT OF WATER SHUT-OFF.....	
NOTICE OF INTENTION TO CHANGE PLANS.....		SUBSEQUENT REPORT OF SHOOTING OR ACIDIZING.....	
NOTICE OF INTENTION TO TEST WATER SHUT-OFF.....		SUBSEQUENT REPORT OF ALTERING CASING.....	
NOTICE OF INTENTION TO RE-DRILL OR REPAIR WELL.....		SUBSEQUENT REPORT OF RE-DRILLING OR REPAIR.....	
NOTICE OF INTENTION TO SHOOT OR ACIDIZE.....		SUBSEQUENT REPORT OF ABANDONMENT.....	
NOTICE OF INTENTION TO PULL OR ALTER CASING.....		SUPPLEMENTARY WELL HISTORY.....	
NOTICE OF INTENTION TO ABANDON WELL.....			

(INDICATE ABOVE BY CHECK MARK NATURE OF REPORT, NOTICE, OR OTHER DATA)

April 12, 1961

Well No. **1** is located **1450** ft. from **N** line and **1900** ft. from **E** line of sec. **25**

NW/4 SE/4 of Sec. 25 (1/4 Sec. and Sec. No.) **19N** (Twp.) **10E** (Range) **RGN** (Meridian)
South Huerfano (Field) **Ally** (County or Subdivision) **New Mexico** (State or Territory)

The elevation **undesignated** above sea level is **3493** ft.

DETAILS OF WORK

(State names of and expected depths to objective sands; show sizes, weights, and lengths of proposed casings; indicate mudding jobs, cementing points, and all other important proposed work)

(See Attached)

RECEIVED

APR 14 1961

U. S. GEOLOGICAL SURVEY
ARTESIA, NEW MEXICO

I understand that this plan of work must receive approval in writing by the Geological Survey before operations may be commenced.

Company **G. M. Strake**

Address **1300 Gulf Building**

Houston 2, Texas

By **C. R. Mote**

Title **Prod. Supt.**

RECEIVED

APR 20 1961

OF WORK

O. C. C.
ARTESIA, OFFICE

proposed to drill a well to test the Yates and Seven Rivers
ations at a maximum depth of 2300 feet. The drilling will be
with rotary tool equipment or cable tools.

face casing will be set to the top of the Massive Salt (approximately
10 feet). This casing will be 8-5/8" OD, 24#, J-55 or 7" OD, 23#, J-55
grade or equivalent. The surface casing will be cemented with a volume
sufficient to circulate the annular space to the surface of the ground.

Provided commercial oil and/or gas production is obtained, production
casing will be set to total depth or plug-back total depth. The pro-
duction casing will be 4-1/2" OD, 9.5#, J-55 grade or equivalent. It
will be cemented with a volume equivalent to 150% of the annular space
from the bottom of the casing to the base of the Massive Salt, or a
minimum of 150 sacks, and preceded with mud laden fluid circulated to
the surface of the ground.

Figure 1. The effect of the concentration of the *Agrobacterium* suspension on the transformation efficiency of *Agrobacterium* strains.

1. The first step in the process of the investigation is the identification of the problem. This is done by the investigator who is assigned to the case. The investigator will then gather information about the problem and the people involved. This information will be used to develop a plan of action.

NUMBER OF COPIES RECEIVED	
DISTRIBUTION	
SANTA FE	
FILE	
U.S.G.S.	
LAND OFFICE	
TRANSPORTER	OIL GAS
PRODUCTION OFFICE	
OPERATOR	

NEW MEXICO OIL CONSERVATION COMMISSION
WELL LOCATION AND ACREAGE DEDICATION **RECEIVED**
 SEE INSTRUCTIONS FOR COMPLETING THIS FORM ON THE REVERSE SIDE

FORM C-128
 Revised 5/1/57

APR 20 1961

SECTION A

Operator G.W. Strake		Lease LeRoy Federal		D. C. C. OFFICE 3	
Unit Letter 8	Section 25	Township 19 South	Range 30 East	County Eddy	
Actual Footage Location of Well: 1650 feet from the South line and 1980 feet from the East line					
Ground Level Elev. 3403	Producing Formation Yates or Seven Rivers	Pool unlabeled	Dedicated Acreage: 40 Acres		

1. Is the Operator the only owner in the dedicated acreage outlined on the plat below? YES ☒ NO ____ . ("Owner" means the person who has the right to drill into and to produce from any pool and to appropriate the production either for himself or for himself and another. (65-3-29 (e) NMSA 1935 Comp.)
2. If the answer to question one is "no," have the interests of all the owners been consolidated by communitization agreement or otherwise? YES ____ NO ____ . If answer is "yes," Type of Consolidation ____
3. If the answer to question two is "no," list all the owners and their respective interests below:

Owner G. W. Strake, 3300 Gulf Building,	Land Description NW/4 SE/4 of Section 25, T19S, R30E, N27W
Houston 2, Texas	

SECTION B

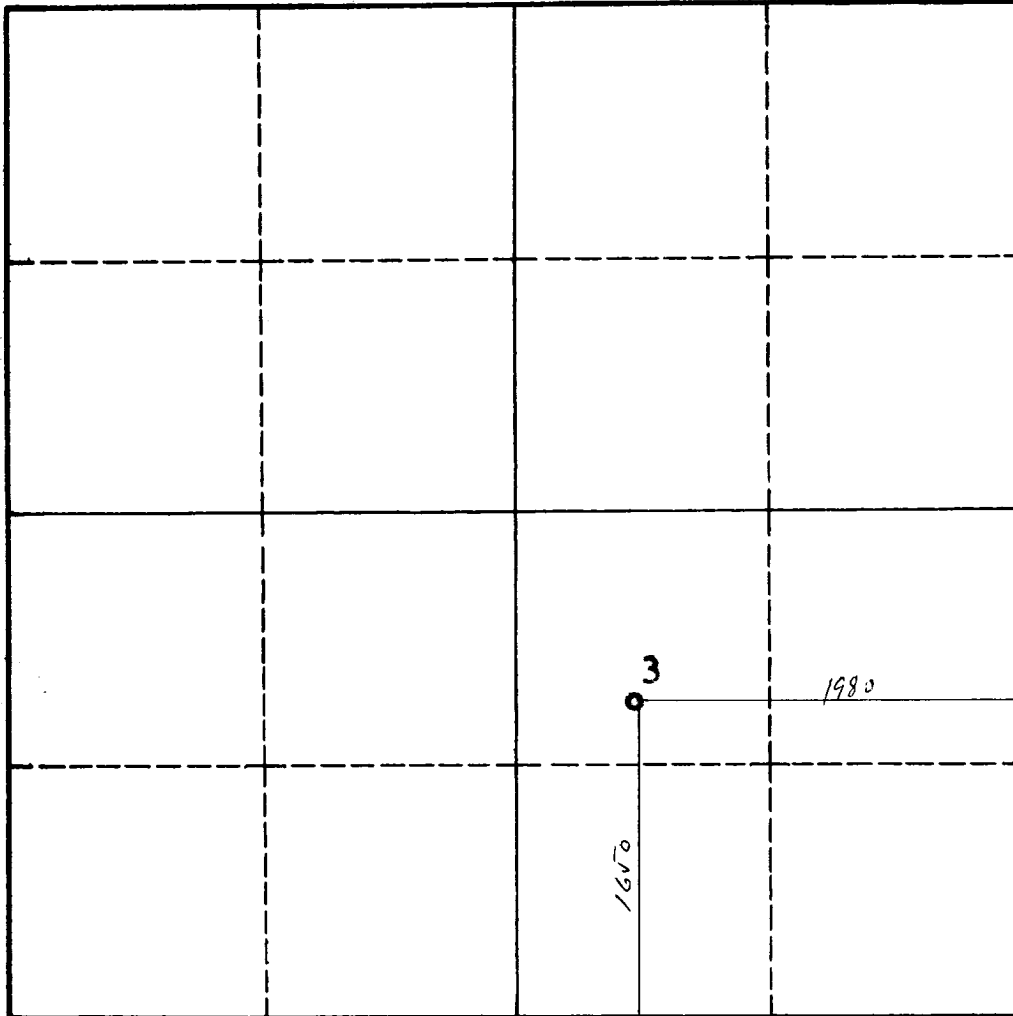

CERTIFICATION

I hereby certify that the information in SECTION A above is true and complete to the best of my knowledge and belief.

Name C. R. Kato
Position Prod. Supt.
Company G. W. Strake
Date April 12, 1961

I hereby certify that the well location shown on the plat in SECTION B was plotted from field notes of actual surveys made by me or under my supervision, and that the same is true and correct to the best of my knowledge and belief.

Date Surveyed April 10, 1961
Registered Professional Engineer and/or Land Surveyor John A. Mathis
Certificate No: 1502

0 330 660 990 1320 1650 1980 2310 2640 2000 1500 1000 500 0

INSTRUCTIONS FOR COMPLETION OF FORM C-128

1. Operator shall furnish and certify to the information called for in Section A.
2. Operator shall outline the dedicated acreage for *both* oil and gas wells on the plat in Section B.
3. A registered professional engineer or land surveyor registered in the State of New Mexico or approved by the Commission shall show on the plat the location of the well and certify this information in the space provided.
4. All distances shown on the plat must be from the outer boundaries of the Section.
5. If additional space is needed for listing owners and their respective interests as required in question 3 of Section A, please use space below.



UNITED STATES
DEPARTMENT OF THE INTERIOR
GEOLOGICAL SURVEY

P. O. Box 6721
Roswell, New Mexico

RECEIVED

IN REPLY REFER TO:

DEC 21 1960
U. S. GEOLOGICAL SURVEY
ARTESIAN OFFICE

December 21, 1960

Mr. G. W. Straub
1300 Gulf Building
Houston 2, Texas

Dear Mr. Straub:

Reference is made to your Notice of Intention to Drill well No. 3
Lester-Federal (copy attached) in the SW 1/4 sec. 23, T. 19 S.,
R. 30 E., N.M.P.M., Eddy County, New Mexico, on lease New Mexico
06767. Inasmuch as said lease lies within the "Potash Area"
designated by the Secretary of the Interior on October 16, 1951,
it is subject to the "Potash Stipulation."

Pursuant to the authority delegated by the Director, U. S. Geological
Survey on December-20, 1960, I hereby approve the Notice of Intention
to Drill the above described well to a depth of approximately 2000 feet
to test the Yates and Seven Rivers Formations. Please notify the
District Engineer, U. S. Geological Survey, Denver 8, Colorado,
New Mexico, in sufficient time for a representative to witness all
coring operations.

Very truly yours,

JOHN A. ANDERSON
Regional Oil and Gas Supervisor

Copy to: Washington (ltr. only)
72002, Artesia (w/2 cy of ltr. & Notice)

*as per telephone
communication with
Shaw
May 31, 1961*

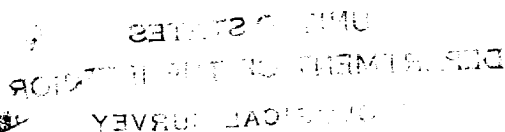

Journal of Management Education 30(6)p. 789-804
© The Author(s) 2006. Reprints and permissions:
<http://www.sagepub.com/journalsPermissions.nav>

2010 年 12 月 10 日

SECRET

1951-1952

1. The first step in the process of the investigation is the identification of the subject. This is done by the use of the subject's name, address, and other identifying information. The subject is then located and interviewed. The interview is conducted in a confidential manner and the subject is assured that their information will be kept confidential. The information obtained from the interview is then used to determine the subject's activities and associations. This information is then used to determine the subject's involvement in the investigation. The investigation is then conducted in a confidential manner and the subject is assured that their information will be kept confidential. The information obtained from the interview is then used to determine the subject's activities and associations. This information is then used to determine the subject's involvement in the investigation.

[illegible]

... *Y. enterocolitica* ...

[illegible]

1940-1941, 1942-1943, 1944-1945, 1946-1947, 1948-1949, 1950-1951, 1952-1953, 1954-1955, 1956-1957, 1958-1959, 1960-1961, 1962-1963, 1964-1965, 1966-1967, 1968-1969, 1970-1971, 1972-1973, 1974-1975, 1976-1977, 1978-1979, 1980-1981, 1982-1983, 1984-1985, 1986-1987, 1988-1989, 1990-1991, 1992-1993, 1994-1995, 1996-1997, 1998-1999, 2000-2001, 2002-2003, 2004-2005, 2006-2007, 2008-2009, 2010-2011, 2012-2013, 2014-2015, 2016-2017, 2018-2019, 2020-2021, 2022-2023, 2024-2025, 2026-2027, 2028-2029, 2030-2031, 2032-2033, 2034-2035, 2036-2037, 2038-2039, 2040-2041, 2042-2043, 2044-2045, 2046-2047, 2048-2049, 2050-2051, 2052-2053, 2054-2055, 2056-2057, 2058-2059, 2060-2061, 2062-2063, 2064-2065, 2066-2067, 2068-2069, 2070-2071, 2072-2073, 2074-2075, 2076-2077, 2078-2079, 2080-2081, 2082-2083, 2084-2085, 2086-2087, 2088-2089, 2090-2091, 2092-2093, 2094-2095, 2096-2097, 2098-2099, 2100-2101, 2102-2103, 2104-2105, 2106-2107, 2108-2109, 2110-2111, 2112-2113, 2114-2115, 2116-2117, 2118-2119, 2120-2121, 2122-2123, 2124-2125, 2126-2127, 2128-2129, 2130-2131, 2132-2133, 2134-2135, 2136-2137, 2138-2139, 2140-2141, 2142-2143, 2144-2145, 2146-2147, 2148-2149, 2150-2151, 2152-2153, 2154-2155, 2156-2157, 2158-2159, 2160-2161, 2162-2163, 2164-2165, 2166-2167, 2168-2169, 2170-2171, 2172-2173, 2174-2175, 2176-2177, 2178-2179, 2180-2181, 2182-2183, 2184-2185, 2186-2187, 2188-2189, 2190-2191, 2192-2193, 2194-2195, 2196-2197, 2198-2199, 2200-2201, 2202-2203, 2204-2205, 2206-2207, 2208-2209, 2210-2211, 2212-2213, 2214-2215, 2216-2217, 2218-2219, 2220-2221, 2222-2223, 2224-2225, 2226-2227, 2228-2229, 2230-2231, 2232-2233, 2234-2235, 2236-2237, 2238-2239, 2240-2241, 2242-2243, 2244-2245, 2246-2247, 2248-2249, 2250-2251, 2252-2253, 2254-2255, 2256-2257, 2258-2259, 2260-2261, 2262-2263, 2264-2265, 2266-2267, 2268-2269, 2270-2271, 2272-2273, 2274-2275, 2276-2277, 2278-2279, 2280-2281, 2282-2283, 2284-2285, 2286-2287, 2288-2289, 2290-2291, 2292-2293, 2294-2295, 2296-2297, 2298-2299, 2300-2301, 2302-2303, 2304-2305, 2306-2307, 2308-2309, 2310-2311, 2312-2313, 2314-2315, 2316-2317, 2318-2319, 2320-2321, 2322-2323, 2324-2325, 2326-2327, 2328-2329, 2330-2331, 2332-2333, 2334-2335, 2336-2337, 2338-2339, 2340-2341, 2342-2343, 2344-2345, 2346-2347, 2348-2349, 2350-2351, 2352-2353, 2354-2355, 2356-2357, 2358-2359, 2360-2361, 2362-2363, 2364-2365, 2366-2367, 2368-2369, 2370-2371, 2372-2373, 2374-2375, 2376-2377, 2378-2379, 2380-2381, 2382-2383, 2384-2385, 2386-2387, 2388-2389, 2390-2391, 2392-2393, 2394-2395, 2396-2397, 2398-2399, 2400-2401, 2402-2403, 2404-2405, 2406-2407, 2408-2409, 2410-2411, 2412-2413, 2414-2415, 2416-2417, 2418-2419, 2420-2421, 2422-2423, 2424-2425, 2426-2427, 2428-2429, 2430-2431, 2432-2433, 2434-2435, 2436-2437, 2438-2439, 2440-2441, 2442-2443, 2444-2445, 2446-2447, 2448-2449, 2450-2451, 2452-2453, 2454-2455, 2456-2457, 2458-2459, 2460-2461, 2462-2463, 2464-2465, 2466-2467, 2468-2469, 2470-2471, 2472-2473, 2474-2475, 2476-2477, 2478-2479, 2480-2481, 2482-2483, 2484-2485, 2486-2487, 2488-2489, 2490-2491, 2492-2493, 2494-2495, 2496-2497, 2498-2499, 2500-2501, 2502-2503, 2504-2505, 2506-2507, 2508-2509, 2510-2511, 2512-2513, 2514-2515, 2516-2517, 2518-2519, 2520-2521, 2522-2523, 2524-2525, 2526-2527, 2528-2529, 2530-2531, 2532-2533, 2534-2535, 2536-2537, 2538-2539, 2540-2541, 2542-2543, 2544-2545, 2546-2547, 2548-2549, 2550-2551, 2552-2553, 2554-2555, 2556-2557, 2558-2559, 2560-2561, 2562-2563, 2564-2565, 2566-2567, 2568-2569, 2570-2571, 2572-2573, 2574-2575, 2576-2577, 2578-2579, 2580-2581, 2582-2583, 2584-2585, 2586-2587, 2588-2589, 2590-2591, 2592-2593, 2594-2595, 2596-2597, 2598-2599, 2600-2601, 2602-2603, 2604-2605, 2606-2607, 2608-2609, 2610-2611, 2612-2613, 2614-2615, 2616-2617, 2618-2619, 2620-2621, 2622-2623, 2624-2625, 2626-2627, 2628-2629, 2630-2631, 2632-2633, 2634-2635, 2636-2637, 2638-2639, 2640-2641, 2642-2643, 2644-2645, 2646-2647, 2648-2649, 2650-2651, 2652-2653, 2654-2655, 2656-2657, 2658-2659, 2660-2661, 2662-2663, 2664-2665, 2666-2667, 2668-2669, 2670-2671, 2672-2673, 2674-2675, 2676-2677, 2678-2679, 2680-2681, 2682-2683, 26

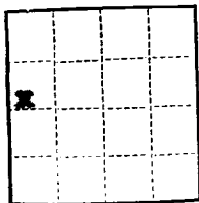

(SUBMIT IN TRIPLICATE)

UNITED STATES
DEPARTMENT OF THE INTERIOR
GEOLOGICAL SURVEY

Land Office _____
Lease No. **HH-06767**
Unit _____

SUNDRY NOTICES AND REPORTS ON WELLS

NOTICE OF INTENTION TO DRILL	<input checked="" type="checkbox"/>	SUBSEQUENT REPORT OF WATER SHUT-OFF	
NOTICE OF INTENTION TO CHANGE PLANS		SUBSEQUENT REPORT OF SHOOTING OR ACIDIZING	
NOTICE OF INTENTION TO TEST WATER SHUT-OFF		SUBSEQUENT REPORT OF ALTERING CASING	
NOTICE OF INTENTION TO RE-DRILL OR REPAIR WELL		SUBSEQUENT REPORT OF RE-DRILLING OR REPAIR	
NOTICE OF INTENTION TO SHOOT OR ACIDIZE		SUBSEQUENT REPORT OF ABANDONMENT	
NOTICE OF INTENTION TO PULL OR ALTER CASING		SUPPLEMENTARY WELL HISTORY	
NOTICE OF INTENTION TO ABANDON WELL			

(INDICATE ABOVE BY CHECK MARK NATURE OF REPORT, NOTICE, OR OTHER DATA)

Well No. **3** is located **1980** ft. from **184** line and **660** ft. from **W** line of sec. **25**
LoDow-Federal
34 1/4 Sec. 25 (1/4 Sec. and Sec. No.) **195** (Twp.) **3E** (Range) **104W** (Meridian)
Undesignated (Field) **Eddy** (County or Subdivision) **New Mexico** (State or Territory)

The elevation of the derrick floor above sea level is **3245** ft.

DETAILS OF WORK

(State names of and expected depths to objective sands; show sizes, weights, and lengths of proposed casings; indicate mudding jobs, cementing points, and all other important proposed work)

See Attached

RECEIVED

DEC 13 1960

U. S. GEOLOGICAL SURVEY
ARTESIA, NEW MEXICO

I understand that this plan of work must receive approval in writing by the Geological Survey before operations may be commenced.

Company **G. W. Strake**
Address **3300 Gulf Building**
Houston 2, Texas

By **C. E. Fote**
Title **Prod. Supt.**

DETAILS OF WORK

It is proposed to drill a well to test the Yates and Seven Rivers formations at a maximum depth of 2300 feet. The drilling will be done with rotary tool equipment.

Surface casing will be set to the top of the Massive Salt (approximately 500 feet). This casing will be 8-5/8" OD, 24#, J-55 grade or equivalent. The surface casing will be cemented with a volume sufficient to circulate the annular space to the surface of the ground.

Provided commercial oil and/or gas production is obtained, production casing will be set to total depth or plug-back total depth. The production casing will be 5-1/2" OD, 15.5#, J-55 grade or equivalent. It will be cemented with a volume equivalent to 150% of the annular space from the bottom of the casing to the base of the Massive Salt, or a minimum of 150 sacks, and preceded with mud laden fluid circulated to the surface of the ground.

NEW MEXICO OIL CONSERVATION COMMISSION
WELL LOCATION AND ACREAGE DEDICATION PLAT

FORM C-128
 Revised 5/1/57

SEE INSTRUCTIONS FOR COMPLETING THIS FORM ON THE REVERSE SIDE

SECTION A

Operator G.W. Strake		Lease LeBow-Federal		Well No. 3
Unit Letter E	Section 25	Township 19 South	Range 30 East	County Eddy
Actual Footage Location of Well: 1980 feet from the North line and 660 feet from the West line				
Ground Level Elev. 3245	Producing Formation Yates or Seven Rivers	Pool Undesignated	Dedicated Acreage: 40 Acres	

1. Is the Operator the only owner in the dedicated acreage outlined on the plat below? YES ☒ NO ☐ . ("Owner" means the person who has the right to drill into and to produce from any pool and to appropriate the production either for himself or for himself and another. (65-3-29 (e) NMSA 1935 Comp.)
2. If the answer to question one is "no," have the interests of all the owners been consolidated by communitization agreement or otherwise? YES ☐ NO ☐ . If answer is "yes," Type of Consolidation _____
3. If the answer to question two is "no," list all the owners and their respective interests below:

Owner G. W. Strake, 3300 Gulf Building Houston 2, Texas	Land Description SW/4 NW/4 of Section 25, T19S, R30E, N40W
---	--

SECTION B

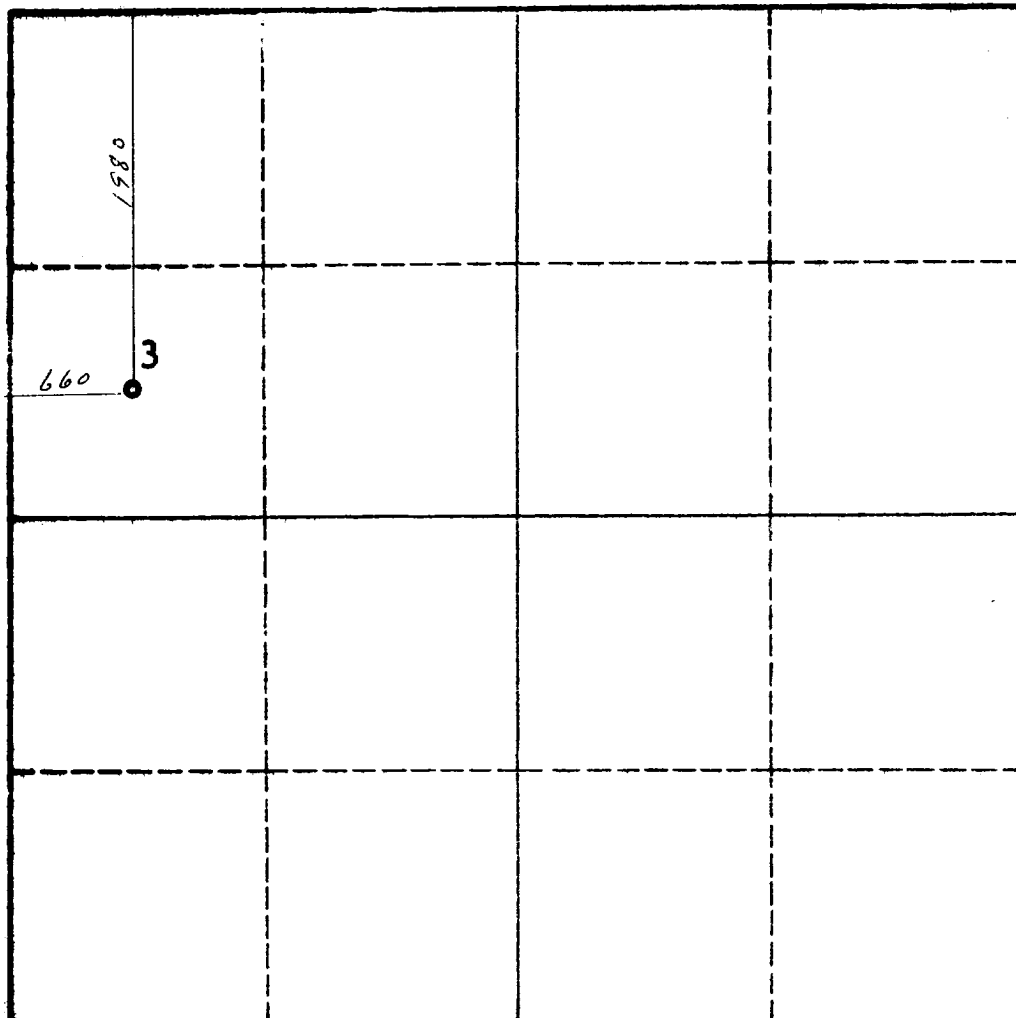

CERTIFICATION

I hereby certify that the information in SECTION A above is true and complete to the best of my knowledge and belief.

Name C. R. Mote
Position Prod. Supt.
Company G. W. Strake
Date December 12, 1960

I hereby certify that the well location shown on the plat in SECTION B was plotted from field notes of actual surveys made by me or under my supervision, and that the same is true and correct to the best of my knowledge and belief.

Date Surveyed November 14, 1960
Registered Professional Engineer and/or Land Surveyor John A. Matlock
Certificate No. 1502

0 330 660 990 1320 1650 1980 2310 2640 2000 1500 1000 500 0

INSTRUCTIONS FOR COMPLETION OF FORM C-128

1. Operator shall furnish and certify to the information called for in Section A.
2. Operator shall outline the dedicated acreage for *both* oil and gas wells on the plat in Section B.
3. A registered professional engineer or land surveyor registered in the State of New Mexico or approved by the Commission shall show on the plat the location of the well and certify this information in the space provided.
4. All distances shown on the plat must be from the outer boundaries of the Section.
5. If additional space is needed for listing owners and their respective interests as required in question 3 of Section A, please use space below.