



copy to 58.
UNITED STATES
DEPARTMENT OF THE INTERIOR
GEOLOGICAL SURVEY

P.O. Box 6721
Roswell, New Mexico

February 14, 1961

IN REPLY REFER TO:

RECEIVED
FEB 16 1961
D. C. C.
ARTESIA, OFFICE

Cosden Petroleum Corporation
Box 1311
Big Spring, Texas

Attention: Mr. H. L. Weeks

Gentlemen:

Reference is made to your Notice of Intention to Drill (copy attached) well No. 1 Federal "H" in the NE $\frac{1}{4}$ NE $\frac{1}{4}$ sec. 26, T. 19 S., R. 30 E., N.M.P.M., Eddy County, New Mexico, on lease New Mexico 06768. Said lease is located within the "Potash Area" designated by order of the Secretary of the Interior dated October 16, 1951, and is subject to the "Potash Stipulation."

Pursuant to the authority delegated by the Director, U.S. Geological Survey on February 7, 1961, I hereby approve the Notice of Intention to Drill the above described well to a depth of approximately 2,200 feet to test the Yates sand. Please notify the District Engineer, U.S. Geological Survey, Drawer U, Artesia, New Mexico, in sufficient time for a representative to witness all cementing operations.

Very truly yours,

(Orig. Sgd.) JOHN A. ANDERSON

JOHN A. ANDERSON
Regional Oil and Gas Supervisor

Copy to: Washington
NMOCC, Artesia (2) (w/cy(2)notice)

(SUBMIT IN TRIPLICATE)

UNITED STATES
DEPARTMENT OF THE INTERIOR
GEOLOGICAL SURVEY

Land Office **Artesia, New Mex.**
Lease No. **20 0040**
Unit _____
RECEIVED
FEB 16 1961
D. C. F.
ARTESIA, OFFICE

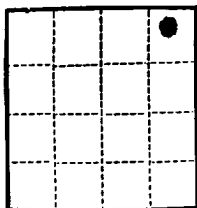

SUNDRY NOTICES AND REPORTS ON WELLS

NOTICE OF INTENTION TO DRILL	<input checked="" type="checkbox"/>	SUBSEQUENT REPORT OF WATER SHUT-OFF	
NOTICE OF INTENTION TO CHANGE PLANS		SUBSEQUENT REPORT OF SHOOTING OR ACIDIZING	
NOTICE OF INTENTION TO TEST WATER SHUT-OFF		SUBSEQUENT REPORT OF ALTERING CASING	
NOTICE OF INTENTION TO RE-DRILL OR REPAIR WELL		SUBSEQUENT REPORT OF RE-DRILLING OR REPAIR	
NOTICE OF INTENTION TO SHOOT OR ACIDIZE		SUBSEQUENT REPORT OF ABANDONMENT	
NOTICE OF INTENTION TO PULL OR ALTER CASING		SUPPLEMENTARY WELL HISTORY	
NOTICE OF INTENTION TO ABANDON WELL			

(INDICATE ABOVE BY CHECK MARK NATURE OF REPORT, NOTICE, OR OTHER DATA)

Condon Petroleum Corporation's _____ **January 17**, 19 **61**
Federal "F"

Well No. **1** is located **300** ft. from **[N]** line and **440** ft. from **[E]** line of sec. **26**

NE/4 Sec. 24 **19-0** **20-0** **20-0**
(1/4 Sec. and Sec. No.) (Twp.) (Range) (Meridian)
Hardy **Hardy** **New Mexico**
(Field) (County or Subdivision) (State or Territory)

The elevation of the derrick floor above sea level is _____ ft.

JAN 19 1961

DETAILS OF WORK

(State names of and expected depths to objective sands; show sizes, weights, and lengths of proposed casings; indicate mudding jobs, cementing points, and all other important proposed work)

To drill to approx. 1100' & test the Tule Sand with "Heavy" or "Cable Tools".
Casing and approx. hole size program to be as follows:
8-3/8" 240 lb 110' to be set in an 11 in. hole at approx. 475' or into the
"Top of the Salt" and cement will be circulated. 5-1/2" csg will be set at T.B.
in a 7-7/8" hole and cemented with a volume of cement, exceeding 100% of the estimated
volume of annular space from "T.B." to the "Base of the Salt".
An alternate program will be to set 7" 170 lb 110' in a 7" hole and 4-1/2" 9.50 lb 3-35 in
a 6-1/4" hole.
Cementing and depths will be as above.

If "cable tools" are used for drilling; fluid will be circulated before cementing.

I understand that this plan of work must receive approval in writing by the Geological Survey before operations may be commenced.

Company **CONDON PETROLEUM CORPORATION**
Address **Box 1311**
Big Spring, Texas
By **[Signature]**
H. L. Woods
Title **Supt. of Production**

NEW MEXICO OIL CONSERVATION COMMISSION
WELL LOCATION AND ACREAGE DEDICATION PLAT

SEE INSTRUCTIONS FOR COMPLETING THIS FORM ON THE REVERSE SIDE

SECTION A

Operator Cosden Petroleum Corp.			Lease Federal WHM		
Unit Letter A	Section 26	Township 19 South	Range 30 East	County Eddy	
Actual Footage Location of Well: 330 feet from the North line and 660 feet from the East line					
Ground Level Elev. •	Producing Formation Yates		Pool Hackberry		Dedicated Acreage: 40 Acres

1. Is the Operator the only owner in the dedicated acreage outlined on the plat below? YES ☒ NO ☐ ("Owner" means the person who has the right to drill into and to produce from any pool and to appropriate the production either for himself or for himself and another. (65-3-29 (a) NMSA 1955 Comp.)
2. If the answer to question one is "no," have the interests of all the owners been consolidated by communitization agreement or otherwise? YES ☐ NO ☐ If answer is "yes," Type of Consolidation _____
3. If the answer to question two is "no," list all the owners and their respective interests below:

Owner	Land Description

RECEIVED

JAN 19 1961

U. S. GEOLOGICAL SURVEY
ARTESIA, NEW MEXICO

SECTION B

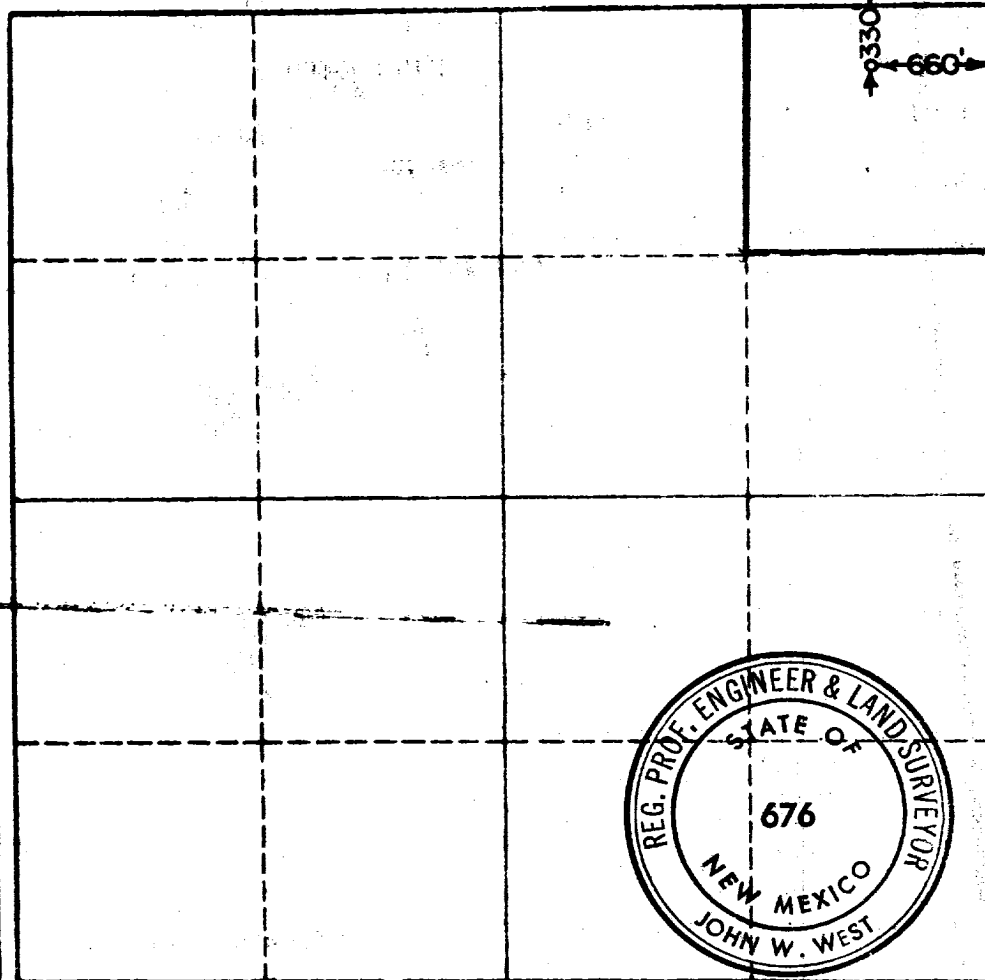

CERTIFICATION

I hereby certify that the information in SECTION A above is true and complete to the best of my knowledge and belief.

Name L. L. Wicks
Position Supt. of Production
Company COSDEN PETROLEUM CORPORATION
Date January 17, 1961

I hereby certify that the well location shown on the plat in SECTION B was plotted from field notes of actual surveys made by me or under my supervision, and that the same is true and correct to the best of my knowledge and belief.

Date Surveyed 1-5-61
Registered Professional Engineer and/or Land Surveyor, JOHN W. WEST
Certificate No. John W. West N. M. - P. E. & L. S. NO. 676

0 330 660 990 1320 1650 1980 2310 2640 2970 3300 3630 0