

NEW MEXICO OIL CONSERVATION COMMISSION
Santa Fe, New Mexico

NOTICE OF INTENTION TO DRILL OR RECOMPLETE

Notice must be given to the District Office of the Oil Conservation Commission and approval obtained before drilling or recompletion begins. If changes in the proposed plan are considered advisable, a copy of this notice showing such changes will be returned to the sender. Submit this notice in QUINTUPLICATE. One copy will be returned following approval. See additional instructions in Rules and Regulations of the Commission.

MIDLAND, TEXAS

(Place)

DECEMBER 27, 1955

(Date)

OIL CONSERVATION COMMISSION
SANTA FE, NEW MEXICO

Gentlemen:

You are hereby notified that it is our intention to commence the (Drilling) (~~Recompletion~~) of a well to be known as

W. H. BLACK

(Company or Operator)

STATE-LOWE

(Lease)

Well No. 1

in "A"

(Unit)

The well is

located 330 feet from the North line and 330 feet from the East line of Section 32, T. 19 S, R. 30 E, NMPM.

(GIVE LOCATION FROM SECTION LINE)

Wildcat

Pool,

Bdry

County

If State Land the Oil and Gas Lease is No. E-9542

If patented land the owner is

Address

We propose to drill well with drilling equipment as follows: Cable Tools

The status of plugging bond is Applied for

Drilling Contractor J. C. Clower

We intend to complete this well in the Yates Formation

formation at an approximate depth of 2100 feet.

CASING PROGRAM

We propose to use the following strings of Casing and to cement them as indicated:

Size of Hole	Size of Casing	Weight per Foot	New or Second Hand	Depth	Sacks Cement
12"	8-5/8"	26	New	300'	Sufficient to cement back to surface.
8"	5-1/2"	14	New	2100'	Suff. to cement back to bottom of surface casing

If changes in the above plans become advisable we will notify you immediately.

ADDITIONAL INFORMATION (If recompletion give full details of proposed plan of work.)

Approved....., 19.....
Except as follows:

OIL CONSERVATION COMMISSION

By *H. G. Hanson*

Title

Sincerely yours,

W. H. BLACK

(Company or Operator)

By *[Signature]*

Position Agent

Send Communications regarding well to

Name J. S. Bell,

Address Box 174

Midland, Texas

WELL LOCATION SURVEY PLAT

OPERATOR W H BLACK

LEASE STATE ~~WISCONSIN~~ LOWE

WELL NO. 1

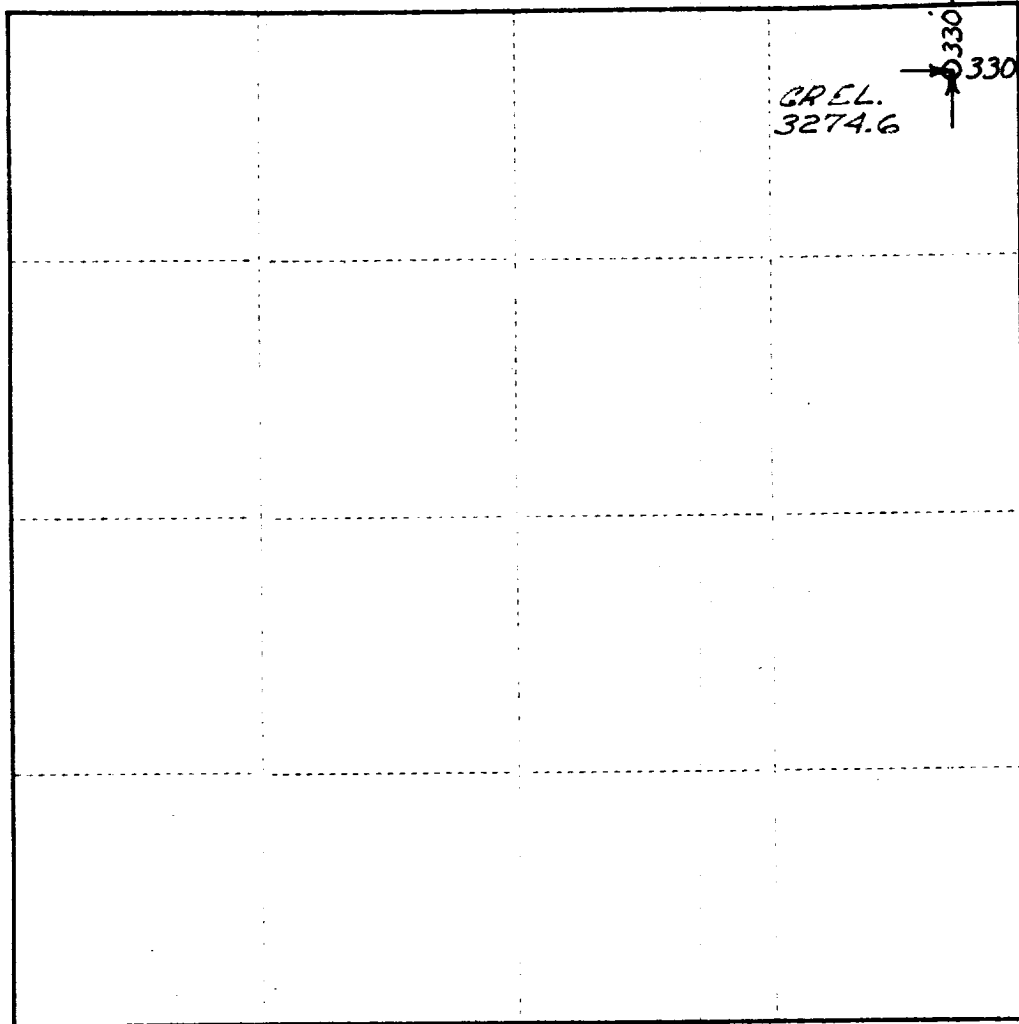

SEC. 32, TWP. 19 S., RGE. 30 E., N.M.P.M.

I HEREBY CERTIFY THAT THIS PLAT WAS MADE
FROM NOTES TAKEN IN THE FIELD BY ME AND
THAT THE SAME IS TRUE AND CORRECT TO THE
BEST OF MY KNOWLEDGE AND BELIEF.

John W West

JOHN W. WEST, PE & LS NO. 676

12-22-1955