

(SUBMIT IN TRIPLICATE)

UNITED STATES
DEPARTMENT OF THE INTERIOR
GEOLOGICAL SURVEY

Land Office **Las Cruces**
Lease No. **029388 (4)**
Unit **I**

SUNDRY NOTICES AND REPORTS ON WELLS

AUG 13 1957
GEOLOGICAL SURVEY
ALBUQUERQUE, NEW MEXICO

NOTICE OF INTENTION TO DRILL.....	<input checked="" type="checkbox"/>	SUBSEQUENT REPORT OF WATER SHUT-OFF.....	
NOTICE OF INTENTION TO CHANGE PLANS.....		SUBSEQUENT REPORT OF SHOOTING OR ACIDIZING.....	
NOTICE OF INTENTION TO TEST WATER SHUT-OFF.....		SUBSEQUENT REPORT OF ALTERING CASING.....	
NOTICE OF INTENTION TO RE-DRILL OR REPAIR WELL.....		SUBSEQUENT REPORT OF RE-DRILLING OR REPAIR.....	
NOTICE OF INTENTION TO SHOOT OR ACIDIZE.....		SUBSEQUENT REPORT OF ABANDONMENT.....	
NOTICE OF INTENTION TO PULL OR ALTER CASING.....		SUPPLEMENTARY WELL HISTORY.....	
NOTICE OF INTENTION TO ABANDON WELL.....			

(INDICATE ABOVE BY CHECK MARK NATURE OF REPORT, NOTICE, OR OTHER DATA)

Federal Johnson "A"

July 12, 1957

Well No. **4** is located **1900** ft. from **N** line and **660** ft. from **E** line of sec. **10**

N 1/4 Sec. 10 (1/4 Sec. and Sec. No.) **18 E** (Twp.) **31 E** (Range) (Meridian)
North Shogart (Field) **Eddy** (County or Subdivision) **New Mexico** (State or Territory)

The elevation of the derrick floor above sea level is _____ ft.

DETAILS OF WORK

(State names of and expected depths to objective sands; show sizes, weights, and lengths of proposed casings; indicate mudding jobs, cementing points, and all other important proposed work)

Plan to drill to Grayburg at approx. 4250', estimated total depth being 4400'.
Plan to set 9-5/8" OD casing. 32.3' at 800' with 400 sacks cement, and 5 1/2"
15.50#, J-55 casing to total depth using 450 sacks of cement. All casing will
be cemented and tested by approved method.

I understand that this plan of work must receive approval in writing by the Geological Survey before operations may be commenced.

Company **The Ohio Oil Company**

Address **P. O. Box 2167**

Hobbs, New Mexico

By **ORIGINAL**
SIGNED BY: E. G. HOWARD
Asst.
Title **Superintendent**

(See other side for distribution)

DISTRIBUTION:

New Mex. O.C.C.
Mr. J. A. Grimes
Mr. L. H. Spearer
Mr. H. J. Brunt
Mr. T. A. Steele
Mr. T. O. Webb

RECEIVED
JAN 10 1941

NEW MEXICO OIL CONSERVATION COMMISSION
Well Location and Acreage Dedication Plat

Section A.

Date 7-8-57

Operator Ohio Oil Co. Lease Federal Johnson "A"
Well No. 4 Unit Letter I Section 10 Township 18 S Range 31 E NMPM
Located 1980 Feet From South Line, 660 Feet From East Line
County Eddy G. L. Elevation 3722.2 Dedicated Acreage 40 Acres
Name of Producing Formation Queen Pool North Stuart

1. Is the Operator the only owner* in the dedicated acreage outlined on the plat below?
Yes X No .
2. If the answer to question one is "no," have the interests of all the owners been consolidated by communitization agreement or otherwise? Yes No . If answer is "yes," Type of Consolidation
3. If the answer to question two is "no," list all the owners and their respective interests below:

Owner

Land Description

Section B

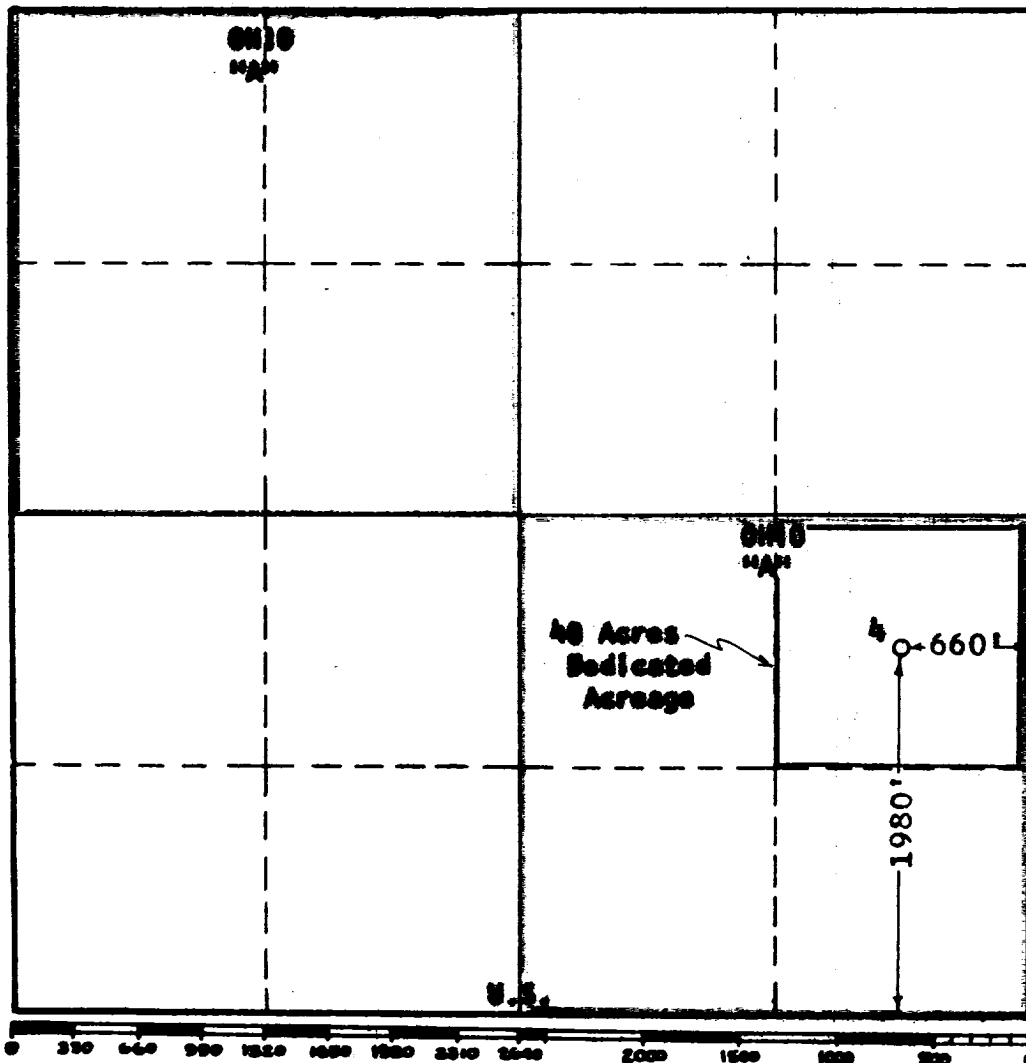

This is to certify that the information in Section A above is true and complete to the best of my knowledge and belief.

The Ohio Oil Company

(Operator)

Thomas O. Webb

(Representative)

P.O. Box 2107, Hobbs, N. Mex.
Address

This is to certify that the well location shown on the plat in Section B was plotted from field notes of actual surveys made by me or under my supervision and that the same is true and correct to the best of my knowledge and belief.

Date Surveyed 7-6-57

Colin W. West
Registered Professional
Engineer and/or Land Surveyor.

Certificate No. 676