

(SUBMIT IN TRIPLICATE)

UNITED STATES  
DEPARTMENT OF THE INTERIOR  
GEOLOGICAL SURVEY

Land Office Las Cruces  
Lease No. 029388 (4)  
Unit B

## SUNDRY NOTICES AND REPORTS ON WELLS

NOTICE OF INTENTION TO DRILL	<input checked="" type="checkbox"/>	SUBSEQUENT REPORT OF WATER SHUT-OFF
NOTICE OF INTENTION TO CHANGE PLANS		SUBSEQUENT REPORT OF SHOOTING OR ACIDIZING
NOTICE OF INTENTION TO TEST WATER SHUT-OFF		SUBSEQUENT REPORT OF ALTERING CASING
NOTICE OF INTENTION TO RE-DRILL OR REPAIR WELL		SUBSEQUENT REPORT OF RE-DRILLING OR REPAIR
NOTICE OF INTENTION TO SHOOT OR ACIDIZE		SUBSEQUENT REPORT OF ABANDONMENT
NOTICE OF INTENTION TO PULL OR ALTER CASING		SUPPLEMENTARY WELL HISTORY
NOTICE OF INTENTION TO ABANDON WELL		

(INDICATE ABOVE BY CHECK MARK NATURE OF REPORT, NOTICE, OR OTHER DATA)

Federal Johnson "B" a/c 1

November 20, 19 57

Well No. 2 is located 1980 ft. from N line and 660 ft. from W line of sec. 11  
SW/4, NW/4, Sec. 11 18 S 31 E  
(1/4 Sec. and Sec. No.) (Twp.) (Range) (Meridian)  
North Shugart Eddy New Mexico  
(Field) (County or Subdivision) (State or Territory)

The elevation of the derrick floor above sea level is \_\_\_\_\_ ft.

### DETAILS OF WORK

(State names of and expected depths to objective sands; show sizes, weights, and lengths of proposed casings; indicate mudding jobs, cementing points, and all other important proposed work)

Plan to drill to Grayburg at approximately 4250', estimated total depth being 4400'. Plan to set 9-5/8" OD 32.3# at 800' w/400 sacks cement, and 5-1/2" OD 15.50# casing to total depth, using 450 sacks cement. All casing will be cemented and tested by approved method.

I understand that this plan of work must receive approval in writing by the Geological Survey before operations may be commenced.

Company The Ohio Oil Company

Address P. O. Box 2107

Hobbs, New Mexico

Original Signed by  
By D. L. PROVINGS

Title Superintendent

NEW MEXICO OIL CONSERVATION COMMISSION  
Well Location and Acreage Dedication Plat

Section A.

Date 11-22-57

Operator Ohio Oil Co. Lease Federal Johnson "B" Account 1  
Well No. 2 Unit Letter E Section 11 Township 18 S Range 31 E NMPM  
Located 1980 Feet From North Line, 660 Feet From West Line  
County Eddy G. L. Elevation \_\_\_\_\_ Dedicated Acreage 40 Acres  
Name of Producing Formation Queen Pool North Shugart

1. Is the Operator the only owner\* in the dedicated acreage outlined on the plat below?  
Yes X No \_\_\_\_\_.
2. If the answer to question one is "no," have the interests of all the owners been consolidated by communitization agreement or otherwise? Yes \_\_\_\_\_ No \_\_\_\_\_. If answer is "yes," Type of Consolidation \_\_\_\_\_
3. If the answer to question two is "no," list all the owners and their respective interests below:

Owner

Land Description

RECEIVED  
NOV 26 1957  
U. S. DEPARTMENT OF  
ARTESIA, N. M.

Section B

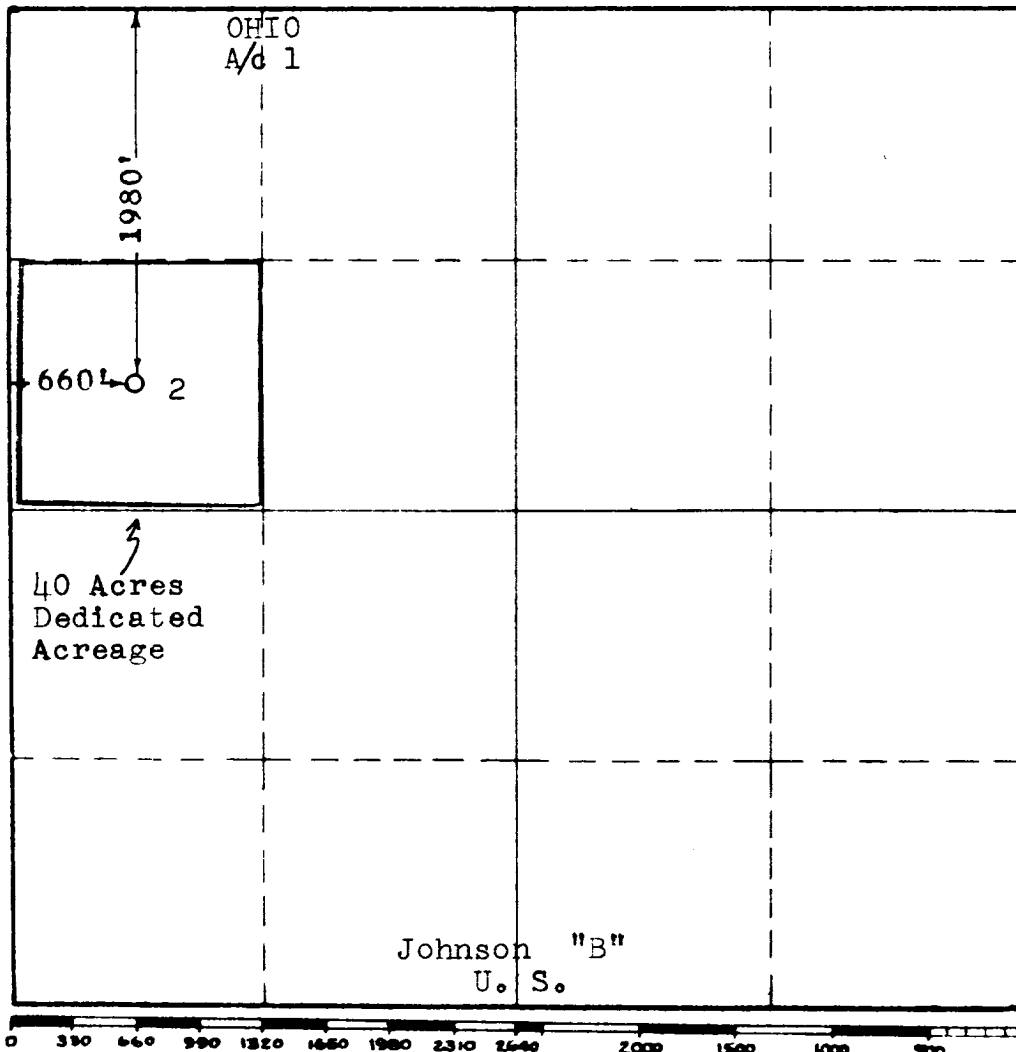

This is to certify that the information in Section A above is true and complete to the best of my knowledge and belief.

The Ohio Oil Company  
(Operator)

Thomas C. H. Hest  
(Representative)

Box 2107, Hobbs, N. M.  
Address

This is to certify that the well location shown on the plat in Section B was plotted from field notes of actual surveys made by me or under my supervision and that the same is true and correct to the best of my knowledge and belief.

Date Surveyed 11-21-57

John W. West  
Registered Professional  
Engineer and/or Land Surveyor.

Certificate No. 676