

(SUBMIT IN TRIPLICATE)

UNITED STATES

DEPARTMENT OF THE INTERIOR

GEOLOGICAL SURVEY

Land Office Las CrucesLease No. LC 029393 (b)Unit
RECEIVED

NOV 23 1962

SUNDRY NOTICES AND REPORTS ON WELLS

U. S. G.
ARTESIA, OFFICE

NOTICE OF INTENTION TO DRILL.....	<input checked="" type="checkbox"/>	SUBSEQUENT REPORT OF WATER SHUT-OFF.....	
NOTICE OF INTENTION TO CHANGE PLANS.....		SUBSEQUENT REPORT OF SHOOTING OR ACIDIZING.....	
NOTICE OF INTENTION TO TEST WATER SHUT-OFF.....		SUBSEQUENT REPORT OF ALTERING CASING.....	
NOTICE OF INTENTION TO RE-DRILL OR REPAIR WELL.....		SUBSEQUENT REPORT OF RE-DRILLING OR REPAIR.....	
NOTICE OF INTENTION TO SHOOT OR ACIDIZE.....		SUBSEQUENT REPORT OF ABANDONMENT.....	
NOTICE OF INTENTION TO PULL OR ALTER CASING.....		SUPPLEMENTARY WELL HISTORY.....	
NOTICE OF INTENTION TO ABANDON WELL.....			

(INDICATE ABOVE BY CHECK MARK NATURE OF REPORT, NOTICE, OR OTHER DATA)

November 14, 1962

Well No. 1 Watson is located 660 ft. from S line and 2310 ft. from E line of sec. 18

<u>SW/4 SE/4 sec. 18</u> ($\frac{1}{4}$ Sec. and Sec. No.)	<u>18S</u> (Twp.)	<u>31E</u> (Range)	<u>NMPM</u> (Meridian)
<u>North Shugart</u> (Field)	<u>Eddy</u> (County or Subdivision)	<u>New Mexico</u> (State or Territory)	

The elevation of the derrick floor above sea level is 3268.8 ft.

DETAILS OF WORK

(State names of and expected depths to objective sands; show sizes, weights, and lengths of proposed casings; indicate mudding jobs, cementing points, and all other important proposed work)

Set 24# 8-5/8" casing in top of salt at approximately 700' and circulate mud in front of 50 sacks of cement. Drill to an approximate total depth of 3350' to test Queen Sand. Well will be drilled with cable tools. 9-1/2# J-55 4-1/2" pipe will be run to total depth with mud circulated before 150 sacks of cement. Pipe will be perforated opposite pay zone and section fractured.

RECEIVED
NOV 16 1962
U. S. GEOLOGICAL SURVEY
ARTESIA, NEW MEXICO

I understand that this plan of work must receive approval in writing by the Geological Survey before operations may be commenced.

Company Ray SmithAddress Box 953Midland, TexasBy Ray SmithTitle Agent

NEW MEXICO OIL CONSERVATION COMMISSION
WELL LOCATION AND ACREAGE DEDICATION PLAT

FORM C-128
Revised 5/1/57

SEE INSTRUCTIONS FOR COMPLETING THIS FORM ON THE REVERSE SIDE

SECTION A

Operator RAY SMITH		Lease WATSON FEDERAL		Well No. 1
Unit Letter O	Section 18	Township 18 SOUTH	Range 31 EAST	County EDDY
Actual Footage Location of Well: 660 feet from the SOUTH line and 2310 feet from the EAST line				
Ground Level Elev. 5628.8	Producing Formation QUEEN SAND	Pool NORTH-BELGANT	Dedicated Acreage: 40 Acres	

1. Is the Operator the only owner in the dedicated acreage outlined on the plat below? YES ☒ NO ____ . ("Owner" means the person who has the right to drill into and to produce from any pool and to appropriate the production either for himself or for himself and another. (63-3-29 (e) NMSA 1935 Comp.)
2. If the answer to question one is "no," have the interests of all the owners been consolidated by communitization agreement or otherwise? YES ____ NO ____ . If answer is "yes," Type of Consolidation ____
3. If the answer to question two is "no," list all the owners and their respective interests below:

Owner	Land Description

SECTION B

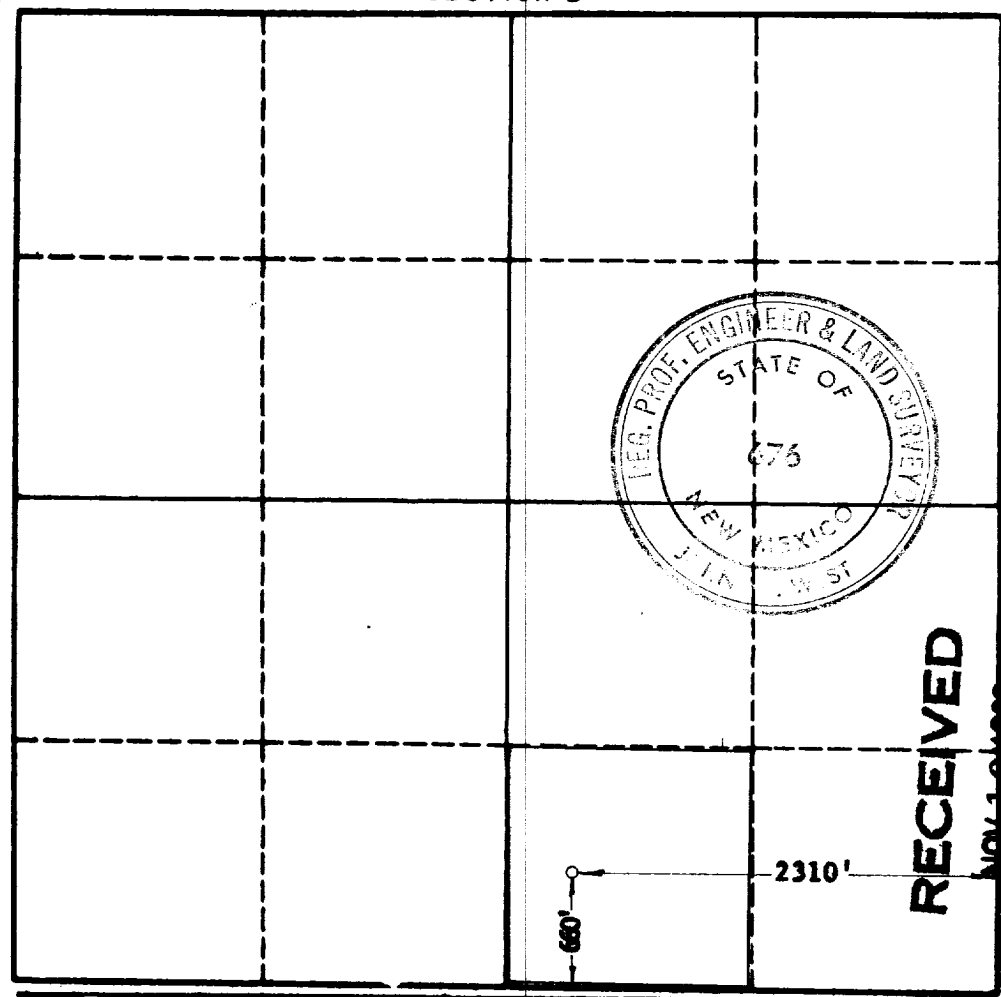

CERTIFICATION

I hereby certify that the information in SECTION A above is true and complete to the best of my knowledge and belief.

Name	Ray Smith
Position	Agent
Company	Ray Smith
Date	November 14, 1962

I hereby certify that the well location shown on the plat in SECTION B was plotted from field notes of actual survey made by me or under my supervision, and that the same is true and correct to the best of my knowledge and belief.

Surveyed	11-3-62
Registered Professional Engineer and/or Land Surveyor, JOHN W. WEST	
Certificate No. N.M. - P.E. & L.S. NO. 676	