

NEW MEXICO OIL CONSERVATION COMMISSION

WELL LOCATION AND ACREAGE DEDICATION PLAT

RECEIVED
FORM C-128
Rev. 1/57
FEB 10 1961

SEE INSTRUCTIONS FOR COMPLETING THIS FORM ON THE REVERSE SIDE

SECTION A

Operator J.J. Travis			Lease Kenwood Federal		N.M.C. ARTESIA OFFICE 2
Unit Letter D	Section 21	Township 18 South	Range 31 East	County Eddy	
Actual Footage Location of Well: 990 feet from the North line and 330 feet from the West line					
Ground Level Elev. 7640.5	Producing Formation		Pool		Dedicated Acreage: Acres

1. Is the Operator the only owner in the dedicated acreage outlined on the plat below? YES ☒ NO ☐ ("Owner" means the person who has the right to drill into and to produce from any pool and to appropriate the production either for himself or for himself and another. (65-3-29 (e) NMSA 1935 Comp.)
2. If the answer to question one is "no," have the interests of all the owners been consolidated by communitization agreement or otherwise? YES ☐ NO ☐ If answer is "yes," Type of Consolidation _____
3. If the answer to question two is "no," list all the owners and their respective interests below:

Owner	Land Description

SECTION B

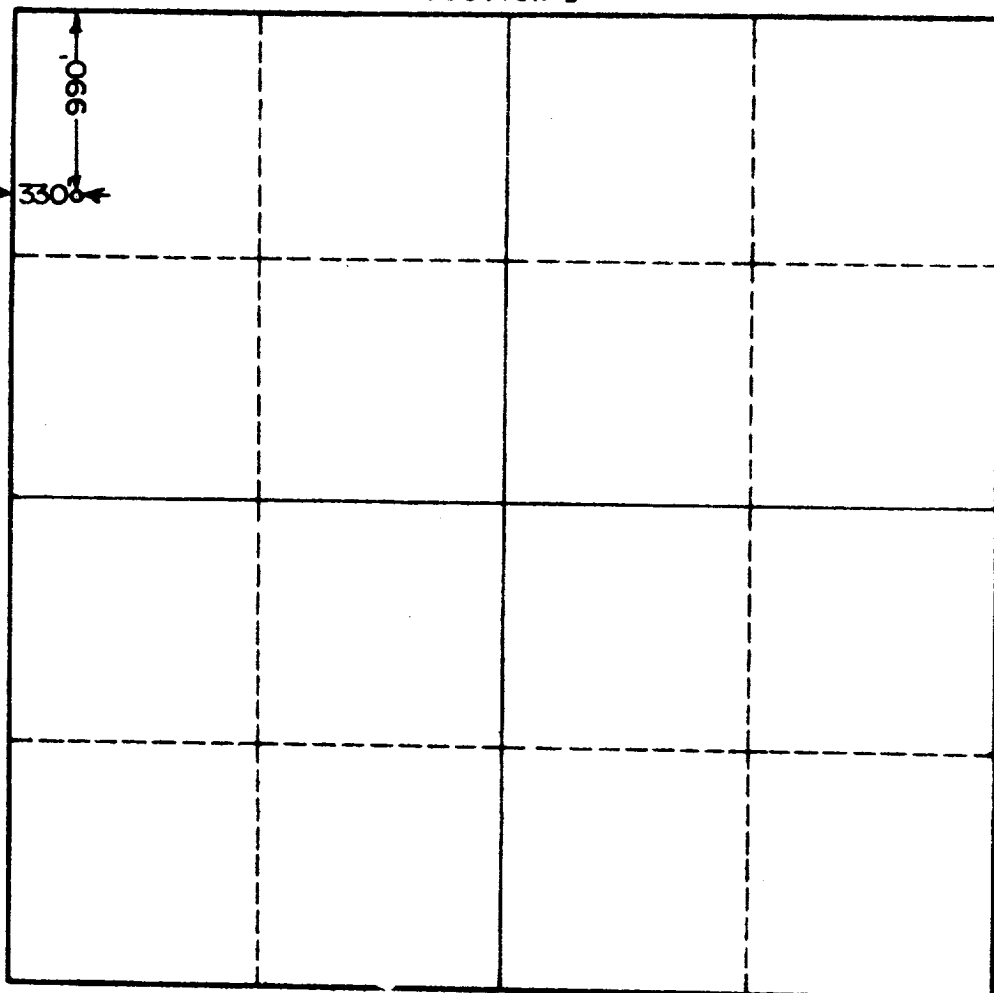

CERTIFICATION

I hereby certify that the information in SECTION A above is true and complete to the best of my knowledge and belief.

Name: J.J. Travis
 Position: Operator
 Company: Independent
 Date: 1-30-61

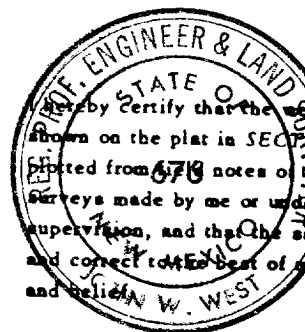

Date Surveyed: 1-30-61
 Registered Professional Engineer and/or Land Surveyor, **JOHN W. WEST**
 Certificate No. John W. West
 N.M. - P.E. & L.S. NO. 878