

Land Office **LAS CRUCES**

Lease No. **065580**

Unit **L**

(SUBMIT IN TRIPLICATE)

UNITED STATES
DEPARTMENT OF THE INTERIOR
GEOLOGICAL SURVEY

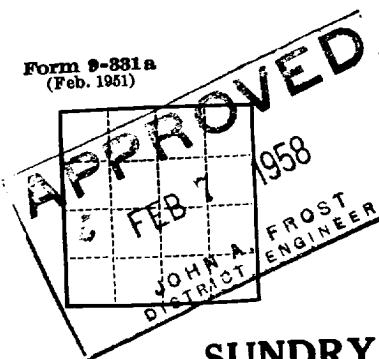

SUNDRY NOTICES AND REPORTS ON WELLS

NOTICE OF INTENTION TO DRILL	<input checked="" type="checkbox"/>	SUBSEQUENT REPORT OF WATER SHUT-OFF	
NOTICE OF INTENTION TO CHANGE PLANS		SUBSEQUENT REPORT OF SHOOTING OR ACIDIZING	
NOTICE OF INTENTION TO TEST WATER SHUT-OFF		SUBSEQUENT REPORT OF ALTERING CASING	
NOTICE OF INTENTION TO RE-DRILL OR REPAIR WELL		SUBSEQUENT REPORT OF RE-DRILLING OR REPAIR	
NOTICE OF INTENTION TO SHOOT OR ACIDIZE		SUBSEQUENT REPORT OF ABANDONMENT	
NOTICE OF INTENTION TO PULL OR ALTER CASING		SUPPLEMENTARY WELL HISTORY	
NOTICE OF INTENTION TO ABANDON WELL			

(INDICATE ABOVE BY CHECK MARK NATURE OF REPORT, NOTICE, OR OTHER DATA)

FEBRUARY 7TH, 19**56**

LEONARD
Well No. **2** is located **1650** ft. from **N** line and **330** ft. from **W** line of sec. **25**

NW 25 (1/4 Sec. and Sec. No.) **18S** (Twp.) **31E** (Range) **T. 4. N. R. 4. W.** (Meridian)
UNDESIGNATED (Field) **EDDY** (County or Subdivision) **NEW MEXICO** (State or Territory)

The elevation of the derrick floor above sea level is _____ ft.

DETAILS OF WORK

(State names of and expected depths to objective sands; show sizes, weights, and lengths of proposed casings; indicate mudding jobs, cementing points, and all other important proposed work)

EXPECT TO DRILL THE ABOVE WELL TO APPROXIMATELY 4,000 FEET. WILL SET 8-5/8" CASING AT APPROXIMATELY 900 FEET AND CEMENT WITH 50 SACKS OF CEMENT. EXPECT TO RUN 5-1/5 INCH CASING TO TOTAL DEPTH, CEMENT WITH 200 SACKS OF CEMENT, PERFORATE THE 5-1/5" CASING AND TREAT.

SHELDON PLAT ATTACHED

I understand that this plan of work must receive approval in writing by the Geological Survey before operations may be commenced.

Company **THOMAS F. WELCH,**
Address **BOX 564**
IRTESIA, NEW MEXICO

By **Thomas F. Welch**

Title **OWNER**

APPROVED

FEB 7 1958

NEW MEXICO OIL CONSERVATION COMMISSION

Well Location and Acreage Dedication Plat

Section A. JOHN A. FROST
DISTRICT ENGINEER

Date January 20, 1958

Operator T. F. WELCH Lease Right
Well No. 2 Unit Letter 1 Section 25 Township 18 South Range 31 East NMPM
Located 1650 Feet From South Line, 330 Feet From West Line
County El Paso G. L. Elevation _____ Dedicated Acreage 40 Acres
Name of Producing Formation Carbon Pool Shafter

1. Is the Operator the only owner* in the dedicated acreage outlined on the plat below?
Yes X No _____.
2. If the answer to question one is "no," have the interests of all the owners been consolidated by communitization agreement or otherwise? Yes _____ No _____. If answer is "yes," Type of Consolidation _____
3. If the answer to question two is "no," list all the owners and their respective interests below:

Owner

Land Description

Section B

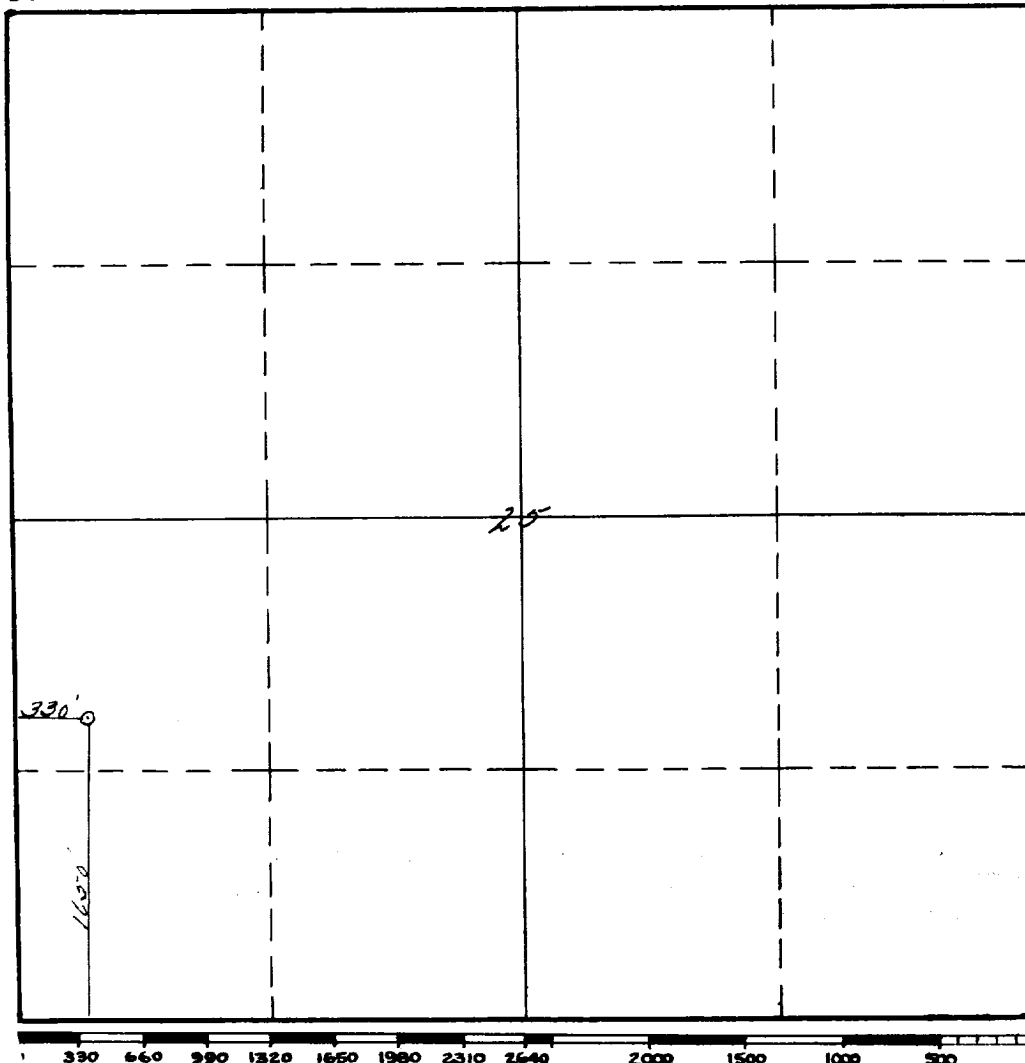

This is to certify that the information in Section A above is true and complete to the best of my knowledge and belief.

T. F. WELCH

(Operator)

Thomas F. Welch
(Representative)

P.O. Box 364

Artesia, New Mexico

Address

This is to certify that the well location shown on the plat in Section B was plotted from field notes of actual surveys made by me or under my supervision and that the same is true and correct to the best of my knowledge and belief.

Date Surveyed January 18, 1958

Edgar P. Shellen
Registered Professional
Engineer and/or Land Surveyor.

Certificate No. 963

(See instructions for completing this form on the reverse side)

INSTRUCTIONS FOR COMPLETION

1. Operator shall furnish and certify to the information called for in Section A.
2. Operator shall outline the dedicated acreage for both oil and gas wells on the plat in Section B.
3. A registered professional engineer or land surveyor registered in the State of New Mexico or approved by the Commission shall show on the plat the location of the well and certify this information in the space provided.
4. All distances shown on the plat must be from the outer boundaries of Section.
5. If additional space is needed for listing owners and their respective interests as required in question 3, Section A, please use space below

* "Owner" means the person who has the right to drill into and to produce from any pool and to appropriate the production either for himself or for himself and another. (65-3-29 (e) NMSA 1953 Comp.)