

(SUBMIT IN TRIPLICATE)

UNITED STATES
DEPARTMENT OF THE INTERIOR
GEOLOGICAL SURVEY

Land Office

Lease No.

Unit

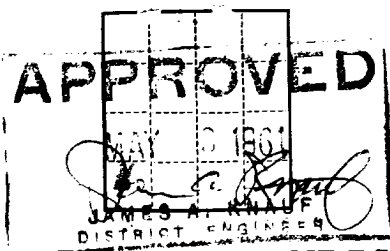

SUNDRY NOTICES AND REPORTS ON WELLS

NOTICE OF INTENTION TO DRILL	SUBSEQUENT REPORT OF WATER SHUT-OFF
NOTICE OF INTENTION TO CHANGE PLANS	SUBSEQUENT REPORT OF SHOOTING OR ACIDIZING
NOTICE OF INTENTION TO TEST WATER SHUT-OFF	SUBSEQUENT REPORT OF ALTERING CASING
NOTICE OF INTENTION TO RE-DRILL OR REPAIR WELL	SUBSEQUENT REPORT OF RE-DRILLING OR REPAIR
NOTICE OF INTENTION TO SHOOT OR ACIDIZE	SUBSEQUENT REPORT OF ABANDONMENT
NOTICE OF INTENTION TO PULL OR ALTER CASING	SUPPLEMENTARY WELL HISTORY
NOTICE OF INTENTION TO ABANDON WELL	

(INDICATE ABOVE BY CHECK MARK NATURE OF REPORT, NOTICE, OR OTHER DATA)

Well No. 5-282 is located 330 ft. from S line and 990 ft. from W line of sec. 26
SW SW Sec. 26 T8S R0E N. M. P. M.
 (1/4 Sec. and Sec. No.) (Twp.) (Range) (Meridian)
SHOOTING EDDI NEW MEXICO
 (Field) (County or Subdivision) (State or Territory)

The elevation of the derrick floor above sea level is _____ ft.

DETAILS OF WORK

(State names of and expected depths to objective sands; show sizes, weights, and lengths of proposed casings; indicate mudding jobs, cementing points, and all other important proposed work)

EXPECT TO DRILL THE ABOVE WELL TO APPROXIMATELY 2800 FEET.
 PLAN TO RUN 8-5/8" CASING TO 380 FEET AND MUD. PLAN TO
 RUN 7" CASING TO TOTAL DEPTH, PERFORATE AND TREAT AFTER
 RUNNING SUFFICIENT AMOUNT OF CEMENT TO COME UP ABOVE THE
 SALT AT LEAST 200 FEET. & WILL RUN a cement key

RECEIVED

MAY 3 1961

I understand that this plan of work must receive approval in writing by the Geological Survey before operations may be commenced.

Company THOMAS F. WELCH

P. O. BOX 564

Address ARTESIA, NEW MEXICO

By

Title

NEW MEXICO OIL CONSERVATION COMMISSION
WELL LOCATION AND ACREAGE DEDICATION PLAT

FORM C-128
 Revised 5/1/57

SEE INSTRUCTIONS FOR COMPLETING THIS FORM ON THE REVERSE SIDE

SECTION A

Operator <i>Thomas F. Angle & Son</i>		Lease <i>Hinkle "B"</i>		ARTESIA, DE WILCOX No. <i>5-248</i>	
Unit Letter <i>1</i>	Section <i>26</i>	Township <i>18N</i>	Range <i>12E</i>	County <i>ddy</i>	
Actual Footage Location of Well: <i>350</i> feet from the <i>W</i> line and <i>990</i> feet from the <i>W</i> line					
Ground Level Elev.	Producing Formation <i>UGEN</i>	Pool <i>Shugart</i>		Dedicated Acreage: <i>40</i> Acres	

1. Is the Operator the only owner in the dedicated acreage outlined on the plat below? YES *X* NO ____ . ("Owner" means the person who has the right to drill into and to produce from any pool and to appropriate the production either for himself or for himself and another. (65-3-29 (e) NMSA 1935 Comp.)
2. If the answer to question one is "no," have the interests of all the owners been consolidated by communitization agreement or otherwise? YES ____ NO ____ . If answer is "yes," Type of Consolidation _____
3. If the answer to question two is "no," list all the owners and their respective interests below:

Owner	Land Description

RECEIVED

MAY 3 1961

SECTION B

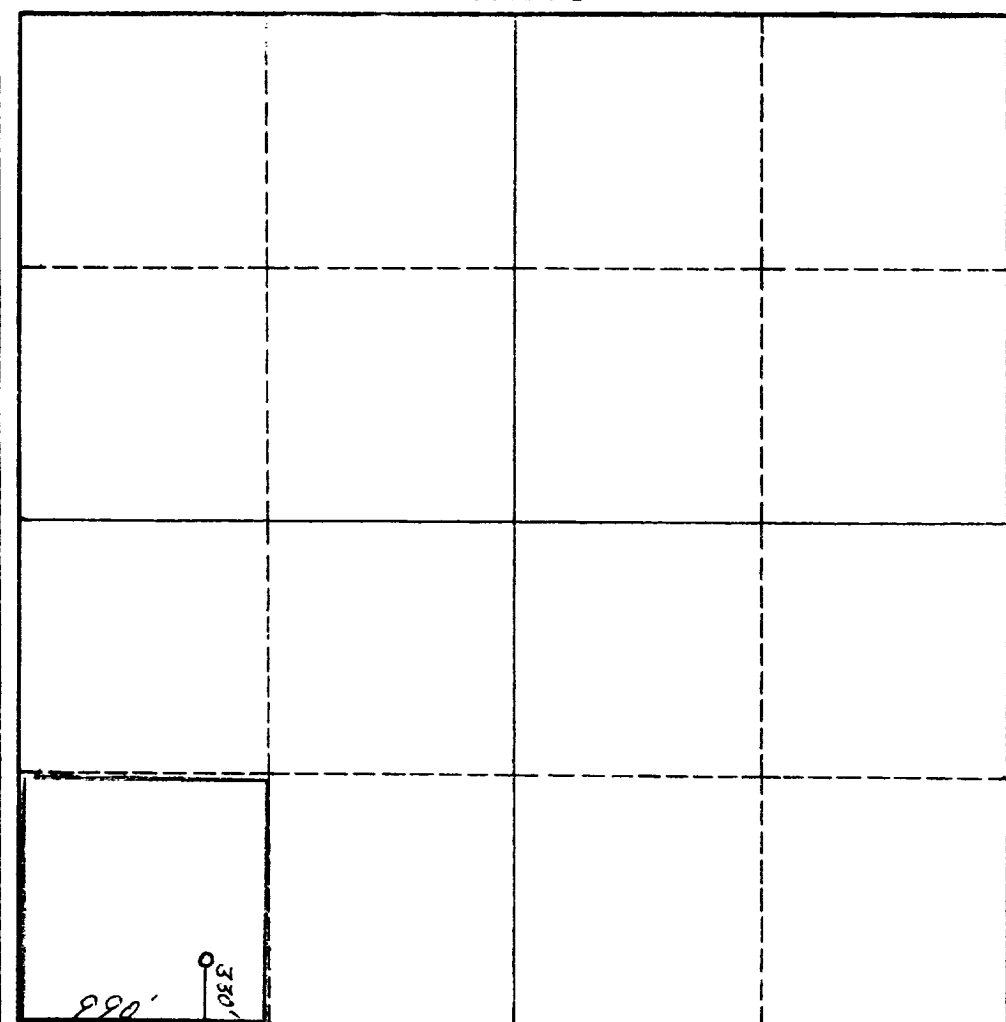

U. CERTIFICATION SURVEY

ARTESIA, NEW MEXICO

I hereby certify that the information in SECTION A above is true and complete to the best of my knowledge and belief.

Name

Position

Company

Date

I hereby certify that the well location shown on the plat in SECTION B was plotted from field notes of actual surveys made by me or under my supervision, and that the same is true and correct to the best of my knowledge and belief.

Date Surveyed

6/2/61

Registered Professional Engineer and/or Land Surveyor

Certificate No.

H. C. Yates

0 330 660 990 1320 1650 1980 2310 2640 2000 1500 1000 500 0

INSTRUCTIONS FOR COMPLETION OF FORM C-128

1. Operator shall furnish and certify to the information called for in Section A.
2. Operator shall outline the dedicated acreage for *both* oil and gas wells on the plat in Section B.
3. A registered professional engineer or land surveyor registered in the State of New Mexico or approved by the Commission shall show on the plat the location of the well and certify this information in the space provided.
4. All distances shown on the plat must be from the outer boundaries of the Section.
5. If additional space is needed for listing owners and their respective interests as required in question 3 of Section A, please use space below.