

(SUBMIT IN TRIPLICATE)

UNITED STATES  
DEPARTMENT OF THE INTERIOR  
GEOLOGICAL SURVEYLand Office *San Antonio*Lease No. *24-000-10*Unit *LC 029390(w)*

RECEIVED

FEB 20 1962

## SUNDRY NOTICES AND REPORTS ON WELLS

U. S. G. C.

ARTESIA, OFFICE

NOTICE OF INTENTION TO DRILL.....	<input checked="" type="checkbox"/>	SUBSEQUENT REPORT OF WATER SHUT-OFF.....	
NOTICE OF INTENTION TO CHANGE PLANS.....		SUBSEQUENT REPORT OF SHOOTING OR ACIDIZING.....	
NOTICE OF INTENTION TO TEST WATER SHUT-OFF.....		SUBSEQUENT REPORT OF ALTERING CASING.....	
NOTICE OF INTENTION TO RE-DRILL OR REPAIR WELL.....		SUBSEQUENT REPORT OF RE-DRILLING OR REPAIR.....	
NOTICE OF INTENTION TO SHOOT OR ACIDIZE.....		SUBSEQUENT REPORT OF ABANDONMENT.....	
NOTICE OF INTENTION TO PULL OR ALTER CASING.....		SUPPLEMENTARY WELL HISTORY.....	
NOTICE OF INTENTION TO ABANDON WELL.....			

(INDICATE ABOVE BY CHECK MARK NATURE OF REPORT, NOTICE, OR OTHER DATA)

February 14, 1962

Federal Leases et al "3"

Well No. 1 is located 1980 ft. from N line and 660 ft. from W line of sec. 28

N/4, s/4 28

(1/4 Sec. and Sec. No.)

18-2

(Twp.)

11-E

(Range)

RMPN

(Meridian)

Undesignated

(Field)

Bddy

(County or Subdivision)

New Mexico

(State or Territory)

The elevation of the derrick floor above sea level is \_\_\_\_\_ ft.

## DETAILS OF WORK

(State names of and expected depths to objective sands; show sizes, weights, and lengths of proposed casings; indicate mudding jobs, cementing points, and all other important proposed work)

It is proposed to drill to approximately 3650' with Rotary tools and complete in the Green Formation.

Hole Size	Cas. Size	Wt./ft.	How or SI	Depth	Cement
11"	8-5/8"	24#	New	250'	Circulate
7-7/8"	4-1/2"	9.5#	New	3650'	Circulate

I understand that this plan of work must receive approval in writing by the Geological Survey before operations may be commenced.

Company Gulf Oil CorporationAddress Box 2167, Hobbs, New MexicoBy J. M. RUSSELLTitle Area Production Manager

**NEW MEXICO OIL CONSERVATION COMMISSION**  
**WELL LOCATION AND ACREAGE DEDICATION PLAT**

FORM C-128  
 Revised 5/1/57

**SEE INSTRUCTIONS FOR COMPLETING THIS FORM ON THE REVERSE SIDE**

**SECTION A**

Operator <b>Gulf Oil Corp.</b>		Lease <b>Federal-Keohane "B" (40-41)</b>		Well No. <b>1</b>
Unit Letter <b>E</b>	Section <b>28</b>	Township <b>18 South</b>	Range <b>31 East</b>	County <b>Eddy</b>

Actual Footage Location of Well:  
**1980** feet from the **north** line and **660** feet from the **west** line

Ground Level Elev.	Producing Formation <b>Guan</b>	Pool <b>Undesignated</b>	Dedicated Acreage: <b>40</b> Acres
--------------------	------------------------------------	-----------------------------	---------------------------------------

1. Is the Operator the only owner in the dedicated acreage outlined on the plat below? YES ☒ NO ☐ ("Owner" means the person who has the right to drill into and to produce from any pool and to appropriate the production either for himself or for himself and another. (63-3-29 (a) NMSA 1935 Comp.)
2. If the answer to question one is "no," have the interests of all the owners been consolidated by communitization agreement or otherwise? YES ☐ NO ☐ If answer is "yes," Type of Consolidation **RECON**
3. If the answer to question two is "no," list all the owners and their respective interests below:

Owner	Land Description
	<b>FEB 15 1962</b> <b>U. S. GEOL. SURV.</b> <b>ARTESIAN</b>

**SECTION B**

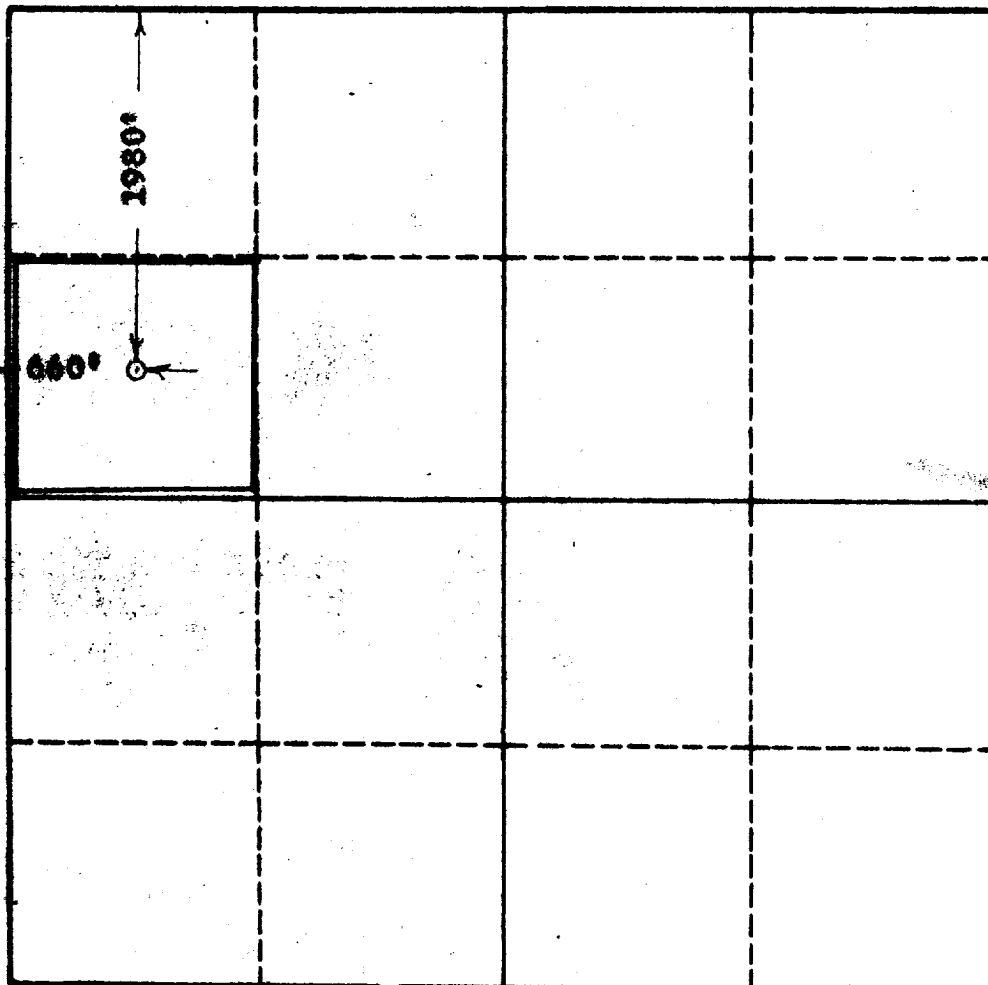

**CERTIFICATION**

I hereby certify that the information in SECTION A above is true and complete to the best of my knowledge and belief.

Name <b>J. M. RUSSELL</b>
Position <b>Area Production Manager</b>
Company <b>Gulf Oil Corporation</b>
Date <b>February 16, 1962</b>

I hereby certify that the well location shown on the plat in SECTION B was plotted from field notes of actual survey made by **676** under my supervision, and that the same is true and correct to the best of my knowledge and belief.

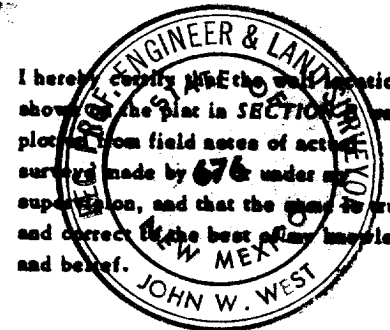

Date Surveyed <b>Jan. 31, 1962</b>
Registered Professional Engineer and/or Land Surveyor, <b>JOHN W. WEST</b>
Certificate No. <b>N.M. - P.E. &amp; L.S. NO. 676</b>

0 330 660 990 1320 1650 1980 2310 2640 2970 3300 3630 3960 4290 4620 4950 5280 5610 5940 6270 6600