

(SUBMIT IN TRIPLICATE)

UNITED STATES
DEPARTMENT OF THE INTERIOR
GEOLOGICAL SURVEY

Land Office New MexicoLease No. 10-729390-4 (Case)

Unit _____

RECEIVED

FEB 22 1962

SUNDRY NOTICES AND REPORTS ON WELLS

NOTICE OF INTENTION TO DRILL	<input checked="" type="checkbox"/>	SUBSEQUENT REPORT OF WATER SHUT-OFF	<input type="checkbox"/>
NOTICE OF INTENTION TO CHANGE PLANS	<input type="checkbox"/>	SUBSEQUENT REPORT OF SHOOTING OR ACIDIZING	<input type="checkbox"/>
NOTICE OF INTENTION TO TEST WATER SHUT-OFF	<input type="checkbox"/>	SUBSEQUENT REPORT OF ALTERING CASING	<input type="checkbox"/>
NOTICE OF INTENTION TO RE-DRILL OR REPAIR WELL	<input type="checkbox"/>	SUBSEQUENT REPORT OF RE-DRILLING OR REPAIR	<input type="checkbox"/>
NOTICE OF INTENTION TO SHOOT OR ACIDIZE	<input type="checkbox"/>	SUBSEQUENT REPORT OF ABANDONMENT	<input type="checkbox"/>
NOTICE OF INTENTION TO PULL OR ALTER CASING	<input type="checkbox"/>	SUPPLEMENTARY WELL HISTORY	<input type="checkbox"/>
NOTICE OF INTENTION TO ABANDON WELL	<input type="checkbox"/>		<input type="checkbox"/>

(INDICATE ABOVE BY CHECK MARK NATURE OF REPORT, NOTICE, OR OTHER DATA)

February 19, 1962

Federal Keokano et al "B"

Well No. 3 is located 1980 ft. from N line and 1980 ft. from W line of sec. 20

SE 1/4, sec 20

(1/4 Sec. and Sec. No.)

18-8

(Twp.)

31-1

(Range)

NHPN

(Meridian)

Shogert

(Field)

Hidy

(County or Subdivision)

New Mexico

(State or Territory)

The elevation of the derrick floor above sea level is _____ ft.

DETAILS OF WORK

(State names of and expected depths to objective sands; show sizes, weights, and lengths of proposed casings; indicate mudding jobs, cementing points, and all other important proposed work)

FEB 20 1962
U. S. GEOLOGICAL SURVEY
ARTESIA, NEW MEXICO

It is proposed to drill to approximately 3400' with Rotary tools and complete in the Queen formation.

Hole Size	Csg. Size	Wt./ft.	New or SH	Depth	Cement
11"	8-5/8"	21#	New	250'	Circulate
7-7/8"	4-1/2"	9.5#	New	3400'	Circulate

I understand that this plan of work must receive approval in writing by the Geological Survey before operations may be commenced.

Company Gulf Oil CorporationAddress Box 2167, Hobbs,New MexicoLOCAL SIGNED
-BY-

J. M. RUSSELL

By _____

Title Area Production Manager

NEW MEXICO OIL CONSERVATION COMMISSION
WELL LOCATION AND ACREAGE DEDICATION PLAT

FORM C-128
Revised 5/1/57

SEE INSTRUCTIONS FOR COMPLETING THIS FORM ON THE REVERSE SIDE

SECTION A

Operator Gulf Oil Corp.		Lease Federal-Keohane "B" (et al)		Well No. 3
Unit Letter F	Section 28	Township 18 South	Range 31 East	County Eddy
Actual Footage Location of Well: 1980 feet from the west line and 1980 feet from the north line				
Ground Level Elev.	Producing Formation Quatern	Pool Shagert	Dedicated Acreage: 50 Acres	

1. Is the Operator the only owner in the dedicated acreage outlined on the plat below? YES _____ NO _____. ("Owner" means the person who has the right to drill into and to produce from any pool and to appropriate the production either for himself or for himself and another. (65-3-29 (e) NMSA 1935 Comp.)
2. If the answer to question one is "no," have the interests of all the owners been consolidated by communitization agreement or otherwise? YES _____ NO _____. If answer is "yes," Type of Consolidation _____
3. If the answer to question two is "no," list all the owners and their respective interests below:

RECEIVED

Owner	Land Description	FEB 20 1962
		U. S. GEOLOGICAL SURVEY
		ARTESIA, NEW MEXICO

SECTION B

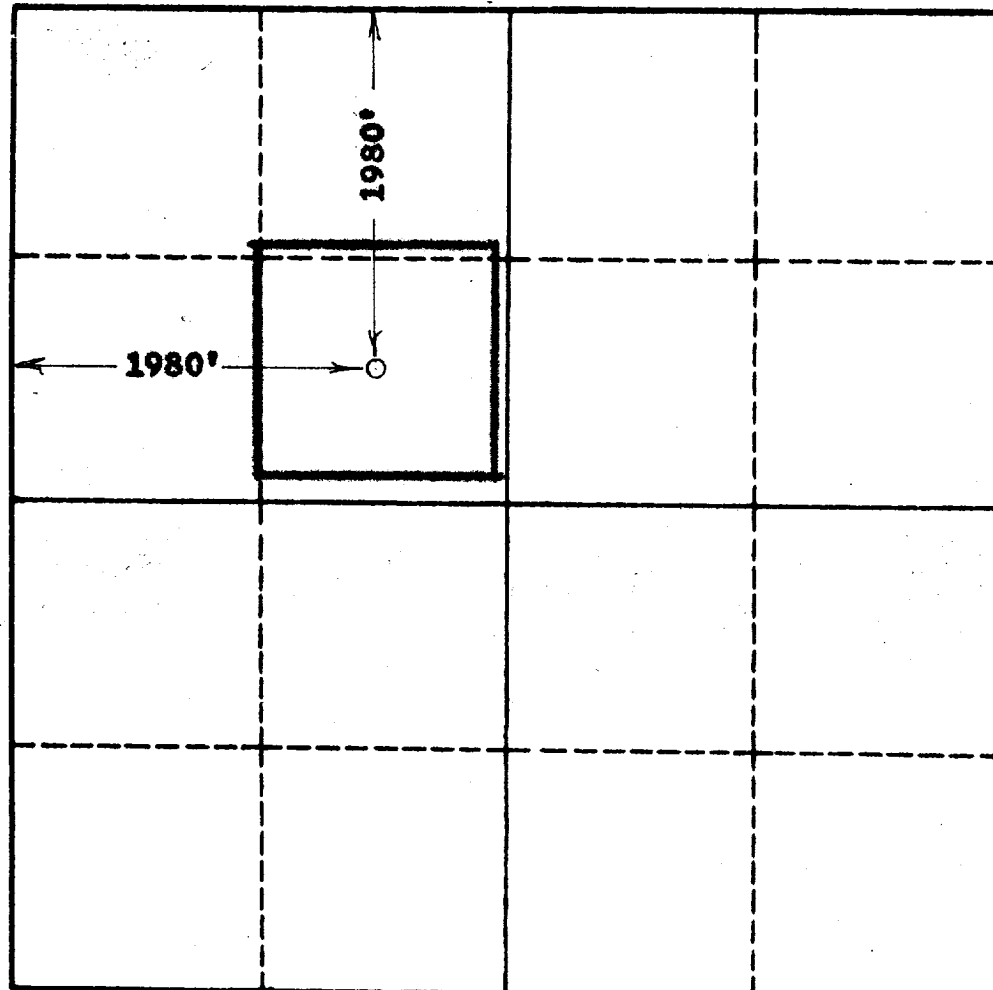

CERTIFICATION

I hereby certify that the information in SECTION A above is true and complete to the best of my knowledge and belief.

ORIGINAL SIGNED
-BY-

Name **J. M. RUSSELL**

Position **Area Production Manager**

Company **Gulf Oil Corporation**

Date **February 19, 1962**

I hereby certify that the well location shown on the plat in SECTION B was plotted from field notes of actual surveys made by me or under my supervision, and that the same is true and correct to the best of my knowledge and belief.

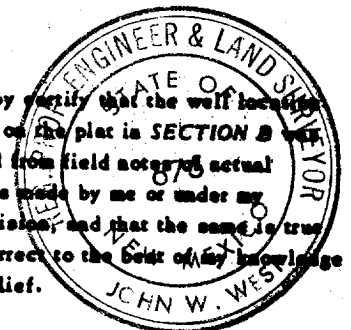

Date Surveyed Jan 31, 1962
Registered Professional Engineer and/or Land Surveyor, JOHN W. WEST
Certificate No. N. M. - P. E. & L. S. NO. 676

0 330 660 990 1320 1650 1980 2310 2640 2000 1500 1000 500 0