

(SUBMIT IN TRIPLICATE)

UNITED STATES
DEPARTMENT OF THE INTERIOR
GEOLOGICAL SURVEYLand Office **LAS CRUCES**
Lease No. **029387 (4) (C)**
Unit **J**
RECEIVED
MAR 2 1961
D. E. D.
ARTESIA, NEW MEX.

SUNDRY NOTICES AND REPORTS ON WELLS

NOTICE OF INTENTION TO DRILL.....	<input checked="" type="checkbox"/>	SUBSEQUENT REPORT OF WATER SHUT-OFF.....	
NOTICE OF INTENTION TO CHANGE PLANS.....		SUBSEQUENT REPORT OF SHOOTING OR ACIDIZING.....	
NOTICE OF INTENTION TO TEST WATER SHUT-OFF.....		SUBSEQUENT REPORT OF ALTERING CASING.....	
NOTICE OF INTENTION TO RE-DRILL OR REPAIR WELL.....		SUBSEQUENT REPORT OF RE-DRILLING OR REPAIR.....	
NOTICE OF INTENTION TO SHOOT OR ACIDIZE.....		SUBSEQUENT REPORT OF ABANDONMENT.....	
NOTICE OF INTENTION TO PULL OR ALTER CASING.....		SUPPLEMENTARY WELL HISTORY.....	
NOTICE OF INTENTION TO ABANDON WELL.....			

(INDICATE ABOVE BY CHECK MARK NATURE OF REPORT, NOTICE, OR OTHER DATA)

FEBRUARY 23, 19 **61**

SHUGART ^H
Well No. **4-6** is located **1650** ft. from **{N}** line and **2310** ft. from **{E}** line of sec. **29**
NW SE Sec. 29 **18S** **31E** **N. M. P. M.**
(¹/₄ Sec. and Sec. No.) (Twp.) (Range) (Meridian)
SHUGART **EDDY** **NEW MEXICO**
(Field) (County or Subdivision) (State or Territory)

The elevation of the derrick floor above sea level is _____ ft.

DETAILS OF WORK

(State names of and expected depths to objective sands; show sizes, weights, and lengths of proposed casings; indicate mudding jobs, cementing points, and all other important proposed work)

PLAN TO DRILL WITH CABLE TOOLS TO APPROXIMATELY 2800 FEET. EXPECT TO RUN APPROXIMATELY 800 FEET OF 8-5/8" CASING AND CEMENT WITH 50 SACKS. EXPECT TO RUN 7" TO TOTAL DEPTH, CEMENT WITH 100 SACKS, PERFORATE AND TREAT.

I understand that this plan of work must receive approval in writing by the Geological Survey before operations may be commenced.

Company **IVERSON & WELCH**
DRAWER W
Address **ARTESIA, NEW MEXICO****RECEIVED****FEB 24 1961**U. S. GEOLOGICAL SURVEY
ARTESIA

By

Title

AGENT

NEW MEXICO OIL CONSERVATION COMMISSION
WELL LOCATION AND ACRES DEDICATION PLAT

RECEIVED
FORM C-128
Revised 5/1/57
MAR 2

SEE INSTRUCTIONS FOR COMPLETING THIS FORM ON THE REVERSE SIDE

SECTION A

Operator Iverson and Welch		Lease Segment A		Well No. 4-8	
Unit Letter J	Section 29	Township 18 N	Range 31 E	County Blair	
Actual Footage Location of Well: 1650 feet from the South line and 2310 feet from the East line					
Ground Level Elev.	Producing Formation	Pool	Dedicated Acreage: Acres		

1. Is the Operator the only owner in the dedicated acreage outlined on the plat below? YES _____ NO _____. ("Owner" means the person who has the right to drill into and to produce from any pool and to appropriate the production either for himself or for himself and another. (65-3-29 (e) NMSA 1935 Comp.)
2. If the answer to question one is "no," have the interests of all the owners been consolidated by communitization agreement or otherwise? YES _____ NO _____. If answer is "yes," Type of Consolidation _____
3. If the answer to question two is "no," list all the owners and their respective interests below:

Owner	Land Description

SECTION B

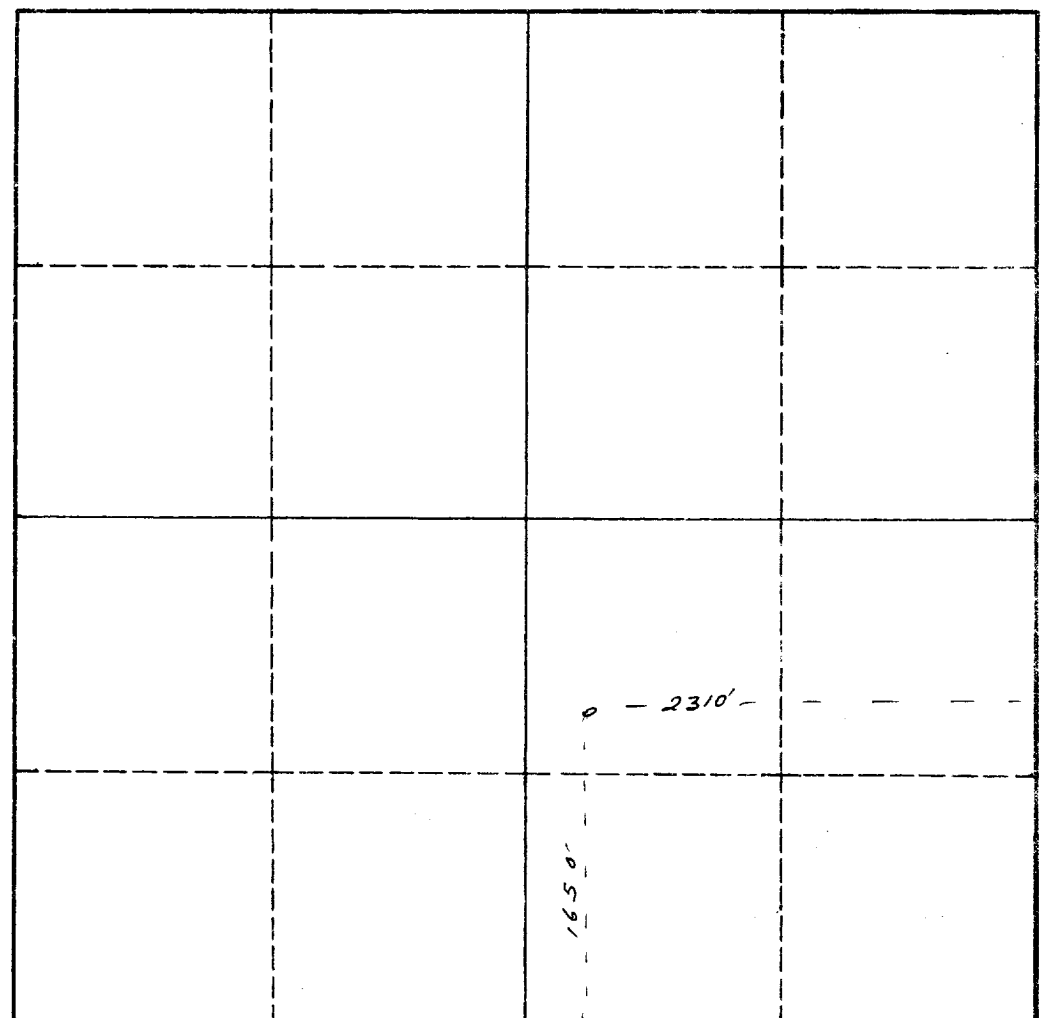

CERTIFICATION

I hereby certify that the information in SECTION A above is true and complete to the best of my knowledge and belief.

Name	<i>[Signature]</i>
Position	AGENT
Company	Iverson & Welch
Date	

I hereby certify that the well location shown on the plat in SECTION B was plotted from field notes of actual surveys made by me or under my supervision, and that the same is true and correct to the best of my knowledge and belief.

Date Surveyed	Jan. 10, 1962
Registered Professional Engineer and/or Land Surveyor	<i>[Signature]</i>
Certificate No.	963

0 330 660 990 1320 1650 1980 2310 2640 2000 1500 1000 500 0

INSTRUCTIONS FOR COMPLETION OF FORM C-128

1. Operator shall furnish and certify to the information called for in Section A.
2. Operator shall outline the dedicated acreage for *both* oil and gas wells on the plat in Section B.
3. A registered professional engineer or land surveyor registered in the State of New Mexico or approved by the Commission shall show on the plat the location of the well and certify this information in the space provided.
4. All distances shown on the plat must be from the outer boundaries of the Section.
5. If additional space is needed for listing owners and their respective interests as required in question 3 of Section A, please use space below.