

(SUBMIT IN TRIPLICATE)

UNITED STATES
DEPARTMENT OF THE INTERIOR
GEOLOGICAL SURVEYLand Office **LAS CRUCES**Lease No. **630387 (b)**Unit **1****RECEIVED**

JAN 19 1961

D. C. C.
ARTESIA, OFFICE

SUNDRY NOTICES AND REPORTS ON WELLS

NOTICE OF INTENTION TO DRILL	2	SUBSEQUENT REPORT OF WATER SHUT-OFF	
NOTICE OF INTENTION TO CHANGE PLANS		SUBSEQUENT REPORT OF SHOOTING OR ACIDIZING	
NOTICE OF INTENTION TO TEST WATER SHUT-OFF		SUBSEQUENT REPORT OF ALTERING CASING	
NOTICE OF INTENTION TO RE-DRILL OR REPAIR WELL		SUBSEQUENT REPORT OF RE-DRILLING OR REPAIR	
NOTICE OF INTENTION TO SHOOT OR ACIDIZE		SUBSEQUENT REPORT OF ABANDONMENT	
NOTICE OF INTENTION TO PULL OR ALTER CASING		SUPPLEMENTARY WELL HISTORY	
NOTICE OF INTENTION TO ABANDON WELL			

(INDICATE ABOVE BY CHECK MARK NATURE OF REPORT, NOTICE, OR OTHER DATA)

JANUARY 13TH

19 61

SHUGART

Well No. **C-3** is located **1650** ft. from **N** line and **530** ft. from **E** line of sec. **30****NE SE Sec. 30**

(1/4 Sec. and Sec. No.)

103

(Twp.)

S1E

(Range)

N.M.P.M.

(Meridian)

UNDESIGNATED

(Field)

EDDY

(County or Subdivision)

NEW MEXICO

(State or Territory)

The elevation of the derrick floor above sea level is _____ ft.

DETAILS OF WORK

(State names of and expected depths to objective sands; show sizes, weights, and lengths of proposed casings; indicate mudding jobs, cementing points, and all other important proposed work)

PLAN TO DRILL THIS WELL TO APPROXIMATELY 3700 FEET. WILL RUN APPROXIMATELY 750 FEET OF 8-5/8" CASING AND CEMENT WITH 50 BAGS. EXPECT TO RUN 7" CASING TO TOTAL DEPTH, PERFORATE AND SANDFILL AFTER CEMENTING THE 7" WITH 100 BAGS.

(V.P. SHELDON PLAT ATTACHED)

RECEIVED

JAN 19 1961

U. S. GEOLOGICAL SURVEY
NEW MEXICO

I understand that this plan of work must receive approval in writing by the Geological Survey before operations may be commenced.

Company **IVERSON & WELCH****P. O. DRAPER**Address **ARTESIA, NEW MEXICO**By Title **AGENT**

NEW MEXICO OIL CONSERVATION COMMISSION
WELL LOCATION AND ACREAGE DEDICATION PLAT

FORM C-128
 Revised 5/1/57

SEE INSTRUCTIONS FOR COMPLETING THIS FORM ON THE REVERSE SIDE

SECTION A

Operator V. S. Welch		Lease Shugart "C"		Well No. 0-5-3
Unit Letter I	Section 30	Township 13 S	Range 31 E	County Eddy
Actual Footage Location of Well: 1650 feet from the S line and 330 feet from the E line				
Ground Level Elev.	Producing Formation Yates-Queen	Pool Shugart	Dedicated Acreage: 40 Acres	

1. Is the Operator the only owner in the dedicated acreage outlined on the plat below? YES ☒ NO ____ . ("Owner" means the person who has the right to drill into and to produce from any pool and to appropriate the production either for himself or for himself and another. (65-3-29 (e) NMSA 1935 Comp.)
2. If the answer to question one is "no," have the interests of all the owners been consolidated by communitization agreement or otherwise? YES ____ NO ____ . If answer is "yes," Type of Consolidation ____
3. If the answer to question two is "no," list all the owners and their respective interests below:

Owner	Land Description

SECTION B

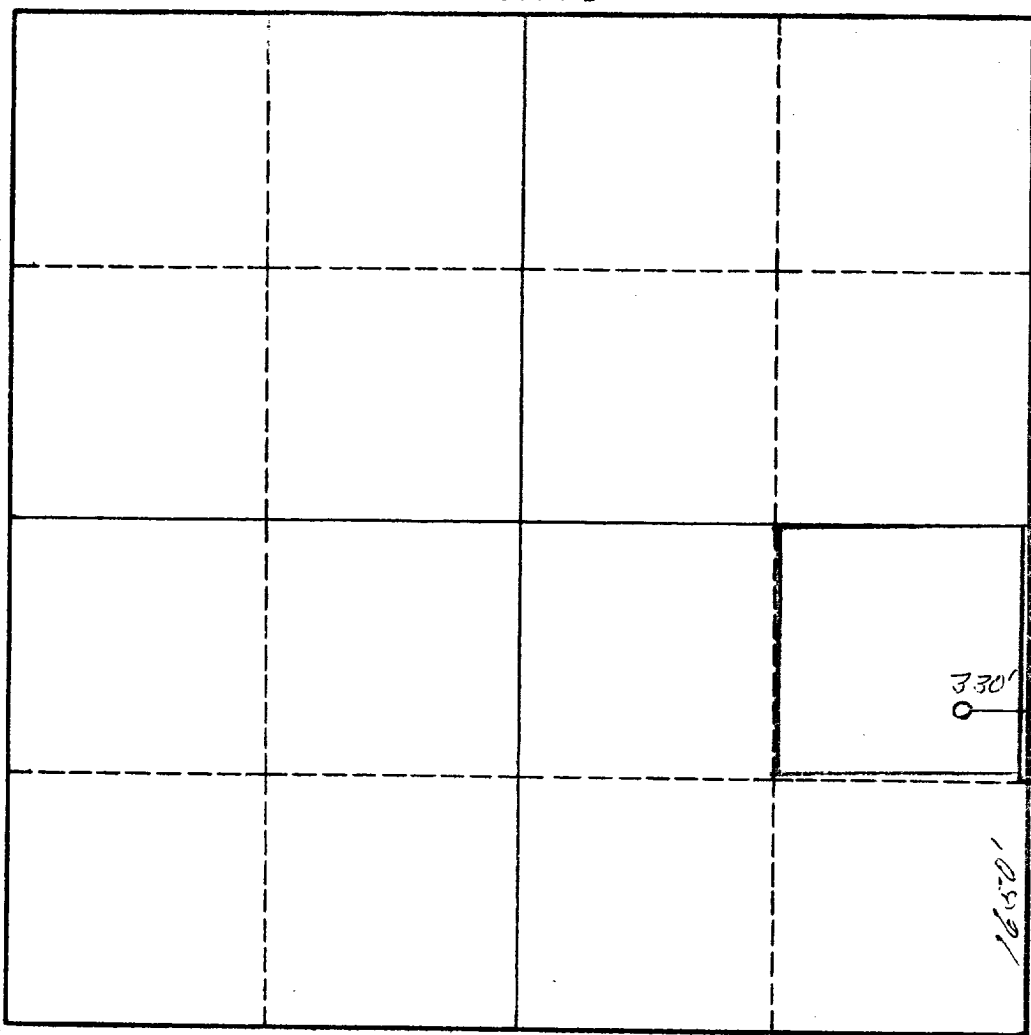

CERTIFICATION

I hereby certify that the information in SECTION A above is true and complete to the best of my knowledge and belief.

Name	<i>Lee Ann Adams</i>
Position	<i>Agent</i>
Company	<i>Johnson & Welch</i>
Date	<i>1-13-61</i>

I hereby certify that the well location shown on the plat in SECTION B was plotted from field notes of actual surveys made by me or under my supervision, and that the same is true and correct to the best of my knowledge and belief.

Date Surveyed	<i>1/12/61</i>
Registered Professional Engineer and/or Land Surveyor	<i>W. P. Sheldor</i>
Certificate No.	<i>963</i>

0 330 660 990 1320 1650 1980 2310 2640 2000 1500 1000 500 0

INSTRUCTIONS FOR COMPLETION OF FORM C-128

1. Operator shall furnish and certify to the information called for in Section A.
2. Operator shall outline the dedicated acreage for *both* oil and gas wells on the plat in Section B.
3. A registered professional engineer or land surveyor registered in the State of New Mexico or approved by the Commission shall show on the plat the location of the well and certify this information in the space provided.
4. All distances shown on the plat must be from the outer boundaries of the Section.
5. If additional space is needed for listing owners and their respective interests as required in question 3 of Section A, please use space below.