

NEW MEXICO OIL CONSERVATION COMMISSION  
Santa Fe, New Mexico

RECEIVED  
Form O-101  
Revised (12/1/55)  
AUG 3 1961

NOTICE OF INTENTION TO DRILL

Notice must be given to the District Office of the Oil Conservation Commission and approval obtained before drilling or recompletion begins. If changes in the proposed plan are considered advisable, a copy of this notice showing such changes will be returned to the sender. Submit this notice in QUINTUPLICATE. One copy will be returned following approval. See additional instructions in Rules and Regulations of the Commission. If State Land submit 6 Copies Attach Form C-128 in triplicate to first 3 copies of form C-101

Midland Texas  
(Place)

August 2, 1961  
(Date)

OIL CONSERVATION COMMISSION  
SANTA FE, NEW MEXICO

Gentlemen:

You are hereby notified that it is our intention to commence the Drilling of a well to be known as

W. E. BAKKE, OPERATOR

(Company or Operator)

MONTEREY - STATE  
(Lessee)

Well No. L-1

in J (Unit)

The well is

located 2130 feet from the SOUTH line and 1980 feet from the

EAST line of Section 32, T18 SOUTH, R31 EAST, NMPM.

(GIVE LOCATION FROM SECTION LINE) CULWIN Und Pool, EDDY County

E - 6947

If State Land the Oil and Gas Lease is No.

If patented land the owner is

Address

We propose to drill well with drilling equipment as follows: CABLE TOOLS FROM SURFACE TO TOTAL DEPTH.

The status of plugging bond is APPROVED 7-2-61

Drilling Contractor Tom Boyd Drilling Co. Inc.

We intend to complete this well in the YATES LAND, INITIALLY

formation at an approximate depth of 2750 TO 3700 feet.

CASING PROGRAM

We propose to use the following strings of Casing and to cement them as indicated:

Size of Hole	Size of Casing	Weight per Foot	New or Second Hand	Depth	Sacks Cement
10"	8 5/8"	24 lb	Second Hand	900'	150
8"	4 1/2"	9 lb	New	3700	To Cover Red Sand

If changes in the above plans become advisable we will notify you immediately.

ADDITIONAL INFORMATION (If recompletion give full details of proposed plan of work.)

Approved on AUG 3, 1961, 19  
Except as follows:

Sincerely yours,

W. E. BAKKE, OPERATOR  
(Company or Operator)

By BRYANT HEAD

Position PRODUCTION SUPT.

Send Communications regarding well to

Name BAKKE & WARD

Address DRAWER 231, MIDLAND, TEXAS

OIL CONSERVATION COMMISSION

By

M L Armstrong

RECEIVED

NEW MEXICO OIL CONSERVATION COMMISSION  
WELL LOCATION AND ACREAGE DEDICATION PLATFORM C-128  
5/1/57

AUG 3 1961

SEE INSTRUCTIONS FOR COMPLETING THIS FORM ON THE REVERSE SIDE

D. C. B.  
ARTEZIA, OFFICE

## SECTION A

Operator <del>W. E. BAKKE, OPERATOR</del> <del>W. E. BAKKE, OPERATOR</del>	Lease <b>Monterey State</b>	Well No. <b>1J</b>		
Unit Letter <b>J</b>	Section <b>32</b>	Township <b>18 South</b>	Range <b>31 East</b>	County <b>Eddy</b>
Actual Footage Location of Well: <b>2130</b> feet from the <b>South</b> line and <b>1980</b> feet from the <b>East</b> line				
Ground Level Elev. <b>3583.1</b>	Producing Formation <b>YATES &amp; QUEEN</b>	Pool <b>CULWIN</b>	Dedicated Acreage: <b>40</b> Acres	

1. Is the Operator the only owner in the dedicated acreage outlined on the plat below? YES \_\_\_\_\_ NO X. ("Owner" means the person who has the right to drill into and to produce from any pool and to appropriate the production either for himself or for himself and another. (53-3-29 (e) NMSA 1935 Comp.)
2. If the answer to question one is "no," have the interests of all the owners been consolidated by communization agreement or otherwise? YES X NO \_\_\_\_\_. If answer is "yes," Type of Consolidation OPERATING AGREEMENT & ASSIGNMENT
3. If the answer to question two is "no," list all the owners and their respective interests below:

Owner	Land Description

## SECTION B

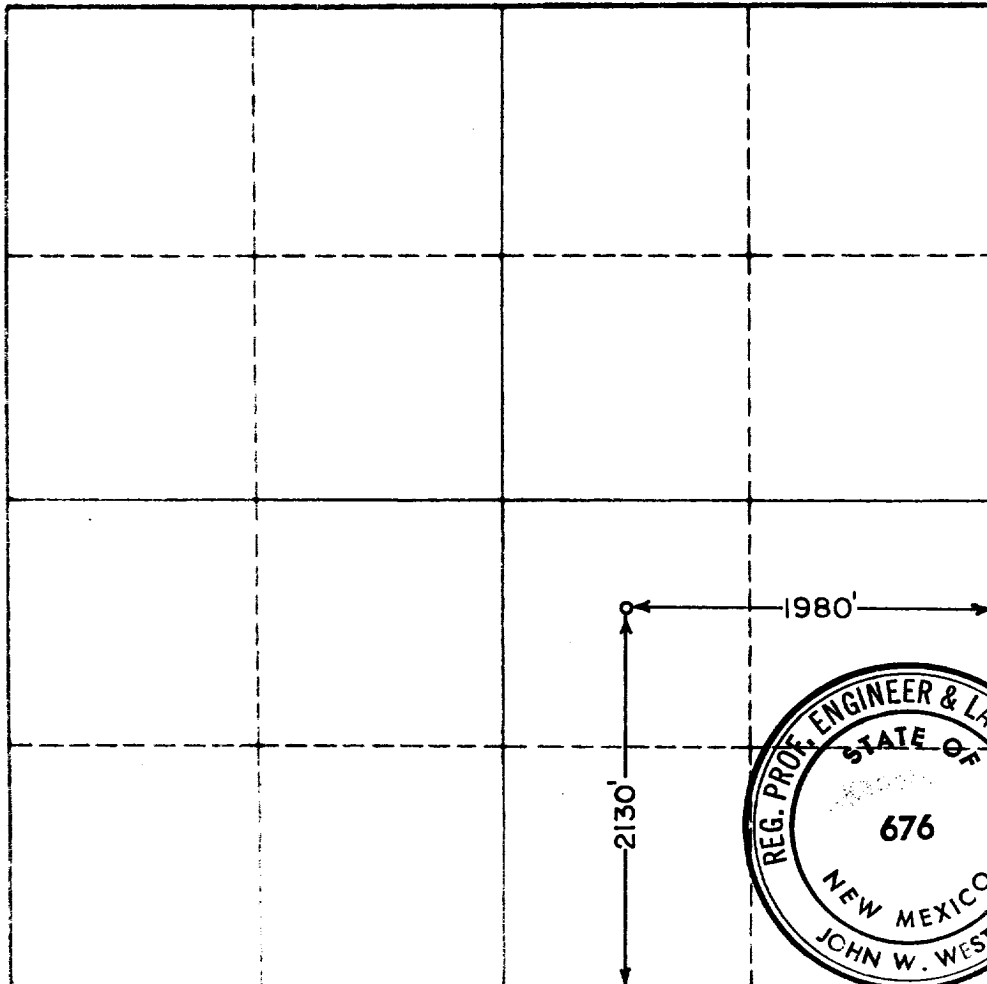

## CERTIFICATION

I hereby certify that the information in SECTION A above is true and complete to the best of my knowledge and belief.

Name <b>G. B. HEAD</b>
Position <b>PRODUCTION SUPERINTENDENT</b>
Company <b>W. E. BAKKE, OPERATOR</b>
Date <b>8-1-61</b>

I hereby certify that the well location shown on the plat in SECTION B was plotted from field notes of actual surveys made by me or under my supervision, and that the same is true and correct to the best of my knowledge and belief.

Date Surveyed <b>7-26-61</b>
Registered Professional Engineer and/or Land Surveyor, <b>JOHN W. WEST</b>
Certificate No. <b>N.M. - P.E. &amp; L.S. NO. 676</b>

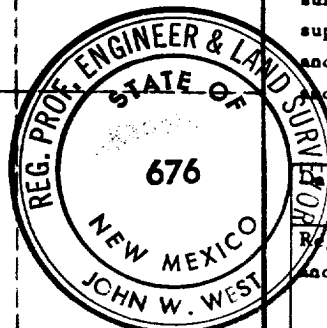

OIL CONSERVATION COMMISSION  
ARTESIA DISTRICT OFFICE

No. Copies Received

6

DISTRIBUTION

	NO. FURNISHED	
OPERATOR	1	
SANTA FE	1	
PRORATION OFFICE	1	
STATE LAND OFFICE	1	
U. S. G. S.	2	
TRANSPORTER		
FILE	1	✓
BUREAU OF MINES		