

(SUBMIT IN TRIPLICATE)

UNITED STATES
DEPARTMENT OF THE INTERIOR
GEOLOGICAL SURVEY

227 Bureau No. 42-R358.4
Land Office **029392**
Lease No. **7**
Unit **1**
JUL 24 1957

Oil Cons. Comm.
ARTESIA OFFICE

SUNDRY NOTICES AND REPORTS ON WELLS

NOTICE OF INTENTION TO DRILL.....	SUBSEQUENT REPORT OF WATER SHUT-OFF.....
NOTICE OF INTENTION TO CHANGE PLANS.....	SUBSEQUENT REPORT OF SHOOTING OR ACIDIZING.....
NOTICE OF INTENTION TO TEST WATER SHUT-OFF.....	SUBSEQUENT REPORT OF ALTERING CASING.....
NOTICE OF INTENTION TO RE-DRILL OR REPAIR WELL.....	SUBSEQUENT REPORT OF RE-DRILLING OR REPAIR.....
NOTICE OF INTENTION TO SHOOT OR ACIDIZE.....	SUBSEQUENT REPORT OF ABANDONMENT.....
NOTICE OF INTENTION TO PULL OR ALTER CASING.....	SUPPLEMENTARY WELL HISTORY.....
NOTICE OF INTENTION TO ABANDON WELL.....	

(INDICATE ABOVE BY CHECK MARK NATURE OF REPORT, NOTICE, OR OTHER DATA)

APRIL 13TH, 19**57**

HINKLE **2310**
Well No. **6-4** is located **350** ft. from **N** line and **330** ft. from **E** line of sec. **34**
SENE Sec. 34 **18S** **31E** **N. M. P. M.**
(1/4 Sec. and Sec. No.) (Twp.) (Range) (Meridian)
SHUGART **EDDY** **NEW MEXICO**
(Field) (County or Subdivision) (State or Territory)

The elevation of the derrick floor above sea level is ft.

DETAILS OF WORK

(State names of and expected depths to objective sands; show sizes, weights, and lengths of proposed casings; indicate mudding jobs, cementing points, and all other important proposed work)

PLAN TO RUN 900 FEET OF 8 INCH CASING AND CEMENT WITH 50 SACKS.

PLAN TO RUN APPROXIMATELY 3500 FEET OF 7 INCH CASING AND CEMENT WITH 100 SACKS. EXPECT TO PERFORATE AND SANDFRAC THROUGH THE 7 INCH CASING.

V. P. SHELDON PLAT ATTACHED.

I understand that this plan of work must receive approval in writing by the Geological Survey before operations may be commenced.

Company **KEOHANE SAUNDERS WELCH & IVINSON**
BOX 1392
Address **ARTESIA, NEW MEXICO.**

By
Title **AGENT**

NEW MEXICO
OIL CONSERVATION COMMISSION

Form C-128

Well Location and/or Gas Proration Plat

Date April 10, 1957

Operator Neohane, Saunders et al Lease Hinkle "A"

Well No. 6 Section 34 Township 18S Range 31E NMPM

Located 2310 Feet From North Line, 330 Feet From East Line,

Eddy County, New Mexico. G. L. Elevation _____

Name of Producing Formation Queen Pool Shugart Dedicated Acreage 40

(Note: All distances must be from outer boundaries of Section)

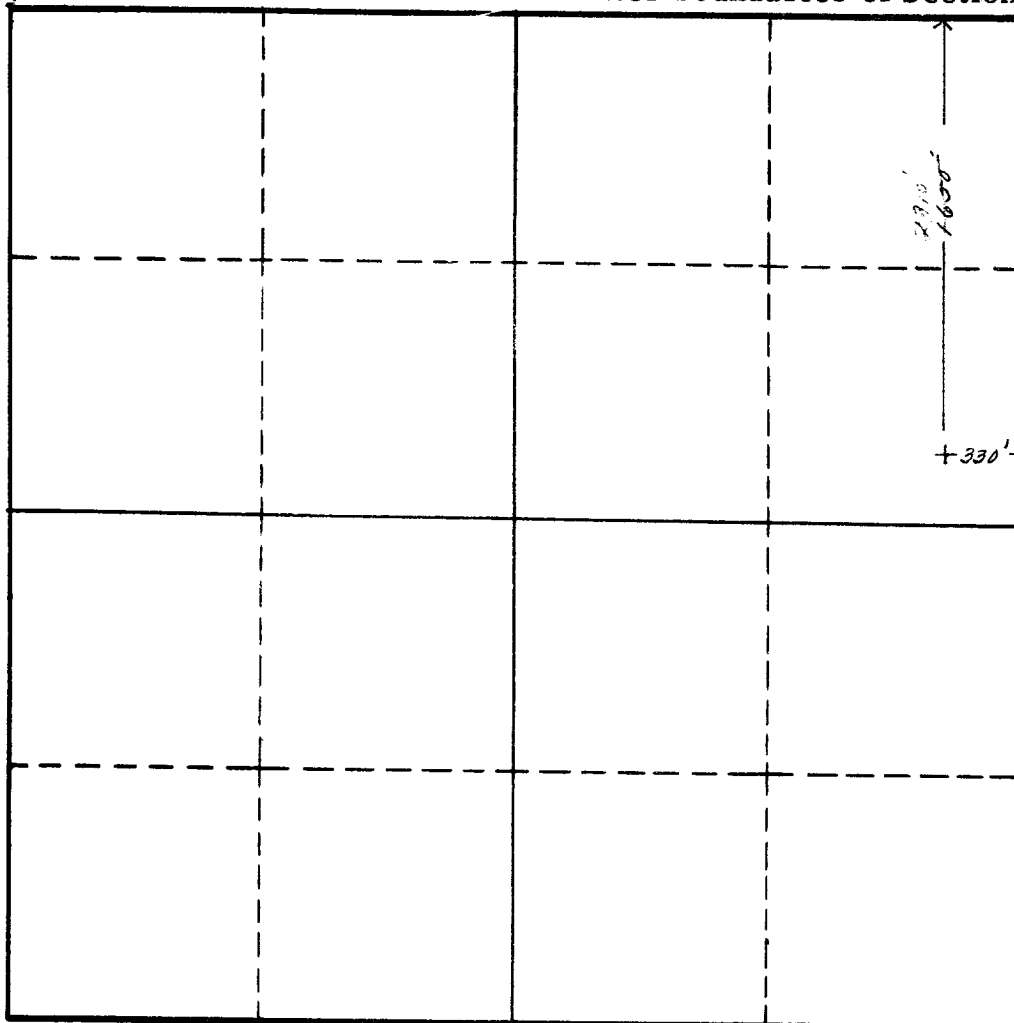

NOTE

This section of
form is to be
used for gas
wells only.



SCALE: 1"=1000'

1. Is this Well a Dual Comp. ? Yes ___ No ___.
2. If the answer to Question 1 is yes, are there any other dually completed wells within the dedicated acreage ? Yes ___ No ___.

Name _____
Position _____
Representing _____
Address _____

This is to certify that the above plat was prepared from field notes of actual surveys made by me or under my supervision and that the same are true and correct to the best of my knowledge and belief.

Date Surveyed April 9, 1957
Charles P. Johnson
Registered Professional Engineer and/or
Land Surveyor