

(SUBMIT IN TRIPLICATE)

Land Office

LAS CRUCES

Lease No.

025322-6(6)

UNITED STATES  
DEPARTMENT OF THE INTERIOR  
GEOLOGICAL SURVEYRECEIVED  
JUL 28 1959

## SUNDRY NOTICES AND REPORTS ON WELLS

NOTICE OF INTENTION TO DRILL.....	<input checked="" type="checkbox"/>	SUBSEQUENT REPORT OF WATER SHUT-OFF.....	
NOTICE OF INTENTION TO CHANGE PLANS.....		SUBSEQUENT REPORT OF SHOOTING OR ACIDIZING.....	
NOTICE OF INTENTION TO TEST WATER SHUT-OFF.....		SUBSEQUENT REPORT OF ALTERING CASING.....	
NOTICE OF INTENTION TO RE-DRILL OR REPAIR WELL.....		SUBSEQUENT REPORT OF RE-DRILLING OR REPAIR.....	
NOTICE OF INTENTION TO SHOOT OR ACIDIZE.....		SUBSEQUENT REPORT OF ABANDONMENT.....	
NOTICE OF INTENTION TO PULL OR ALTER CASING.....		SUPPLEMENTARY WELL HISTORY.....	
NOTICE OF INTENTION TO ABANDON WELL.....			

(INDICATE ABOVE BY CHECK MARK NATURE OF REPORT, NOTICE, OR OTHER DATA)

Dr. Drummond the Surveying Unit JULY 16, 1959  
# 14-68-1001-2907Well No. C-2 is located 1000 ft. from N line and 230 ft. from E line of sec. 34

44 54 Sec. 34 (1/4 Sec. and Sec. No.)    100 (Twp.)    31 (Range)    N. 1. 7. 1 (Meridian)

SPUGART (County or Subdivision)    NEW MEXICO (State or Territory)

The elevation of the derrick floor above sea level is \_\_\_\_\_ ft.

## DETAILS OF WORK

(State names of and expected depths to objective sands; show sizes, weights, and lengths of proposed casings; indicate mudding jobs, cementing points, and all other important proposed work)

WE EXPECT TO DRILL THIS WELL WITH CABLE TOOLS TO A TOTAL DEPTH OF 4,000 FEET. EXPECT TO RUN 300 FEET OF 8" CASING AND CEMENT WITH 50 SACKS. EXPECT TO RUN 7" CASING TO TOTAL DEPTH AND CEMENT WITH 200 SACKS, PERFORATE THE 7" CASING AND TREAT.

I understand that this plan of work must receive approval in writing by the Geological Survey before operations may be commenced.

Company ASQUANS SAUNDERS WELCH & IVERSONP.O. BOX 1392Address ARTESIA, NEW MEXICO

By

Title

AGENT



NEW MEXICO OIL CONSERVATION COMMISSION  
Well Location and Acreage Dedication Plat

RECEIVED

Section A.

Date July 19 1959

Operator Keohane Saunders, et. al. Lease Hinkle "B"  
Well No. 6 Unit Letter L Section 34 Township 18 S Range 31 E NMPM  
Located 1650 Feet From S Line, 990 Feet From W Line  
County Eddy G. L. Elevation \_\_\_\_\_ Dedicated Acreage 40 Acres  
Name of Producing Formation Queen Pool Shugart

1. Is the Operator the only owner\* in the dedicated acreage outlined on the plat below?  
Yes X No \_\_\_\_\_.
2. If the answer to question one is "no," have the interests of all the owners been consolidated by communitization agreement or otherwise? Yes \_\_\_\_\_ No \_\_\_\_\_. If answer is "yes," Type of Consolidation \_\_\_\_\_
3. If the answer to question two is "no," list all the owners and their respective interests below:

Owner

Land Description



RECEIVED  
JUL 21 1959  
SURVEY  
NEW MEXICO

Section B

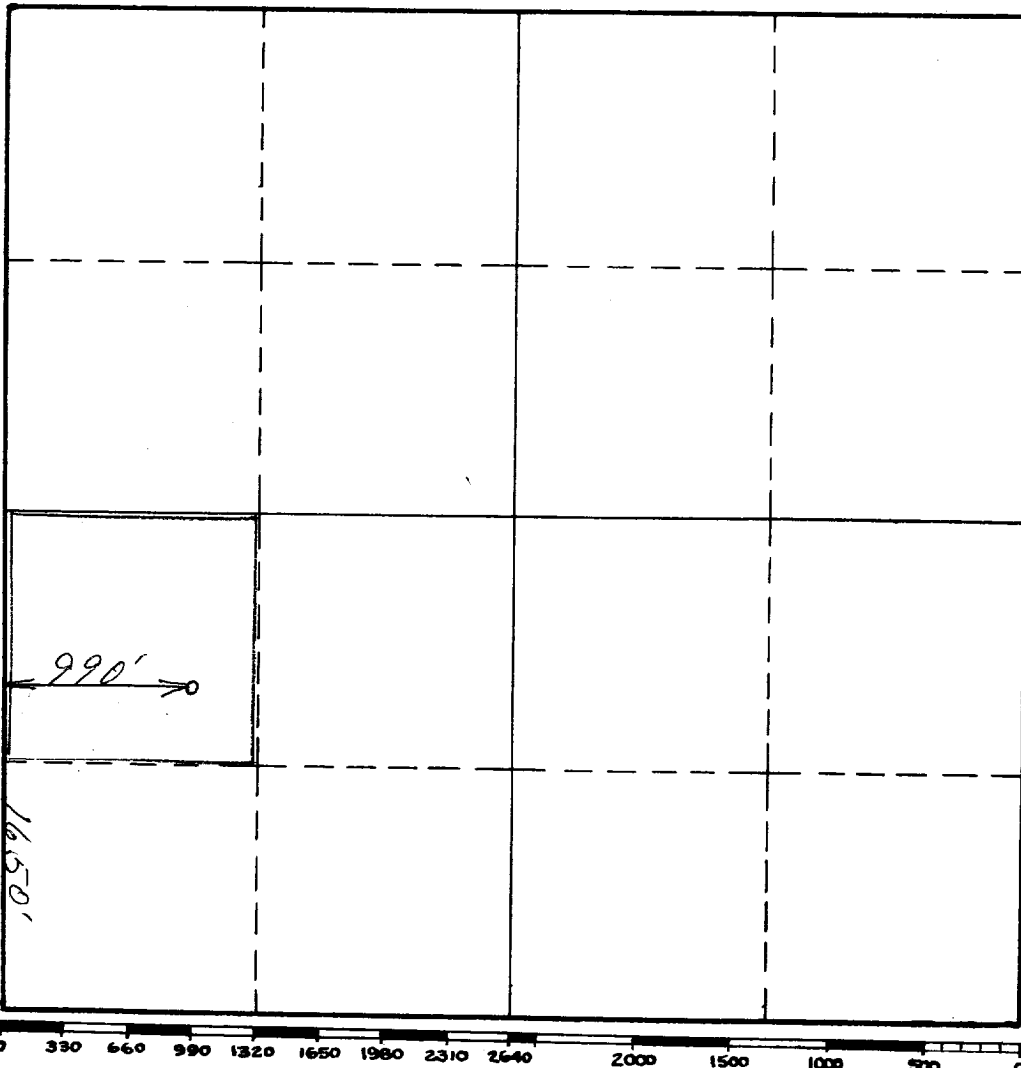

This is to certify that the information in Section A above is true and complete to the best of my knowledge and belief.

Keohane Saunders, et. al  
(Operator)  
[Signature]  
(Representative)

Artesia, N. M.  
Address

This is to certify that the well location shown on the plat in Section B was plotted from field notes of actual surveys made by me or under my supervision and that the same is true and correct to the best of my knowledge and belief.

Date Surveyed 7/18/59  
V. P. Sheldon  
Registered Professional  
Engineer and/or Land Surveyor.

Certificate No. 963  
(See instructions for completing this form on the reverse side)

INSTRUCTIONS FOR COMPLETION:

1. Operator shall furnish and certify to the information called for in Section A.
2. Operator shall outline the dedicated acreage for both oil and gas wells on the plat in Section B.
3. A registered professional engineer or land surveyor registered in the State of New Mexico or approved by the Commission shall show on the plat the location of the well and certify this information in the space provided.
4. All distances shown on the plat must be from the outer boundaries of Section.
5. If additional space is needed for listing owners and their respective interests as required in question 3, Section A, please use space below

OIL CONSERVATION COMMISSION	
ARTESIA DISTRICT OFFICE	
No. Copies Received	
DATE	
OPERATOR	
SANTA FE	
PROJECT	
STATE	
U.S.	
REMARKS	

\* "Owner" means the person who has the right to drill into and to produce from any pool and to appropriate the production either for himself or for himself and another. (65-3-29 (e) NMSA 1953 Comp.)