

10/15/61 N. M. O. C. C. COPY

Budget Bureau No. 42-R358.4.
Approval expires 12-31-60.

(SUBMIT IN TRIPLICATE)

UNITED STATES
DEPARTMENT OF THE INTERIOR
GEOLOGICAL SURVEY

Land Office **LAS CRUCES**
Lease No. **662033**
Unit **N**

RECEIVED

JUN 16 1961

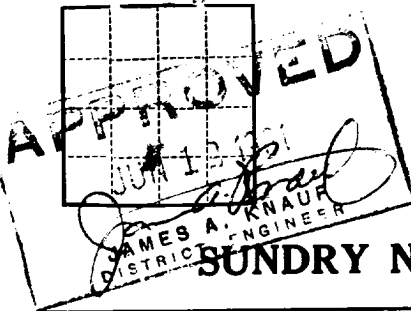

SUNDRY NOTICES AND REPORTS ON WELLS

O. C. C.

ARTESIA, OFFICE

NOTICE OF INTENTION TO DRILL	<input checked="" type="checkbox"/>	SUBSEQUENT REPORT OF WATER SHUT-OFF	
NOTICE OF INTENTION TO CHANGE PLANS		SUBSEQUENT REPORT OF SHOOTING OR ACIDIZING	
NOTICE OF INTENTION TO TEST WATER SHUT-OFF		SUBSEQUENT REPORT OF ALTERING CASING	
NOTICE OF INTENTION TO RE-DRILL OR REPAIR WELL		SUBSEQUENT REPORT OF RE-DRILLING OR REPAIR	
NOTICE OF INTENTION TO SHOOT OR ACIDIZE		SUBSEQUENT REPORT OF ABANDONMENT	
NOTICE OF INTENTION TO PULL OR ALTER CASING		SUPPLEMENTARY WELL HISTORY	
NOTICE OF INTENTION TO ABANDON WELL			

(INDICATE ABOVE BY CHECK MARK NATURE OF REPORT, NOTICE, OR OTHER DATA)

JUNE 8TH

19 61

FEDERAL FRATHERSTONE

Well No. **3** is located **990** ft. from **N** line and **2310** ft. from **E** line of sec. **5**

SE/4 SW/4 Sec. 5

(1/4 Sec. and Sec. No.)

19S

(Twp.)

31E

(Range)

N.M.P.M.

(Meridian)

UNDESIGNATED

(Field)

EDDY

(County or Subdivision)

NEW MEXICO

(State or Territory)

The elevation of the derrick floor above sea level is _____ ft.

DETAILS OF WORK

(State names of and expected depths to objective sands; show sizes, weights, and lengths of proposed casings; indicate mudding jobs, cementing points, and all other important proposed work)

EXPECT TO DRILL THE ABOVE WELL TO APPROXIMATELY 3700 FEET. PLAN TO SET 8-5/8" CASING AT APPROXIMATELY 800 FEET AND CEMENT WITH 50 BAGS. PLAN TO RUN 5 INCH CASING TO TOTAL DEPTH, PERFORATE AND TREAT AFTER CEMENTING WITH 100* BAGS.

* Sufficient cement to cover 100 bags

ILLEGIBLE

RECEIVED

JUN 12 1961

I understand that this plan of work must receive approval in writing by the Geological Survey before operations may be commenced.

Company **W. C. JELCH**
P. O. BOX 558
Address **ARTESIA, NEW MEXICO**

U. S. GEOLOGICAL SURVEY
ARTESIA, NEW MEXICO

By

Title

AGENT

NUMBER OF COPIES RECEIVED	
DISTRIBUTION	
SANTA FE	
FILE	
U.S.G.S.	
LAND OFFICE	
TRANSPORTER	OIL
	GAS
PRODUCTION OFFICE	
OPERATOR	

NEW MEXICO OIL CONSERVATION COMMISSION
WELL LOCATION AND ACREAGE DEDICATION PLAT
 SEE INSTRUCTIONS FOR COMPLETING THIS FORM ON THE REVERSE SIDE

FORM C-128
 Revised 5/1/57

RECEIVED
 JUN 16 1961

SECTION A

Operator W.C. WELCH		Lease Featherstone Tract		Well ARTESIA, OFFSHORE	
Unit Letter B	Section 8	Township 10 N	Range 31 E	County Sandoval	
Actual Footage Location of Well: 990 feet from the 3 line and 2310 feet from the 7 line					
Ground Level Elev.	Producing Formation UOGB	Pool Undesignated	Dedicated Acreage: 40 Acres		

1. Is the Operator the only owner in the dedicated acreage outlined on the plat below? YES ☒ NO ____ . ("Owner" means the person who has the right to drill into and to produce from any pool and to appropriate the production either for himself or for himself and another. (65-3-29 (e) NMSA 1935 Comp.)
2. If the answer to question one is "no," have the interests of all the owners been consolidated by communitization agreement or otherwise? YES ____ NO ____ . If answer is "yes," Type of Consolidation ____
3. If the answer to question two is "no," list all the owners and their respective interests below:

Owner	Land Description
ILLEGIBLE	

RECEIVED
 JUN 12 1961
 U. S. GEOLOGICAL SURVEY
 ARTESIA, NEW MEXICO

SECTION B

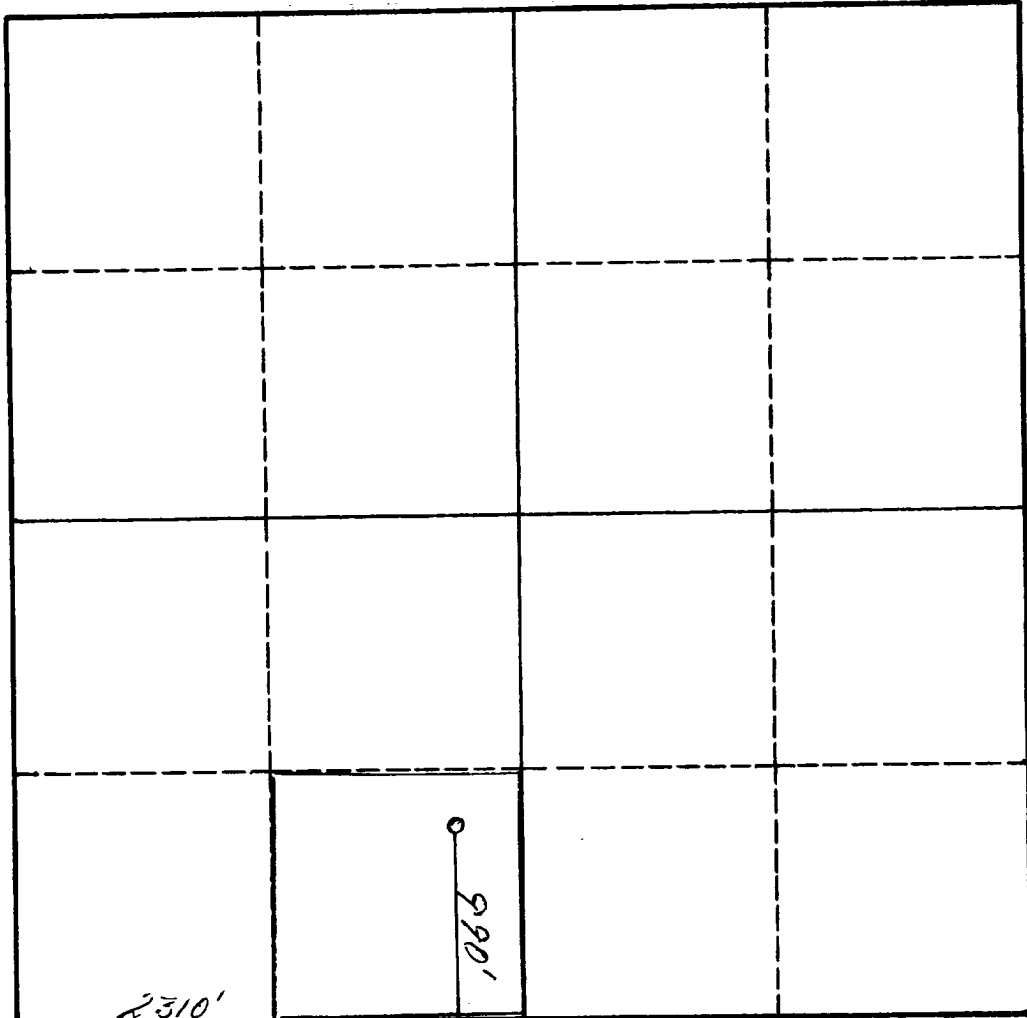

I hereby certify that the information in SECTION A above is true and complete to the best of my knowledge and belief.

Name	<i>[Signature]</i>
Position	AGENT
Company	W. C. WELCH
Date	JUNE 8, 1961

I hereby certify that the well location shown on the plat in SECTION B was plotted from field notes of actual surveys made by me or under my supervision, and that the same is true and correct to the best of my knowledge and belief.

Date Surveyed	6/1/61
Registered Professional Engineer and/or Land Surveyor	<i>[Signature]</i>
Certificate No.	772

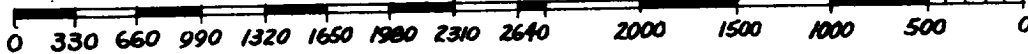

INSTRUCTIONS FOR COMPLETION OF FORM C-128

1. Operator shall furnish and certify to the information called for in Section A.
2. Operator shall outline the dedicated acreage for *both* oil and gas wells on the plat in Section B.
3. A registered professional engineer or land surveyor registered in the State of New Mexico or approved by the Commission shall show on the plat the location of the well and certify this information in the space provided.
4. All distances shown on the plat must be from the outer boundaries of the Section.
5. If additional space is needed for listing owners and their respective interests as required in question 3 of Section A, please use space below.