



UNITED STATES  
DEPARTMENT OF THE INTERIOR  
GEOLOGICAL SURVEY

P. O. Drawer U  
Artesia, New Mexico

RECEIVED

MAY 24 1961

May 23, 1961 P. O. C.  
ARTESIA, OFFICE

Mr. Neil G. Salsich, Jr.  
716 First National Bank Building  
Midland, Texas

Dear Mr. Salsich:

Your Notice of Intention to Drill Continental well No. 1 (copy attached) in the NW $\frac{1}{4}$ SE $\frac{1}{4}$  sec. 9, T. 19 S., R. 31 E., N.M.P.M., Eddy County, New Mexico, lease Las Cruces 069033-A, has been forwarded to this office for approval. The lease lies within the "Potash Area" designated by the Secretary of the Interior and is subject to the stipulation that all wells drilled to formations above the base of the Delaware sand or to be a depth above 5,000 feet, whichever is the lesser, must be approved by the Director of the Geological Survey.

Pursuant to authority delegated to me by the Director, U. S. Geological Survey on June 7, 1960, I hereby approve the Notice of Intention to Drill the Continental well No. 1 to a depth of approximately 4,000 feet to test the Grayburg formation.

Please notify the District Engineer, U. S. Geological Survey, P. O. Drawer U, Artesia, New Mexico, in sufficient time for a representative to witness all cementing operations.

Very truly yours,

(Orig. Sgd.) JOHN A. ANDERSON

John A. Anderson  
Regional Oil and Gas Supervisor

Attachment

Copy to: Washington (w/cy Notice)  
Mining Branch (2) (w/2 cys Notice)  
NMOCC-Artesia (2) (w/2 cys Notice) ✓  
Artesia (w/cy Notice)  
Roswell office copy

UNITED STATES  
DEPARTMENT OF THE INTERIOR  
GEOLOGICAL SURVEY

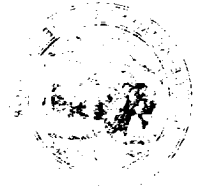

100-100000-100000

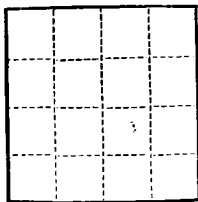
Form 9-331a  
(Feb. 1951)

(SUBMIT IN TRIPLICATE)

UNITED STATES  
DEPARTMENT OF THE INTERIOR  
GEOLOGICAL SURVEY

Land Office

LOS CRUCES, N. M.

Lease No.

1059033-1

Unit

MAY 24 1961

U. S. G.  
ARTESIA, OFFICE

# SUNDRY NOTICES AND REPORTS ON WELLS

NOTICE OF INTENTION TO DRILL		SUBSEQUENT REPORT OF WATER SHUT-OFF	
NOTICE OF INTENTION TO CHANGE PLANS		SUBSEQUENT REPORT OF SHOOTING OR ACIDIZING	
NOTICE OF INTENTION TO TEST WATER SHUT-OFF		SUBSEQUENT REPORT OF ALTERING CASING	
NOTICE OF INTENTION TO RE-DRILL OR REPAIR WELL		SUBSEQUENT REPORT OF RE-DRILLING OR REPAIR	
NOTICE OF INTENTION TO SHOOT OR ACIDIZE		SUBSEQUENT REPORT OF ABANDONMENT	
NOTICE OF INTENTION TO PULL OR ALTER CASING		SUPPLEMENTARY WELL HISTORY	
NOTICE OF INTENTION TO ABANDON WELL			

(INDICATE ABOVE BY CHECK MARK NATURE OF REPORT, NOTICE, OR OTHER DATA)

Continental Federal  
Well No. 1 is located 1700 ft. from [S] line and 1700 ft. from [E] line of sec. 9

S4/1 Sec. 9 (1/4 Sec. and Sec. No.) 12-5 (Twp.) 31-E (Range) 107N (Meridian)  
Midland (City) Midland (County or Subdivision) New Mexico (State or Territory)

The elevation of the derrick floor above sea level is \_\_\_\_\_ ft.

## DETAILS OF WORK

(State names of and expected depths to objective sands; show sizes, weights, and lengths of proposed casings; indicate mudding jobs, cementing points, and all other important proposed work)

I plan to drill with cable tools to a total depth of 1000' to test the Grayburg formation. 500' of 8 5/8" casing will be cemented as surface with 50 sacks after circulating mud. In event of production 1 1/2" casing will be cemented at total depth with at least 100 sacks to bring cement to the salt section.

RECEIVED

MAY 17 1961

U. S. GEOLOGICAL SURVEY

ARTESIA, NEW MEXICO

I understand that this plan of work must receive approval in writing by the Geological Survey before operations may be commenced.

Company Neil E. Salsich, Jr.

Address 716 1st Nat'l. Bk Bldg.

Midland, Texas

By

Neil E. Salsich, Jr.

Title

Owner

**NEW MEXICO OIL CONSERVATION COMMISSION  
WELL LOCATION AND ACREAGE DEDICATION PLAT**

**RECEIVED**  
FORM C-128  
Revised 5/1/57  
**MAY 24 1961**

SEE INSTRUCTIONS FOR COMPLETING THIS FORM ON THE REVERSE SIDE

**SECTION A**

Operator <b>Neal H. Salsich, Jr.</b>		Lease <b>Continental Federal</b>		COUNTY OFFICE <b>1</b>	
Unit Letter <b>J</b>	Section <b>9</b>	Township <b>19 South</b>	Range <b>31 East</b>	County <b>Eddy</b>	
Actual Footage Location of Well: <b>1980</b> feet from the <b>South</b> line and <b>1980</b> feet from the <b>East</b> line					
Ground Level Elev. <b>1880</b>	Producing Formation <b>Gilbert</b>	Pool <b>Wildcat</b>		Dedicated Acreage: <b>1</b> Acres	

1. Is the Operator the only owner in the dedicated acreage outlined on the plat below? YES ☒ NO ☐ ("Owner" means the person who has the right to drill into and to produce from any pool and to appropriate the production either for himself or for himself and another. (65-3-29 (a) NMSA 1955 Comp.)
2. If the answer to question one is "no," have the interests of all the owners been consolidated by communication agreement or otherwise? YES ☐ NO ☐ If answer is "yes," Type of Consolidation **RECEIVED**
3. If the answer to question two is "no," list all the owners and their respective interests below:

Owner	Land Description	<b>MAY 18 1961</b> <b>U. S. GEOLOGICAL SURVEY</b> <b>ARTESIA, NEW MEXICO</b>

**SECTION B**

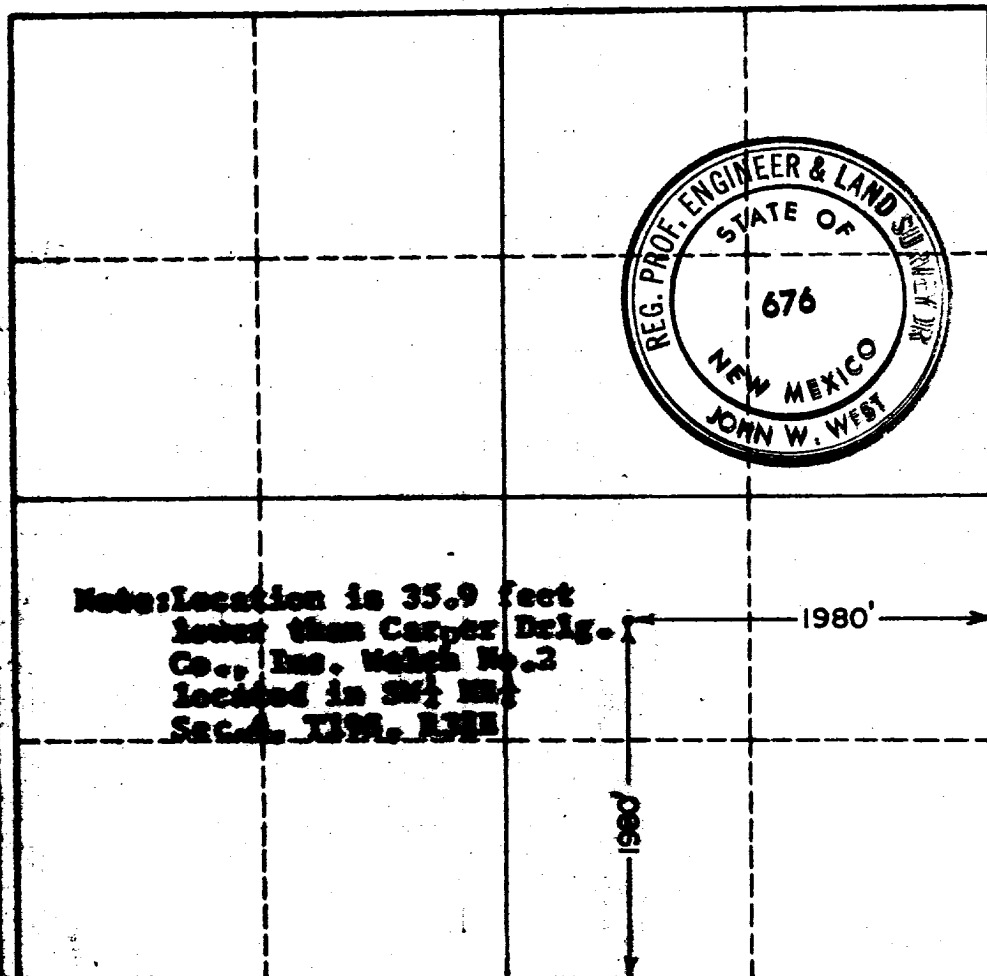

**CERTIFICATION**

I hereby certify that the information in SECTION A above is true and complete to the best of my knowledge and belief.

*John W. West*  
Name  
**Engineer**  
Position  
**Neal H. Salsich, Jr.**  
Company  
**5/18/61**  
Date

I hereby certify that the well location shown on the plat in SECTION B was plotted from field notes of actual surveys made by me or under my supervision, and that the same is true and correct to the best of my knowledge and belief.

Date Surveyed **3-12-61**  
Registered Professional Engineer and/or Land Surveyor, **JOHN W. WEST**  
*John W. West*  
Certificate No.  
**A.M. - P.E. & L.S. NO. 676**

0 320 640 960 1280 1600 1920 2240 2560 2880 3200 3520 3840 4160 4480 4800 5120 5440 5760 6080 6400 6720 7040 7360 7680 8000