

(SUBMIT IN TRIPLICATE)

UNITED STATES
DEPARTMENT OF THE INTERIOR
GEOLOGICAL SURVEY

Budget Bureau No. 42-R358.4,
Approval expires 12-31-60.
RECEIVED
Land Office **LC 07358**
Lease No. **137**
Unit **Charles J. Jones**
30-015-05783
Cons. Comm.
ARTESIA OFFICE

SUNDRY NOTICES AND REPORTS ON WELLS

NOTICE OF INTENTION TO DRILL	<input checked="" type="checkbox"/>	SUBSEQUENT REPORT OF WATER SHUT-OFF
NOTICE OF INTENTION TO CHANGE PLANS		SUBSEQUENT REPORT OF SHOOTING OR ACIDIZING
NOTICE OF INTENTION TO TEST WATER SHUT-OFF		SUBSEQUENT REPORT OF ALTERING CASING
NOTICE OF INTENTION TO RE-DRILL OR REPAIR WELL		SUBSEQUENT REPORT OF RE-DRILLING OR REPAIR
NOTICE OF INTENTION TO SHOOT OR ACIDIZE		SUBSEQUENT REPORT OF ABANDONMENT
NOTICE OF INTENTION TO PULL OR ALTER CASING		SUPPLEMENTARY WELL HISTORY
NOTICE OF INTENTION TO ABANDON WELL		

(INDICATE ABOVE BY CHECK MARK NATURE OF REPORT, NOTICE, OR OTHER DATA)

July 25, 1957
Angle-Walsh
Well No. 2-23 is located 1980 ft. from [N] line and 1980 ft. from [W] line of sec. 23
C SE 1/4 NW 1/4 sec. 23 T. 19 S., R. 31 E., N.M.P.M.
(1/4 Sec. and Sec. No.) (Twp.) (Range) (Meridian)
Undesignated Area Eddy New Mexico
(Field) (County or Subdivision) (State or Territory)

The elevation of the derrick floor above sea level is 3555 (ground)

DETAILS OF WORK

(State names of and expected depths to objective sands; show sizes, weights, and lengths of proposed casings; indicate mudding jobs, cementing points, and all other important proposed work)

Propose to drill the above well to total depth of approximately 5,000 ft. to test the San Andres formation. The following proposed casing program follows:

8-5/8" casing set @ approximately 850 ft. and cemented with not less than 50 m
5 1/2" casing set @ approximately 2970 ft. or pay zone and cemented with not less than 200 sacks of cement. 5000

I understand that this plan of work must receive approval in writing by the Geological Survey before operations may be commenced.

Company Three States Natural Gas Company

Address 102 South Second Street

Artesia, New Mexico

By

Title Agent

NEW MEXICO OIL CONSERVATION COMMISSION
Well Location and Acreage Dedication Plat

Section A.

Three States Natural Gas Co. Date July 22, 1957
Operator Three States Natural Gas Co. Lease angle-wilch
Well No. 2-23 Unit Letter F Section 23 Township 19S Range 31E NMPM
Located 1980 Feet From North Line, 1930 Feet From West Line
County ddy G. L. Elevation 3555 Dedicated Acreage _____ Acres
Name of Producing Formation _____ Pool Wildcat

1. Is the Operator the only owner* in the dedicated acreage outlined on the plat below?
Yes _____ No _____.
2. If the answer to question one is "no," have the interests of all the owners been consolidated by communitization agreement or otherwise? Yes _____ No _____. If answer is "yes," Type of Consolidation _____
3. If the answer to question two is "no," list all the owners and their respective interests below:

Owner

Land Description

Section B

R31E

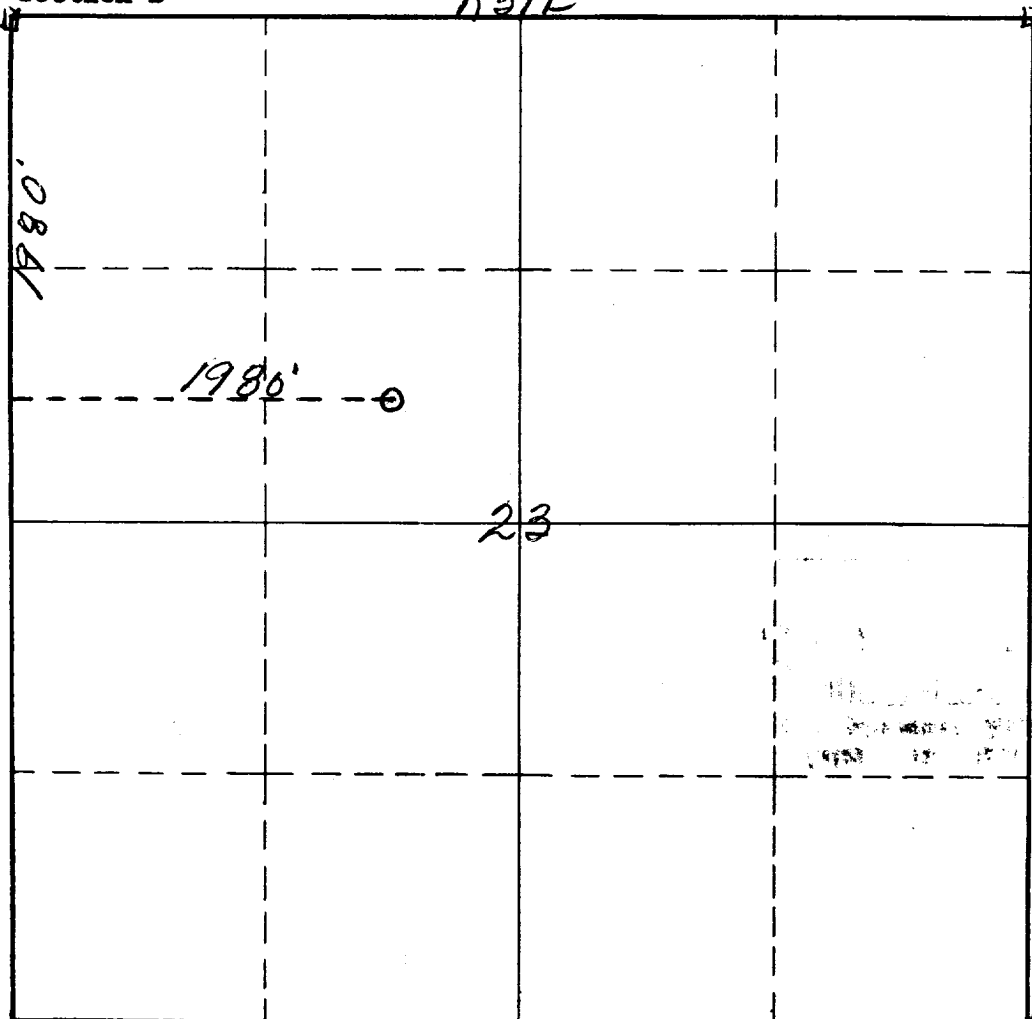

This is to certify that the information in Section A above is true and complete to the best of my knowledge and belief.

Three States Natural Gas Co.
(Operator)

Don Angle, agent
(Representative)

102 So. 2.
Artisia, New Mexico
Address

This is to certify that the well location shown on the plat in Section B was plotted from field notes of actual surveys made by me or under my supervision and that the same is true and correct to the best of my knowledge and belief.

Date Surveyed July 17th 1957

James H. Brown
Registered Professional
Engineer and/or Land Surveyor.

Certificate No. 542

(See instructions for completing this form on the reverse side)

INSTRUCTIONS FOR COMPLETION:

1. Operator shall furnish and certify to the information called for in Section A.
2. Operator shall outline the dedicated acreage for both oil and gas wells on the plat in Section B.
3. A registered professional engineer or land surveyor registered in the State of New Mexico or approved by the Commission shall show on the plat the location of the well and certify this information in the space provided.
4. All distances shown on the plat must be from the outer boundaries of Section.
5. If additional space is needed for listing owners and their respective interests as required in question 3, Section A, please use space below

* "Owner" means the person who has the right to drill into and to produce from any pool and to appropriate the production either for himself or for himself and another. (65-3-29 (e) NMSA 1953 Comp.)