



UNITED STATES
DEPARTMENT OF THE INTERIOR
GEOLOGICAL SURVEY

P. O. Box 6721
Roswell, New Mexico

IN REPLY REFER TO:

October 31, 1960

RECEIVED

NOV 2 1960

D. I. 4-
ARTESIA 1960

Mr. Len Mayer
P. O. Box 5613
Roswell, New Mexico

Dear Sir:

Reference is made to your Notice of Intention to Drill dated October 29, 1960, covering your No. 3 Barbara well in the SE 1/4 sec. 29, T. 19 S., R. 31 E., N.M.P.M., Eddy County, New Mexico on Lease New Mexico 032240 which contains the "Potash Stipulation".

Pursuant to authority delegated by the Director, U. S. Geological Survey on June 7, 1960, I hereby approve the Notice of Intention to Drill the above described well to a depth of approximately 2200 feet to test the Yates formation. Please notify the District Engineer, U. S. Geological Survey, P. O. Box 187, Artesia, New Mexico, in sufficient time for a representative to witness all cementing operations.

Very truly yours,

(Sgd.) JOHN A. ANDERSON

JOHN A. ANDERSON
Regional Oil and Gas Supervisor

Enclosure

JAKnauf:gs 10/31/60

Copy (w/notice) to: Washington
Artesia
NMOCG, Artesia (2) ✓
Mining Supervisor, Carlsbad (2)
Roswell file



DEPARTMENT OF THE INTERIOR
BUREAU OF LAND MANAGEMENT
LAND ACQUISITION SECTION

10-10-1964

10-10-1964

10-10-1964

(SUBMIT IN TRIPLICATE)

Land Office New MexicoLease No. NM-032240Unit N

RECEIVED

NOV 3 1960

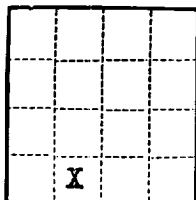
UNITED STATES
DEPARTMENT OF THE INTERIOR
GEOLOGICAL SURVEY

SUNDRY NOTICES AND REPORTS ON WELLS

NOTICE OF INTENTION TO DRILL.....	<input checked="" type="checkbox"/>	SUBSEQUENT REPORT OF WATER SHUT-OFF.....	
NOTICE OF INTENTION TO CHANGE PLANS.....		SUBSEQUENT REPORT OF SHOOTING OR ACIDIZING.....	
NOTICE OF INTENTION TO TEST WATER SHUT-OFF.....		SUBSEQUENT REPORT OF ALTERING CASING.....	
NOTICE OF INTENTION TO RE-DRILL OR REPAIR WELL.....		SUBSEQUENT REPORT OF RE-DRILLING OR REPAIR.....	
NOTICE OF INTENTION TO SHOOT OR ACIDIZE.....		SUBSEQUENT REPORT OF ABANDONMENT.....	
NOTICE OF INTENTION TO PULL OR ALTER CASING.....		SUPPLEMENTARY WELL HISTORY.....	
NOTICE OF INTENTION TO ABANDON WELL.....			

(INDICATE ABOVE BY CHECK MARK NATURE OF REPORT, NOTICE, OR OTHER DATA)

October 29, 1960

Barbara
Well No. 3 is located 990 ft. from SW line and 1980 ft. from W line of sec. 29

<u>SE 1/4</u> Sec. <u>29</u>	<u>19S</u>	<u>31E</u>	<u>N.M.P.M.</u>
(1/4 Sec. and Sec. No.)	(Twp.)	(Range)	(Meridian)
No. <u>Hackberry Yates</u>	<u>Eddy</u>	<u>New Mexico</u>	
(Field)	(County or Subdivision)	(State or Territory)	

The elevation of the derrick floor above sea level is 3482 ft. GL

DETAILS OF WORK

(State names of and expected depths to objective sands; show sizes, weights, and lengths of proposed casings; indicate mudding jobs, cementing points, and all other important proposed work)

Propose to drill to approximately 2200 feet to test the Yates Sand with Cable Tools. Will set surface pipe at top of salt (Approx. 800 ft.), and propose to circulate on surface pipe with mud to surface and follow with 50 sacks of cement, and drill out to total depth. If production is obtained, will circulate mud to surface on production string and follow with 100 sacks of cement.

Pecos Drilling Co., Inc., with cable tools.

RECEIVED

OCT 31 1960

U. S. GEOLOGICAL SURVEY
ARTESIA, NEW MEXICO

I understand that this plan of work must receive approval in writing by the Geological Survey before operations may be commenced.

Company Len MayerAddress P.O. Box 5613Roswell, New MexicoBy Len MayerTitle Owner

NEW MEXICO OIL CONSERVATION COMMISSION
Well Location and Acreage Dedication Plat

Section A.

Date _____

Operator LEN MAYER Lease BARBARA-FEDERAL
Well No. 3 Unit Letter M Section 29 Township 19 South Range 31 East NMPM
Located 300 Feet From South Line, 1980 Feet From West Line
County Doña Ana G. L. Elevation _____ Dedicated Acreage 40 Acres
Name of Producing Formation Yates Pool Undesignated

1. Is the Operator the only owner* in the dedicated acreage outlined on the plat below?
Yes ☒ No ☐.
2. If the answer to question one is "no," have the interests of all the owners been consolidated by communitization agreement or otherwise? Yes ☐ No ☐. If answer is "yes," Type of Consolidation _____
3. If the answer to question two is "no," list all the owners and their respective interests below:

Owner

Land Description

RECEIVED

OCT 31 1960

U. S. GEOLOGICAL SURVEY
ARTESIA, NEW MEXICO

Section B

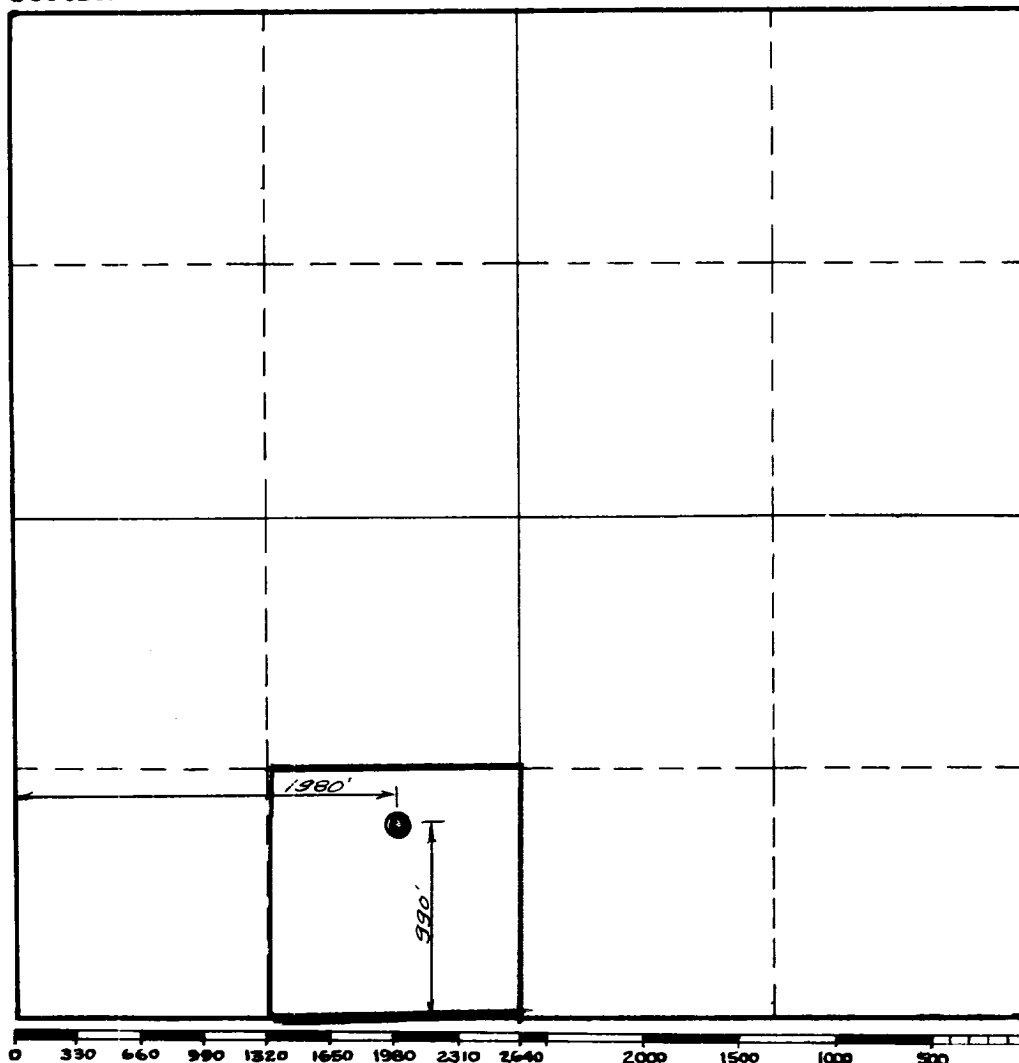

This is to certify that the information in Section A above is true and complete to the best of my knowledge and belief.

Len Mayer
Len Mayer

(Operator)
P. O. Box 5613
Roswell, New Mexico
(Representative)

Address

This is to certify that the well location shown on the plat in Section B was plotted from field notes of actual surveys made by me or under my supervision and that the same is true and correct to the best of my knowledge and belief.

Date Surveyed July 16, 1960

Don A. Swaney
Registered Professional
Engineer and/or Land Surveyor.

Certificate No. 2707

INSTRUCTIONS FOR COMPLETION:

1. Operator shall furnish and certify to the information called for in Section A.
2. Operator shall outline the dedicated acreage for both oil and gas wells on the plat in Section B.
3. A registered professional engineer or land surveyor registered in the State of New Mexico or approved by the Commission shall show on the plat the location of the well and certify this information in the space provided.
4. All distances shown on the plat must be from the outer boundaries of Section.
5. If additional space is needed for listing owners and their respective interests as required in question 3, Section A, please use space below

* "Owner" means the person who has the right to drill into and to produce from any pool and to appropriate the production either for himself or for himself and another. (65-3-29 (e) NMSA 1953 Comp.)