

NEW MEXICO OIL CONSERVATION COMMISSION
Santa Fe, New Mexico

NOTICE OF INTENTION TO DRILL OR RECOMPLETE

Notice must be given to the District Office of the Oil Conservation Commission and approval obtained before drilling or recompletion begins. If changes in the proposed plan are considered advisable, a copy of this notice showing such changes will be returned to the sender. Submit this notice in **QUINTUPLICATE**. One copy will be returned following approval. See additional instructions in Rules and Regulations of the Commission. **If State Land submit 6 Copies**

April 29, 1963
(Date)

APR 29 1963

O. C. C.
ARTESIAN OFFICE

OIL CONSERVATION COMMISSION
SANTA FE, NEW MEXICO

Gentlemen:

You are hereby notified that it is our intention to commence the (Drilling) (Recompletion) of a well to be known as

Don H. Ford

(Company or Operator)

Union

(Lease)

Well No. **21**, in **P** (Unit) The well is

located **990** feet from the **South** line and **660** feet from the

East

line of Section **36**, T. **19S**, R. **29E**, NMPM.

(GIVE LOCATION FROM SECTION LINE) **W.C.** Pool, _____ County

If State Land the Oil and Gas Lease is No. **E-8170**

If patented land the owner is _____

Address _____

We propose to drill well with drilling equipment as follows: **C. T. 10" hole to approximately 375' & 8" hole to 1650'**

The status of plugging bond is **Don H. Ford, 1 well bond**

Drilling Contractor **Apache Drilling Co.**

We intend to complete this well in the **Yates 7-Rivers** formation at an approximate depth of **1600'** feet.

CASING PROGRAM

We propose to use the following strings of Casing and to cement them as indicated:

Size of Hole	Size of Casing	Weight per Foot	New or Second Hand	Depth	Sacks Cement
10"	8 5/8	24#	second hand	375'	50 sa:
8"	5 1/2	15.5 #	new	1600'	50 "

If changes in the above plans become advisable we will notify you immediately.

ADDITIONAL INFORMATION (If recompletion give full details of proposed plan of work.)

Approved **MAY 2 1963**, 19_____
Except as follows:

Sincerely yours,

Don H. Ford
(Company or Operator)

By _____

Position _____
Send Communications regarding well to

Name **Don H. Ford**

Address **Box 567, Lordsburg, N. M.**

OIL CONSERVATION COMMISSION

By **M. L. Armstrong**

NUMBER OF COPIES RECEIVED	
DISTRIBUTION	
SANTA FE	
FILE	
U.S.G.S.	
LAND OFFICE	
TRANSPORTER	OIL
	GAS
PRORATION OFFICE	
OPERATOR	

NEW MEXICO OIL CONSERVATION COMMISSION
WELL LOCATION AND ACREAGE DEDICATION PLAT
 SEE INSTRUCTIONS FOR COMPLETING THIS FORM ON THE REVERSE SIDE

FORM C-128
 Revised 5/1/57

SECTION A

Operator Don H. Ford		Lease Union		Well No. 2
Unit Letter	Section 36	Township 19 South	Range 29 East	County Eddy
Actual Footage Location of Well: 660 feet from the East line and 990 feet from the South line				
Ground Level Elev. 3325	Producing Formation		Pool	Dedicated Acreage: Acres

1. Is the Operator the only owner in the dedicated acreage outlined on the plat below? YES ☒ NO ☐ . ("Owner" means the person who has the right to drill into and to produce from any pool and to appropriate the production either for himself or for himself and another. (65-3-29 (e) NMSA 1935 Comp.)
2. If the answer to question one is "no," have the interests of all the owners been consolidated by communitization agreement or otherwise? YES ☐ NO ☐ . If answer is "yes," Type of Consolidation _____
3. If the answer to question two is "no," list all the owners and their respective interests below:

Owner	Land Description
	SE 1/4

SECTION B

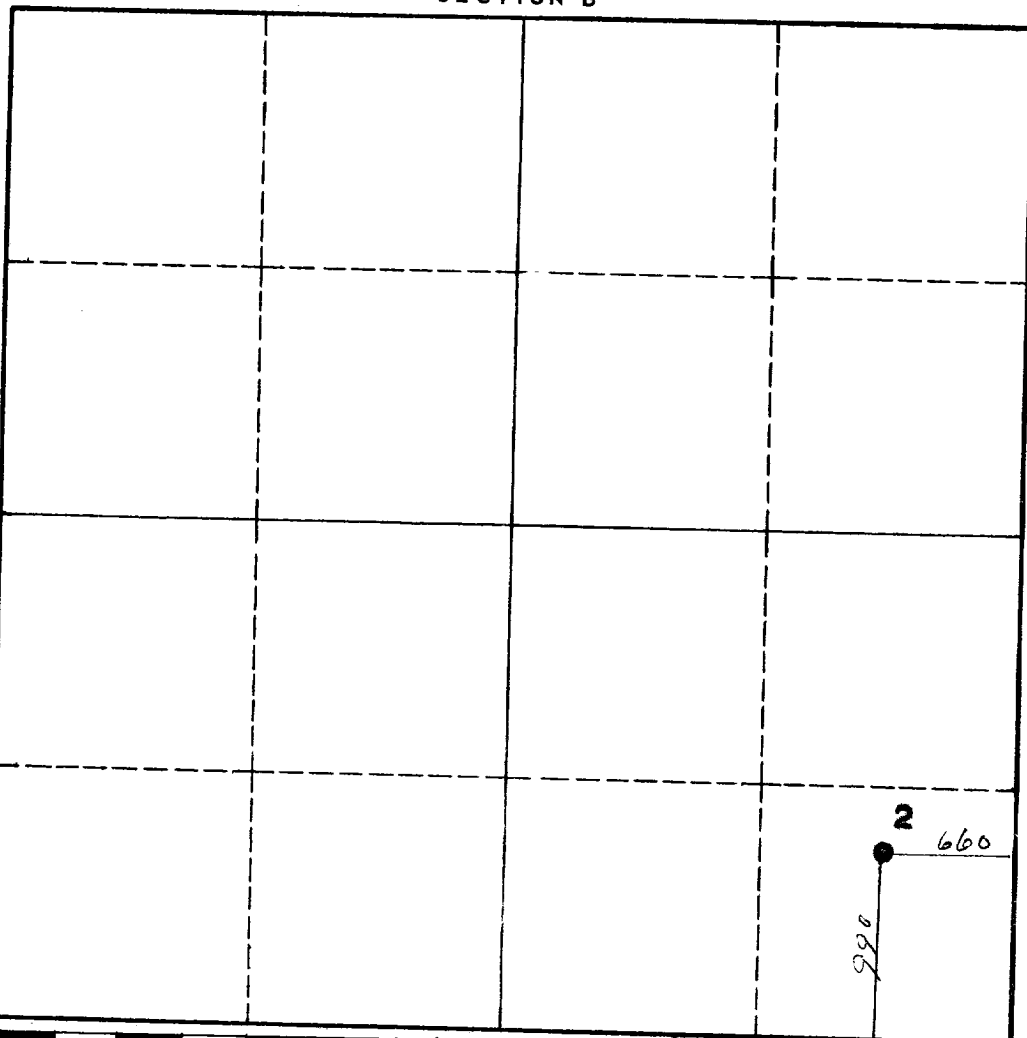

CERTIFICATION

I hereby certify that the information in SECTION A above is true and complete to the best of my knowledge and belief.

Name <i>Don H. Ford</i>
Position
Company
Date <i>April 27, 1963</i>

I hereby certify that the well location shown on the plat in SECTION B was plotted from field notes of actual surveys made by me or under my supervision, and that the same is true and correct to the best of my knowledge and belief.

Date Surveyed April 27, 1963
Registered Professional Engineer and/or Land Surveyor <i>John A. Mathis Jr.</i>
Certificate No. 1502

INSTRUCTIONS FOR COMPLETION OF FORM C-128

1. Operator shall furnish and certify to the information called for in Section A.
2. Operator shall outline the dedicated acreage for *both* oil and gas wells on the plat in Section B.
3. A registered professional engineer or land surveyor registered in the State of New Mexico or approved by the Commission shall show on the plat the location of the well and certify this information in the space provided.
4. All distances shown on the plat must be from the outer boundaries of the Section.
5. If additional space is needed for listing owners and their respective interests as required in question 3 of Section A, please use space below.

OIL CONSERVATION COMMISSION		
ARTESIA DISTRICT OFFICE		
No. Copies Received		
DISTRIBUTION		
OPERATOR	DATE	INITIALS
SANTA FE		
REGISTRATION OFFICE		
STATE LAND OFFICE		
G. S.		
NOTED		
RECEIVED		