



IN REPLY REFER TO:

UNITED STATES
DEPARTMENT OF THE INTERIOR
GEOLOGICAL SURVEY
P. O. Drawer 1857
Roswell, New Mexico

*copy
to p. 1.*

December 3, 1963

Southwestern, Inc.
P. O. Box 1116
Lovington, New Mexico

Dear Sir:

Your Notice of Intention to Drill well No. 3 Gas Federal (copy attached) in the SE1/4 sec. 29, T. 19 S., R. 31 E., N.M.P.M., Eddy County, New Mexico, lease Las Cruces 063422, to a depth of 2,500 feet to test the Yates formation, has been forwarded to this office for approval.

Pursuant to authority delegated to the Regional Oil and Gas Supervisor on May 10, 1962, 27 F.R. 4814, I hereby approve the Notice of Intention to Drill described in the foregoing.

Please notify the District Engineer, Geological Survey, Drawer U, Artesia, New Mexico, in sufficient time for a representative to witness all cementing operations.

Very truly yours,

(SIGNED) JOHN A. ANDERSON
JOHN A. ANDERSON
Regional Oil and Gas Supervisor

Attachment

Copy to: Washington
Mining Branch (2)
NMOCC-Artesia (2) (w/2 cys Notice) ✓
Artesia
Roswell (2)

JAKnauf:hb 12/2/63

RECEIVED

DEC 5 1963

U. S. G.
ARTESIA OFFICE

UNITED STATES
DEPARTMENT OF THE INTERIOR
GEOLOGICAL SURVEY
WASHINGTON, D. C.
20548



TO THE DIRECTOR, GEOLOGICAL SURVEY
WASHINGTON, D. C.
FROM THE CHIEF OF BUREAU OF LAND MANAGEMENT
DENVER, COLORADO
SUBJECT: [Illegible]

[The following text is extremely faint and largely illegible due to the quality of the scan. It appears to be a memorandum or report detailing geological findings or land management issues.]

Very truly yours,
[Illegible Signature]

Approved: [Illegible]
Special Agent in Charge

Enclosure

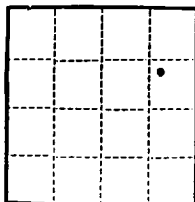

(SUBMIT IN TRIPLICATE)

UNITED STATES
DEPARTMENT OF THE INTERIOR
GEOLOGICAL SURVEY

Land Office ROSWELL
Lease No. LC 063622
Unit H

SUNDRY NOTICES AND REPORTS ON WELLS

NOTICE OF INTENTION TO DRILL	<input checked="" type="checkbox"/>	SUBSEQUENT REPORT OF WATER SHUT-OFF	
NOTICE OF INTENTION TO CHANGE PLANS		SUBSEQUENT REPORT OF SHOOTING OR ACIDIZING	
NOTICE OF INTENTION TO TEST WATER SHUT-OFF		SUBSEQUENT REPORT OF ALTERING CASING	
NOTICE OF INTENTION TO RE-DRILL OR REPAIR WELL		SUBSEQUENT REPORT OF RE-DRILLING OR REPAIR	
NOTICE OF INTENTION TO SHOOT OR ACIDIZE		SUBSEQUENT REPORT OF ABANDONMENT	
NOTICE OF INTENTION TO PULL OR ALTER CASING		SUPPLEMENTARY WELL HISTORY	
NOTICE OF INTENTION TO ABANDON WELL			

(INDICATE ABOVE BY CHECK MARK NATURE OF REPORT, NOTICE, OR OTHER DATA)

NOVEMBER 26, 19 63

Well No. 3-Conn is located 1650 ft. from N line and 990 ft. from E line of sec. 29

SE/4 NE/4 SEC 29

19S

31E

($\frac{1}{4}$ Sec. and Sec. No.)

(Twp.)

(Range)

(Meridian)

N. HACKBERRY YATES

EDDY

NEW MEXICO

(Field)

(County or Subdivision)

(State or Territory)

The elevation of the derrick floor above sea level is 3481 ft. GROUND LEVEL

DETAILS OF WORK

(State names of and expected depths to objective sands; show sizes, weights, and lengths of proposed casings; indicate mudding jobs, cementing points, and all other important proposed work)

700 FT 8 5/8" CASING CIRCULATE MUD TO SURFACE AND CEMENT W/50 SX.

2500 FT 4 1/2" CIRCULATE MUD TO SURFACE AND CEMENT W/100 SX.

T.D. APPROXIMATELY 2500'

TO TEST YATES FORMATION

CABLE TOOLS TO BE USED.

I understand that this plan of work must receive approval in writing by the Geological Survey before operations may be commenced.

Company SOUTHWESTERN, INC.

Address BOX 1116

LOVINGTON, N.M.

By T. J. Hollis
T. J. HOLLIS

Title PRESIDENT

NEW MEXICO OIL CONSERVATION COMMISSION

WELL LOCATION AND ACREAGE DEDICATION PLAT

FORM C-125
Revised 8/1/57

SEE INSTRUCTIONS FOR COMPLETING THIS FORM ON THE REVERSE SIDE

SECTION A

Operator SOUTHWESTERN, INC.			Lease CEM TENNECO FEDERAL		Well No. 1-3
Well Letter H	Section 29	Township 19 SOUTH	Range 31 EAST	County EDDY	
Actual Well Location of Well: 1650 feet from the NORTH line and 990 feet from the EAST line					
Ground Level Elev.	Producing Formation		Pool		Dedicated Acreage: Acres

1. Is the Operator the only owner in the dedicated acreage outlined on the plat below? YES ☒ NO ☐ . ("Owner" means the person who has the right to drill into and to produce from any pool and to appropriate the production either for himself or for himself and another. (65-5-29 (a) NMSA 1955 Comp.)
2. If the answer to question one is "no," have the interests of all the owners been consolidated by communication agreements or otherwise? YES ☐ NO ☐ . If answer is "yes," Type of Consolidation _____
3. If the answer to question two is "no," list all the owners and their respective interests below:

RECEIVED

DEC 5 1963

N. C. C.
ARTESIA OFFICE

SECTION B

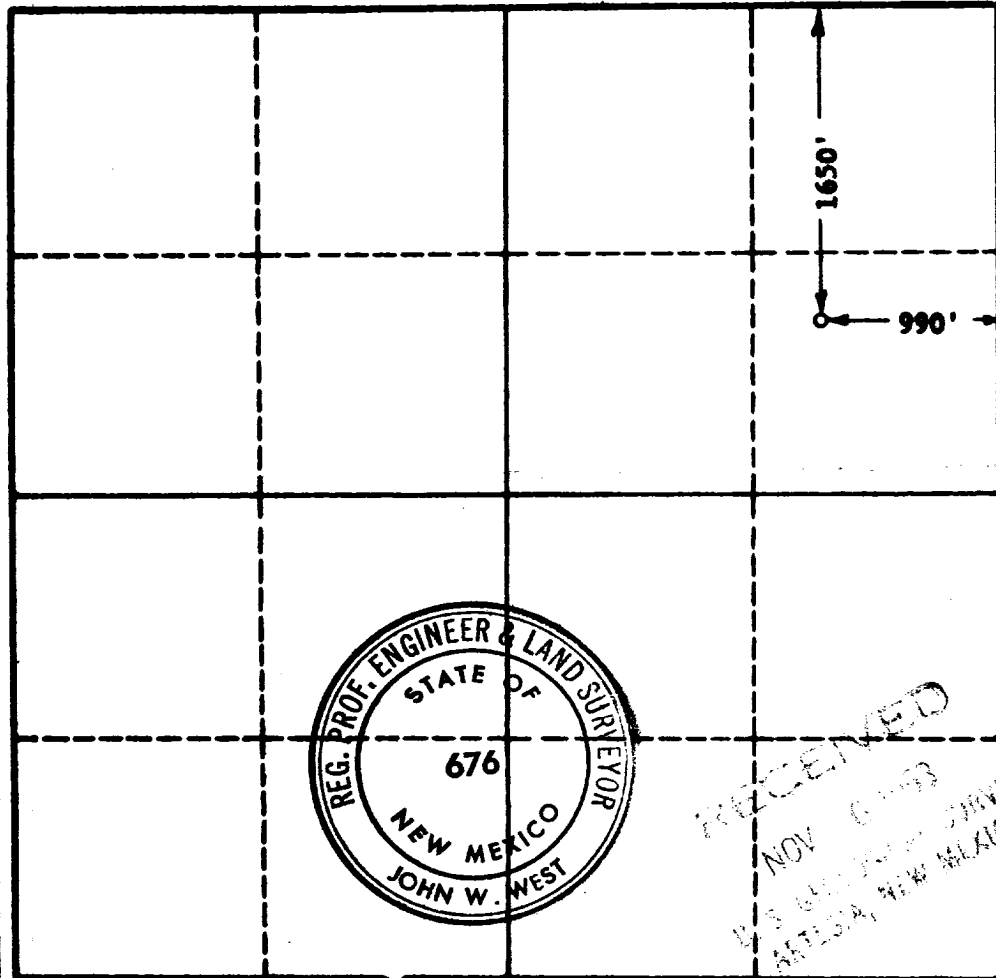

CERTIFICATION

I hereby certify that the information in SECTION A above is true and complete to the best of my knowledge and belief.

Name <i>J. J. Salas</i>
Position <i>President</i>
Company <i>Southwestern Inc.</i>
Date <i>2-12-63</i>

I hereby certify that the well location shown on the plat in SECTION B was plotted from field notes of actual surveys made by me or under my supervision, and that the same is true and correct to the best of my knowledge and belief.

Date Surveyed 11-19-1963
Registered Professional Engineer and/or Land Surveyor, JOHN W. WEST
<i>John W. West</i>
Certificate No. N. M. - P. E. & L. S. NO. 676

RECEIVED
NOV 1963
N. C. C. ARTESIA, NEW MEXICO

0 300 600 900 1200 1500 1800 2100 2400 2700 3000 0